

Massachusetts Cultural Resource Information System

Scanned Record Cover Page

Inventory No:	CON.96
Historic Name:	Wheildon - Browne Storage Building
Common Name:	
Address:	17 Belknap St
City/Town:	Concord
Village/Neighborhood:	Concord Center
Local No:	G9-789-2
Year Constructed:	c 1909
Architect(s):	
Architectural Style(s):	No style
Use(s):	Out Building; Single Family Dwelling House
Significance:	Architecture
Area(s):	
Designation(s):	
Building Materials(s):	Roof: Asphalt Shingle Wall: Synthetic Other; Wood; Wood Clapboard



The Massachusetts Historical Commission (MHC) has converted this paper record to digital format as part of ongoing projects to scan records of the Inventory of Historic Assets of the Commonwealth and National Register of Historic Places nominations for Massachusetts. Efforts are ongoing and not all inventory or National Register records related to this resource may be available in digital format at this time.

The MACRIS database and scanned files are highly dynamic; new information is added daily and both database records and related scanned files may be updated as new information is incorporated into MHC files. Users should note that there may be a considerable lag time between the receipt of new or updated records by MHC and the appearance of related information in MACRIS. Users should also note that not all source materials for the MACRIS database are made available as scanned images. Users may consult the records, files and maps available in MHC's public research area at its offices at the State Archives Building, 220 Morrissey Boulevard, Boston, open M-F, 9-5.

Users of this digital material acknowledge that they have read and understood the MACRIS Information and Disclaimer (<http://mhc-macris.net/macrisdisclaimer.htm>)

Data available via the MACRIS web interface, and associated scanned files are for information purposes only. THE ACT OF CHECKING THIS DATABASE AND ASSOCIATED SCANNED FILES DOES NOT SUBSTITUTE FOR COMPLIANCE WITH APPLICABLE LOCAL, STATE OR FEDERAL LAWS AND REGULATIONS. IF YOU ARE REPRESENTING A DEVELOPER AND/OR A PROPOSED PROJECT THAT WILL REQUIRE A PERMIT, LICENSE OR FUNDING FROM ANY STATE OR FEDERAL AGENCY YOU MUST SUBMIT A PROJECT NOTIFICATION FORM TO MHC FOR MHC'S REVIEW AND COMMENT. You can obtain a copy of a PNF through the MHC web site (www.sec.state.ma.us/mhc) under the subject heading "MHC Forms."

Commonwealth of Massachusetts
Massachusetts Historical Commission
220 Morrissey Boulevard, Boston, Massachusetts 02125
www.sec.state.ma.us/mhc

This file was accessed on: Monday, July 30, 2018 at 10:18 AM

FORM B - BUILDING

Assessor's number

USGS Quad

Area(s)

Form Number

CON. 96

Massachusetts Historical Commission
80 Boylston Street
Boston, Massachusetts 02116

G9-789-2

CONCORD

96

Town CONCORD SET B

(neighborhood or village) _____

Concord Center P1SS 17 Belknap Streetic Name Wheildon/Browne outbuildingsPresent dwelling and garageOriginal outbuildingsof Construction pre-1909e Sanborn mapsForm utilitarianect/Builder unknown

Interior Material:

Foundation concrete (some sections
parged)Wall/Trim clapboard and synthetic
sidingRoof asphalt shingle

Outbuildings/Secondary Structures _____

3-car garage

Major Alterations (with dates) _____

converted to a house ca. 1930's; east
section added after 1947. Shed
dormer on cottage.

Condition fairMoved ☒ no ☐ yes Date N/AAcreage less than one acre

Setting In residential district of
19th- and early-20th-century houses at
town center. Faces south to side yard;
driveway at front.

Sketch Map

Draw a map of the area indicating properties within it. Number each property for which individual inventory forms have been completed. Label streets including route numbers, if any. Attach a separate sheet if space is not sufficient here. Indicate North.

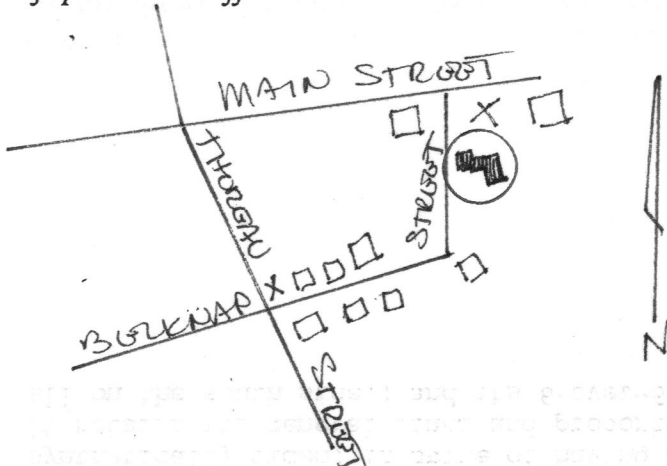

A. Forbes

Recorded by _____
for Concord Hist. CommissionOrganization _____
June, 1992

Date (month/day/year) _____

CON 96

BUILDING FORM

ARCHITECTURAL DESCRIPTION ☐ see continuation sheet

Describe architectural features. Evaluate the characteristics of this building in terms of other buildings within the community.

In spite of the considerable amount of modern construction here, #17 Belknap Street is significant as the conversion of two pre-1909 outbuildings. Both the garage and small 1 1/2-story cottage to its east are formerly shown on maps as sheds and storage buildings. The garage retains its clapboard siding. The cottage has been synthetically sided; in spite of having lost some of its trim in the siding process, it retains its general lines and proportions (including the shed-roofed one-story ell on the south side,) and its 6-over-6-sash windows.

HISTORICAL NARRATIVE ☐ see continuation sheet

Discuss the history of the building. Explain its associations with local (or state) history. Include uses of the building, and the role(s) the owners/occupants played within the community.

In the middle of this century the ca. two-acre former William Wheildon property at #207 Main Street, which extended west to Belknap and south to Middle Street, was divided into four lots, and new houses built at #221 Main and #30 Middle Street. This little cottage and garage was formerly a pair of 1 1/2-story storage buildings that stood here next to the road at the extreme western edge of the property. (See #207 Main Street.) Mr. Wheildon died in 1892, and both outbuildings were certainly standing during the time that his son-in-law T. Quincy Browne succeeded him as owner. After Mr. Browne died in 1914, the whole property was sold to George Phelan, who lived here until 1922. In 1924 the property was bought by Edward and Harriet Motley, who owned it through the middle of the century.

By 1927 the western building had become an automobile garage, and sometime between 1927 and 1947 the small building just to its east was converted to a dwelling. The largest, cupolaed cross-gabled section was added after 1947.

BIBLIOGRAPHY and/or REFERENCES ☐ see continuation sheet

Maps, atlases: Sanborns from 1909.
(See sources for #207 Main Street.)

☐ Recommended for listing in the National Register of Historic Places. *If checked, you must attach a completed National Register Criteria Statement form.*