

# Massachusetts Cultural Resource Information System

## Scanned Record Cover Page

<b>Inventory No:</b>	CON.381
<b>Historic Name:</b>	
<b>Common Name:</b>	
<b>Address:</b>	20 Elsinore St
<b>City/Town:</b>	Concord
<b>Village/Neighborhood:</b>	Concord Center
<b>Local No:</b>	G9-605
<b>Year Constructed:</b>	c 1880
<b>Architect(s):</b>	
<b>Architectural Style(s):</b>	Victorian Eclectic
<b>Use(s):</b>	Single Family Dwelling House
<b>Significance:</b>	Architecture
<b>Area(s):</b>	CON.Z: Back of the Depot - Fairgrounds
<b>Designation(s):</b>	
<b>Building Materials(s):</b>	Roof: Asphalt Shingle Wall: Wood; Wood Clapboard Foundation: Brick



The Massachusetts Historical Commission (MHC) has converted this paper record to digital format as part of ongoing projects to scan records of the Inventory of Historic Assets of the Commonwealth and National Register of Historic Places nominations for Massachusetts. Efforts are ongoing and not all inventory or National Register records related to this resource may be available in digital format at this time.

The MACRIS database and scanned files are highly dynamic; new information is added daily and both database records and related scanned files may be updated as new information is incorporated into MHC files. Users should note that there may be a considerable lag time between the receipt of new or updated records by MHC and the appearance of related information in MACRIS. Users should also note that not all source materials for the MACRIS database are made available as scanned images. Users may consult the records, files and maps available in MHC's public research area at its offices at the State Archives Building, 220 Morrissey Boulevard, Boston, open M-F, 9-5.

Users of this digital material acknowledge that they have read and understood the MACRIS Information and Disclaimer (<http://mhc-macris.net/macrisdisclaimer.htm>)

Data available via the MACRIS web interface, and associated scanned files are for information purposes only. THE ACT OF CHECKING THIS DATABASE AND ASSOCIATED SCANNED FILES DOES NOT SUBSTITUTE FOR COMPLIANCE WITH APPLICABLE LOCAL, STATE OR FEDERAL LAWS AND REGULATIONS. IF YOU ARE REPRESENTING A DEVELOPER AND/OR A PROPOSED PROJECT THAT WILL REQUIRE A PERMIT, LICENSE OR FUNDING FROM ANY STATE OR FEDERAL AGENCY YOU MUST SUBMIT A PROJECT NOTIFICATION FORM TO MHC FOR MHC'S REVIEW AND COMMENT. You can obtain a copy of a PNF through the MHC web site ([www.sec.state.ma.us/mhc](http://www.sec.state.ma.us/mhc)) under the subject heading "MHC Forms."

Commonwealth of Massachusetts  
Massachusetts Historical Commission  
220 Morrissey Boulevard, Boston, Massachusetts 02125  
[www.sec.state.ma.us/mhc](http://www.sec.state.ma.us/mhc)

This file was accessed on: Friday, October 23, 2020 at 12:23 PM

FORM B - BUILDING

MASSACHUSETTS HISTORICAL COMMISSION  
80 BOYLSTON STREET  
BOSTON, MA 02116



Sketch Map: Draw map showing property's location in relation to nearest cross streets and/or geographical features. Indicate all buildings between inventoried property and nearest intersection(s). Indicate north

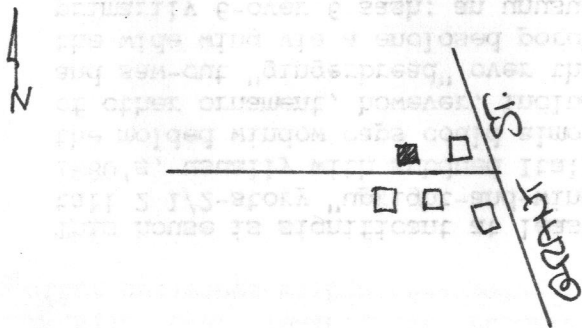

UTM REFERENCE Parcel G9-605

USGS QUADRANGLE \_\_\_\_\_

SCALE \_\_\_\_\_

PP - CONCORD  
USGS - CONCORD  
SENT B

CON.381

AREA

Z

FORM NO.

381

CONCORD

20 Elsinore Street

ss \_\_\_\_\_

tric Name \_\_\_\_\_

Present dwelling

Original dwelling

RIPTION

ca. 1880

e maps; style

vernacular Victorian

Architect unknown

Exterior Wall Fabric clapboard

Outbuildings garage

Major Alterations (with dates)  
encl. porch

Condition good

Moved no Date N/A

Acreage less than one acre

Setting Quiet side street of

late 19th- and early 20th Century

wood-frame houses.

Recorded by A. Forbes

Organization for Concord Hist. Comm.

Date July, 1990

## NATIONAL REGISTER CRITERIA STATEMENT (if applicable)

**ARCHITECTURAL SIGNIFICANCE** Describe important architectural features and evaluate in terms of other buildings within the community.

This house is significant at least partly for its lack of any definable style. It is a tall 2 1/2-story "upright-and-wing" house, a type found throughout Concord in the 1880's, usually with subdued Italianate trim. The narrow corner- and rake-boarding and the molded window caps could almost be called Italianate. The house has an eclectic mix of other ornament, however, including a shallow Greek-inspired pediment over one window, and saw-cut "gingerbread" over the polygonal bay on the facade. The main entry is in the wide wing via a enclosed porch built some time after 1909. The windows are primarily 6-over-6-sash; an unusual note is the 3-over-3-sash eave window on the wing facade, as are the two "blind" windows on the east chimney wall at first and second story. The foundation is brick.

**HISTORICAL SIGNIFICANCE** Explain the role owners played in local or state history and how the building relates to the development of the community.

#20 Elsinore was one of the first houses built on the lower section of the street, the third street to be developed in the neighborhood "back of the depot" at Concord center. Standing by 1889, it illustrates a general type of large single-family house found throughout the area through the turn of the century. It appears to have been built for a member of the Watson family, who also owned the later house at #24, next door. In 1906 it is shown as belonging to the estate of M. O'Neil.

**BIBLIOGRAPHY and/or REFERENCES**

Town directories.

Maps and atlases: 1889, 1893, 1906; Sanborns from 1903.