

Massachusetts Cultural Resource Information System

Scanned Record Cover Page

Inventory No:	CON.264
Historic Name:	Chamberlaine, Augustus P. House
Common Name:	
Address:	23 Lewis Rd
City/Town:	Concord
Village/Neighborhood:	
Local No:	F8-1804
Year Constructed:	1884
Architect(s):	
Architectural Style(s):	Colonial Revival
Use(s):	Single Family Dwelling House
Significance:	Architecture
Area(s):	
Designation(s):	
Building Materials(s):	Roof: Asphalt Shingle Wall: Brick; Wood Foundation: Granite; Stone, Cut



The Massachusetts Historical Commission (MHC) has converted this paper record to digital format as part of ongoing projects to scan records of the Inventory of Historic Assets of the Commonwealth and National Register of Historic Places nominations for Massachusetts. Efforts are ongoing and not all inventory or National Register records related to this resource may be available in digital format at this time.

The MACRIS database and scanned files are highly dynamic; new information is added daily and both database records and related scanned files may be updated as new information is incorporated into MHC files. Users should note that there may be a considerable lag time between the receipt of new or updated records by MHC and the appearance of related information in MACRIS. Users should also note that not all source materials for the MACRIS database are made available as scanned images. Users may consult the records, files and maps available in MHC's public research area at its offices at the State Archives Building, 220 Morrissey Boulevard, Boston, open M-F, 9-5.

Users of this digital material acknowledge that they have read and understood the MACRIS Information and Disclaimer (<http://mhc-macris.net/macrisdisclaimer.htm>)

Data available via the MACRIS web interface, and associated scanned files are for information purposes only. THE ACT OF CHECKING THIS DATABASE AND ASSOCIATED SCANNED FILES DOES NOT SUBSTITUTE FOR COMPLIANCE WITH APPLICABLE LOCAL, STATE OR FEDERAL LAWS AND REGULATIONS. IF YOU ARE REPRESENTING A DEVELOPER AND/OR A PROPOSED PROJECT THAT WILL REQUIRE A PERMIT, LICENSE OR FUNDING FROM ANY STATE OR FEDERAL AGENCY YOU MUST SUBMIT A PROJECT NOTIFICATION FORM TO MHC FOR MHC'S REVIEW AND COMMENT. You can obtain a copy of a PNF through the MHC web site (www.sec.state.ma.us/mhc) under the subject heading "MHC Forms."

Commonwealth of Massachusetts
Massachusetts Historical Commission
220 Morrissey Boulevard, Boston, Massachusetts 02125
www.sec.state.ma.us/mhc

This file was accessed on: Friday, October 23, 2020 at 1:27: PM

FORM B - BUILDING

Assessor's number

USGS Quad

Area(s)

Form Number

CON-264

Massachusetts Historical Commission
80 Boylston Street
Boston, Massachusetts 02116

F8-1804

CONCORD

264

CONCORD

Town

neighborhood or village)

23 Lewis Road

A.P. Chamberlaine House

Name

dwelling

Present

dwelling

Original

1884

Construction

Keyes; maps; visual

assessment

early Federal Revival

Style/Form

unknown

Architect/Builder

Exterior Material:

rusticated granite

Foundation

brick veneer

Wall/Trim

Roof

asphalt shingle

Outbuildings/Secondary Structures

Shingled barn/carriage house with tre-
foil verge-boarding at the facade
gable.

Major Alterations (with dates)

Post 1900: attic removed and roofline
lowered; 2nd-story porch removed,
center facade.

Condition

excellent

Moved ☒ no ☐ yes Date N/A

Acreage 94,950 sq. ft.

Setting On short dead-end street

of modern houses. Deep, open, lot
dotted with mature deciduous trees.

Sketch Map

Draw a map of the area indicating properties within
it. Number each property for which individual
inventory forms have been completed. Label streets
including route numbers, if any. Attach a separate
sheet if space is not sufficient here. Indicate North.

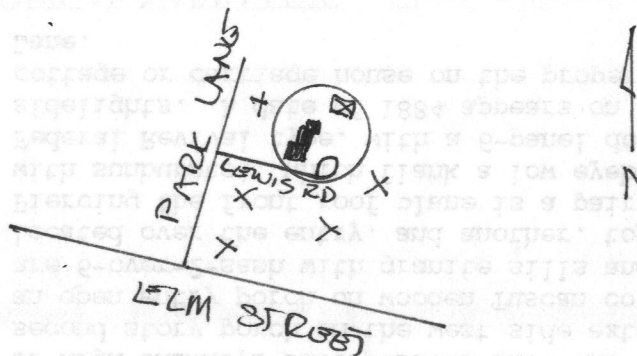

A. Forbes

research by Ann Dwelley

Recorded by

for Concord Hist. Commission

Organization

June, 1992

Date (month/day/year)

BUILDING FORM

ARCHITECTURAL DESCRIPTION ☐ *see continuation sheet*

Describe architectural features. Evaluate the characteristics of this building in terms of other buildings within the community.

#23 Lewis Road, which is now surrounded by modern houses, originally stood alone on the north side of Elm Street opposite the Baker Farm. Even after William Wheeler began to develop his "Nashawtuc Farm" in about 1891, for many years this house stood isolated at the end of a drive west from Musketaquid Road.

It is a high 2 1/2-story brick house with a nearly flat-topped gambrel roof, and pairs of high chimneys incorporated into the end walls. A long two-story wing with a recessed second story porch on the west side extends to the rear. The facade is five bays, with an open entry porch on wooden Tuscan columns with granite bases. Most of the windows are 6-over-2-sash with granite sills and brick lintels. A large three-part window is located over the entry, and another, topped with a fanlight, appears on the east wall. Piercing the front roof plane is a pair of shingled dormers (their pediments ornamented with sunbursts), which flank a low eyebrow dormer. The main entry is a wide, typically Federal Revival type, with a 6-panel door with leaded elliptical fanlight and sidelights. A date of 1884 appears on a brick at the rear of the house. A former cottage or carriage house on the property has been converted into the house at #74 Park Lane.

HISTORICAL NARRATIVE ☐ *see continuation sheet*

Discuss the history of the building. Explain its associations with local (or state) history. Include uses of the building, and the role(s) the owners/occupants played within the community.

This house stands on land that in the late eighteenth century was part of the farm of Gen. James Colburn (ca. 1757-1803). (Colburn's Hill was named for the Colburn family.) General Colburn married Rebecca Wheeler in 1779, and the original farmhouse may have been built at about that time. According to Keyes, some time between 1833 and 1837 carpenter Bradley Blanchard moved a large wooden house from Colburn Hill to #207 Main Street, where it stands today. If, as has been suggested by a structural inspection, the fieldstone foundation of #23 Lewis Road is of eighteenth-century date, it is likely that it may remain from the Colburn farmhouse. (See #207 Main Street.)

The building seen today is significant for its connection with the **Augustus P. Chamberlaine** family. Begun in 1884, it may not have been finished until 1889, for they are still listed as residing at #310 Main Street until that year. A.P. Chamberlaine, who had served as a Lieutenant in the Civil War, had worked in the East India trade in Salem with his father's business. He retired to Concord in the late 1860's. He died in 1909 after removing to Vermont in 1907. The property was sold in 1908 to developer **William Wheeler** and his partners, who subsequently subdivided it into house lots as an extension of their large Nashawtuc Farm neighborhood. Beginning in about 1910 the property appears under the name of **Warner**.

BIBLIOGRAPHY and/or REFERENCES ☐ *see continuation sheet*

Maps, atlases: "Map of Nashawtuc Farm, 1899-1914." 1889, and 1906 atlases.
Keyes/Tolman "Houses in Concord." 1885; rev. 1915 and 1920's.
Town Directories and tax lists.
Concord Chronicle.
Interview with owner, 1992.

- ☐ Recommended for listing in the National Register of Historic Places. *If checked, you must attach a completed National Register Criteria Statement form.*

Original yellow form: ☐ Eligibility file
Copies: ☒ Inventory form
☐ Town file (w/corresp.)
☐ Macris
☐ NR director

CON.264

Community: **Concord**

MHC OPINION: ELIGIBILITY FOR NATIONAL REGISTER

Date Received: 8/4/97 Date Due: Date Reviewed: 8/13/97
Type: Individual District (Attach map indicating boundaries)
Name: Hosmer Homestead / George Minot Baker House Inventory Form: CON.263
Address: 138 Baker Avenue
Requested by: Nancy A. Conway (owner)
Action: Honor ITC Grant R&C Other:
Agency: n/a Staff in charge of Review:

INDIVIDUAL PROPERTIES

☒ Eligible
☐ Eligible, also in district
☐ Eligible only in district
☐ Ineligible
☐ More information needed

DISTRICTS

☐ Eligible
☐ Ineligible
☐ More information needed

CRITERIA: A B C D
LEVEL: Local State National

STATEMENT OF SIGNIFICANCE by Cathleen Lambert

The Hosmer Homestead, constructed c. 1710 and substantially enlarged in the mid-18th-century, is eligible for listing in the National Register under Criterion A for its association with members of the prominent Hosmer family and their role in the early development of Concord; under Criterion C as a well-preserved vernacular Georgian farmhouse; and under Criterion D for the potential of the building to yield additional information about an unusual structural framing type. The house was built by Stephen Hosmer, grandson of William Hosmer, an original founder of Concord. According to a description by Lawrence Sorli of NPS, the framing system is significant for its overall level of intactness, its inclusion of early 18th-century elements, the flatwise placement of floor joists in some sections of the first floor, and examples of unusual joinery. Significant interior features include a paneled and pilastered chimney breast on the first floor; ovolo molded-edge casings on summer beams, wall girts and corner posts; and feather-edged and quarter-round molded wall sheathing boards. The house stayed in the Hosmer family until the late 19th century; it was purchased by the current owners in 1977.

