

# Massachusetts Cultural Resource Information System

## Scanned Record Cover Page

<b>Inventory No:</b>	CON.307
<b>Historic Name:</b>	Beaton - Davis Store
<b>Common Name:</b>	Richardson - Wheeler House
<b>Address:</b>	29 Lexington Rd
<b>City/Town:</b>	Concord
<b>Village/Neighborhood:</b>	Concord Center
<b>Local No:</b>	60, H9-14
<b>Year Constructed:</b>	c 1750
<b>Architect(s):</b>	
<b>Architectural Style(s):</b>	Greek Revival
<b>Use(s):</b>	Carriage Factory; General Retail Store; Multiple Family Dwelling House; Other Commercial; Other Manufacturing; Post Office; Single Family Dwelling House
<b>Significance:</b>	Architecture; Commerce; Industry; Politics Government
<b>Area(s):</b>	CON.A: Concord Monument Sq-Lexington Road Historic Dist. CON.DS: American Mile Historic District
<b>Designation(s):</b>	Local Historic District (03/06/1961); Nat'l Register District (09/13/1977)
<b>Building Materials(s):</b>	Roof: Asphalt Shingle Wall: Wood; Wood Clapboard Foundation: Granite; Stone, Cut



The Massachusetts Historical Commission (MHC) has converted this paper record to digital format as part of ongoing projects to scan records of the Inventory of Historic Assets of the Commonwealth and National Register of Historic Places nominations for Massachusetts. Efforts are ongoing and not all inventory or National Register records related to this resource may be available in digital format at this time.

The MACRIS database and scanned files are highly dynamic; new information is added daily and both database records and related scanned files may be updated as new information is incorporated into MHC files. Users should note that there may be a considerable lag time between the receipt of new or updated records by MHC and the appearance of related information in MACRIS. Users should also note that not all source materials for the MACRIS database are made available as scanned images. Users may consult the records, files and maps available in MHC's public research area at its offices at the State Archives Building, 220 Morrissey Boulevard, Boston, open M-F, 9-5.

Users of this digital material acknowledge that they have read and understood the MACRIS Information and Disclaimer (<http://mhc-macris.net/macrisdisclaimer.htm>)

Data available via the MACRIS web interface, and associated scanned files are for information purposes only. THE ACT OF CHECKING THIS DATABASE AND ASSOCIATED SCANNED FILES DOES NOT SUBSTITUTE FOR COMPLIANCE WITH APPLICABLE LOCAL, STATE OR FEDERAL LAWS AND REGULATIONS. IF YOU ARE REPRESENTING A DEVELOPER AND/OR A PROPOSED PROJECT THAT WILL REQUIRE A PERMIT, LICENSE OR FUNDING FROM ANY STATE OR FEDERAL AGENCY YOU MUST SUBMIT A PROJECT NOTIFICATION FORM TO MHC FOR MHC'S REVIEW AND COMMENT. You can obtain a copy of a PNF through the MHC web site ([www.sec.state.ma.us/mhc](http://www.sec.state.ma.us/mhc)) under the subject heading "MHC Forms."

Commonwealth of Massachusetts  
Massachusetts Historical Commission  
220 Morrissey Boulevard, Boston, Massachusetts 02125  
[www.sec.state.ma.us/mhc](http://www.sec.state.ma.us/mhc)

This file was accessed on: Friday, October 30, 2020 at 9:19: AM

Massachusetts Historical Commission

H9-14

Concord

A, DS

307

80 Boylston Street

Boston, Massachusetts 02116

NR: DIS.; LHD

RECEIVED

Town Concord

Place (neighborhood or village) \_\_\_\_\_

Concord centerAddress 29 Lexington RoadHistoric Name Beaton(?) / Davis StoreUses: Present single-family dwellingOriginal storeDate of Construction ca. 1750 or laterSource deed research by Ruth WheelerStyle/Form gable-end Greek RevivalArchitect/Builder unknown

## Exterior Material:

Foundation graniteWall/Trim wood clapboardRoof asphalt shingle

Outbuildings/Secondary Structures \_\_\_\_\_

shedMajor Alterations (with dates) modernexterior chimney and screened porch on E.side. (See also page 2.)Condition excellentMoved [X] no [ ] yes Date N/AAcreage less than one acreSetting Close to street on narrow lot, in areaof 17th- late-19th-C. houses. Fieldstone re-taining wall at rear, against ridge.

## Sketch Map

Draw a map of the area indicating properties within it. Number each property for which individual inventory forms have been completed. Label streets, including route numbers, if any. Attach a separate sheet if space is not sufficient here. Indicate north.

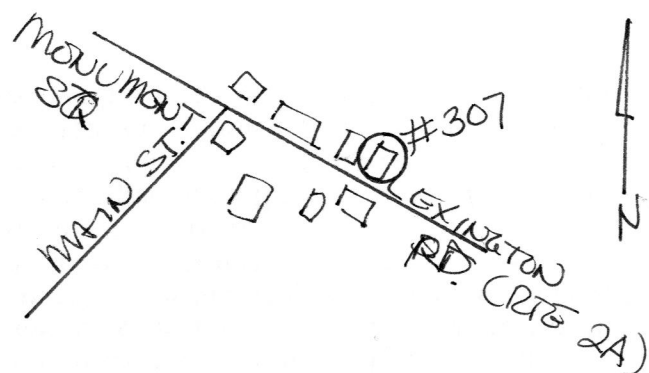
Recorded by Anne Forbes, consultant;

research by Ann Young

Organization Concord Hist. CommissionDate 10/17/94

## BUILDING FORM

### ARCHITECTURAL DESCRIPTION [ X ] *see continuation sheet*

*Describe architectural features. Evaluate the characteristics of this building in terms of other buildings within the community.*

This building, part of which may date to the mid-eighteenth century, is today the only structure in Concord that retains the large wood-frame, gable-end form of a typical early-nineteenth-century commercial and manufacturing building. It is a long, deep 2 1/2-story structure, with a five-bay, pedimented facade. The form, and most of the details here, probably added by Charles Davis after his purchase of the property in the late 1820's, appear to date to the transition between the Federal and Greek Revival styles. The windows are 12-over-12-sash, in projecting enframements. The main entry has a six-panel door with both raised, shaped field paneling and applied moldings. Similar paneling appears in the aprons under the multi-light, leaded sidelights. The entry surround consists of paneled pilasters, a flat frieze with reeded center section, reeded circles in the pilaster capitals, and a molded, projecting lintel. The house trim includes narrow cornerboards, a sill board, and boxed eaves with a large bed molding and frieze below.

### HISTORICAL NARRATIVE [X] *see continuation sheet*

*Explain history of the building. Explain its associations with local (or state) history. Include uses of the building, and the role(s) the owners/occupants played within the community.*

Although today this building has the appearance of an early nineteenth-century house or store, deed research indicates that part of it, at least, may date from before 1753, when a deed refers to land in this location that John Beaton had acquired for a new store. (See Form #313: Beaton/Brown/Heywood House).

The building, which stands on a small lot carved out of the west end of the six-acre parcel that the Rev. Peter Bulkeley bought from George Hayward in 1653, was owned for much of its history by the owners of the very early house at 47, as well as 37 Lexington Road. (See Forms 308 and 309). It apparently functioned as a combination store and manufacturing building through much of the late-eighteenth century.

Future deed research may reveal the names of other eighteenth-century owners of the building. More information, however, (some of it contradictory,) is available on its many nineteenth-century tenants. According to George Keyes, in his 1871 Social Circle memoir of John Richardson (owner of the Middlesex Hotel), Richardson, with partner Jonathan Wheeler, had a sizeable general store here between 1802 and 1805. Edward Jarvis and others, however, say that the Richardson & Wheeler store was located in the old "White Block" across the street on the Church Green. (Cont.)

### BIBLIOGRAPHY and/or REFERENCES [X] *see continuation sheet*

Maps and Atlases: 1830, 1852, 1856, 1875, 1889, 1893, 1906. Sanborns.  
Concord Directories.  
Concord Library, Special Collections: Obituary File.  
Concord Vital Records.  
Jarvis. Houses & People in Concord. ca. 1884. (Cont.)

[ X ] Recommended for listing in the National Register of Historic Places\*. If checked, a completed National Register Criteria Statement form is attached. \*NR-listed 1977.



INVENTORY FORM CONTINUATION SHEET

Massachusetts Historical Commission  
80 Boylston Street  
Boston, Massachusetts 02116

Community	Property
Concord	Beaton (?)/Davis Store
Area(s) A	Form No.s 307

HISTORICAL NARRATIVE, cont.

Jarvis speaks of other tenants in the building at the beginning of the nineteenth century. According to him, the tenant of the first floor was wheelwright and carriage-maker Joseph Turner, who lived across the street in one of the tenements in the "long block" (see Form #322--48 Lexington Road.) He died in 1808. In the upstairs was a related business, Henry Sanderson's a harness and carriage-trimming shop. Sanderson was the third Captain of the Concord Artillery, and apparently left Concord in about 1814, after the War of 1812. Between 1803 and 1808 the young William Whiting, nephew of Dr. Joseph Hunt of 47 Lexington Road, served as Sanderson's apprentice. He later became a wealthy carriage manufacturer (see Form 42--169 Main Street).

In 1827, one of the five enterprising Davis brothers, **Charles B. Davis**, purchased 37 Lexington Road as his residence. He may have acquired this building at the same time, as it is known to have housed his own general store before he built the "Davis Block" at the corner of Main and Walden Streets (see Form #12) in the late 1840's. Charles Davis was the town postmaster at intervals from 1838 to 1861, and the post office was located here for part of that time.

Charles Davis apparently owned the building until his death in 1865, renting it out. After he died, the property was acquired by **Joel Walcott**, who had bought 47 Lexington Road for his home in the late 1840's, and in the early 1870's owned #37 as well. He is said to have converted #29 to a "four-tenement" house, although Assessor's records indicate that Charles Davis may already have made it over into a residence at the time he moved his store. Among the tenants in the mid-1880's were Phoebe Foster and Rhoda Melvin, two of the "silent poor" (people who lived partly on the charity of the town). Keyes also lists John Langmaid, an engineer on the Boston & Lowell Railroad, and "his bright little wife."

Joel Walcott died in 1883, and all three buildings, 29, 37, and 47 Lexington Road, remained in the family until after Mrs. Walcott's death in 1895. This house was subsequently sold to **John Flaherty**, who is listed here with several other family members by 1901. By 1915 John Flaherty had apparently died, as the house is shown under the name of his widow. Members of the Flaherty family owned the property through at least 1950.

BIBLIOGRAPHY, cont.

Chapin, Sarah, ed. Edward Jarvis' Reminiscences of Concord.

Keyes/Tolman. "Houses in Concord."

Social Circle Memoirs, Vols. I: John Richardson, Jonathan Davis, Josiah Davis;  
Vol. II: Edward Jarvis, Nathaniel Munroe, William Whiting;  
Vol. IV: Samuel Staples.

Wheeler, Ruth. Concord, Climate for Freedom.  
Our American Mile.  
Concord House File: L4.

FORM B - STRUCTURE SURVEY  
MASSACHUSETTS HISTORICAL COMMISSION  
Office of the Secretary, State House, Boston

1. Is this structure historically significant to:  
Town      Commonwealth      Nation

Structure has historical connection with the following themes: (See also reverse side)

Agriculture	Commerce/Industry
Architecture	Science/Invention
Art/Sculpture	Travel/Communication
Education	Military Affairs
Government	Religion/Philosophy
Literature	Indians
Music	Development of Town/City

2. Town Concord CON. 307 307  
Street Lexington Rd (29)  
Name RICHARDSON-WHEELER House  
Original Use NEDIS - 9/13/77  
LHD - 3/6/61  
PI - CONCORD  
Present Use USGS - CONCORD SET B  
Present Owner private  
Date mid 1800's Style Greek Rev  
Source of Date guess - style, JB  
Architect \_\_\_\_\_

3. CONDITION: Excellent Good Fair Deteriorated Moved Altered \_\_\_\_\_

IMPORTANCE of site to area: Great/Little None SITE endangered by \_\_\_\_\_

4. DESCRIPTION

FOUNDATION/BASEMENT: High Regular Low Material: cut stone

WALL COVER: Wood clapboard Brick Stone Other \_\_\_\_\_

STORIES: 1 2 3 4 CHIMNEYS: 1 2 3 4 Center End Cluster Elaborate Irregular

ATTACHMENTS: Wings Ell Shed Dependency \_\_\_\_\_ Simple/Complex

PORCHES: 1 2 3 4 Portico Balcony \_\_\_\_\_ Recessed \_\_\_\_\_

ROOF: Ridge Gambrel Flat Hip Mansard  
Tower Cupola Dormer windows Balustrade Grillwork \_\_\_\_\_

FACADE: Gable End: Front/Side Symmetrical/Asymmetrical Simple/Complex Ornament

Entrance: Front/Side Centered Double Features: side lights, cornice, modified pilasters

Windows: Spacing: Regular/Irregular Identical/Varied 12/12

Corners: Plain Pilasters Quoins Obscured \_\_\_\_\_

OUTBUILDINGS \_\_\_\_\_ LANDSCAPING \_\_\_\_\_

5. Indicate location of structure on map below 6. Footage of structure from street 10'

Property has 40 feet frontage on street

Recorder \_\_\_\_\_

For 1

Photo 68-448  
II-14

5.09.065.11060

NOTE: Recorder should obtain written permission from Commission or sponsoring organization before using this form. (See Reverse Side)



FOR USE WITH IMPORTANT STRUCTURES (Indicate any interior features of note)

Fireplace

Stairway

Other

GIVE A BRIEF DESCRIPTION OF HISTORIC IMPORTANCE OF SITE (Refer and elaborate on theme circled on front of form)

REFERENCE (Where was this info

BIBLIOGRAPHY



Original Owner: \_\_\_\_\_

Deed Information: Book Number \_\_\_\_\_ Page \_\_\_\_\_, \_\_\_\_\_ Registry of Deeds