

# Massachusetts Cultural Resource Information System

## Scanned Record Cover Page

<b>Inventory No:</b>	CON.30
<b>Historic Name:</b>	U. S. Post Office - Concord Branch
<b>Common Name:</b>	
<b>Address:</b>	34 Walden St
<b>City/Town:</b>	Concord
<b>Village/Neighborhood:</b>	Concord Center
<b>Local No:</b>	H9-828
<b>Year Constructed:</b>	1937
<b>Architect(s):</b>	Carter, Harry B.; Guarino, John; Hull, Franklin M.; Kaeselau, Charles; Melick, Louis A.; Mutual Construction Company; Nelson-Wentworth, C.; Simon, Louis Adolf
<b>Architectural Style(s):</b>	Colonial Revival
<b>Use(s):</b>	Post Office
<b>Significance:</b>	Architecture; Art; Commerce; Politics Government
<b>Area(s):</b>	CON.DU: Main Street Historic District
<b>Designation(s):</b>	Local Historic District (03/12/1962)
<b>Building Materials(s):</b>	Roof: Asphalt Shingle Wall: Brick; Granite; Wood; Wood Flushboard; Metal, Undetermined Foundation: Brick; Concrete Unspecified



The Massachusetts Historical Commission (MHC) has converted this paper record to digital format as part of ongoing projects to scan records of the Inventory of Historic Assets of the Commonwealth and National Register of Historic Places nominations for Massachusetts. Efforts are ongoing and not all inventory or National Register records related to this resource may be available in digital format at this time.

The MACRIS database and scanned files are highly dynamic; new information is added daily and both database records and related scanned files may be updated as new information is incorporated into MHC files. Users should note that there may be a considerable lag time between the receipt of new or updated records by MHC and the appearance of related information in MACRIS. Users should also note that not all source materials for the MACRIS database are made available as scanned images. Users may consult the records, files and maps available in MHC's public research area at its offices at the State Archives Building, 220 Morrissey Boulevard, Boston, open M-F, 9-5.

Users of this digital material acknowledge that they have read and understood the MACRIS Information and Disclaimer (<http://mhc-macris.net/macrisdisclaimer.htm>)

Data available via the MACRIS web interface, and associated scanned files are for information purposes only. THE ACT OF CHECKING THIS DATABASE AND ASSOCIATED SCANNED FILES DOES NOT SUBSTITUTE FOR COMPLIANCE WITH APPLICABLE LOCAL, STATE OR FEDERAL LAWS AND REGULATIONS. IF YOU ARE REPRESENTING A DEVELOPER AND/OR A PROPOSED PROJECT THAT WILL REQUIRE A PERMIT, LICENSE OR FUNDING FROM ANY STATE OR FEDERAL AGENCY YOU MUST SUBMIT A PROJECT NOTIFICATION FORM TO MHC FOR MHC'S REVIEW AND COMMENT. You can obtain a copy of a PNF through the MHC web site ([www.sec.state.ma.us/mhc](http://www.sec.state.ma.us/mhc)) under the subject heading "MHC Forms."

Commonwealth of Massachusetts  
Massachusetts Historical Commission  
220 Morrissey Boulevard, Boston, Massachusetts 02125  
[www.sec.state.ma.us/mhc](http://www.sec.state.ma.us/mhc)

This file was accessed on: Friday, October 30, 2020 at 1:46: PM

## FORM B - BUILDING

Assessor's number

USGS Quad

Area(s)

Form Number

Massachusetts Historical Commission  
80 Boylston Street  
Boston, Massachusetts 02116

H9-828

CONCORD

DU

30

Town

CONCORD

SECT B

neighborhood or village)

Concord Center

34 Walden Street

SS

Concord Post Office

ic Name

post office

Present

post office

Original

of Construction 1937

e Plaque on building

Form Col./Classical Revival

ect/Builder Harry B. Carter, with

Louis Simon; Neal Melick, engineer

L Exterior Material:

brick

Foundation

brick

Wall/Trim

asphalt shingle

Roof

Outbuildings/Secondary Structures

none

Major Alterations (with dates)

rear wing added, main entry replaced--  
late 20th century

Condition

good

Moved ☒ no ☐ yes Date N/A

Acreage less than one acre

Setting

In commercial district,  
in line of 19th-early 20th-century  
commercial, municipal and institu-  
tional buildings of varying design.  
At corner of Hubbard Street.

## Sketch Map

Draw a map of the area indicating properties within it. Number each property for which individual inventory forms have been completed. Label streets including route numbers, if any. Attach a separate sheet if space is not sufficient here. Indicate North.

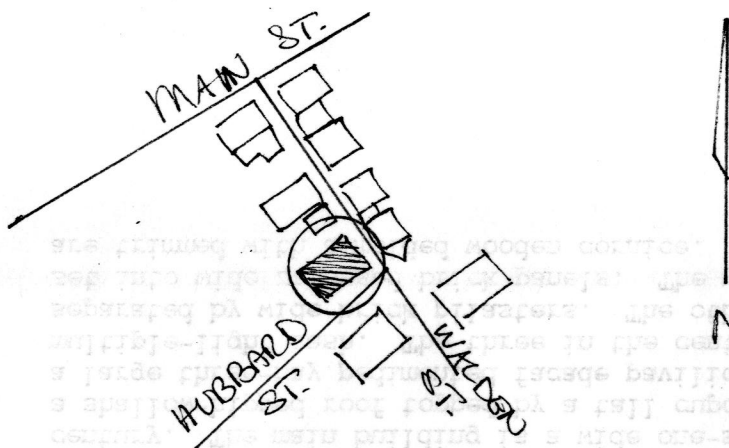

Recorded by Anne Forbes

Organization for Concord Hist. Commission

Date (month/day/year) July, 1992

BUILDING FORM

CON. 30

ARCHITECTURAL DESCRIPTION ☐ see continuation sheet

*Describe architectural features. Evaluate the characteristics of this building in terms of other buildings within the community.*

Like the 1904 municipal fire station next door, the Concord Post Office is typical of small Colonial Revival government buildings of the early twentieth century. The main building is a wide one-story symmetrical brick structure with a shallow-hipped roof topped by a tall cupola; the main entry is in the center of a large three-bay pedimented facade pavilion. All the windows are large, with multiple-light sash. The three in the center have segmental-arched openings are separated by wide brick pilasters. The other windows are rectangular, and are set into wide recessed brick panels. The pediment is flushboarded; the rooflines are trimmed with a molded wooden cornice.

HISTORICAL NARRATIVE ☐ see continuation sheet

*Discuss the history of the building. Explain its associations with local (or state) history. Include uses of the building, and the role(s) the owners/occupants played within the community.*

The Concord Post Office was built in 1937 on what had formerly been the lawn of the George Brabrook house (see #22-28 Walden Street.) It replaced a series of small Post Offices that over the course of the nineteenth and early twentieth centuries had been housed in stores and other business establishments on Main and Walden Streets.

BIBLIOGRAPHY and/or REFERENCES ☐ see continuation sheet

Maps and atlases: Sanborn maps from 1942.  
Street list, Main Street Historic District.

☐ Recommended for listing in the National Register of Historic Places. *If checked, you must attach a completed National Register Criteria Statement form.*

## Historic, Architectural &amp; Archeological Significance Survey

CON. 30

## 1. General Information

a. Facility Name U.S. Post Office, Concord, MA		b. Historic/Original Name U.S. Post Office	
c. Finance/Subloc. No.	d. Site Size (Sq. Ft.) 48700	e. Lot, Block	
f. Property Address (Include county & ZIP code) 34 Walden Street Concord, MA 01742 Middlesex County		g. Building Size (Sq. Ft.) 9150	h. Building Size (Dimensions) 74 X 56 & 69 X 72
j. Address of Office with Building Records (Name and address of field office, region, etc. with official file.) N.E. Field Real Estate & Buildings Office 1050 Waltham St., Lexington, MA 02173		i. Is Building Open to Public? Yes	
		k. Original Use of the Building Post Office	
		l. Present Use Same	

## 2. Property Appearance

a. Description of General Area (Describe neighborhood, historic district, land use & direct or indirect effect upon other building of historic interest. If more space is needed, attach additional sheets.)  On one of Concord's secondary commercial streets, the Post Office is adjacent to a large 19th century wood church and a two story brick commercial structure. The sites are well landscaped with a number of large trees. Across the street are one story connected masonry storefronts lining the sidewalk, no landscape planting.
b. General Condition of Property (Site and Building)  Condition and maintenance of both the building and grounds appears to be very good.
c. Description of Building Material (Roofs, walls, foundation, interior features, floor and ceiling, etc.) The brick exterior is trimmed in painted wood. Front steps are granite with simple iron railings and light standards. The concrete foundation is not visible on the exterior. The front roof is pitched with replacement asphalt shingles and metal ice flashing at the eaves. The lobby floor is original terrazzo, wainscot is marble. Ornamental plaster is used at the cornice and ceiling. A new aluminum and glass partition divides the original lobby.
d. Description of Floorplan (Attach drawings if available.) A low flight of granite steps leads up to the (replacement aluminum) entry doors. The box lobby is entered directly, with the expanded service lobby to the right and the Postmaster's Office to the left. Beyond the lobby is the expanded workroom with the mail platform and truck area to the rear.
e. Description of unusual or unique subterranean features (Basement, tunnels, vaults, shelters, etc.)

3. Architectural History

a. Date Designed 1936	b. Date Construction Began 1937	c. Date Building Completed 1939	d. Date Restored/Renovated 1965
e. Original Owner (Name & Biographical Data) U.S. Government		f. Original Builder (Name & Biographical Data) Mutual Construction Co. - General Contractor C. Nelson-Wentworth - Construction Engineer Franklin M. Hull - Construction Engineer	
g. Original Architect (Name & Biographical Data) Louis A. Simon, Supervising Architect Harry B. Carter, Architect		h. Other Significant Participants (Names, relation to building, biographical data) Mural in lobby-Revolutionary War Battle Scene at Concord by Charles Kaesela	
i. Restoration Architect or Designer (if building has been restored/renovated) Rear extension, lobby modernization - John Guarino, Architect			

4. Architectural Significance

Identify type, period, method of construction, artistic value, significant and distinguishable entity (See National Register criteria, 36 CFR 60.4, Criteria for Evaluation).

A pedimented 3-bay central projecting pavilion is flanked by single-bay hipped roof side wings. Wide, flat brick pilasters define the central bays, inset brick panels define the wing bays. Each main bay contains a large, segmental arched opening set in a recessed brick panel, the center opening containing the simply framed wood entrance (replacement aluminum doors). A large wood and metal louvered belfry caps the intersection of the pitched roofs. Detailing (Colonial Traditional) is kept to a minimum. The visual effect depends instead on the relationship between large-scale elements of a somewhat planer character.

5. Historical Significance

Identify the broad patterns of American history (National, state or local level) or historic persons with whom the property is associated. (See National Register Criteria.)

Designed in the mid 1930's, the building is typical of many built during the Depression Era. A local consulting Architect was employed, one of the less common Government programs, but frequently used in the early 1930's.

6. Conclusion and Recommendation

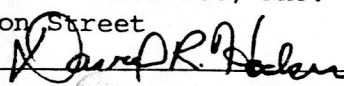
Should this property be nominated to the National Register? <input type="checkbox"/> Yes <input checked="" type="checkbox"/> No			
Give a brief statement to support your recommendation.			
A smaller structure by Post Office standards, the building is a reflection of standard plans and exterior elevation motifs in use by the Post Office at this time. Belfry and pediment are possible design features influenced by the particular location, otherwise the appearance is undistinguished.			
Prepared by David R. Hocker		Final Recommendation by	
Signature Earl R. Flansburgh + Associates, Inc. 77 North Washington Street Boston, MA 02114		Signature 	
Title Architect	Date 15 July 1983	Title	Date

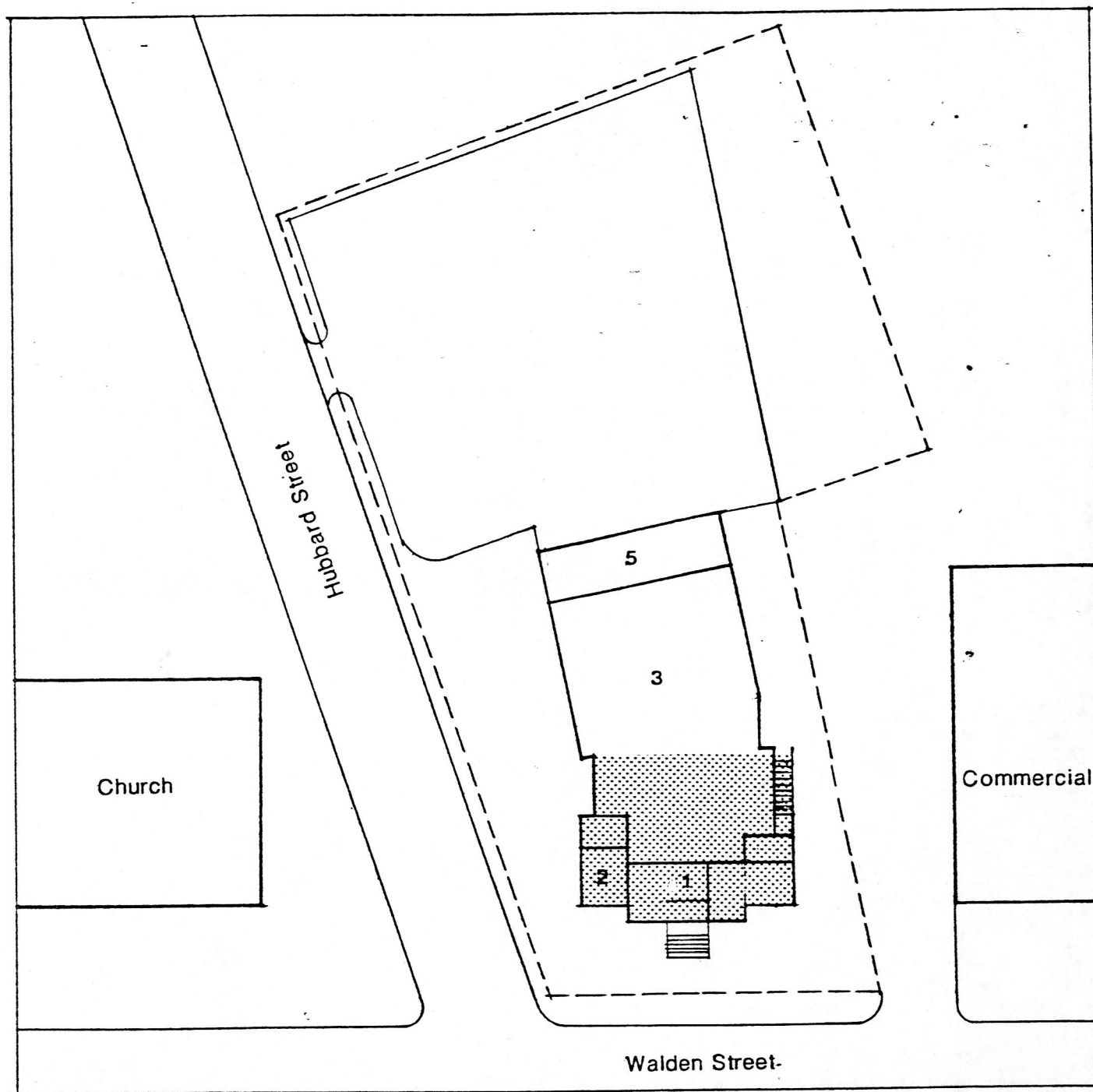

1. LOBBY
2. POSTMASTER'S OFFICE
3. WORKROOM
4. MAIL VESTIBULE
5. MAIL PLATFORM
- ORIGINAL BUILDING (BEFORE ADDITION)

