

# Massachusetts Cultural Resource Information System

## Scanned Record Cover Page

<b>Inventory No:</b>	CON.31
<b>Historic Name:</b>	Tuttle, Horace Livery Stable
<b>Common Name:</b>	
<b>Address:</b>	35-45 Walden St
<b>City/Town:</b>	Concord
<b>Village/Neighborhood:</b>	Concord Center
<b>Local No:</b>	H9-7
<b>Year Constructed:</b>	1891
<b>Architect(s):</b>	
<b>Architectural Style(s):</b>	No style; Not researched
<b>Use(s):</b>	Gas Station or Service Station; Other Commercial; Other Transportation; Showroom
<b>Significance:</b>	Architecture; Commerce; Community Planning; Transportation
<b>Area(s):</b>	CON.DU: Main Street Historic District
<b>Designation(s):</b>	Local Historic District (03/12/1962)
<b>Building Materials(s):</b>	Roof: Asphalt Shingle Wall: Wood; Wood Clapboard



The Massachusetts Historical Commission (MHC) has converted this paper record to digital format as part of ongoing projects to scan records of the Inventory of Historic Assets of the Commonwealth and National Register of Historic Places nominations for Massachusetts. Efforts are ongoing and not all inventory or National Register records related to this resource may be available in digital format at this time.

The MACRIS database and scanned files are highly dynamic; new information is added daily and both database records and related scanned files may be updated as new information is incorporated into MHC files. Users should note that there may be a considerable lag time between the receipt of new or updated records by MHC and the appearance of related information in MACRIS. Users should also note that not all source materials for the MACRIS database are made available as scanned images. Users may consult the records, files and maps available in MHC's public research area at its offices at the State Archives Building, 220 Morrissey Boulevard, Boston, open M-F, 9-5.

Users of this digital material acknowledge that they have read and understood the MACRIS Information and Disclaimer (<http://mhc-macris.net/macrisdisclaimer.htm>)

Data available via the MACRIS web interface, and associated scanned files are for information purposes only. THE ACT OF CHECKING THIS DATABASE AND ASSOCIATED SCANNED FILES DOES NOT SUBSTITUTE FOR COMPLIANCE WITH APPLICABLE LOCAL, STATE OR FEDERAL LAWS AND REGULATIONS. IF YOU ARE REPRESENTING A DEVELOPER AND/OR A PROPOSED PROJECT THAT WILL REQUIRE A PERMIT, LICENSE OR FUNDING FROM ANY STATE OR FEDERAL AGENCY YOU MUST SUBMIT A PROJECT NOTIFICATION FORM TO MHC FOR MHC'S REVIEW AND COMMENT. You can obtain a copy of a PNF through the MHC web site ([www.sec.state.ma.us/mhc](http://www.sec.state.ma.us/mhc)) under the subject heading "MHC Forms."

Commonwealth of Massachusetts  
Massachusetts Historical Commission  
220 Morrissey Boulevard, Boston, Massachusetts 02125  
[www.sec.state.ma.us/mhc](http://www.sec.state.ma.us/mhc)

This file was accessed on: Friday, October 30, 2020 at 1:46: PM

## FORM B - BUILDING

Assessor's number

USGS Quad

Area(s)

Form Number

Massachusetts Historical Commission  
80 Boylston Street  
Boston, Massachusetts 02116

H9-7

CONCORD

DU

31

CONCORD

(neighborhood or village)

Concord Center

35-45 Walden Street

ss

Tuttle's Livery  
Stable

Present commercial

Original livery stable

of Construction 1891

e Concord Chronicle

Form utilitarian

tect/Builder unknown

Exterior Material:

Foundation (not visible)

Wall/Trim clapboard

Roof asphalt shingle

Outbuildings/Secondary Structures

#33 Walden Street on same parcel

Major Alterations (with dates)

largely rebuilt 1980's (see page 2)

Condition fair

Moved ☒ no ☐ yes Date N/A

Acreage less than one acre

Setting In commercial district

opposite Hubbard Street. In area of  
19th-early 20th-century stores and  
institutional buildings of varying  
design.

## Sketch Map

Draw a map of the area indicating properties within it. Number each property for which individual inventory forms have been completed. Label streets including route numbers, if any. Attach a separate sheet if space is not sufficient here. Indicate North.

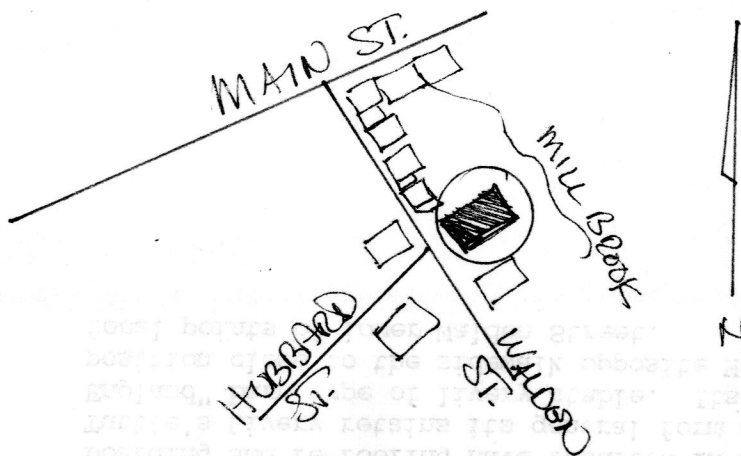

Recorded by Anne Forbes

Organization for Concord Hist. Commission

Date (month/day/year) July, 1992

CON-31

## BUILDING FORM

### ARCHITECTURAL DESCRIPTION ☐ see continuation sheet

*Describe architectural features. Evaluate the characteristics of this building in terms of other buildings within the community.*

Although all the windows and doors of this building have recently been replaced, new galleries have been replaced the old ones along the sides, and re-clapboarding and re-roofing have resulted in nearly all new exterior material, Tuttle's Livery retains its general form as a large 2-story gable-end "New England" barn type of livery stable. Its great bulk, cupolaed roof, and imposing position close to the sidewalk opposite Hubbard Street still make it one of the focal points of lower Walden Street.

### HISTORICAL NARRATIVE ☒ see continuation sheet

*Discuss the history of the building. Explain its associations with local (or state) history. Include uses of the building, and the role(s) the owners/occupants played within the community.*

This building, though highly altered, is a rare survival of a late-nineteenth-century livery stable in the heart of town. It was built in 1891 by Horace Tuttle, who bought out the smaller livery stable of George Penniman, which had been located from about 1880 just to the north on the site of #29/31 Walden Street. (Penniman had moved the former building from Monument Square where it is said to have housed the horses for the Wright Tavern. After the sale of his business he worked for Mr. Tuttle until his death in 1915. His old stable, which was subsequently converted to a grain and feed store, was torn in 1912.)

The Tuttle Livery Stable was both a rental and sales business, and was soon expanded back to the Mill Brook by the construction of a carriage storehouse behind the main building. The storehouse or "repository" stood until the middle of this century. Other outbuildings on the property included a small "horse clipping shed" where horses were sheared and, according to one longtime Concord resident, boys were given their summer haircuts as well. That building, which later was used as an auto repair shop for #33 Walden Street, was torn down between 1927 and 1942. (Cont.)

### BIBLIOGRAPHY and/or REFERENCES ☐ see continuation sheet

Keyes/Tolman.

Concord directories.

Maps and atlases: 1893, 1906; Sanborn maps from 1892.

Concord Chronicle.

Strawberries and Streetcars.

- ☐ Recommended for listing in the National Register of Historic Places. *If checked, you must attach a completed National Register Criteria Statement form.*

INVENTORY FORM CONTINUATION SHEET

Community

Property

CONCORD

Tuttle's Livery Stable

Massachusetts Historical Commission  
80 Boylston Street  
Boston, Massachusetts 02116

Area(s) Form No.

31

HISTORICAL SIGNIFICANCE, cont.

With the surge of tourism in Concord at the turn of the century, Tuttle's Livery carriages drove visitors to see the local historical sites, often including a long ride to the Wayside Inn in Sudbury. For many years horses for the fire company were also kept here.

When the automobile replaced the horse and carriage, the building was converted to a car dealership, and a long brick and concrete store- and garage-front was added across the width of the facade. Much of the building was used for auto repair. Later a filling station, with gas pumps located between it and #33, was operating here as well.

