

Massachusetts Cultural Resource Information System

Scanned Record Cover Page

Inventory No:	CON.89
Historic Name:	Whitney's Meat Market - Grocery Store
Common Name:	
Address:	59 Thoreau St
City/Town:	Concord
Village/Neighborhood:	Concord Center
Local No:	G9-779
Year Constructed:	c 1903
Architect(s):	
Architectural Style(s):	Italianate
Use(s):	Market or Grocery Store; Speciality store
Significance:	Architecture; Commerce
Area(s):	
Designation(s):	
Building Materials(s):	Wall: Wood; Wood Clapboard Foundation: Stone, Uncut



The Massachusetts Historical Commission (MHC) has converted this paper record to digital format as part of ongoing projects to scan records of the Inventory of Historic Assets of the Commonwealth and National Register of Historic Places nominations for Massachusetts. Efforts are ongoing and not all inventory or National Register records related to this resource may be available in digital format at this time.

The MACRIS database and scanned files are highly dynamic; new information is added daily and both database records and related scanned files may be updated as new information is incorporated into MHC files. Users should note that there may be a considerable lag time between the receipt of new or updated records by MHC and the appearance of related information in MACRIS. Users should also note that not all source materials for the MACRIS database are made available as scanned images. Users may consult the records, files and maps available in MHC's public research area at its offices at the State Archives Building, 220 Morrissey Boulevard, Boston, open M-F, 9-5.

Users of this digital material acknowledge that they have read and understood the MACRIS Information and Disclaimer (<http://mhc-macris.net/macrisdisclaimer.htm>)

Data available via the MACRIS web interface, and associated scanned files are for information purposes only. THE ACT OF CHECKING THIS DATABASE AND ASSOCIATED SCANNED FILES DOES NOT SUBSTITUTE FOR COMPLIANCE WITH APPLICABLE LOCAL, STATE OR FEDERAL LAWS AND REGULATIONS. IF YOU ARE REPRESENTING A DEVELOPER AND/OR A PROPOSED PROJECT THAT WILL REQUIRE A PERMIT, LICENSE OR FUNDING FROM ANY STATE OR FEDERAL AGENCY YOU MUST SUBMIT A PROJECT NOTIFICATION FORM TO MHC FOR MHC'S REVIEW AND COMMENT. You can obtain a copy of a PNF through the MHC web site (www.sec.state.ma.us/mhc) under the subject heading "MHC Forms."

Commonwealth of Massachusetts
Massachusetts Historical Commission
220 Morrissey Boulevard, Boston, Massachusetts 02125
www.sec.state.ma.us/mhc

This file was accessed on: Friday, October 30, 2020 at 1:34: PM

FORM B - BUILDING

Assessor's number

USGS Quad

Area(s)

Form Number

Massachusetts Historical Commission
80 Boylston Street
Boston, Massachusetts 02116

G9-779

CONCORD

89

NOV 17 1992

Town CONCORD

Place (neighborhood or village) Concord Center

Address 59 Thoreau Street

Historic Name

Present dry cleaner's

Original double store

Year of Construction ca. 1903

Source maps; visual assessment

Style/Form utilitarian "false-front"

Architect/Builder Unknown

Exterior Material:

Foundation field stone

Wall/Trim wood clapboard

Roof (not visible)

Outbuildings/Secondary Structures none

Major Alterations (with dates) none

Condition excellent

Moved ☐ no ☐ yes Date N/A

Acreage less than one acre

Setting Close to street on south-

east corner of Belknap, in line

of 1-story twentieth-century

store buildings.

Sketch Map

Draw a map of the area indicating properties within it. Number each property for which individual inventory forms have been completed. Label streets including route numbers, if any. Attach a separate sheet if space is not sufficient here. Indicate North.

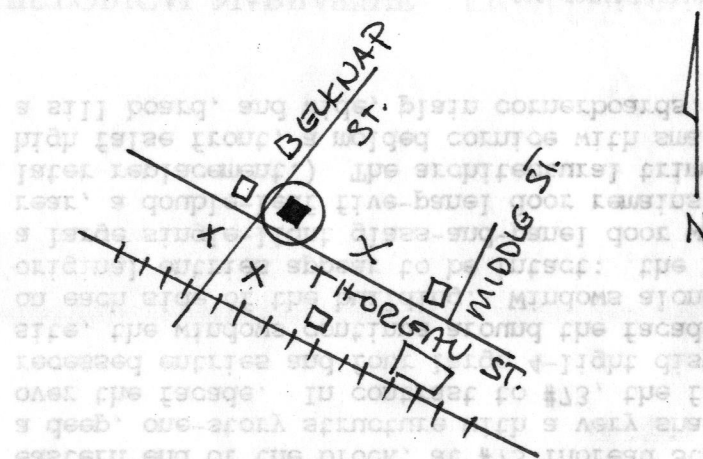

Recorded by A. Forbes

Organization for Concord Historical Commission

Date (month/day/year) June, 1991

BUILDING FORM

CON. 89

ARCHITECTURAL DESCRIPTION ☐ see continuation sheet

Describe architectural features. Evaluate the characteristics of this building in terms of other buildings within the community.

This little building is extremely significant as Concord's most well preserved survival of an early-twentieth-century wooden store building. The fact that it is one of a pair adds to importance--it was built as a companion to a nearly identical building on the eastern end of the block, at #73 Thoreau Street. In completely intact condition, it is a deep, one-story structure with a very shallow pitched roof and prominent "false front" over the facade. In contrast to #73, the facade here is symmetrical, with a pair of recessed entries and four large 4-light display windows. Taking advantage of the corner site, the windows continue around the facade corner, where there is one display window on each side of the building. Windows along the sides are 2-over-2-sash. All the major original entries appear to be intact: the two facade entries are recessed, and each has a large single-light glass-and-panel door with two-part transom above. Even at the rear, a double-leaf five-panel door remains. (A six-panel door to its east may be a later replacement.) The architectural trim, identical to that at #73, consists of the high false front, a molded cornice with small paired brackets and returns on the facade, a sill board, and wide, plain cornerboards.

HISTORICAL NARRATIVE ☐ see continuation sheet

Discuss the history of the building. Explain its associations with local (or state) history. Include uses of the building, and the role(s) the owners/occupants played within the community.

#59 Thoreau Street is a vivid reminder of the small commercial center that gradually grew up opposite the Fitchburg Depot at the beginning of this century. Its companion at #73 was standing by 1903, and this building was built shortly thereafter, both on small parcels carved out of the corners of James Garty's large lot, which had stretched from his house at #60 Middle Street (see Form # ,) to Thoreau. Although the coming of the railroad in 1844 inspired such heavy-duty enterprises as the coal, lumber, and grain yards on the west side of the tracks, with a century-old commercial area thriving to the east at Main and Walden Streets, small commercial growth around the depot was relatively slow. With the exception of the depot and baggage office on the west side of Thoreau and a small fire house and the livery stable of the McManus brothers on the east, #59 and 73 were the only buildings on the street between Sudbury Road and Belknap Street as late as 1918.

Each store building housed two stores. #59 was occupied by a grocery in the north half, and John Whitney's meat market on the south.

BIBLIOGRAPHY and/or REFERENCES ☐ see continuation sheet

Maps and atlases: 1906; Sanborns from 1909.

Town Directories.

Concord Oral History Tapes. Ralph Hemenway: interviewed by Renee Garrelick, 3/83.

☒ Recommended for listing in the National Register of Historic Places. *If checked, you must attach a completed National Register Criteria Statement form.*

CON. 89

Massachusetts Historical Commission
80 Boylston Street
Boston, Massachusetts 02116

Community
CONCORD

Property Address
59 Thoreau St.

Area(s)	FormNo.
	89

National Register of Historic Places Criteria Statement Form



Recommended:

☐ Individually ☒ District ☒ Contributing to a Potential Historic District

Criteria:

A	B	C	D
<input type="checkbox"/>	<input type="checkbox"/>	<input checked="" type="checkbox"/>	<input type="checkbox"/>

Statement of Significance by Anne McCarthy Forbes

The criteria that are checked in the above sections must be justified here.

#59 Thoreau Street, with its companion at #73 Thoreau, contributes significantly to a small commercial area of early-twentieth-century "false-front" store buildings in a rare state of preservation, and thus meets Criterion C. as part of a National Register District.