

# Massachusetts Cultural Resource Information System

## Scanned Record Cover Page

<b>Inventory No:</b>	CON.106
<b>Historic Name:</b>	Garty, James House
<b>Common Name:</b>	
<b>Address:</b>	60 Middle St
<b>City/Town:</b>	Concord
<b>Village/Neighborhood:</b>	Concord Center
<b>Local No:</b>	
<b>Year Constructed:</b>	1852
<b>Architect(s):</b>	
<b>Architectural Style(s):</b>	Greek Revival; Italianate
<b>Use(s):</b>	Single Family Dwelling House
<b>Significance:</b>	Agriculture; Architecture
<b>Area(s):</b>	
<b>Designation(s):</b>	
<b>Building Materials(s):</b>	Roof: Asphalt Shingle Wall: Wood; Wood Clapboard Foundation: Granite; Stone, Cut



The Massachusetts Historical Commission (MHC) has converted this paper record to digital format as part of ongoing projects to scan records of the Inventory of Historic Assets of the Commonwealth and National Register of Historic Places nominations for Massachusetts. Efforts are ongoing and not all inventory or National Register records related to this resource may be available in digital format at this time.

The MACRIS database and scanned files are highly dynamic; new information is added daily and both database records and related scanned files may be updated as new information is incorporated into MHC files. Users should note that there may be a considerable lag time between the receipt of new or updated records by MHC and the appearance of related information in MACRIS. Users should also note that not all source materials for the MACRIS database are made available as scanned images. Users may consult the records, files and maps available in MHC's public research area at its offices at the State Archives Building, 220 Morrissey Boulevard, Boston, open M-F, 9-5.

Users of this digital material acknowledge that they have read and understood the MACRIS Information and Disclaimer (<http://mhc-macris.net/macrisdisclaimer.htm>)

Data available via the MACRIS web interface, and associated scanned files are for information purposes only. THE ACT OF CHECKING THIS DATABASE AND ASSOCIATED SCANNED FILES DOES NOT SUBSTITUTE FOR COMPLIANCE WITH APPLICABLE LOCAL, STATE OR FEDERAL LAWS AND REGULATIONS. IF YOU ARE REPRESENTING A DEVELOPER AND/OR A PROPOSED PROJECT THAT WILL REQUIRE A PERMIT, LICENSE OR FUNDING FROM ANY STATE OR FEDERAL AGENCY YOU MUST SUBMIT A PROJECT NOTIFICATION FORM TO MHC FOR MHC'S REVIEW AND COMMENT. You can obtain a copy of a PNF through the MHC web site ([www.sec.state.ma.us/mhc](http://www.sec.state.ma.us/mhc)) under the subject heading "MHC Forms."

Commonwealth of Massachusetts  
Massachusetts Historical Commission  
220 Morrissey Boulevard, Boston, Massachusetts 02125  
[www.sec.state.ma.us/mhc](http://www.sec.state.ma.us/mhc)

This file was accessed on: Monday, July 30, 2018 at 10:16 AM

## FORM B - BUILDING

MASSACHUSETTS HISTORICAL COMMISSION  
80 BOYLSTON STREET  
BOSTON, MA 02116

RECEIVED

PO. CONCORD  
USGS - CONCORD  
SEA - B

CON. 106

AREA

FORM NO.

106

CONCORD

60 Middle Street

Address

James Garty House

Historic Name

Present dwelling

Original dwelling

DESCRIPTION

ca. 1852-56

Influence maps; style

Greek Rev., with Italianate update

Architect unknown

Exterior Wall Fabric clapboard

Outbuildings garage/shed

Major Alterations (with dates)

screened porch  
on E.; some windows, porch posts replaced

Condition good

Moved no Date N/A

Acreage less than one acre

Setting On side street of primarily

mid-19th century wood-frame houses.

Picket fenced yard with heavy round-

headed granite posts.

Recorded by A. Forbes

Organization Research by Cathie Sur  
for Concord Hist. Comm.

Date July, 1990

UTM REFERENCE Parcel G9-772

USGS QUADRANGLE

SCALE

Sketch Map: Draw map showing property's location  
in relation to nearest cross streets and/or  
geographical features. Indicate all buildings  
between inventoried property and nearest  
intersection(s).  
Indicate north

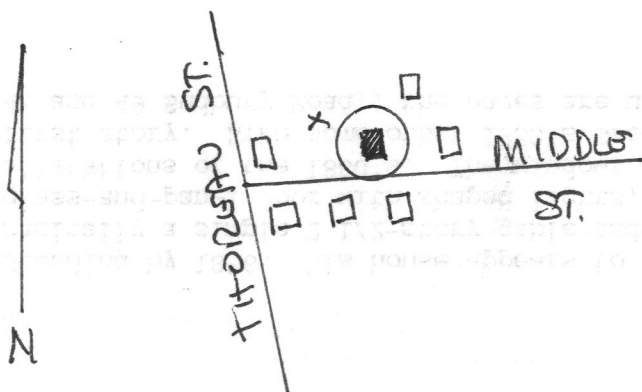

## NATIONAL REGISTER CRITERIA STATEMENT (if applicable)

For its association with the late nineteenth-century residential development of Concord center, and as a well-preserved example of the architecture of its time, this house meets Criteria A and C as part of a National Register district encompassing a town center of 17th- through early 20th-century buildings.

## ARCHITECTURAL SIGNIFICANCE Describe important architectural features and evaluate in terms of other buildings within the community.

Standing by 1856, this house appears to be the second oldest on Middle Street. It is basically a simple 2 1/2-story gable-and-wing Greek Revival building, but its glass-and-panel door with shaped lights, and window- and eave-bracketing are probably alterations of the 1880's. The windows are 6-over-6-sash, very large in scale at the first story. Like some other 1850's Greek Revival houses in the neighborhood, (see e.g. 46 and 49 Sudbury Road,) the eaves are unboxed. The foundation is dressed granite.

## HISTORICAL SIGNIFICANCE Explain the role owners played in local or state history and how the building relates to the development of the community.

Middle Street was laid out in 1850. It extended from Academy Lane, (also called both School Street and Cross Street,) to the one-block section of today's Thoreau Street that had been built in front of the Fitchburg Railroad depot. Henry Thoreau made the first plan of the street, showing its division into house lots. Later in the nineteenth century it was called Centre Street; the name was changed by the early part of this century.

#60 is one of the few houses in the neighborhood to have remained in the same family for over half a century. It was built for James Garty, a mason, (according to Keyes,) who was a three-term road commissioner, serving from 1886 to 1896, as chairman for much of that time. During the Civil War he had a government contract that involved timber for ships, and was later a western railroad representative. He was retired by 1885, and established a vineyard and a hothouse, (the present garage,) on the property. He died in about 1900, and his widow, Ellen Garty, lived here until at least 1915. Their son, William, is shown living here in 1905-6; he is listed as a contractor, but was also a freight agent for the C.B. & Q. Railroad. It appears that he had moved from Concord by 1915, but that his widow and her brother, "Mr. Hines", occupied the house in 1930.

## BIBLIOGRAPHY and/or REFERENCES

Walcott. "Concord Roads." 1938.

Keyes.

Town directories.

Maps, plans, and atlases: 1856, 1875, 1889, 1893, 1906; Sanborns from 1903.