

Massachusetts Cultural Resource Information System

Scanned Record Cover Page

Inventory No:	CON.320
Historic Name:	Davidson, Isabella House
Common Name:	Jenkins, Alder House
Address:	62 Lexington Rd
City/Town:	Concord
Village/Neighborhood:	Concord Center
Local No:	A, H9-112
Year Constructed:	1892
Architect(s):	
Architectural Style(s):	Colonial Revival; Shingle Style
Use(s):	Single Family Dwelling House
Significance:	Architecture
Area(s):	CON.A: Concord Monument Sq-Lexington Road Historic Dist. CON.DS: American Mile Historic District
Designation(s):	Local Historic District (03/06/1961); Nat'l Register District (09/13/1977)
Building Materials(s):	Roof: Asphalt Shingle Wall: Wood; Wood Shingle Foundation: Stone, Uncut



The Massachusetts Historical Commission (MHC) has converted this paper record to digital format as part of ongoing projects to scan records of the Inventory of Historic Assets of the Commonwealth and National Register of Historic Places nominations for Massachusetts. Efforts are ongoing and not all inventory or National Register records related to this resource may be available in digital format at this time.

The MACRIS database and scanned files are highly dynamic; new information is added daily and both database records and related scanned files may be updated as new information is incorporated into MHC files. Users should note that there may be a considerable lag time between the receipt of new or updated records by MHC and the appearance of related information in MACRIS. Users should also note that not all source materials for the MACRIS database are made available as scanned images. Users may consult the records, files and maps available in MHC's public research area at its offices at the State Archives Building, 220 Morrissey Boulevard, Boston, open M-F, 9-5.

Users of this digital material acknowledge that they have read and understood the MACRIS Information and Disclaimer (<http://mhc-macris.net/macrisdisclaimer.htm>)

Data available via the MACRIS web interface, and associated scanned files are for information purposes only. THE ACT OF CHECKING THIS DATABASE AND ASSOCIATED SCANNED FILES DOES NOT SUBSTITUTE FOR COMPLIANCE WITH APPLICABLE LOCAL, STATE OR FEDERAL LAWS AND REGULATIONS. IF YOU ARE REPRESENTING A DEVELOPER AND/OR A PROPOSED PROJECT THAT WILL REQUIRE A PERMIT, LICENSE OR FUNDING FROM ANY STATE OR FEDERAL AGENCY YOU MUST SUBMIT A PROJECT NOTIFICATION FORM TO MHC FOR MHC'S REVIEW AND COMMENT. You can obtain a copy of a PNF through the MHC web site (www.sec.state.ma.us/mhc) under the subject heading "MHC Forms."

Commonwealth of Massachusetts
Massachusetts Historical Commission
220 Morrissey Boulevard, Boston, Massachusetts 02125
www.sec.state.ma.us/mhc

This file was accessed on: Friday, October 30, 2020 at 9:39: AM

Massachusetts Historical Commission

H9-112

Concord

A

320

80 Boylston Street

Boston, Massachusetts 02116

NR: DIS; LHD

DEC 07 1994

Town Concord

Place (neighborhood or village) _____

Concord centerAddress 62 Lexington RoadHistoric Name Mrs. Isabella Davidson HouseUses: Present dwellingOriginal dwellingDate of Construction 1892Source Assessor's records; Keyes/TolmanStyle/Form Shingle StyleArchitect/Builder unknown

Exterior Material:

Foundation fieldstoneWall/Trim wood shingleRoof asphalt shingle

Outbuildings/Secondary Structures _____

ca. 1893 carriage house

Major Alterations (with dates) _____

rear deck added--late 20th C.Condition excellentMoved ☒ no ☐ yes Date N/AAcreage less than one acreSetting On narrow lot; picket fence withgranite posts and base at front. In area ofprimarily 17th-19th-C. houses.

Sketch Map

Draw a map of the area indicating properties within it. Number each property for which individual inventory forms have been completed. Label streets, including route numbers, if any. Attach a separate sheet if space is not sufficient here. Indicate north.

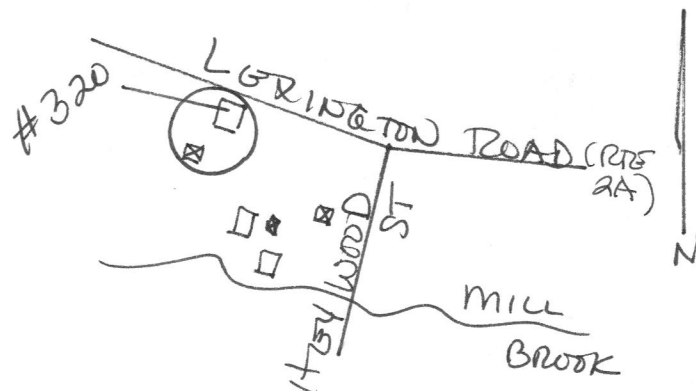
Recorded by Anne Forbes, consultant

research by Ann Donoghue

Organization Concord Hist. CommissionDate 11/4/94

BUILDING FORM

CON 320

ARCHITECTURAL DESCRIPTION [] *see continuation sheet*

Describe architectural features. Evaluate the characteristics of this building in terms of other buildings within the community.

62 Lexington Road is one of the most intact examples of the Shingle Style in Concord, and the only example of the style on lower Lexington Road. This is a two-story house, two rooms deep, with a gambrel roof. Two interior chimneys rise from the roof ridge. The facade, dominated, as in many Shingle Style houses, by the sweeping roof planes, is asymmetrical, with a wide off-center entry under a hip-roofed porch. On either side of the entry are a paired 6-over-1-sash rectangular bay on the east, and a single 6-over-1 window on the west. The entry porch is supported on Tuscan columns, and its square-doweled balustrade extends across the east portion of the facade.

The main door is a glass-and-panel type with 12 panes over three horizontal panels. Attention is drawn to the upper part of the house by a variety of window treatments. A wide, pyramid-roofed dormer bay window, with two 4-over-1-sash windows flanking a 24-pane fixed sash projects through both roof planes above the entry, and a small, single dormer, also with 4-over-1-sash and a near-pyramid roof, appears beside it. On the side elevations, a curved, shingled gable screen appears under each end-gable; the one on the west projects out over a single double-hung window, and the one on the east over a pair of narrow, multilight casements. Toward the rear of the west side is a small polygonal oriel bay window, possibly a later alteration.

HISTORICAL NARRATIVE [X] *see continuation sheet*

Explain history of the building. Explain its associations with local (or state) history. Include uses of the building, and the role(s) the owners/occupants played within the community.

The only later "infill" house to be built on the south streetfront of lower Lexington Road, and the only one in the area built for a woman, this house was constructed in 1892.

In about 1888, its small lot was divided out of the larger property at 70 Lexington Road, and owned for a short time by Mrs. R. F. (Cora) Barrett of Main Street, one of the major real estate speculators of the time in Concord center. Sometime prior to 1875, Henry Shattuck had bought the acre-and-a-half piece of land between Lexington Road and the Mill Brook which used to be the garden for the Reuben Brown House (77 Lexington Road--see Form #312.) He may have torn down the ancient Brown barn, mentioned in deeds as far back as 1725, and built a new barn on the property, which he later converted to the house at #70 (See Form #319).

This house was built for a widow, **Isabella Davidson** (Mrs. Francis). Little is known about her, and she only lived here for a short time before she died in 1896, at the age of 76. After her death, the property was purchased by the owner who had bought #70, artist **Robertson James**, who rented it out. Among the early tenants was George L. Ware, a broker, (probably a customs broker), in Boston. (Cont.)

BIBLIOGRAPHY and/or REFERENCES [X] *see continuation sheet*

Maps and Atlases: Maps and Atlases: (1889), 1893, 1906. Sanborns from 1918.
Concord Assessor's Records.
Concord Directories and Lists of Poll Taxpayers.
Concord Vital Records. (Cont.)

[X] Recommended for listing in the National Register of Historic Places*. *If checked, a completed National Register Criteria Statement form is attached.* *NR-listed 1977.

INVENTORY FORM CONTINUATION SHEET

Community

Property

CON. 320

Massachusetts Historical Commission
80 Boylston Street
Boston, Massachusetts 02116

Concord Isabella Davidson House

Area(s)
A

Form No.
320

HISTORICAL NARRATIVE, cont.

Robertson James died in 1910, and his family continued to rent out the house after his death. In contrast to some of the other buildings in the area, which had frequent changes of tenants, attorney Robert H. Bygrave and his wife, Olive, lived here from at least 1917 through 1948. Robert Bygrave (1877-1959) was an attorney with an office in Boston. Locally, he served on the School Committee from 1922 to 1929, and for three years as its chairman. It appears that for a brief time in 1949 **Edward H. James**, who had inherited the house after his mother died, and lived for many years at 70 Lexington and 105 Walden Street, was actually living here in the house.

In 1949-1950 both #s 62 and 70 were acquired by **Alexander and Nancy (Bush) Ellis**. Mrs. Ellis was the sister of later U.S. President, George Bush. The Ellises sold the house between 1953 and 1956.

BIBLIOGRAPHY, cont.

Concord Free Library: Obituary file.

Donoghue, Ann. Interview with owners, 4/18/94.

Keyes/Tolman. "Houses in Concord."