

# Massachusetts Cultural Resource Information System

## Scanned Record Cover Page

<b>Inventory No:</b>	CON.19
<b>Historic Name:</b>	Stewart, Rennselaer S. House
<b>Common Name:</b>	
<b>Address:</b>	75 Main St
<b>City/Town:</b>	Concord
<b>Village/Neighborhood:</b>	Concord Center
<b>Local No:</b>	H9-825-2
<b>Year Constructed:</b>	r 1825
<b>Architect(s):</b>	
<b>Architectural Style(s):</b>	Federal; Greek Revival
<b>Use(s):</b>	Bank; Shop Other; Single Family Dwelling House; Speciality store
<b>Significance:</b>	Architecture; Commerce
<b>Area(s):</b>	CON.DU: Main Street Historic District
<b>Designation(s):</b>	Local Historic District (03/12/1962)
<b>Building Materials(s):</b>	Roof: Asphalt Shingle Wall: Wood; Wood Clapboard Foundation: Granite; Stone, Cut



The Massachusetts Historical Commission (MHC) has converted this paper record to digital format as part of ongoing projects to scan records of the Inventory of Historic Assets of the Commonwealth and National Register of Historic Places nominations for Massachusetts. Efforts are ongoing and not all inventory or National Register records related to this resource may be available in digital format at this time.

The MACRIS database and scanned files are highly dynamic; new information is added daily and both database records and related scanned files may be updated as new information is incorporated into MHC files. Users should note that there may be a considerable lag time between the receipt of new or updated records by MHC and the appearance of related information in MACRIS. Users should also note that not all source materials for the MACRIS database are made available as scanned images. Users may consult the records, files and maps available in MHC's public research area at its offices at the State Archives Building, 220 Morrissey Boulevard, Boston, open M-F, 9-5.

Users of this digital material acknowledge that they have read and understood the MACRIS Information and Disclaimer (<http://mhc-macris.net/macrisdisclaimer.htm>)

Data available via the MACRIS web interface, and associated scanned files are for information purposes only. THE ACT OF CHECKING THIS DATABASE AND ASSOCIATED SCANNED FILES DOES NOT SUBSTITUTE FOR COMPLIANCE WITH APPLICABLE LOCAL, STATE OR FEDERAL LAWS AND REGULATIONS. IF YOU ARE REPRESENTING A DEVELOPER AND/OR A PROPOSED PROJECT THAT WILL REQUIRE A PERMIT, LICENSE OR FUNDING FROM ANY STATE OR FEDERAL AGENCY YOU MUST SUBMIT A PROJECT NOTIFICATION FORM TO MHC FOR MHC'S REVIEW AND COMMENT. You can obtain a copy of a PNF through the MHC web site ([www.sec.state.ma.us/mhc](http://www.sec.state.ma.us/mhc)) under the subject heading "MHC Forms."

Commonwealth of Massachusetts  
Massachusetts Historical Commission  
220 Morrissey Boulevard, Boston, Massachusetts 02125  
[www.sec.state.ma.us/mhc](http://www.sec.state.ma.us/mhc)

This file was accessed on: Friday, October 30, 2020 at 11:16 AM

## FORM B - BUILDING

Assessor's number

USGS Quad

Area(s)

Form Number

Massachusetts Historical Commission  
80 Boylston Street  
Boston, Massachusetts 02116

H9-825-2

CONCORD

DU

19

RECEIVED

NOV 17 1992

CONCORD

Town SECTION - B

Place (neighborhood or village) \_\_\_\_\_

Concord Center P1

75 Main Street

Address

R.S. Stewart House

Historic Name

bank

Present

dwelling, shop

Original

ca. 1820's

Date of Construction

maps; Keyes; visual assessment

Source

Federal/Greek Revival

Style/Form

unknown

Architect/Builder

Prior Material:

dressed granite

Foundation

wood clapboard

Wall/Trim

asphalt shingle

Roof

Outbuildings/Secondary Structures

none

display

Major Alterations (with dates)

windows on facade, exter. chimney on  
E., 1-story extension and dormers on  
rear. Door replaced. (See page 2.)

Condition

fair

Moved ☒ no ☐ yes

Date N/A

Acreage

less than one acre

Setting

In commercial district,  
opposite cemetery in line of shops; con-  
verted house to west. Brick terrace in  
front, landscaped yard and town parking  
lot to rear.

## Sketch Map

Draw a map of the area indicating properties within  
it. Number each property for which individual  
inventory forms have been completed. Label streets  
including route numbers, if any. Attach a separate  
sheet if space is not sufficient here. Indicate North.

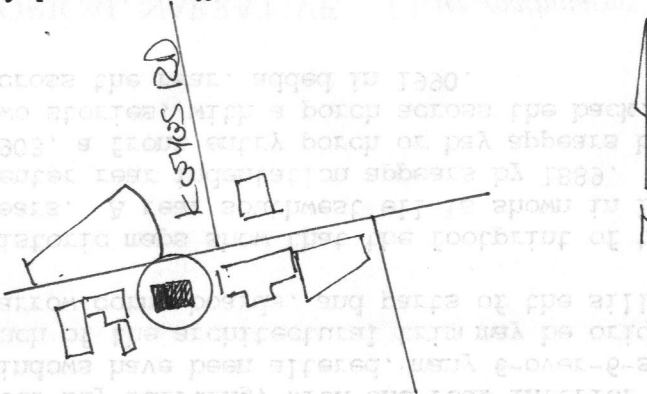

Recorded by Anne Forbes;  
research by Beatrice von Baeyer  
for Concord Hist. Commission

Organization June, 1992

Date (month/day/year) \_\_\_\_\_

ARCHITECTURAL DESCRIPTION ☐ see continuation sheet

Describe architectural features. Evaluate the characteristics of this building in terms of other buildings within the community.

In spite of considerable alteration over the years, this building makes a significant contribution to the character of Concord center as a reminder of the days when brick and wood-frame houses extended all the way down to the Milldam on Main Street. As late as 1927 two other residences stood to the east of this one; today #75 is the easternmost house on the street. It is a 2 1/2-story, three- by four-bay building, with one rear interior chimney. Although its entry and several windows have been altered, many 6-over-6-sash windows with molded surrounds remain. Much of the architectural trim may be original, including the molded, boxed cornice, narrow cornerboards, and parts of the sillboard at the granite foundation.

Historic maps show that the footprint of this house changed several times over the years. A rear southwest ell is shown in 1852, and either a pair of rear ells or a center rear indentation appears by 1889. The center rear section was one-story by 1903, a front entry porch or bay appears by 1909, and in 1927 the building is a full two stories, with a porch across the back. The most recent addition is a section across the rear, added in 1990.

HISTORICAL NARRATIVE ☐ see continuation sheet

Discuss the history of the building. Explain its associations with local (or state) history. Include uses of the building, and the role(s) the owners/occupants played within the community.

In its century-long ownership by one family, #75 is unusual in the lower Main Street area, where buildings tended to change hands fairly frequently. According to Keyes it was built by at least 1835 by **Rennselaer S. Stewart**, (ca. 1792-1889) a tailor who lived here until his death at the age of 92. He had a tailor shop in the west end of the house. Since a building appears in this position on the map of 1830, it is likely that the house was standing by that time.

After R.S. Stewart died, the property was owned by his son, **Charles E. Stewart**, who altered the house somewhat, and was the proprietor of a clothing store, C. E. Stewart's "Clothing House," from at least 1876 through the mid-1890's. For some years his store was located in the building at #23-25 Main Street. By 1909 he had retired from business, and by 1913 real estate agent **Albert B. Black** and his family also lived here. **Albert Black** died in about 1929, and his widow, **Evelyn Black** remained here through the 1930's.

After 1937 **Hurwitch Brothers'** clothing store was located here, and occupied the building through the middle of the century. Today this is a branch of the **Cambridge Trust Company**, one the few wood-frame buildings in the Concord area occupied by a bank.

( BIBLIOGRAPHY and/or REFERENCES ☐ see continuation sheet

Maps, atlases: 1830 (?), 1852, 1856, ca. 1871, 1875, 1889, 1893, 1906. Sanborns from 1903.  
Keyes/Tolman.  
Interview with Cambridge Trust officers, 1992.  
Concord directories.

- ☐ Recommended for listing in the National Register of Historic Places. If checked, you must attach a completed National Register Criteria Statement form.