

Massachusetts Cultural Resource Information System

Scanned Record Cover Page

Inventory No:	CON.462
Historic Name:	
Common Name:	
Address:	89-91 Central St
City/Town:	Concord
Village/Neighborhood:	West Concord
Local No:	262
Year Constructed:	c 1900
Architect(s):	
Architectural Style(s):	Victorian Eclectic
Use(s):	Single Family Dwelling House
Significance:	Architecture
Area(s):	CON.F: Derby Addition CON.DH: Central Streetscape
Designation(s):	
Building Materials(s):	Roof: Asphalt Shingle Wall: Glass; Wood; Wood Clapboard; Wood Shingle



The Massachusetts Historical Commission (MHC) has converted this paper record to digital format as part of ongoing projects to scan records of the Inventory of Historic Assets of the Commonwealth and National Register of Historic Places nominations for Massachusetts. Efforts are ongoing and not all inventory or National Register records related to this resource may be available in digital format at this time.

The MACRIS database and scanned files are highly dynamic; new information is added daily and both database records and related scanned files may be updated as new information is incorporated into MHC files. Users should note that there may be a considerable lag time between the receipt of new or updated records by MHC and the appearance of related information in MACRIS. Users should also note that not all source materials for the MACRIS database are made available as scanned images. Users may consult the records, files and maps available in MHC's public research area at its offices at the State Archives Building, 220 Morrissey Boulevard, Boston, open M-F, 9-5.

Users of this digital material acknowledge that they have read and understood the MACRIS Information and Disclaimer (<http://mhc-macris.net/macrisdisclaimer.htm>)

Data available via the MACRIS web interface, and associated scanned files are for information purposes only. THE ACT OF CHECKING THIS DATABASE AND ASSOCIATED SCANNED FILES DOES NOT SUBSTITUTE FOR COMPLIANCE WITH APPLICABLE LOCAL, STATE OR FEDERAL LAWS AND REGULATIONS. IF YOU ARE REPRESENTING A DEVELOPER AND/OR A PROPOSED PROJECT THAT WILL REQUIRE A PERMIT, LICENSE OR FUNDING FROM ANY STATE OR FEDERAL AGENCY YOU MUST SUBMIT A PROJECT NOTIFICATION FORM TO MHC FOR MHC'S REVIEW AND COMMENT. You can obtain a copy of a PNF through the MHC web site (www.sec.state.ma.us/mhc) under the subject heading "MHC Forms."

Commonwealth of Massachusetts
Massachusetts Historical Commission
220 Morrissey Boulevard, Boston, Massachusetts 02125
www.sec.state.ma.us/mhc

This file was accessed on: Thursday, October 22, 2020 at 11:39 AM

FORM B - BUILDING

MASSACHUSETTS HISTORICAL COMMISSION
80 BOYLSTON STREET
BOSTON, MA 02116

W. WILSON
USGS - MAY
SECT - A

AREA
F, DH-

CON. 462
FORM NO.
262
462



Sketch Map: Draw map showing property's location in relation to nearest cross streets and/or geographical features. Indicate all buildings between inventoried property and nearest intersection(s).
Indicate north

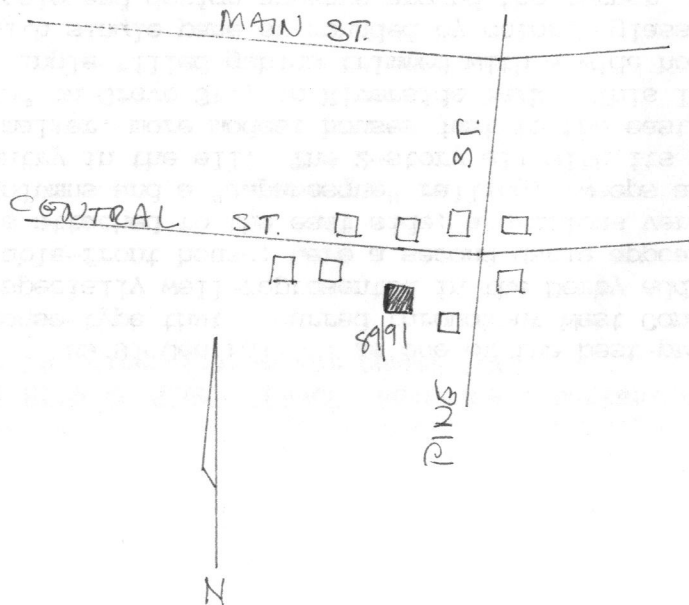

UTM REFERENCE _____

USGS QUADRANGLE _____

SCALE _____

Town West Concord

Address 89/91 Central St.

Historic Name _____

Use: Present residential

Original residential

DESCRIPTION

Date ca. 1900

Source maps and visual assessment

Style Queen Anne vernacular

Architect _____

Exterior Wall Fabric wood clapboard and shingle

Outbuildings garage

Major Alterations (with dates) _____

none

Condition good

Moved _____ Date _____

Acreage less than one acre

Setting On a quiet residential side street of houses of similar date

Recorded by A. Forbes

Organization for Concord Hist. Comm

Date 6/15/88

NATIONAL REGISTER CRITERIA STATEMENT (if applicable)

ARCHITECTURAL SIGNIFICANCE Describe important architectural features and evaluate in terms of other buildings within the community.

89/91 Central St. is one of the best-preserved of the larger examples of a house-type that occurred throughout West Concord at the turn of the century, but is especially well-represented in the Derby addition. It is a 2 1/2-story, side-hall plan, gable-front house; here a second gable appears on the west side. A shallow, 2-story ell is attached to the east side; a gracious veranda, trimmed with bracketed, lathe-turned columns and a "Japanesque" railing, sweeps around from the main front entry to a second entry in the ell. The 2-story ell with its own facade entry is also prevalent in smaller, more modest houses just to the east on Central and Pine St., (See Form # ,) and on Grove St., in Riverside Park. This long, larger version of the type has shingle-filled gables trimmed with a wide horizontal board below, and a stairwell window with single pane surrounded by colored-glass rectangles. A companion house of similar scale and design appears around the corner, at 26 Pine St.

HISTORICAL SIGNIFICANCE Explain the role owners played in local or state history and how the building relates to the development of the community.

Along with other large 2- and 3-bay gable-front houses, 89/91 Central St. illustrates one house type that, in its conservative, yet stylish, vernacular design, personifies West Concord tastes at the turn of the 20th century.

BIBLIOGRAPHY and/or REFERENCES

Sanborn Fire Insurance Maps, 1903, 1907, 1918, 1927.