

# Massachusetts Cultural Resource Information System

## Scanned Record Cover Page

<b>Inventory No:</b>	CON.146
<b>Historic Name:</b>	Wheeler, Timothy - Stow, Cyrus House
<b>Common Name:</b>	Concord Home for the Aged
<b>Address:</b>	110 Walden St
<b>City/Town:</b>	Concord
<b>Village/Neighborhood:</b>	Concord Center
<b>Local No:</b>	H9-122
<b>Year Constructed:</b>	c 1750
<b>Architect(s):</b>	Hosmer, Rufus
<b>Architectural Style(s):</b>	Greek Revival
<b>Use(s):</b>	Nursing Home; Single Family Dwelling House
<b>Significance:</b>	Architecture; Education; Health Medicine
<b>Area(s):</b>	CON.DU: Main Street Historic District
<b>Designation(s):</b>	Local Historic District (03/12/1962)
<b>Building Materials(s):</b>	Roof: Asphalt Shingle Wall: Wood; Wood Clapboard Foundation: Granite; Stone, Cut



The Massachusetts Historical Commission (MHC) has converted this paper record to digital format as part of ongoing projects to scan records of the Inventory of Historic Assets of the Commonwealth and National Register of Historic Places nominations for Massachusetts. Efforts are ongoing and not all inventory or National Register records related to this resource may be available in digital format at this time.

The MACRIS database and scanned files are highly dynamic; new information is added daily and both database records and related scanned files may be updated as new information is incorporated into MHC files. Users should note that there may be a considerable lag time between the receipt of new or updated records by MHC and the appearance of related information in MACRIS. Users should also note that not all source materials for the MACRIS database are made available as scanned images. Users may consult the records, files and maps available in MHC's public research area at its offices at the State Archives Building, 220 Morrissey Boulevard, Boston, open M-F, 9-5.

Users of this digital material acknowledge that they have read and understood the MACRIS Information and Disclaimer (<http://mhc-macris.net/macrisdisclaimer.htm>)

Data available via the MACRIS web interface, and associated scanned files are for information purposes only. THE ACT OF CHECKING THIS DATABASE AND ASSOCIATED SCANNED FILES DOES NOT SUBSTITUTE FOR COMPLIANCE WITH APPLICABLE LOCAL, STATE OR FEDERAL LAWS AND REGULATIONS. IF YOU ARE REPRESENTING A DEVELOPER AND/OR A PROPOSED PROJECT THAT WILL REQUIRE A PERMIT, LICENSE OR FUNDING FROM ANY STATE OR FEDERAL AGENCY YOU MUST SUBMIT A PROJECT NOTIFICATION FORM TO MHC FOR MHC'S REVIEW AND COMMENT. You can obtain a copy of a PNF through the MHC web site ([www.sec.state.ma.us/mhc](http://www.sec.state.ma.us/mhc)) under the subject heading "MHC Forms."

Commonwealth of Massachusetts  
Massachusetts Historical Commission  
220 Morrissey Boulevard, Boston, Massachusetts 02125  
[www.sec.state.ma.us/mhc](http://www.sec.state.ma.us/mhc)

This file was accessed on: Friday, October 30, 2020 at 1:49: PM

## FORM B - BUILDING

Assessor's number

USGS Quad

Area(s)

Form Number

Massachusetts Historical Commission  
80 Boylston Street  
Boston, Massachusetts 02116

H9-122

CONCORD

DU

146

CON. 146

LHD. 3/12/02

Town CONCORD

SECT B

Place (neighborhood or village)

Concord CenterAddress 110 Walden StreetOwner Name Timothy Wheeler/Cyrus Stow  
HousePresent dwellingOriginal dwellingPeriod of Construction pre-1750 and 1851-2Style Wheeler; Soc. Circle Memoirs;  
Thoreau survey plan  
Form Greek RevivalArchitect/Builder unknown; (1851--  
possibly Rufus Hosmer)

Exterior Material:

Foundation graniteWall/Trim wood clapboardRoof asphalt shingleOutbuildings/Secondary Structures  
garage

Major Alterations (with dates)

One-story rear wing--late 19th &/or  
early 20th C.; Early 20th: south  
porch; mid-20th: iron fire es-  
cape on south side.Condition excellentMoved ☒ no ☐ yes Date N/AAcreage less than one acreSetting On deep lot with mature trees  
at front. Banked up above road, with  
long, open side yard. Rectangular-picket  
fence with granite posts across front.

## Sketch Map

Draw a map of the area indicating properties within it. Number each property for which individual inventory forms have been completed. Label streets including route numbers, if any. Attach a separate sheet if space is not sufficient here. Indicate North.

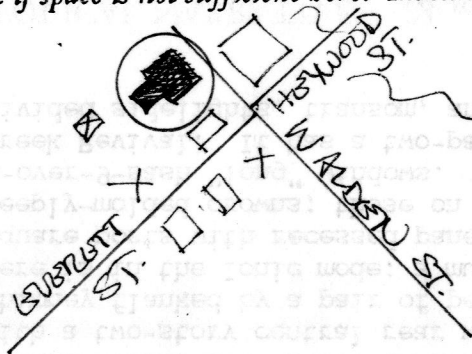

Recorded by Anne Forbes  
research by Cathy Parmelee  
Organization for Concord Hist. Commission

Date (month/day/year) June, 1992

ARCHITECTURAL DESCRIPTION ☒ see continuation sheet

*Describe architectural features. Evaluate the characteristics of this building in terms of other buildings within the community.*

#110 Walden Street is one of Concord center's more spectacular examples of the incorporation of an older house into a larger new one. The early part of this building was a smaller hip-roofed house constructed some time prior to 1750. In the rebuilding process the old frame was lengthened and all its interior finish was removed. Most of the rest of the building is the product of the Greek Revival period, one of Concord's few examples of the high-style "temple-front" house with facade colonnade. Built in 1851-2, it is a 2 1/2-story, five- by four-bay building with a two-story central rear wing. The roof is pierced on each side by a tall chimney flanked by a pair of pedimented dormer windows. The tetrastyle colonnade here is in the Ionic mode; a much later porch along the south side is supported on square posts with recessed panels. The windows are large 6-over-6-sash, with high, deeply-molded crowns; those on the first story facade are typically Greek Revival 6-over-9-sash "long" windows. The center entry is also typical of the high-style Greek Revival. It has a two-panel door with carved ornamentation, full-length divided sidelights, transom, and a projecting lintel. (Cont.)

HISTORICAL NARRATIVE ☒ see continuation sheet

*Discuss the history of the building. Explain its associations with local (or state) history. Include uses of the building, and the role(s) the owners/occupants played within the community.*

This house is highly significant in several periods of Concord's history. Ruth Wheeler's notes indicate its early section may be the house lived in by ca. 1700 by Capt. Joseph Bulkeley, son of Peter Bulkeley, Esq., although her later research (cf. Wheeler House File #W6) suggests that the Bulkeley house stood to the south, on the site of the present #128 Walden Street. In 1726 the property, at least, was sold by the Town of Concord to Timothy Minot, and by him in 1733 to Ebenezer Wheeler, et al. Part of #110 was evidently standing in 1744, when Ebenezer Wheeler gave it to his son, Timothy Wheeler (d. 1796), a miller on the milldam. His nickname "Pond Tim" distinguished him from three other Timothy Wheelers of his time. He is best known for his quick thinking on April 19, 1775 when the British searched his storehouse, where a substantial quantity of provincial stores were hidden. He said many of the barrels contained his own flour, and the search party, not intending to disturb private property, left much of the supply untouched.

In 1777 Timothy Wheeler deeded the house to his son, Peter Wheeler, who later lived and kept a tavern next door at #92 Walden Street. Sometime after his father died he moved back here to live. He died in 1813, and sources conflict as to when the next change in ownership and occupancy took place. (Cont.)

BIBLIOGRAPHY and/or REFERENCES ☒ see continuation sheet

Maps, atlases: 1830; 1852; 1856; 1871; 1875, 1889, 1893, 1906.  
 Keyes/Tolman.  
 Wheeler House File #W5.  
 Jarvis.  
 Shattuck.  
 Gross.  
 Town directories and tax files. (Cont.)

☒ Recommended for listing in the National Register of Historic Places. If checked, you must attach a completed National Register Criteria Statement form.



INVENTORY FORM CONTINUATION SHEET

Community

Property

CONCORD

Wheeler/ Stow House

Massachusetts Historical Commission  
80 Boylston Street  
Boston, Massachusetts 02116

Area(s) Form No.

146

ARCHITECTURAL SIGNIFICANCE, cont.

Other stylish architectural trim includes a molded, boxed cornice with full frieze and architrave, a sillboard, and corner pilasters with recessed panels. It is possible that the master builder for the new house was Rufus Hosmer (see #77/79 Walden Street.) He had done considerable work for Cyrus Stow in the past, and his familiarity with the high-style Greek Revival is illustrated by his execution of the columns for the Concord Bank Building at #46-48 Main Street.

HISTORICAL SIGNIFICANCE, cont.

Ruth Wheeler says that although his family moved to Fitchburg, the old house remained the property of Peter's widow, Phebe Brooks Wheeler, until her death in 1847. The map of 1830 does show "Mrs. P. Wheeler" as the owner of the property. (Some of the family must have remained here, for in about 1830 a daughter, also Phebe Wheeler, was running a small school here. Among her pupils were the young Henry Thoreau and future judge George Merrick Brooks.

Grindall Reynolds writing in the Social Circle Memoirs, however, suggests a different pattern of ownership, saying that brothers Cyrus and Nathan Stow, who had bought #92 in 1813, purchased this adjoining property in 1816. (A copy of deed research in the Wheeler House File indicates they bought it in 1813.) The latter two sources conflict slightly on later transactions: Reynolds says that the Stows owned the Peter Wheeler estate in common until 1852, at which time they divided it, while the deed research indicates that Nathan Stow conveyed his share to Cyrus in 1851.

In any case, by 1852 this property, with the old Timothy Wheeler house on it, was owned and occupied by Cyrus Stow (1787-1876). He may have had the house rebuilt as early as 1851, as a survey done in October of that year by Henry Thoreau shows the present house and re-designed front yard. Thoreau designed the fence here, and is believed to have built it, as well.

Shortly after he moved here Cyrus Stow retired from all business except for the overseeing of his real estate holdings and other investments. He also engaged in considerable philanthropy, much of it for the benefit of the town. In the 1860's he donated the lot for the high school on Stow Street, followed by other generous contributions for the completion of its 1868 building. In his will he left a \$3,000 fund for the benefit of the high school and \$1,000 for the library, and a considerable donation to the Concord's poor. Because of all his contributions to the town, Stow Street is named for him. (Cont.)

## INVENTORY FORM CONTINUATION SHEET

Community

Property

CONCORDWheeler/ Stow House

Massachusetts Historical Commission  
80 Boylston Street  
Boston, Massachusetts 02116

Area(s) Form No.

146

## HISTORICAL SIGNIFICANCE, cont.

In 1878 the property was purchased from Cyrus Stow's estate by George Everett (see #128 Walden Street,) and in 1887 his widow Mary sold it to the town's Home for the Aged, which has been located here ever since. The Home for the Aged was organized in 1886 by the Charitable Society, and its establishment was made possible by a \$20,000 gift from Martha Hunt in memory of her father. The barn (now gone) behind the house was purchased for the town road department in 1891 and moved southwest to Everett Street.

## BIBLIOGRAPHY, cont.

Memoirs of Members of the Social Circle, First and Second Series.

Moss, Marcia, ed. A Catalog of Thoreau's Surveys in the Concord Free Public Library. 1976.

"Vernacular Carpenters."

Untitled sheet of deed research in Wheeler House File.



CON. 146

Massachusetts Historical Commission  
80 Boylston Street  
Boston, Massachusetts 02116

Community  
CONCORD

Property Address  
110 Walden Street

Area(s)	FormNo.
	146

## National Register of Historic Places Criteria Statement Form



Check all that apply:

- ☒ Individually eligible   ☐ Eligible only in a historic district  
☐ Contributing to a potential historic district   ☐ Potential historic district

Criteria:   ☒ A   ☐ B   ☒ C   ☐ D

Criteria Considerations:   ☐ A   ☐ B   ☐ C   ☐ D   ☐ E   ☐ F   ☐ G

Anne McCarthy Forbes

Statement of Significance by \_\_\_\_\_

*The criteria that are checked in the above sections must be justified here.*

This building meets the criteria for individual listing on the National Register for its association with prominent farmer and town benefactor Cyrus Stow, and for its role, continuing since 1887, as the town's Home for the Aged, (Criterion A.) As a well-preserved high-style Greek Revival "temple-front" house, it also meets Criterion C. It possesses integrity of design, location, setting, materials, and workmanship, feeling and association.

1.



ION  
ton  
to:  
the  
de)  
on

2. Town

Area B  
Concord

Street

32 Wadden in HD

Name

Parham Stow

Original Use

Present Use

Present Owner

altered 18+

Date

1842

Style

Greek Rev.

Source of Date

Literature  
Music

Indians  
Development of Town/City

Architect

3. CONDITION: Excellent Good Fair Deteriorated Moved Altered

IMPORTANCE of site to area: Great Little None SITE endangered by

4. DESCRIPTION

FOUNDATION/BASEMENT: High Regular Low

Material: cut stone

WALL COVER: Wood

clapboard

Brick Stone Other

STORIES: 1 2 | 3 4

CHIMNEYS: 1 2 3 4

Center <sup>interior</sup> End Cluster Elaborate Irregular

ATTACHMENTS: Wings Ell Shed Dependency

2 story rear

Simple/Complex

PORCHES: <sup>E side</sup> 1 2 3 4

Portico Balcony 2 story Ionic

Recessed

ROOF: Ridge Gambrel Flat Hip Mansard

Tower Cupola Dormer windows Balustrade Grillwork

FACADE: Gable End: Front/Side Symmetrical/Asymmetrical Simple/Complex Ornament

Entrance: Front/Side Centered Double Features:

side to ground  
transom, lintel, cornice

Windows: Spacing: Regular/Irregular Identical/Varied

cornice over all windows, matches door

Corners: Plain Pilasters Quoins Obscured

OUTBUILDINGS

LANDSCAPING

5. Indicate location of structure on map below

6. Footage of structure from street

Property has \_\_\_\_\_ feet frontage on street

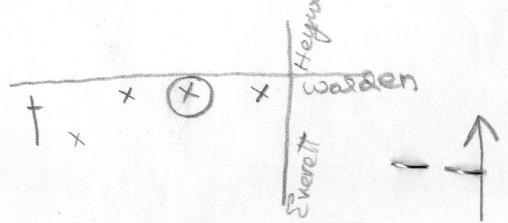

Recorder

For

Photo IV-68-482  
IV-12-483

0.09.065.1.047

NOTE: Recorder should obtain written permission from Commission or sponsoring organization before using this form. (See Reverse Side)



FOR USE WITH IMPORTANT STRUCTURES (Indicate any interior features of note)

Fireplace \_\_\_\_\_

Stairway \_\_\_\_\_

Other \_\_\_\_\_

GIVE A BRIEF DESCRIPTION OF HISTORIC IMPORTANCE OF SITE (Refer and elaborate on theme circled on front of form)

1880s - 1890s -  
Front part of roof raised pillars added  
style four sided 2 1/2 ft. by 2 1/2 ft.

REFERENCE (Where was this information obtained? What book, records, etc.)

Wheeler

## BIBLIOGRAPHY

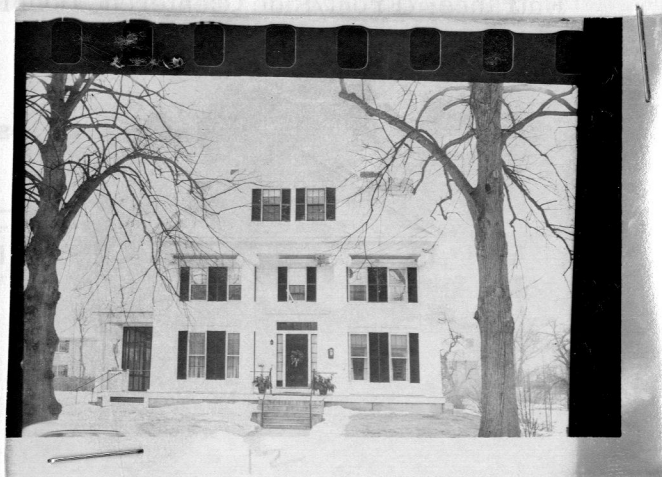

Original Owner: \_\_\_\_\_

Deed Information: Book Number \_\_\_\_\_ Page \_\_\_\_\_, \_\_\_\_\_ Registry of Deeds