

# Massachusetts Cultural Resource Information System

## Scanned Record Cover Page

<b>Inventory No:</b>	CON.39
<b>Historic Name:</b>	Heywood, William - Benjamin, Cyrus House
<b>Common Name:</b>	
<b>Address:</b>	151-153 Main St
<b>City/Town:</b>	Concord
<b>Village/Neighborhood:</b>	Concord Center
<b>Local No:</b>	G9-796
<b>Year Constructed:</b>	1797
<b>Architect(s):</b>	Heywood, William
<b>Architectural Style(s):</b>	Federal
<b>Use(s):</b>	Multiple Family Dwelling House
<b>Significance:</b>	Architecture
<b>Area(s):</b>	CON.DU: Main Street Historic District
<b>Designation(s):</b>	Local Historic District (03/12/1962)
<b>Building Materials(s):</b>	Roof: Asphalt Shingle Wall: Wood; Wood Clapboard Foundation: Granite; Stone, Cut



The Massachusetts Historical Commission (MHC) has converted this paper record to digital format as part of ongoing projects to scan records of the Inventory of Historic Assets of the Commonwealth and National Register of Historic Places nominations for Massachusetts. Efforts are ongoing and not all inventory or National Register records related to this resource may be available in digital format at this time.

The MACRIS database and scanned files are highly dynamic; new information is added daily and both database records and related scanned files may be updated as new information is incorporated into MHC files. Users should note that there may be a considerable lag time between the receipt of new or updated records by MHC and the appearance of related information in MACRIS. Users should also note that not all source materials for the MACRIS database are made available as scanned images. Users may consult the records, files and maps available in MHC's public research area at its offices at the State Archives Building, 220 Morrissey Boulevard, Boston, open M-F, 9-5.

Users of this digital material acknowledge that they have read and understood the MACRIS Information and Disclaimer (<http://mhc-macris.net/macrisdisclaimer.htm>)

Data available via the MACRIS web interface, and associated scanned files are for information purposes only. THE ACT OF CHECKING THIS DATABASE AND ASSOCIATED SCANNED FILES DOES NOT SUBSTITUTE FOR COMPLIANCE WITH APPLICABLE LOCAL, STATE OR FEDERAL LAWS AND REGULATIONS. IF YOU ARE REPRESENTING A DEVELOPER AND/OR A PROPOSED PROJECT THAT WILL REQUIRE A PERMIT, LICENSE OR FUNDING FROM ANY STATE OR FEDERAL AGENCY YOU MUST SUBMIT A PROJECT NOTIFICATION FORM TO MHC FOR MHC'S REVIEW AND COMMENT. You can obtain a copy of a PNF through the MHC web site ([www.sec.state.ma.us/mhc](http://www.sec.state.ma.us/mhc)) under the subject heading "MHC Forms."

Commonwealth of Massachusetts  
Massachusetts Historical Commission  
220 Morrissey Boulevard, Boston, Massachusetts 02125  
[www.sec.state.ma.us/mhc](http://www.sec.state.ma.us/mhc)

This file was accessed on: Friday, October 30, 2020 at 11:18 AM

## FORM B - BUILDING

Assessor's number

USGS Quad

Area(s)

Form Number

Massachusetts Historical Commission  
80 Boylston Street  
Boston, Massachusetts 02116

G9-796

CONCORD

DU

39

Town CONCORDPlace (neighborhood or village) Concord Center

151/153 Main Street

William Heywood House  
Cyrus Benjamin House  
double-house

Present dwelling; double-house

Original

ca. 1797

owner's records;  
visual assessment

Federal period

Form Wm. Heywood, builder

Architect/Builder

Exterior Material: dressed granite

Foundation wood clapboard

Wall/Trim

Roof asphalt shingle

Outbuildings/Secondary Structures shed

Major Alterations (with dates) screened  
porch at southeast rear; 1992: rear  
extension with heavy, paneled chimney.

Condition excellentMoved ☒ no ☐ yes Date N/AAcreage one-half acre

Setting Adjacent to public library  
on south side of Main St. First in line  
of large Federal and Greek Revival resi-  
dences. Long, deep open lot.

## Sketch Map

Draw a map of the area indicating properties within it. Number each property for which individual inventory forms have been completed. Label streets including route numbers, if any. Attach a separate sheet if space is not sufficient here. Indicate North.

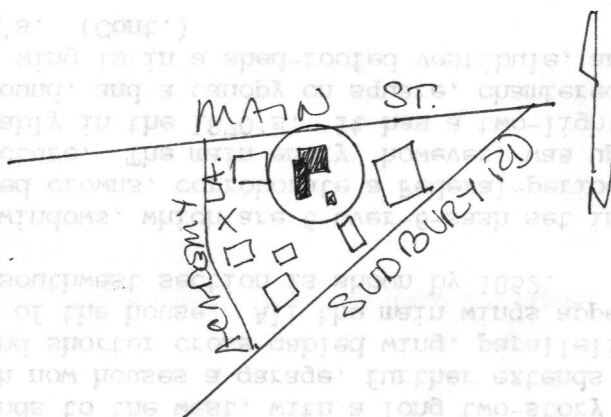

Recorded by Anne Forbes;  
research by Pennie Logemann  
for Concord Hist. Commission

Organization  
Date (month/day/year) June, 1992

ARCHITECTURAL DESCRIPTION ☒ see continuation sheet

*Describe architectural features. Evaluate the characteristics of this building in terms of other buildings within the community.*

Not only is #151/153 Main Street an extremely well-preserved house, it is important as an illustration of the work of one of Concord's many carpenter-builders of the turn of the nineteenth century, William Heywood. It is a 2 1/2-story, five- by two-bay house with a pair of ridge chimneys. A short two-story, two-bay wing extends to the west, with a long two-story rear wing behind it. A one-story ell, which now houses a garage, further extends the extreme length of the rear wing. A second shorter cross-gabled wing, paralleling the first, projects from the southeast rear of the house. All the main wings appear on maps by 1875, and at least some of the southwest section is shown by 1852.

The windows, which are 6-over-6-sash set in projecting frames with heavy, complex-molded crowns, corroborate a Federal-period date of ca. 1790-1800 for the main structure. The main entry, however, was updated during the Italianate period, probably in the 1870's. It has a two-light glass-and-panel door with a molded surround, and a canopy on square, chamfered posts. A second entry in front of the west wing is in a shed-roofed vestibule, and appears to date to the 1830's or 1840's. (Cont.)

HISTORICAL NARRATIVE ☐ see continuation sheet

*Discuss the history of the building. Explain its associations with local (or state) history. Include uses of the building, and the role(s) the owners/occupants played within the community.*

This house is important as the home of two of Concord's builders, William Heywood and his son-in-law, Cyrus Benjamin. William Heywood (1766-1848) was both a cabinetmaker and a housebuilder, and had a shop in his yard. Among the buildings he is known to have had a hand in was the old First Parish Church, which he helped remodel in 1840. His daughter Emeline married Cyrus Benjamin (1807-) in 1837, and they apparently lived here from the time of their marriage, and owned the property after Mr. Heywood's death. Cyrus Benjamin was a mason, and for a while a partner with his brother Thomas of 41 Monument Street. They were also associated with Abner Buttrick and Thomas Ford Hunt, and Cyrus later undertook some profitable real estate ventures, as well. According to Keyes he and his son William each took half the house, added one of the ells, and built a new shop and barn.

Cyrus Benjamin is shown as the owner of this property through at least 1885. William moved to Watertown some time prior to that, and his part of the house was rented out--one of the tenants was a Mrs. Brown, who lived here with her seven daughters. Cyrus moved into his son Cyrus W.'s home on Hubbard Street, and in 1889 #151 is shown under the ownership of "S. Benjamin." (Cont.)

BIBLIOGRAPHY and/or REFERENCES ☐ see continuation sheet

Maps, atlases: 1830, 1852, 1856, ca. 1871, 1875, 1889, 1893, 1906.  
Sanborns from 1897.

Keyes/Tolman.

Wheeler House File #M3.

Town directories and tax files.

Fondiler and Robinson, "Vernacular Carpenters."

Interview with owner, 1992.

☒ Recommended for listing in the National Register of Historic Places. If checked, you must attach a completed National Register Criteria Statement form.



## INVENTORY FORM CONTINUATION SHEET

Community

Property

CONCORDHeywood/Benjamin House

Massachusetts Historical Commission  
80 Boylston Street  
Boston, Massachusetts 02116

Area(s) Form No.

39

## ARCHITECTURAL SIGNIFICANCE, cont.

The latter entry has a 4-panel door flanked by 2/3-length sidelights, and a Greek Revival surround of molded boards with corner blocks. A 1-story polygonal bay window on the east end is probably an addition of the latter part of the nineteenth century. The house was enlarged again in 1897.

An outbuilding formerly on the property, reputed to have been William Heywood's cabinet shop, is said to have been moved just to the east to become the rear wing of the house at #46 Sudbury Road.

## HISTORICAL SIGNIFICANCE, cont.

No one with that initial is listed in directories of the time; it is possible that this is a misprint, and that Cyrus Benjamin still owned the property.

The later nineteenth-century ownership of the property is somewhat unclear. By 1906 it had been acquired by artist Robertson James, who evidently rented it out. In 1893 the tenants were post-office clerk Thomas Drury and Dr. Nathaniel Kirby (who moved to Pennsylvania the next year.) After Mr. James died, the house was inherited by Mrs. Victoria Wood, wife of Richard F. Wood, and they and their family lived there for many years in the early part of this century. The house was apparently inherited by their son, Richard Barrett Wood.

Massachusetts Historical Commission  
80 Boylston Street  
Boston, Massachusetts 02116

Community  
CONCORD

CON. 39  
Property Address  
151 Main Street

Area(s)	FormNo.
	39

## National Register of Historic Places Criteria Statement Form



Check all that apply:

- ☒ Individually eligible   ☐ Eligible only in a historic district  
☒ Contributing to a potential historic district   ☐ Potential historic district

Criteria:   ☒ A   ☐ B   ☒ C   ☐ D

Criteria Considerations:   ☐ A   ☐ B   ☐ C   ☐ D   ☐ E   ☐ F   ☐ G

Anne McCarthy Forbes

Statement of Significance by \_\_\_\_\_  
*The criteria that are checked in the above sections must be justified here.*

This house meets the criteria for individual listing on the National Register and as part of a district of large well-preserved buildings of the late eighteenth- to early nineteenth-centuries at Concord center. For its association with two of Concord's primary builders of the eighteenth- and nineteenth- centuries, it meets Criterion A. As an intact illustration of an <sup>location</sup> early Federal period house, it meets Criterion C. It possesses integrity of design, setting, materials, and workmanship, feeling and association.



CON-39 ✓

# 126

13

Concord

57 Main St

Cyrus Benjamin

al Use

nt Use

nt Owner

private

1800's

Style

e of Date

guess

tect

ed Altered

IMPORTANCE of site to area: Great Little None SITE endangered by

## 4. DESCRIPTION

FOUNDATION/BASEMENT: High Regular Low

Material:

WALL COVER: Wood

Brick Stone Other

STORIES: 1 2 3 4

CHIMNEYS: 1 2 3 4

Center End Cluster Elaborate Irregular

ATTACHMENTS: Wings Ell Shed Dependency

Simple/Complex

PORCHES: 1 2 3 4

Portico Balcony

Recessed

ROOF: Ridge Gambrel Flat Hip Mansard

Tower Cupola Dormer windows Balustrade Grillwork

FACADE: Gable End: Front/Side Symmetrical/Asymmetrical

Simple/Complex

Ornament

Entrance: Front/Side Centered Double Features:

Windows: Spacing: Regular/Irregular Identical/Varied

Corners: Plain Pilasters Quoins Obscured

OUTBUILDINGS

LANDSCAPING

5. Indicate location of structure on map below

6. Footage of structure from street

Property has feet frontage on street

Recorder

For

Photo VII-13  
68-564

omitted from

NOTE: Recorder should obtain written permission from Commission or sponsoring organization before using this form.

map in HD but  
less importance  
(See Reverse Side)no remarkable history  
not remarkable  
architecture

H-36 A3

4

HD

FOR USE WITH IMPORTANT STRUCTURES (Indicate any interior features of note)

Fireplace

Stairway

Other

GIVE A BRIEF DESCRIPTION OF HISTORIC IMPORTANCE OF SITE (Refer and elaborate on theme circled on front of form)

*kept mentally as is in back yard to be used as well as wood*

REFERENCE (Where was this information obtained? What book, records, etc.)

# BIBLIOGRAPHY

Original Owner: \_\_\_\_\_  
 Deed Information: Book Number \_\_\_\_\_ Page \_\_\_\_\_, \_\_\_\_\_ Registry of Deeds