

Massachusetts Cultural Resource Information System

Scanned Record Cover Page

Inventory No:	CON.150
Historic Name:	Derby, Nathan House
Common Name:	
Address:	174 Walden St
City/Town:	Concord
Village/Neighborhood:	Concord Center
Local No:	H9-236
Year Constructed:	r 1835
Architect(s):	
Architectural Style(s):	Second Empire
Use(s):	Agricultural; Single Family Dwelling House; Workers Housing
Significance:	Agriculture; Architecture; Industry
Area(s):	
Designation(s):	
Building Materials(s):	Roof: Asphalt Shingle Wall: Wood; Wood Clapboard Foundation: Brick



The Massachusetts Historical Commission (MHC) has converted this paper record to digital format as part of ongoing projects to scan records of the Inventory of Historic Assets of the Commonwealth and National Register of Historic Places nominations for Massachusetts. Efforts are ongoing and not all inventory or National Register records related to this resource may be available in digital format at this time.

The MACRIS database and scanned files are highly dynamic; new information is added daily and both database records and related scanned files may be updated as new information is incorporated into MHC files. Users should note that there may be a considerable lag time between the receipt of new or updated records by MHC and the appearance of related information in MACRIS. Users should also note that not all source materials for the MACRIS database are made available as scanned images. Users may consult the records, files and maps available in MHC's public research area at its offices at the State Archives Building, 220 Morrissey Boulevard, Boston, open M-F, 9-5.

Users of this digital material acknowledge that they have read and understood the MACRIS Information and Disclaimer (<http://mhc-macris.net/macrisdisclaimer.htm>)

Data available via the MACRIS web interface, and associated scanned files are for information purposes only. THE ACT OF CHECKING THIS DATABASE AND ASSOCIATED SCANNED FILES DOES NOT SUBSTITUTE FOR COMPLIANCE WITH APPLICABLE LOCAL, STATE OR FEDERAL LAWS AND REGULATIONS. IF YOU ARE REPRESENTING A DEVELOPER AND/OR A PROPOSED PROJECT THAT WILL REQUIRE A PERMIT, LICENSE OR FUNDING FROM ANY STATE OR FEDERAL AGENCY YOU MUST SUBMIT A PROJECT NOTIFICATION FORM TO MHC FOR MHC'S REVIEW AND COMMENT. You can obtain a copy of a PNF through the MHC web site (www.sec.state.ma.us/mhc) under the subject heading "MHC Forms."

Commonwealth of Massachusetts
Massachusetts Historical Commission
220 Morrissey Boulevard, Boston, Massachusetts 02125
www.sec.state.ma.us/mhc

This file was accessed on: Friday, October 30, 2020 at 1:50: PM

FORM B - BUILDING

MASSACHUSETTS HISTORICAL COMMISSION
80 BOYLSTON STREET
BOSTON, MA 02116

RECEIVED

PL. CONCORD
USGS - CONCORD
SECT - B

AREA

FORM NO.

150

CONCORD

Address 174 Walden Street

Historic Name Nathan Derby cottage

Present dwelling

Original dwelling

DESCRIPTION

Ca. 1830's and later

Source maps, construction

Style Mansard cottage

Architect unknown

Exterior Wall Fabric clapboard

Outbuildings garage

Major Alterations (with dates)

1-story addition at rear--1981

Condition excellent

Moved no Date N/A

Acreage less than one acre

Setting Opposite woods and

fields, in neighborhood of 18th- and

19th-century houses

Recorded by A. Forbes

Organization Research by Mary Chapman
for Concord Hist. Comm.

Date July, 1990

Sketch Map: Draw map showing property's location
in relation to nearest cross streets and/or
geographical features. Indicate all buildings
between inventoried property and nearest
intersection(s).
Indicate north

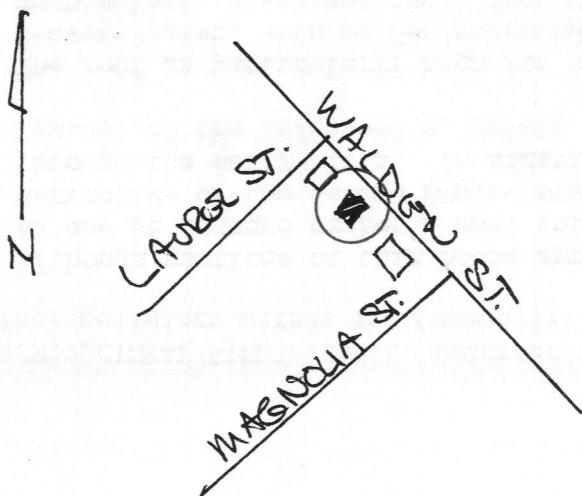

UTM REFERENCE Parcel H9-236

USGS QUADRANGLE

SCALE

NATIONAL REGISTER CRITERIA STATEMENT (if applicable)

For its association with the late nineteenth-century residential development of Concord center, and as a well-preserved example of the architecture of its time, this house meets Criteria A and C as part of a National Register district encompassing a town center of 17th- through early 20th-century buildings.

ARCHITECTURAL SIGNIFICANCE Describe important architectural features and evaluate in terms of other buildings within the community.

Although portions of this house appear to date to ca. 1830-40, it is significant today as one of Concord center's most intact examples of the little Mansard cottage, a modest derivative of the Second Empire style which was fashionable largely from the 1860's through the early '70's. In addition to its style, the brick foundation, which is typical of the 1870's-80's, points to a major rebuilding at that time.

The roof is particularly high for a mansard, with one chimney. The windows are 2-over-2-sash, with molded surrounds; the dormers are flat-roofed. The main entry has a double-leaf, glass-and-panel door with frosted glass, sheltered by a vestibule. The facade veranda, with spindle-work posts, was added after 1921.

HISTORICAL SIGNIFICANCE Explain the role owners played in local or state history and how the building relates to the development of the community.

Although assessor's records, along with framing evidence and the presence of a beehive oven point to a date of ca. 1830-40 for at least part this little house, it is today significant as an example of a type of cottage occupied by farm- and slaughterhouse workers in the latter part of the nineteenth century. Its small lot was originally part of the 17th-century Billings farm, (later the Heywood Farm--see 188 Walden Street,) which was bought by 1852 by John Bent, who farmed the land until about the mid-'50's. Although the 1856 map shows the farm under the name of Clark, it was soon purchased by Nathan Derby, a butcher who ran a slaughterhouse on the property. He appears to have operated a fairly large business, which included general provisions, dairy products, and eggs, with partners, (the company was Derby and Smith in 1875,) salesmen, and other workmen living in at least three houses on the premises. According to Keyes, #174 is the small cottage "fitted up" both for tenants and Derby's workers, probably ca. 1870, a date that would correspond with the style of the house. The property passed to Nathan Derby's brother, Benjamin, in 1896, who sold this house and lot to Augusta Foss, (the Foss family owned the property just to the west,) in 1899. From 1916 to 1921 it was the property of C. Frances Keese, who sold it to Annie M. Hayes, who owned the property until her death in 1961.

BIBLIOGRAPHY and/or REFERENCES

Deed research.
Town directories.
Maps, plans, and atlases: 1852, 1856, 1875, 1889.
Keyes, II/290-1.
Wheeler. Concord, Climate for Freedom.