

Massachusetts Cultural Resource Information System

Scanned Record Cover Page

Inventory No:	CON.123
Historic Name:	Tolman, George House
Common Name:	
Address:	183 Hubbard St
City/Town:	Concord
Village/Neighborhood:	Concord Center; Hubbard Estate Improvement
Local No:	G10-184
Year Constructed:	c 1873
Architect(s):	
Architectural Style(s):	Italianate
Use(s):	Single Family Dwelling House
Significance:	Architecture
Area(s):	
Designation(s):	
Building Materials(s):	Roof: Asphalt Shingle; Slate Wall: Synthetic Other; Wood Foundation: Brick



The Massachusetts Historical Commission (MHC) has converted this paper record to digital format as part of ongoing projects to scan records of the Inventory of Historic Assets of the Commonwealth and National Register of Historic Places nominations for Massachusetts. Efforts are ongoing and not all inventory or National Register records related to this resource may be available in digital format at this time.

The MACRIS database and scanned files are highly dynamic; new information is added daily and both database records and related scanned files may be updated as new information is incorporated into MHC files. Users should note that there may be a considerable lag time between the receipt of new or updated records by MHC and the appearance of related information in MACRIS. Users should also note that not all source materials for the MACRIS database are made available as scanned images. Users may consult the records, files and maps available in MHC's public research area at its offices at the State Archives Building, 220 Morrissey Boulevard, Boston, open M-F, 9-5.

Users of this digital material acknowledge that they have read and understood the MACRIS Information and Disclaimer (<http://mhc-macris.net/macrisdisclaimer.htm>)

Data available via the MACRIS web interface, and associated scanned files are for information purposes only. THE ACT OF CHECKING THIS DATABASE AND ASSOCIATED SCANNED FILES DOES NOT SUBSTITUTE FOR COMPLIANCE WITH APPLICABLE LOCAL, STATE OR FEDERAL LAWS AND REGULATIONS. IF YOU ARE REPRESENTING A DEVELOPER AND/OR A PROPOSED PROJECT THAT WILL REQUIRE A PERMIT, LICENSE OR FUNDING FROM ANY STATE OR FEDERAL AGENCY YOU MUST SUBMIT A PROJECT NOTIFICATION FORM TO MHC FOR MHC'S REVIEW AND COMMENT. You can obtain a copy of a PNF through the MHC web site (www.sec.state.ma.us/mhc) under the subject heading "MHC Forms."

Commonwealth of Massachusetts
Massachusetts Historical Commission
220 Morrissey Boulevard, Boston, Massachusetts 02125
www.sec.state.ma.us/mhc

This file was accessed on: Friday, October 23, 2020 at 1:13: PM

FORM B - BUILDING

Assessor's number

USGS Quad

Area(s)

Form Number

G10-184

CONCORD

123

Massachusetts Historical Commission
80 Boylston Street
Boston, Massachusetts 02116

Town CONCORD

SE 4 B

(neighborhood or village)

Concord CenterAddress 183 Hubbard StreetHistoric Name George Tolman HousePresent dwellingOriginal dwellingDate of Construction ca. 1873-4Assessment Keyes; maps; visual assessmentStyle/Form ItalianateArchitect/Builder Unknown

Exterior Material:

Foundation brickWall/Trim synthetic sidingRoof asphalt shingle and slateOutbuildings/Secondary Structures garage

Major Alterations (with dates) most
windows replaced; some trim removed.

Condition fairMoved ☒ no ☐ yes Date N/AAcreage less than one acreSetting On residential street ofwood-frame houses built 1870'sthrough early 20th century.At corner of Thoreau Street.

Sketch Map

Draw a map of the area indicating properties within it. Number each property for which individual inventory forms have been completed. Label streets including route numbers, if any. Attach a separate sheet if space is not sufficient here. Indicate North.

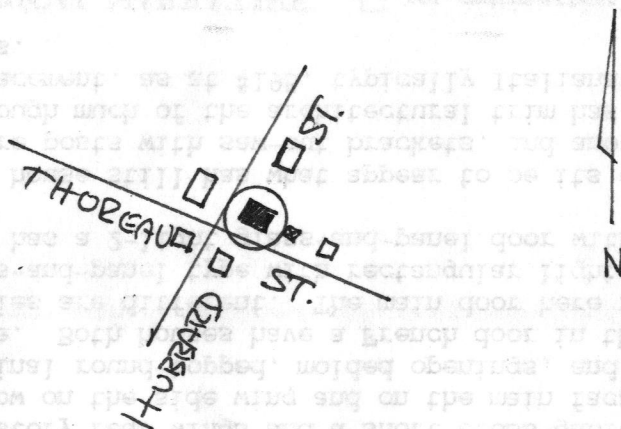
Recorded by A. Forbes; research by Hank SikkemaOrganization for Concord Historical CommissionDate (month/day/year) June, 1991

ARCHITECTURAL DESCRIPTION ☐ *see continuation sheet*

Describe architectural features. Evaluate the characteristics of this building in terms of other buildings within the community.

#183 Hubbard Street, though somewhat less well-preserved than #195 Thoreau, is significant for its overall Italianate form, the retention of considerable detail, and the fact that it and #195 are nearly twins, suggesting that they were both built by the same builder. Both are 2 1/2-story, three-bay "gable-end" side-hall entry houses, with two-story rear wings and a short cross-gabled wing. Both have a 1-story polygonal bay window on the side wing and on the main facade. Here the facade window retains its original round-topped, molded openings, and an arched window remains under the facade gable. Both houses have a French door in the facade of the facade bay, but their main entries are different. The main door here is a typically-Italianate double-leaf glass-and-panel type with rectangular lights. As at #195 Thoreau, an entry in the rear wing has a 2-light glass-and-panel door with a deep bracketed hood.

This house still has what appear to be its original porches--one at the main entry on square posts with saw-cut brackets, and another, on openwork posts, on the west side. Although much of the architectural trim has been lost to synthetic siding and window replacement, as at #195, typically Italianate paired brackets remain at the cornice lines.

HISTORICAL NARRATIVE ☐ *see continuation sheet*

Discuss the history of the building. Explain its associations with local (or state) history. Include uses of the building, and the role(s) the owners/occupants played within the community.

This house appears to have been one of those in the Hubbard Street Improvement that was built by the developers, Rice & Staples. Shown under their names in 1875, it was purchased soon afterward by George Tolman, editor of The New England Farmer, a journal for farmers that was published for much of the nineteenth century. He with the journal until its sale to the owners of The Ploughman, when he retired. Known in Concord as a genealogist and antiquarian after his retirement he turned his talents and attention to his native town. He documented many of the town records and recorded the inscriptions in the burying grounds, and prepared Concord's Vital Records, 1635-1850, for publication. He also devoted much time to the building and collections of the Concord Antiquarian Society. He served on the Board of Selectmen, as well. After his wife died in 1907, he moved to the house of his son Charles on Academy Lane, where he spent his final years.

Although the map of 1906 shows the property under the name of E.W. Aldrich, according to Keyes it was vacant for a time, then sold to Miss Mary Byron, and after some repairs, was occupied by B.L. Filene until 1915. It was then rented by a brother of Mrs. Wilfred Wheeler (see #387 Sudbury Road.)

BIBLIOGRAPHY and/or REFERENCES ☐ *see continuation sheet*

Maps and atlases: 1875, 1889, 1893, 1906. Sanborns from 1903.
Lot #31 on "Hubbard Estate Improvement" Plan, 1872.

Town Directories.
Keyes, II, 467.

☐ Recommended for listing in the National Register of Historic Places. *If checked, you must attach a completed National Register Criteria Statement form.*