

Massachusetts Cultural Resource Information System

Scanned Record Cover Page

Inventory No:	CON.286
Historic Name:	
Common Name:	
Address:	188 Fairhaven Rd
City/Town:	Concord
Village/Neighborhood:	Hubbardville
Local No:	G11-3998
Year Constructed:	1907
Architect(s):	
Architectural Style(s):	No style
Use(s):	Single Family Dwelling House
Significance:	Architecture
Area(s):	
Designation(s):	
Building Materials(s):	Roof: Asphalt Shingle Wall: Wood; Wood Clapboard; Wood Shingle Foundation: Stone, Uncut



The Massachusetts Historical Commission (MHC) has converted this paper record to digital format as part of ongoing projects to scan records of the Inventory of Historic Assets of the Commonwealth and National Register of Historic Places nominations for Massachusetts. Efforts are ongoing and not all inventory or National Register records related to this resource may be available in digital format at this time.

The MACRIS database and scanned files are highly dynamic; new information is added daily and both database records and related scanned files may be updated as new information is incorporated into MHC files. Users should note that there may be a considerable lag time between the receipt of new or updated records by MHC and the appearance of related information in MACRIS. Users should also note that not all source materials for the MACRIS database are made available as scanned images. Users may consult the records, files and maps available in MHC's public research area at its offices at the State Archives Building, 220 Morrissey Boulevard, Boston, open M-F, 9-5.

Users of this digital material acknowledge that they have read and understood the MACRIS Information and Disclaimer (<http://mhc-macris.net/macrisdisclaimer.htm>)

Data available via the MACRIS web interface, and associated scanned files are for information purposes only. THE ACT OF CHECKING THIS DATABASE AND ASSOCIATED SCANNED FILES DOES NOT SUBSTITUTE FOR COMPLIANCE WITH APPLICABLE LOCAL, STATE OR FEDERAL LAWS AND REGULATIONS. IF YOU ARE REPRESENTING A DEVELOPER AND/OR A PROPOSED PROJECT THAT WILL REQUIRE A PERMIT, LICENSE OR FUNDING FROM ANY STATE OR FEDERAL AGENCY YOU MUST SUBMIT A PROJECT NOTIFICATION FORM TO MHC FOR MHC'S REVIEW AND COMMENT. You can obtain a copy of a PNF through the MHC web site (www.sec.state.ma.us/mhc) under the subject heading "MHC Forms."

Commonwealth of Massachusetts
Massachusetts Historical Commission
220 Morrissey Boulevard, Boston, Massachusetts 02125
www.sec.state.ma.us/mhc

This file was accessed on: Friday, October 23, 2020 at 12:45 PM

FORM B - BUILDING

Assessor's number

USGS Quad

Area(s)

Form Number

Massachusetts Historical Commission
80 Boylston Street
Boston, Massachusetts 02116

G11-3998

CONCORD

286

Town CONCORDPlace (neighborhood or village) HubbardvilleAddress 188 Fairhaven Road

Historic Name _____

Present dwellingOriginal dwellingDate of Construction ca. 1907-8.Evidence visual evidence; neighborsStyle/Form astylisticArchitect/Builder unknown

Exterior Material: _____

Foundation rubbleWall/Trim wood clapboard
and shingleRoof asphalt shingle

Outbuildings/Secondary Structures _____

early 20th-century garage

Major Alterations (with dates) _____

noneCondition goodMoved ☒ no ☐ yes Date N/AAcreage 1.9 acresSetting At southwest corner of Fairhaven and Route 2. Brush andswamp to rear, woods to south.

Sketch Map

Draw a map of the area indicating properties within it. Number each property for which individual inventory forms have been completed. Label streets including route numbers, if any. Attach a separate sheet if space is not sufficient here. Indicate North.

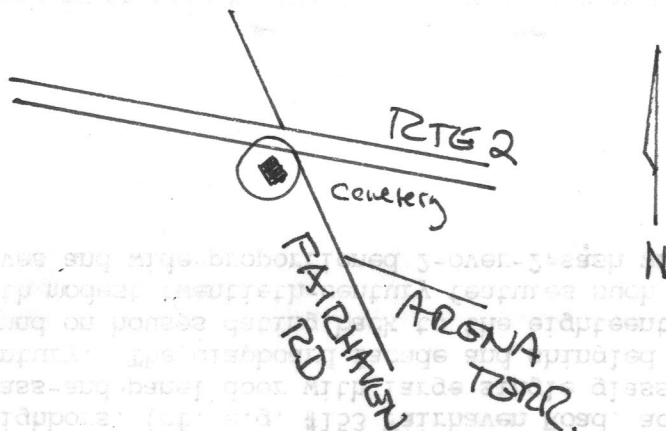

Recorded by A. Forbes
research by Cathy Parmelee

Organization for Concord Hist. Commission

Date (month/day/year) June, 1991

ARCHITECTURAL DESCRIPTION ☐ see continuation sheet

Describe architectural features. Evaluate the characteristics of this building in terms of other buildings within the community.

Although built at the turn of the twentieth century, this little three-bay two-story house follows a few traditions linking it with New England farmhouses of earlier times. Its main entry is through a 1-story pitch-roofed vestibule at the center facade, reminiscent of the eighteenth- and early-nineteenth-century "porches" of some of its neighbors, (cf. e.g. #153 Fairhaven Road, across Route 2.) The door here, however, is a glass-and-panel door with large single glass light, typical of the first part of this century. The clapboard facade and shingled end walls are an economical measure to be found on houses dating back to the eighteenth century, although they are combined here with modest twentieth-century features such as the rubble stone foundation, unboxed eaves and wide-proportioned 2-over-2-sash windows.

HISTORICAL NARRATIVE ☐ see continuation sheet

Discuss the history of the building. Explain its associations with local (or state) history. Include uses of the building, and the role(s) the owners/occupants played within the community.

188 Fairhaven Road is illustrative of the way many houses and real estate were owned and used on some of the larger farms in Concord early in the 1900's. At the turn of the century its lot was part of the property at #154 Fairhaven Road (see the "Pest House", NR,) an early-eighteenth-century Potter family farm which was then owned by Elisha S. Develley (Dwelley,) who operated it as a hen farm until about 1907. It was then acquired by farmer George F. Wheeler (see 25/27 Fairhaven Road,) who rented the old Potter farmhouse out to tenants. It was he who had #188 built, probably as a rental house for workers on his large Hubbardville farm.

Names associated with the house either as tenants or later owners include Alpheus Nickerson, Moreau, Shaughnessy, and Keese. Mrs. Keese was the daughter of the Shaughnessys, and according to former neighbors, she and her husband bought the house from Mr. Wheeler or his heirs.

BIBLIOGRAPHY and/or REFERENCES ☐ see continuation sheet

Keyes., 448.

Interviews with neighbors and owner 3/91, 4/91.
Town directories.

☐ Recommended for listing in the National Register of Historic Places. *If checked, you must attach a completed National Register Criteria Statement form.*