

Massachusetts Cultural Resource Information System

Scanned Record Cover Page

Inventory No:	CON.56
Historic Name:	Thoreau - Alcott House
Common Name:	
Address:	255 Main St
City/Town:	Concord
Village/Neighborhood:	Concord Center
Local No:	30
Year Constructed:	c 1820
Architect(s):	Davis, Josiah
Architectural Style(s):	Federal
Use(s):	Shop Other; Single Family Dwelling House
Significance:	Architecture; Literature; Social History
Area(s):	CON.DU: Main Street Historic District
Designation(s):	Local Historic District (03/12/1962); Nat'l Register Individual Property (07/12/1976)
Building Materials(s):	Roof: Asphalt Shingle Wall: Wood; Wood Clapboard Foundation: Stone, Uncut



The Massachusetts Historical Commission (MHC) has converted this paper record to digital format as part of ongoing projects to scan records of the Inventory of Historic Assets of the Commonwealth and National Register of Historic Places nominations for Massachusetts. Efforts are ongoing and not all inventory or National Register records related to this resource may be available in digital format at this time.

The MACRIS database and scanned files are highly dynamic; new information is added daily and both database records and related scanned files may be updated as new information is incorporated into MHC files. Users should note that there may be a considerable lag time between the receipt of new or updated records by MHC and the appearance of related information in MACRIS. Users should also note that not all source materials for the MACRIS database are made available as scanned images. Users may consult the records, files and maps available in MHC's public research area at its offices at the State Archives Building, 220 Morrissey Boulevard, Boston, open M-F, 9-5.

Users of this digital material acknowledge that they have read and understood the MACRIS Information and Disclaimer (<http://mhc-macris.net/macrisdisclaimer.htm>)

Data available via the MACRIS web interface, and associated scanned files are for information purposes only. THE ACT OF CHECKING THIS DATABASE AND ASSOCIATED SCANNED FILES DOES NOT SUBSTITUTE FOR COMPLIANCE WITH APPLICABLE LOCAL, STATE OR FEDERAL LAWS AND REGULATIONS. IF YOU ARE REPRESENTING A DEVELOPER AND/OR A PROPOSED PROJECT THAT WILL REQUIRE A PERMIT, LICENSE OR FUNDING FROM ANY STATE OR FEDERAL AGENCY YOU MUST SUBMIT A PROJECT NOTIFICATION FORM TO MHC FOR MHC'S REVIEW AND COMMENT. You can obtain a copy of a PNF through the MHC web site (www.sec.state.ma.us/mhc) under the subject heading "MHC Forms."

Commonwealth of Massachusetts
Massachusetts Historical Commission
220 Morrissey Boulevard, Boston, Massachusetts 02125
www.sec.state.ma.us/mhc

This file was accessed on: Friday, October 30, 2020 at 11:22 AM



CON. 56 *Area B* HD 56 30
wn *Concord* NE 7.12.76
reet *255* *Main St.* bet. Thoreau *Bellrap*
me *Thoreau-Alcott House*
iginal Use *AREA DU - LHT 3/12/62*
esent Use *PI. CONCORD SECT - B*
esent Owner *private*
te *1700's* Style *R. Wheeler 1819-1830 - Concord H.C.*
rce of Date *CAB*
chitect

3. CONDITION: Excellent Good Fair Deteriorated Moved Altered
IMPORTANCE of site to area: Great Little None SITE endangered by

4. DESCRIPTION

FOUNDATION/BASEMENT: High Regular Low Material:
WALL COVER: Wood clapboard Brick Stone Other
STORIES: 1 2 3 4 CHIMNEYS: 1 2 3 4 Center End Cluster Elaborate Irregular
ATTACHMENTS: Wings Ell Shed Dependency 2 story wing w 2 story Simple/Complex
PORCHES: 1 2 3 4 Portico Balcony Recessed
ROOF: Ridge Gambrel Flat Hip Mansard
Tower Cupola Dormer windows Balustrade Grillwork
FACADE: Gable End: Front/Side Symmetrical/Asymmetrical Simple/Complex Ornament
Entrance: Front/Side Centered Double Features:
Windows: Spacing: Regular/Irregular Identical/Varied 6/6
Corners: Plain Pilasters Quoins Obscured cornerboard

OUTBUILDINGS LANDSCAPING

5. Indicate location of structure on map below main
6. Footage of structure from street 15
Property has feet frontage on street

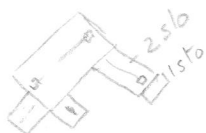

see Area

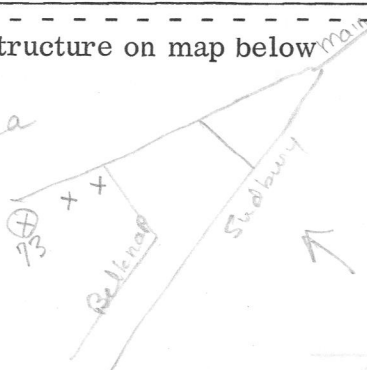

Recorder

For

Photo VII-19
68-570

E.09.065.1.030

NOTE: Recorder should obtain written permission from Commission or sponsoring organization before using this form. (See Reverse Side)

Nat'l Historic Landmark

FOR USE WITH IMPORTANT STRUCTURES (Indicate any interior features of note)

Fireplace

Stairway

Other

GIVE A BRIEF DESCRIPTION OF HISTORIC IMPORTANCE OF SITE (Refer and elaborate on theme circled on front of form)

?? Poet Ellery Channing died here - (according to "The Story of Concord" Channing spent last few years of life with Sauborn)
* Thoreau died here 1862 - lived here last 10 yrs of life
Alcott sisters bought house 1876
Mrs Alcott died here 1877; occupied by Louisa and father short time after Mrs A's death

REFERENCE (Where was this information obtained? What book, records, etc.)

* The Story of Concord - J.L. Swayne

BIBLIOGRAPHY

Original Owner: _____
Deed Information: Book Number _____ Page _____, _____ Registry of Deeds