

Massachusetts Cultural Resource Information System

Scanned Record Cover Page

Inventory No:	CON.62
Historic Name:	Walcott, Henry J. House
Common Name:	
Address:	340 Main St
City/Town:	Concord
Village/Neighborhood:	Concord Center
Local No:	G9-1717
Year Constructed:	c 1870
Architect(s):	
Architectural Style(s):	Victorian Eclectic
Use(s):	Multiple Family Dwelling House; Single Family Dwelling House
Significance:	Architecture
Area(s):	CON.DU: Main Street Historic District
Designation(s):	Local Historic District (03/12/1962)
Building Materials(s):	Roof: Asphalt Shingle Wall: Stucco; Wood Foundation: Granite; Stone, Cut



The Massachusetts Historical Commission (MHC) has converted this paper record to digital format as part of ongoing projects to scan records of the Inventory of Historic Assets of the Commonwealth and National Register of Historic Places nominations for Massachusetts. Efforts are ongoing and not all inventory or National Register records related to this resource may be available in digital format at this time.

The MACRIS database and scanned files are highly dynamic; new information is added daily and both database records and related scanned files may be updated as new information is incorporated into MHC files. Users should note that there may be a considerable lag time between the receipt of new or updated records by MHC and the appearance of related information in MACRIS. Users should also note that not all source materials for the MACRIS database are made available as scanned images. Users may consult the records, files and maps available in MHC's public research area at its offices at the State Archives Building, 220 Morrissey Boulevard, Boston, open M-F, 9-5.

Users of this digital material acknowledge that they have read and understood the MACRIS Information and Disclaimer (<http://mhc-macris.net/macrisdisclaimer.htm>)

Data available via the MACRIS web interface, and associated scanned files are for information purposes only. THE ACT OF CHECKING THIS DATABASE AND ASSOCIATED SCANNED FILES DOES NOT SUBSTITUTE FOR COMPLIANCE WITH APPLICABLE LOCAL, STATE OR FEDERAL LAWS AND REGULATIONS. IF YOU ARE REPRESENTING A DEVELOPER AND/OR A PROPOSED PROJECT THAT WILL REQUIRE A PERMIT, LICENSE OR FUNDING FROM ANY STATE OR FEDERAL AGENCY YOU MUST SUBMIT A PROJECT NOTIFICATION FORM TO MHC FOR MHC'S REVIEW AND COMMENT. You can obtain a copy of a PNF through the MHC web site (www.sec.state.ma.us/mhc) under the subject heading "MHC Forms."

Commonwealth of Massachusetts
Massachusetts Historical Commission
220 Morrissey Boulevard, Boston, Massachusetts 02125
www.sec.state.ma.us/mhc

This file was accessed on: Friday, October 30, 2020 at 11:24 AM

FORM B - BUILDING

Assessor's number

USGS Quad

Area(s)

Form Number

Massachusetts Historical Commission
80 Boylston Street
Boston, Massachusetts 02116

G9-1717

CONCORD

DU

62

Town

CONCORD

Sect B

(neighborhood or village)

Concord center

ss

340 Main Street

ic Name

Henry J. Walcott House

Present

dwelling

Original

dwelling

of Construction

early 1870's

e maps; visual assessment; Keyes

Form

eclectic/High Victorian
Gothic

ect/Builder

unknown



Sketch Map

Draw a map of the area indicating properties within it. Number each property for which individual inventory forms have been completed. Label streets including route numbers, if any. Attach a separate sheet if space is not sufficient here. Indicate North.

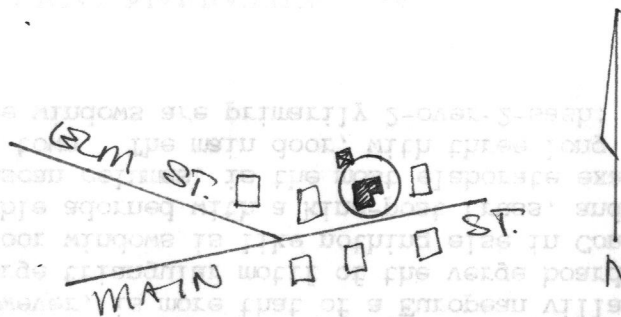

Exterior Material:

Foundation

dressed granite

Wall/Trim

stucco

Roof

asphalt shingle

Outbuildings/Secondary Structures

none

Major Alterations (with dates)

ca. 1967:

garage and ell at rear NW; screened porch on NE; some window alteration.

Condition

good

Moved ☒ no ☐ yes

Date N/A

Acreage

less than one acre

Setting

In residential district of 18th to 19th-century houses. Deep, open, landscaped lot backs up to river. High-board fence on east, deciduous hedge across front.

Recorded by

A. Forbes
research by Carla Garbarino
for Concord Hist. Commission

Organization

June, 1992

Date (month/day/year)

BUILDING FORM

CON-62

ARCHITECTURAL DESCRIPTION ☐ see continuation sheet

Describe architectural features. Evaluate the characteristics of this building in terms of other buildings within the community.

The earliest of several stucco houses at Concord center, this is a stylish, eclectic house with some of the European-inspired characteristics that were popular in the early 1870's. It is a tall 2 1/2-story building, with a central chimney and a narrow gabled "pavilion" at the center of the facade. A two-story wing projects to the rear, a two-story polygonal bay window on the east end wall, and a one-story bay window on the west. The architectural details here reflect a variety of sources. There is a hint of the later Gothic Revival in the pointed- and truncated-arched windows of the second story and in the prominent verge boarding at the gable ends. The overall feeling, however, is more that of a European villa with highly individualized ornament. The large triangular motif of the verge boarding and of the saw-cut pendants over the first floor windows is like nothing else in Concord. The center entry porch, with a stuccoed gable adorned with a king-post truss, and with a doweled frieze screen and half-height Tuscan columns, is the most elaborate example of a type found on only a few other houses in town. The main door, with three long-over three short panels, is also unusual here. The windows are primarily 2-over-2-sash; the roof eaves are unboxed.

HISTORICAL NARRATIVE ☒ see continuation sheet

Discuss the history of the building. Explain its associations with local (or state) history. Include uses of the building, and the role(s) the owners/occupants played within the community.

Like many of its neighbors, #340 Main Street was originally the home of a Milldam businessman. Although Keyes says the house was built in 1875 by Henry Joel Walcott, the Social Circle Memoirs put it as early as 1870. It remained in the Walcott family until at least 1915. Henry J. Walcott (1846-1909) was a prominent Concord native, member of the Social Circle, and holder of many public offices. As a youth he helped out in his father's grocery store on the Milldam, then after taking courses from a "commercial college" in Boston, he worked at Albert Stacy's store at the corner of Walden and Main. He then spent a few years as a partner with James C. Melvin in a "cent shop" in the second floor of 39 Main Street. After the Concord National Bank was robbed in 1865, he was appointed assistant cashier of both the National Bank and the Middlesex Institution for Savings, which shared the same room in the "old bank building" at 46/48 Main Street. In 1869, at the age of 25, he succeeded John Cheney as cashier, and probably had this house built shortly afterward. (Cont.)

BIBLIOGRAPHY and/or REFERENCES ☐ see continuation sheet

Maps, atlases: 1875, 1889, 1893, 1906. Sanborns from 1903.
Keyes/Tolman "Houses in Concord." 1885; rev. 1915 and 1920's.
Town Directories and tax lists.
Social Circle Memoirs. IV.

☒ Recommended for listing in the National Register of Historic Places. If checked, you must attach a completed National Register Criteria Statement form.

INVENTORY FORM CONTINUATION SHEET

Community

Property

CONCORDHenry J. Walcott House

Massachusetts Historical Commission
80 Boylston Street
Boston, Massachusetts 02116

Area(s) Form No.

62

HISTORICAL SIGNIFICANCE, cont.

Henry Walcott married Ellen (Shepard) Johnson, and between 1883 and 1888 they lived in New York, where he managed the firm of Christy, Shepard & Garrett, which Mrs. Walcott had inherited from her brother. The company was the largest wallpaper manufacturer in the country, and after Mr. Walcott's arrival it became Christy, Walcott, & Co. While in New York the Walcotts rented out this house. Among the tenants were Mr. Walcott's sister, Mrs. J.D. Brown, Jr. and Orlando Underhill.

After the Walcotts returned to Concord, and Henry went into business with C. Brigham Co., a milk distributing firm which collected milk along the Boston & Albany Railroad line to sell to Boston dealers. Another partner in the company was his neighbor at #12 Elm Street, Alonzo Tower. Mr. and Mrs. Walcott spent their winters in Boston during this period, and for at least part of the time rented the house to Berkley Johnson. Mr. Walcott retired from business in 1908. His wife survived him, and after his death his son, Dr. Henry J. Walcott, Jr., returned to Concord from Springfield and lived in the house for many years.

H. J. Walcott, Sr. held several town offices, including Town Treasurer, Water Commissioner, and Trustee of the library.

Massachusetts Historical Commission
80 Boylston Street
Boston, Massachusetts 02116

Community
CONCORD

Property Address
340 Main Street

Area(s)	FormNo.
	62

National Register of Historic Places Criteria Statement Form



Check all that apply:

- ☒ Individually eligible ☐ Eligible only in a historic district
☒ Contributing to a potential historic district ☐ Potential historic district

Criteria: ☒ A ☐ B ☒ C ☐ D

Criteria Considerations: ☐ A ☐ B ☐ C ☐ D ☐ E ☐ F ☐ G

Anne McCarthy Forbes

Statement of Significance by _____

The criteria that are checked in the above sections must be justified here.

This house meets the criteria for individual listing on the National Register and as part of a district of well-preserved buildings of the late eighteenth- to nineteenth-centuries at Concord center. As the home of bank cashier and prominent businessman Henry J. Walcott, it qualifies under Criterion A. As a unique example in Concord of this type of eclectic/High Victorian Gothic house, it also meets Criterion C. It possesses integrity of design, location, setting, materials, workmanship, feeling and association.