

Massachusetts Cultural Resource Information System

Scanned Record Cover Page

Inventory No:	CON.422
Historic Name:	Wheeler, Francis House
Common Name:	
Address:	350 Fitchburg Tpk
City/Town:	Concord
Village/Neighborhood:	Nine Acre Corner
Local No:	F15-3440
Year Constructed:	r 1775
Architect(s):	
Architectural Style(s):	Colonial; Federal
Use(s):	Agricultural; Single Family Dwelling House
Significance:	Agriculture; Architecture
Area(s):	CON.AT: Nine Acre Corner
Designation(s):	
Building Materials(s):	Roof: Slate Wall: Wood; Wood Clapboard Foundation: Granite; Stone, Cut



The Massachusetts Historical Commission (MHC) has converted this paper record to digital format as part of ongoing projects to scan records of the Inventory of Historic Assets of the Commonwealth and National Register of Historic Places nominations for Massachusetts. Efforts are ongoing and not all inventory or National Register records related to this resource may be available in digital format at this time.

The MACRIS database and scanned files are highly dynamic; new information is added daily and both database records and related scanned files may be updated as new information is incorporated into MHC files. Users should note that there may be a considerable lag time between the receipt of new or updated records by MHC and the appearance of related information in MACRIS. Users should also note that not all source materials for the MACRIS database are made available as scanned images. Users may consult the records, files and maps available in MHC's public research area at its offices at the State Archives Building, 220 Morrissey Boulevard, Boston, open M-F, 9-5.

Users of this digital material acknowledge that they have read and understood the MACRIS Information and Disclaimer (<http://mhc-macris.net/macrisdisclaimer.htm>)

Data available via the MACRIS web interface, and associated scanned files are for information purposes only. THE ACT OF CHECKING THIS DATABASE AND ASSOCIATED SCANNED FILES DOES NOT SUBSTITUTE FOR COMPLIANCE WITH APPLICABLE LOCAL, STATE OR FEDERAL LAWS AND REGULATIONS. IF YOU ARE REPRESENTING A DEVELOPER AND/OR A PROPOSED PROJECT THAT WILL REQUIRE A PERMIT, LICENSE OR FUNDING FROM ANY STATE OR FEDERAL AGENCY YOU MUST SUBMIT A PROJECT NOTIFICATION FORM TO MHC FOR MHC'S REVIEW AND COMMENT. You can obtain a copy of a PNF through the MHC web site (www.sec.state.ma.us/mhc) under the subject heading "MHC Forms."

Commonwealth of Massachusetts
Massachusetts Historical Commission
220 Morrissey Boulevard, Boston, Massachusetts 02125
www.sec.state.ma.us/mhc

This file was accessed on: Friday, October 23, 2020 at 12:47 PM

FORM B - BUILDING

MASSACHUSETTS HISTORICAL COMMISSION
80 BOYLSTON STREET
BOSTON, MA 02116

PL. NINE AVE
USGS. MAYNARD
SECT-B

AREA

FORM NO.

AT

422



Sketch Map: Draw map showing property's location in relation to nearest cross streets and/or geographical features. Indicate all buildings between inventoried property and nearest intersection(s). Indicate north

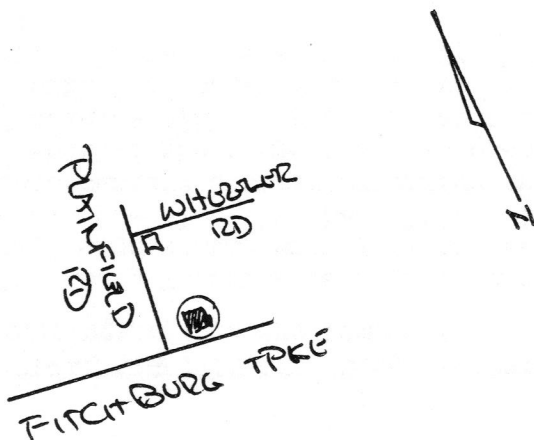

CONCORD

350 Fitchburg Turnpike

Historic Name Francis & Noah Wheeler House

Present dwelling

Original dwelling

DESCRIPTION

Ca. 1770's

deeds, style,

Second Period

Architect unknown

Exterior Wall Fabric clapboard

Outbuildings garage, shed, barn

Major Alterations (with dates) picture

windows, E. and W. ends; modern door

Condition good

Moved no Date N/A

Acreage 7.9 acres

Setting On main road, (Rte

117,) at corner of Plainfield Rd.

Opp. golf course; fields to E.

Picket fenced and hedged yard.

Recorded by A. Forbes

Organization Research by Tillie Sweet
for Concord Hist. Comm.

Date July, 1990

UTM REFERENCE Parcel F15-3440

USGS QUADRANGLE

SCALE

NATIONAL REGISTER CRITERIA STATEMENT (if applicable)

ARCHITECTURAL SIGNIFICANCE Describe important architectural features and evaluate in terms of other buildings within the community.

#350 Fitchburg Turnpike is significant as one of Nine Acre Corner's 2 1/2-story, five-bay, eighteenth-century farmhouses. Here it displays the paired rear chimneys that had become prevalent by the 1770's. It has a two-story rear wing with a twentieth-century 1-story extension on its east end, and a two-story leanto on the west. Most of the house trim is intact, consisting of narrow corner boards and a boxed, molded cornice with no overhang at the gable ends. Windows are 6-over-6-sash. The main entry, with 2/3-length sidelights, narrow, paneled pilasters, and high frieze with projecting lintel, dates to the Greek Revival period. The foundation is dressed granite.

HISTORICAL SIGNIFICANCE Explain the role owners played in local or state history and how the building relates to the development of the community.

This house appears to have been built just prior to the Revolution, for Francis and/or Noah Wheeler, of the large Wheeler family which had farmed much of the land in the Nine Acre Corner area since the seventeenth century. (Francis and Noah were half-brothers, sons of Francis Wheeler, and thus grandsons of William Wheeler, and great-grandsons of George Wheeler.) Francis, (1728-1778,) was apparently killed in the Revolution, but Noah, (1749-1834,) appears to have lived here until his death. The "N. Wheeler" shown here in 1852 is undoubtedly Noah's son, also Noah Wheeler, (b. 1778.)

The property had passed to George Wheeler by 1856. Alice Wheeler, George's wife, was one of the first women elected to the school committee in Concord. After George's death, his daughter Hattie (Harriet) Wheeler sold the property to Harry Brigham in 1905. After World War I it was owned first by Carlson and Pearson, then Pearson alone until sold to Leslie O. Anderson in 1929, who owned it until 1942. Through most of the 1940's the property was farmed by the d'Arrigo brothers.

BIBLIOGRAPHY and/or REFERENCES

Interview with owner, 1990
 Town directories.
 Maps, plans, and atlases: 1830, 1852, 1856, 1875, 1889, 1893, 1906.
 Keyes.
 (See Area Form bibliography.)



CON. 422 no history ✓
Town Concord
Sheet 350
Plainfield + Rt 117
Name ~~Bone~~ Ruzic
Original Use dwelling
Present Use dwelling
Present Owner private Ruzic
Rev. war Style
Date of Date R. Wheeler
Architect

3. CONDITION: Excellent Good Fair Deteriorated Moved Altered _____

IMPORTANCE of site to area: Great Little None SITE endangered by _____

4. DESCRIPTION

FOUNDATION/BASEMENT: High Regular Low Material: cut stone

WALL COVER: Wood clapboard Brick Stone Other _____

STORIES: 1 2 3 4 CHIMNEYS: 1 2 3 4 Center End int. balcony roof ridge Cluster Elaborate Irregular

ATTACHMENTS: Wings Ell Shed Dependency _____ Simple/Complex

PORCHES: 1 2 3 4 Portico Balcony _____ Recessed _____

ROOF: Ridge Gambrel Flat Hip Mansard
Tower Cupola Dormer windows Balustrade Grillwork _____

FACADE: Gable End: Front/Side Symmetrical/Asymmetrical Simple/Complex Ornament

Entrance: Front/Side Centered Double Features: entab + cornice

Windows: Spacing: Regular/Irregular Identical/Varied 9/9

Corners: Plain Pilasters Quoins Obscured cornerboard

OUTBUILDINGS _____ LANDSCAPING _____

5. Indicate location of structure on map below 6. Footage of structure from street 25'
Property has _____ feet frontage on street

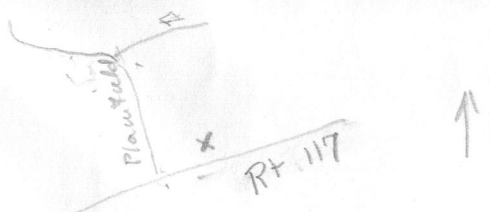

Recorder _____

For _____

Photo VIII-19
68-600
E.09.065.1.001

NOTE: Recorder should obtain written permission from Commission or sponsoring organization before using this form. (See Reverse Side)

FOR USE WITH IMPORTANT STRUCTURES (Indicate any interior features of note)

Fireplace

Stairway

Other

GIVE A BRIEF DESCRIPTION OF HISTORIC IMPORTANCE OF SITE (Refer and elaborate on theme circled on front of form)

Wheeler, Brigham

REFERENCE (Where was this information obtained? What book, records, etc.)

BIBLIOGRAPHY

Original Owner: _____
Deed Information: Book Number _____ Page _____, _____ Registry of Deeds