

Massachusetts Cultural Resource Information System

Scanned Record Cover Page

Inventory No:	CON.420
Historic Name:	Wheeler, Joel and Alvah G. House
Common Name:	
Address:	415 Plainfield Rd 167 Wheeler Rd
City/Town:	Concord
Village/Neighborhood:	Nine Acre Corner
Local No:	E15-3441
Year Constructed:	c 1835
Architect(s):	
Architectural Style(s):	Greek Revival
Use(s):	Agricultural; Dairy; Single Family Dwelling House
Significance:	Agriculture; Architecture
Area(s):	CON.AT: Nine Acre Corner
Designation(s):	
Building Materials(s):	Roof: Asphalt Shingle Wall: Wood; Wood Clapboard; Wood Flushboard Foundation: Granite; Stone, Cut; Stone, Uncut



The Massachusetts Historical Commission (MHC) has converted this paper record to digital format as part of ongoing projects to scan records of the Inventory of Historic Assets of the Commonwealth and National Register of Historic Places nominations for Massachusetts. Efforts are ongoing and not all inventory or National Register records related to this resource may be available in digital format at this time.

The MACRIS database and scanned files are highly dynamic; new information is added daily and both database records and related scanned files may be updated as new information is incorporated into MHC files. Users should note that there may be a considerable lag time between the receipt of new or updated records by MHC and the appearance of related information in MACRIS. Users should also note that not all source materials for the MACRIS database are made available as scanned images. Users may consult the records, files and maps available in MHC's public research area at its offices at the State Archives Building, 220 Morrissey Boulevard, Boston, open M-F, 9-5.

Users of this digital material acknowledge that they have read and understood the MACRIS Information and Disclaimer (<http://mhc-macris.net/macrisdisclaimer.htm>)

Data available via the MACRIS web interface, and associated scanned files are for information purposes only. THE ACT OF CHECKING THIS DATABASE AND ASSOCIATED SCANNED FILES DOES NOT SUBSTITUTE FOR COMPLIANCE WITH APPLICABLE LOCAL, STATE OR FEDERAL LAWS AND REGULATIONS. IF YOU ARE REPRESENTING A DEVELOPER AND/OR A PROPOSED PROJECT THAT WILL REQUIRE A PERMIT, LICENSE OR FUNDING FROM ANY STATE OR FEDERAL AGENCY YOU MUST SUBMIT A PROJECT NOTIFICATION FORM TO MHC FOR MHC'S REVIEW AND COMMENT. You can obtain a copy of a PNF through the MHC web site (www.sec.state.ma.us/mhc) under the subject heading "MHC Forms."

Commonwealth of Massachusetts
Massachusetts Historical Commission
220 Morrissey Boulevard, Boston, Massachusetts 02125
www.sec.state.ma.us/mhc

This file was accessed on: Friday, October 30, 2020 at 1:03: PM

FORM B - BUILDING

Assessor's number

USGS Quad

Area(s)

Form Number

Massachusetts Historical Commission
80 Boylston Street
Boston, Massachusetts 02116

E15-3441

MAYNARD

AT

420



Town

CONCORD

SECT B

Neighborhood or village)

Nine Acre Corner

P9

415 Plainfield Road/
167 Wheeler Road

ic Name Joel and Alvah Wheeler
House

Present dwelling

Original dwelling

of Construction ca. 1835

Wheeler family records

Form Greek Revival

ect/Builder unknown

Sketch Map

Draw a map of the area indicating properties within it. Number each property for which individual inventory forms have been completed. Label streets including route numbers, if any. Attach a separate sheet if space is not sufficient here. Indicate North.

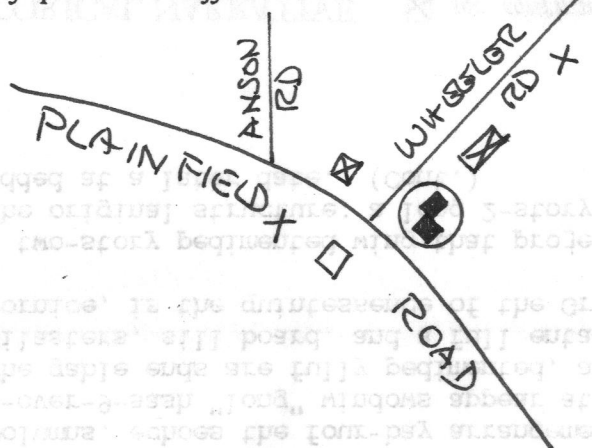

Exterior Material:

Foundation dressed granite, with rubble

Wall/Trim wood clapboard and flushboard

Roof asphalt shingle

Outbuildings/Secondary Structures ~~converted~~
barn with long l-s barn extension,
~~shed, modern barn, modern house~~

Major Alterations (with dates) early 20th

NC: rubble terrace under colonnade, oval-light door with hip-rf. hood, W. end. Hip rf. encl. porch, NW corner w. glass & panel door. Similar door on E. wing.

Condition good (See p. 2.)

Moved ☒ no ☐ yes Date N/A

Acreage 30.5 acres

Recorded by A. Forbes
research by Tillie Sweet
Organization for Concord Hist. Commission

Date (month/day/year) June, 1991

Setting In rural area at intersection of Wheeler and Plainfield Roads, in cluster of 19th-20th-century houses and farm buildings. Fields and pastures to S and W.; former barn to E., altered to dwelling at W. end.

BUILDING FORM

ARCHITECTURAL DESCRIPTION ☒ see continuation sheet

Describe architectural features. Evaluate the characteristics of this building in terms of other buildings within the community.

In spite of some alteration in the early twentieth century, (see page 1,) #415 Plainfield Road is extremely significant as Concord's only example of one high-style Greek Revival house-type--the 2 1/2-story building with 2-story side colonnade. The house is completely true to the type: the tall tetrastyle colonnade, of fluted Doric columns, echoes the four-bay arrangement of the flush-boarded south side, where 9-over-9-sash "long" windows appear at the first story, 6-over-6-sash at the second. The gable ends are fully pedimented, and the house trim, which includes wide corner pilasters, sill board, and a full entablature of architrave, frieze, and molded, boxed cornice, is the quintessence of the Greek Revival at its height.

A two-story pedimented wing that projects to the rear of the main house may be part of the original structure; a long 2-story wing that extends to its east would have been added at a later date. (Cont.)

HISTORICAL NARRATIVE ☒ see continuation sheet

Discuss the history of the building. Explain its associations with local (or state) history. Include uses of the building, and the role(s) the owners/occupants played within the community.

Although it is not mentioned in either the Wheeler House File or Keyes "Houses in Concord," this property is significant as the farmstead of an acreage that was split off from the large farm belonging early in the nineteenth century to Cyrus Wheeler. Further research will be necessary to determine the exact circumstances under which the house was built. It appears first on the 1852 under the name of Joel Wheeler, and it is likely that it was built for him. By 1875 it belonged to "L. Miles", (possibly Levi Miles--see #170 Fitchburg Turnpike,) and by 1880 to Joel's son, Alvah G. Wheeler, who owned it until at least 1908.

Early in this century the farm was acquired by Levingston Prime. He sold it in 1927 to Floyd Verrill, whose son, Stephen Verrill, still owns it today. A new era began at Nine Acre Corner under the Verrill family ownership. Floyd Verrill established a dairy farm here that eventually, under first his management and later that of his son, Stephen, grew to have the county's largest herd of registered Holsteins (over 150) producing milk for wholesale buyers. Floyd Verrill also ran a retail milk (Cont.)

BIBLIOGRAPHY and/or REFERENCES ☐ see continuation sheet

Maps and atlases: 1852, 1856, 1875, 1889, 1906.

Town Directories.

Jarvis.

Sanctuary, V. 26, May/June, 1987.

Garrellick. Concord Oral History Tapes.

Concord Vital Records.

Garrellick and Bailey. Concord in the Days of Strawberries and Streetcars.

- ☐ Recommended for listing in the National Register of Historic Places. *If checked, you must attach a completed National Register Criteria Statement form.*

INVENTORY FORM CONTINUATION SHEET

Community

Property

CONCORDJoel/Alvah Wheeler
House

Massachusetts Historical Commission
80 Boylston Street
Boston, Massachusetts 02116

Area(s) Form No.

AT 420

ARCHITECTURAL SIGNIFICANCE, cont.

In spite of the addition of porches, door hoods, and the replacement of the doors early in this century, much Greek Revival detail remains. Most windows are 6-over-6-sash, with flat surrounds, and a semi-circular window graces the gable of the rear wing. The west entry retains its full-length sidelights and shallow-pedimented entablature in spite of the addition of the later door hood.

The east wing is linked via a 1-story clapboard bay to a large square orange-brick hip-roofed garage, probably built ca. 1910-15.

Old photos show that the barn to the rear, (now converted to a dwelling,) was a large "New England", cupolaed type with the wagon door in the west gable end. In ca. 1929 it was changed to a low, pitch-roofed structure, and the long cow barn added to its east. A polygonal bandstand-like pergola stood just south of the colonnade in 1908.

HISTORICAL SIGNIFICANCE, cont.

business, the Concord Dairy, in partnership with James de Normandie and later Farnham Smith. It delivered milk first from the Verrill's previous farm on the site of what is now the Nashawtuc Country Club and later, from 1939 until the 1950's, from the corner of Sudbury and Thoreau at Concord center. Floyd Verrill was the first of Concord's dairy farmers to pasteurize milk and the first to sell milk to the schools.

By the time Stephen Verrill took over the farm in 1957, however, most of the retail business had been phased out, with only a small portion continuing at Concord center until 1968. By 1990, a combination of changing economics and government regulations led to the end of the dairy operations here, and the Verrill's cows, the last dairy herd left in Concord, were sold at auction. The farm today continues with the presently more profitable enterprises of pick-your-own strawberries and vegetables, and general truck farming. The Verrills also maintain a smaller herd of Holsteins, largely for breeding purposes.



CON. 420 1900 (2)
 n Concord
 et cor. Wheeler Plainfield
 ne _____
 ginal Use _____
 sent Use Farm?
 sent Owner Private
 e 1900's Style Grk Rev.
 rce of Date Mrs Wheeler
 hitect _____
 ved Altered _____

IMPORTANCE of site to area: Great Little None SITE endangered by _____

4. DESCRIPTION

FOUNDATION/BASEMENT: High Regular Low Material: Feldston
 WALL COVER: Wood clapboard Brick Stone Other _____
 STORIES: 1 2 3 4 CHIMNEYS: 1 2 3 4 Center End Cluster Elaborate Irregular
 ATTACHMENTS: Wings Ell Shed Dependency _____ Simple/Complex
 PORCHES: (1) 2 3 4 Portico Balcony 2 story "doric" (modified) Recessed _____
 ROOF: Ridge Gambrel Flat Hip Mansard
 Tower Cupola Dormer windows Balustrade Grillwork _____
 FACADE: Gable End: Front/Side Symmetrical/Asymmetrical Simple/Complex Ornament
 Entrance: Front/Side Centered Double Features: side of front
 Windows: Spacing: Regular/Irregular Identical/Varied almost French lower
 Corners: Plain Pilasters Quoins Obscured _____

OUTBUILDINGS

LANDSCAPING

5. Indicate location of structure on map below

6. Footage of structure from street 20' Plainfield
 Property has _____ feet frontage on street

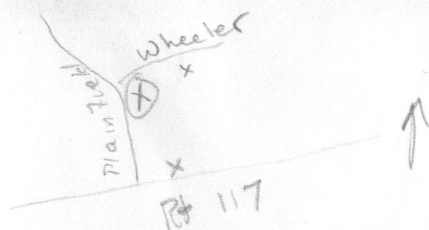

Recorder _____

For _____

Photo VIII-20
68-601

E. 09 065 1.002

NOTE: Recorder should obtain written permission from Commission or sponsoring organization before using this form. (See Reverse Side)

FOR USE WITH IMPORTANT STRUCTURES (Indicate any interior features of note)

Fireplace

Stairway

Other

GIVE A BRIEF DESCRIPTION OF HISTORIC IMPORTANCE OF SITE (Refer and elaborate on theme circled on front of form)

REFERENCE (Where was this information obtained? What book, records, etc.)

BIBLIOGRAPHY

Original Owner:

Deed Information: Book Number Page Registry of Deeds