

Massachusetts Cultural Resource Information System

Scanned Record Cover Page

Inventory No:	CON.256
Historic Name:	Barrett, Col. James Farm
Common Name:	McGrath House
Address:	448 Barrett's Mill Rd
City/Town:	Concord
Village/Neighborhood:	
Local No:	1986-4, 79
Year Constructed:	1705
Architect(s):	Barret, Joseph
Architectural Style(s):	Colonial
Use(s):	Abandoned or Vacant; Agricultural; Single Family Dwelling House
Significance:	Agriculture; Archaeology, Historic; Architecture; Military
Area(s):	CON.DT: Barrett Farm Historic District
Designation(s):	Local Historic District (10/10/1972); Nat'l Register Individual Property (11/15/1973)
Building Materials(s):	Roof: Asphalt Shingle Wall: Wood; Wood Clapboard Foundation: Granite; Stone, Cut



The Massachusetts Historical Commission (MHC) has converted this paper record to digital format as part of ongoing projects to scan records of the Inventory of Historic Assets of the Commonwealth and National Register of Historic Places nominations for Massachusetts. Efforts are ongoing and not all inventory or National Register records related to this resource may be available in digital format at this time.

The MACRIS database and scanned files are highly dynamic; new information is added daily and both database records and related scanned files may be updated as new information is incorporated into MHC files. Users should note that there may be a considerable lag time between the receipt of new or updated records by MHC and the appearance of related information in MACRIS. Users should also note that not all source materials for the MACRIS database are made available as scanned images. Users may consult the records, files and maps available in MHC's public research area at its offices at the State Archives Building, 220 Morrissey Boulevard, Boston, open M-F, 9-5.

Users of this digital material acknowledge that they have read and understood the MACRIS Information and Disclaimer (<http://mhc-macris.net/macrisdisclaimer.htm>)

Data available via the MACRIS web interface, and associated scanned files are for information purposes only. THE ACT OF CHECKING THIS DATABASE AND ASSOCIATED SCANNED FILES DOES NOT SUBSTITUTE FOR COMPLIANCE WITH APPLICABLE LOCAL, STATE OR FEDERAL LAWS AND REGULATIONS. IF YOU ARE REPRESENTING A DEVELOPER AND/OR A PROPOSED PROJECT THAT WILL REQUIRE A PERMIT, LICENSE OR FUNDING FROM ANY STATE OR FEDERAL AGENCY YOU MUST SUBMIT A PROJECT NOTIFICATION FORM TO MHC FOR MHC'S REVIEW AND COMMENT. You can obtain a copy of a PNF through the MHC web site (www.sec.state.ma.us/mhc) under the subject heading "MHC Forms."

Commonwealth of Massachusetts
Massachusetts Historical Commission
220 Morrissey Boulevard, Boston, Massachusetts 02125
www.sec.state.ma.us/mhc

This file was accessed on: Thursday, October 22, 2020 at 10:42 AM

FORM B - BUILDING

Massachusetts Historical Commission
Massachusetts Archives Facility
220 Morrissey Boulevard
Boston, Massachusetts 02125

Assessor's number

USGS Quad

Area(s)

Form Number

Maynard

DT

256

NRIND- 11/15/73
LHD- 12/10/72

Photograph

roll:negative(s):

Sketch Map

see attached map

RECEIVED

JUL 31 2002

MASS. HIST. COMM

Recorded by Ben Ford

Organization PAL

Date (month/day/year) 11/26/01

Town Concord

Place (neighborhood or village) _____

Address 448 Barrett's Mill Road

Historic Name Barrett, Colonel James Farm

Uses: Present domestic dwelling

Original domestic dwelling

Date of Construction 1705

Source Cassie 1973

Style/Form Colonial

Architect/Builder Joseph Barrett

Exterior Material:

Foundation stone

Wall/Trim wood

Roof other

Outbuildings/Secondary Structures _____

Foundation of a wood shed.

Major Alteration (with dates) _____

The windows were enlarged, and the door hood added at the end of the 19th century. Roofline may have been altered.

Condition poor

Moved X no _____ yes Date _____

Acreage 1

Setting Agricultural lands surround with a few residential homes in the vicinity.

BUILDING FORM**ARCHITECTURAL DESCRIPTION** ☒ *see continuation sheet*

Describe architectural features. Evaluate the characteristics of this building in terms of other buildings within the community.

HISTORICAL NARRATIVE ☒ *see continuation sheet*

Discuss the history of the building. Explain its associations with local (or state) history. Include uses of the building, and the role(s) the owners/occupants played within the community.

Note: This form was prepared as part of a survey of Revolutionary War and War of 1812 battlefields and associated historic properties in Massachusetts. It does not necessarily present the full significance of the property during previous or subsequent periods of development.

BIBLIOGRAPHY and/or REFERENCES ☐ *see continuation sheet*

- ☐ **Recommended for listing in the National Register of Historic Places.** *If checked, you must attach a completed National Register Criteria Statement form.*

Previously listed in NR NR# 73000290

INVENTORY FORM CONTINUATION SHEET

Community:
Concord

Property Address:
448 Barrett's Mill Road

**Massachusetts Historical Commission
Massachusetts Archives Facility
220 Morrissey Boulevard
Boston, Massachusetts 02125**

Area(s)
DT

Form No.
256

ARCHITECTURAL DESCRIPTION *(continued)*

The Barrett Farm is located at 448 Barrett's Mill Road and is in poor condition. Despite additions the house has good integrity but is suffering from significant neglect.

The Barrett Farm is a 2.5 story five bay house with a gable roof. The roof is clad in asphalt shingles and is pierced by a large central brick chimney. The block is sheathed in clapboards. The windows are 2 over 1 lights with exterior shingles. The door has an Italianate hood. The foundation is of dressed stone. A bronze interpretative plaque is located on the south east corner of the south facing house. An historic (1760) addition is attached to the west of the house. The addition is very similar to the main house, except it is set back approximately eight feet from the south façade. The foundation of a collapsed wood shed is evident to the east of the house. Historic stone walls are visible from the house. The surrounding area is in agricultural use.

HISTORICAL SIGNIFICANCE *(continued)*

The Colonel James Barrett Farm, which still stands in Concord, is significant as the primary objective of the British advance on April 19, 1775.

The Barrett House was reportedly constructed in 1705 as a one room square building by Joseph Barrett (MHC; NRHP). James was born in the house in 1710 and continued to live there throughout his life. James was influential in politics and served on numerous county and state conventions, was a delegate to the Provincial Congress, and served on the General Court from 1768 to 1777. Most importantly to the Revolution the Colonel was in command of the local militia and the superintendent of military stores for the Massachusetts Committee of Safety. In his role as superintendent he used his own house and barn, in addition to those of his neighbors, to store powder, cannon, shot, flour, and other military stores. Consequently, when the British set out to seize the rebel supplies on the 18th of April they marched straight for Barrett's Farm. The Colonel was warned of their intentions and managed to hide the majority of the supplies on and around his property. The hiding, some accounts report, included placing cannon in the furrows of his field. When the three companies of Regulars under Captain Parsons arrived at the Barrett farm on the 19th they did not find the quantities of supplies they expected or Colonel Barrett. Barrett was with his troops on Punkatasset Hill. Though there is one account of him galloping home ahead of the British to warn his family of the impending visit, before returning to his men. The British did find a few cannon carriages, which they burned. The troops tarried further when Rebecca Hubbard, Barrett's wife, offered them refreshments, effectively keeping them from reinforcing their comrades at North Bridge.

In 1779 Colonel Barrett died at the age of 69 and passed the property to his son, Peter. From then until 1894 the property was owned by Barrett descendants. The property was purchased in 1937 by the McGrath family.

Consequently, The Barrett Farm is significant as the objective of the British march that served as the catalyst for American Revolution. It is unlikely that the war never would have started if Barrett hadn't stored military supplies at his home, but his property is remembered as the destination that instigated the conflict.

BIBLIOGRAPHY and/or REFERENCES *(continued)*

Anonymous, n.d.: Barrett's Farm Vertical File, Concord Public Library
Boston National Historic Sites Commission, 1958: The Lexington-Concord Battle Road: Interim Report of the Boston Historic Sites Commission to the Congress of the United States
Cassie, Alexander, August 1973: Colonel James Barrett Farm



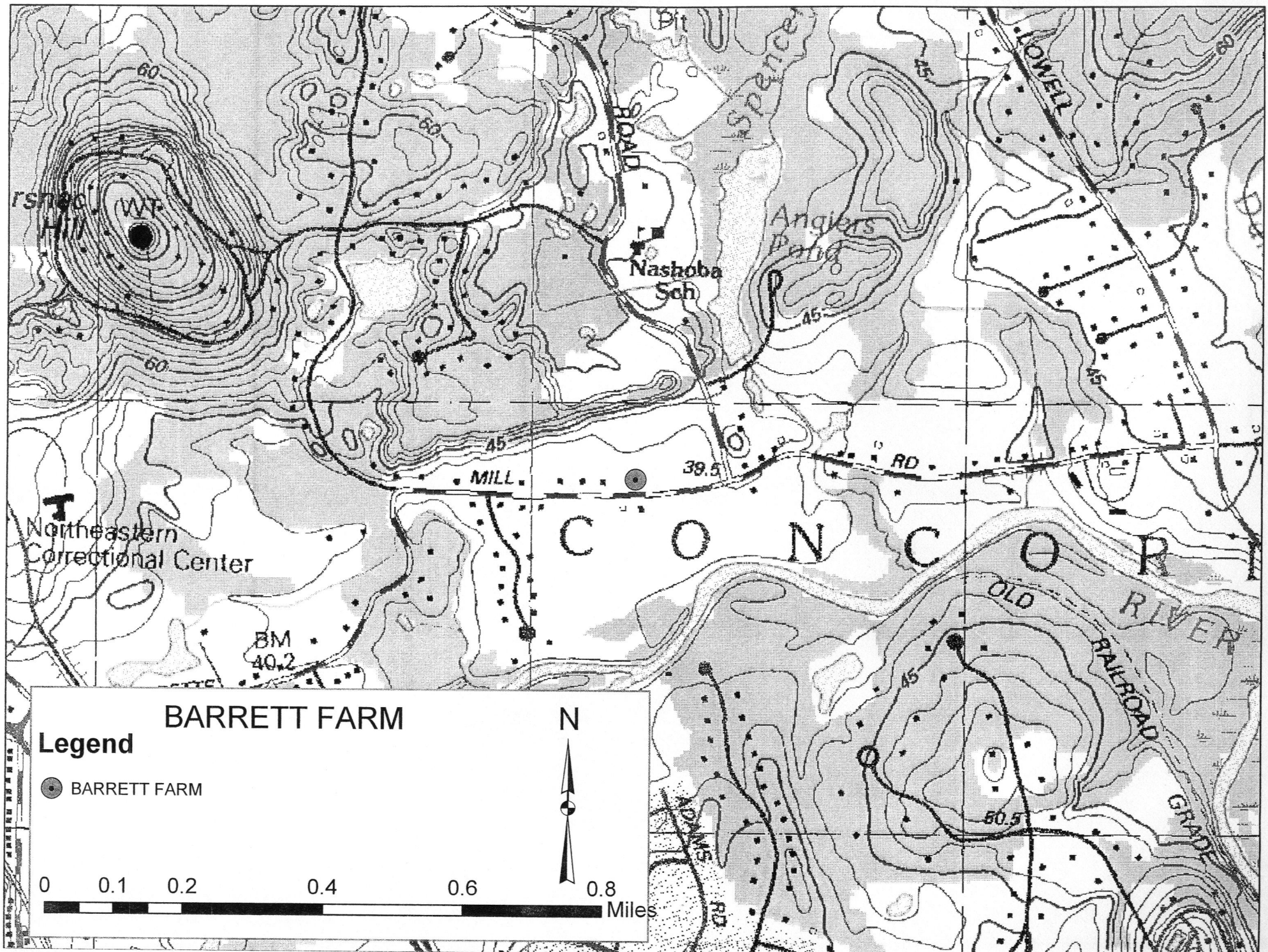

Barrett Farm

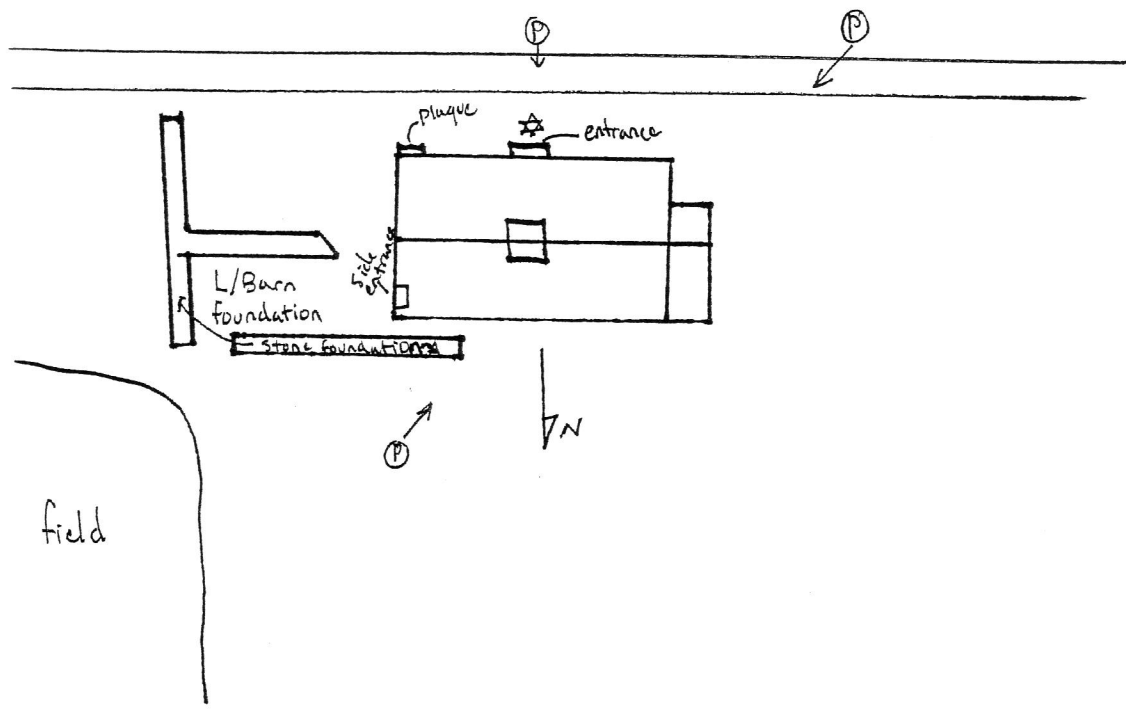

FORM B - STRUCTURE SURVEY
MASSACHUSETTS HISTORICAL COMMISSION
Office of the Secretary, State House, Boston

1. Is this structure historically significant to:
Town _____ Commonwealth _____ Nation _____

Structure has historical connection with the following themes: (See also reverse side)

Agriculture	Commerce/Industry
Architecture	Science/Invention
Art/Sculpture	Travel/Communication
Education	<u>Military Affairs</u>
Government	Religion/Philosophy
Literature	Indians
Music	Development of Town/City

2. Town Concord Street 448 Barrett's Mill Rd
Name James Col. Barrett Original Use LTD - 10/10/72
Present Use NRIND - 11/15/73
Present Owner NOTE private PL - A
Date 1705? Style USGS - MY
Source of Date see over Architect SELF A

3. CONDITION: Excellent Good Fair Deteriorated Moved Altered _____

IMPORTANCE of site to area: Great Little None SITE endangered by _____

4. DESCRIPTION

FOUNDATION/BASEMENT: High Regular Low Material: outslone

WALL COVER: Wood clap? Brick Stone Other _____

STORIES: 1 2 / 3 4 CHIMNEYS: 1 2 3 4 Center End Cluster Elaborate Irregular

ATTACHMENTS: Wings Ell Shed Dependency 3 story W - 1 story garage Simple/Complex

PORCHES: 1 2 3 4 Portico Balcony _____ Recessed _____

ROOF: Ridge Gambrel Flat Hip Mansard
Tower Cupola Dormer windows Balustrade Grillwork _____

FACADE: Gable End: Front Side Symmetrical/Asymmetrical Simple/Complex Ornament

Entrance: Front Side Centered Double Features: Italian bracket overhang

Windows: Spacing: Regular/Irregular Identical/Varied 2/1

Corners: Plain Pilasters Quoins Obscured corner boards

OUTBUILDINGS _____ LANDSCAPING _____

5. Indicate location of structure on map below 6. Footage of structure from street 10'

Property has _____ feet frontage on street

Recorder _____

For _____

68-549
Photo 68-560
68-551 36A
68-552-3-4-3
E.09.065.1. 0 79

NOTE: Recorder should obtain written permission from Commission or sponsoring organization before using this form. (See Reverse Side)

FOR USE WITH IMPORTANT STRUCTURES (Indicate any interior features of note)

Fireplace

Stairway

Other

GIVE A BRIEF DESCRIPTION OF HISTORIC IMPORTANCE OF SITE (Refer and elaborate on theme circled on front of form)

James Barrett (b 1710) colonel of militia 1775
Superintend collection of military stores for Concord
Rep to G. C. 1768-1777.
House center of search by Brit. for military goods 4/19/75.

DESCRIPTION

REFERENCE (Where was this information obtained? What book, records, etc.)

newspaper article - Wheel 10/21/37

BIBLIOGRAPHY

Original Owner: _____
Deed Information: Book Number _____ Page _____ Registry of Deeds



Barretts Mill Road (North side)



Detail barn - east side of house



Barretts Mill Road (North side)



Detail barn - west side of house



Barn - west side of house



Barn - west side of house