

Massachusetts Cultural Resource Information System

Scanned Record Cover Page

Inventory No:	CON.180
Historic Name:	Fox, Benoni and Thomas House
Common Name:	
Address:	472-474 Old Bedford Rd
City/Town:	Concord
Village/Neighborhood:	East Quarter
Local No:	J7-P-973
Year Constructed:	c 1711
Architect(s):	
Architectural Style(s):	First Period; Georgian
Use(s):	Agricultural; Multiple Family Dwelling House; Single Family Dwelling House
Significance:	Agriculture; Architecture
Area(s):	
Designation(s):	
Building Materials(s):	Roof: Asphalt Shingle Wall: Wood; Wood Clapboard Foundation: Stone, Uncut



The Massachusetts Historical Commission (MHC) has converted this paper record to digital format as part of ongoing projects to scan records of the Inventory of Historic Assets of the Commonwealth and National Register of Historic Places nominations for Massachusetts. Efforts are ongoing and not all inventory or National Register records related to this resource may be available in digital format at this time.

The MACRIS database and scanned files are highly dynamic; new information is added daily and both database records and related scanned files may be updated as new information is incorporated into MHC files. Users should note that there may be a considerable lag time between the receipt of new or updated records by MHC and the appearance of related information in MACRIS. Users should also note that not all source materials for the MACRIS database are made available as scanned images. Users may consult the records, files and maps available in MHC's public research area at its offices at the State Archives Building, 220 Morrissey Boulevard, Boston, open M-F, 9-5.

Users of this digital material acknowledge that they have read and understood the MACRIS Information and Disclaimer (<http://mhc-macris.net/macrisdisclaimer.htm>)

Data available via the MACRIS web interface, and associated scanned files are for information purposes only. THE ACT OF CHECKING THIS DATABASE AND ASSOCIATED SCANNED FILES DOES NOT SUBSTITUTE FOR COMPLIANCE WITH APPLICABLE LOCAL, STATE OR FEDERAL LAWS AND REGULATIONS. IF YOU ARE REPRESENTING A DEVELOPER AND/OR A PROPOSED PROJECT THAT WILL REQUIRE A PERMIT, LICENSE OR FUNDING FROM ANY STATE OR FEDERAL AGENCY YOU MUST SUBMIT A PROJECT NOTIFICATION FORM TO MHC FOR MHC'S REVIEW AND COMMENT. You can obtain a copy of a PNF through the MHC web site (www.sec.state.ma.us/mhc) under the subject heading "MHC Forms."

Commonwealth of Massachusetts
Massachusetts Historical Commission
220 Morrissey Boulevard, Boston, Massachusetts 02125
www.sec.state.ma.us/mhc

This file was accessed on: Friday, October 30, 2020 at 12:44 PM

FORM B - BUILDING

Assessor's number

USGS Quad

Area(s)

Form Number

Massachusetts Historical Commission
80 Boylston Street
Boston, Massachusetts 02116

J7-P-973

P-973-1-1

CONCORD

180

Town CONCORD

Place (neighborhood or village) old "East Quarter"

472/474 Old Bedford Road

Historic Name Benoni and Thomas Fox House

Present dwelling

Original dwelling

Year of Construction ca. 1711

Historic Use Will of Eliphalet Fox

Form First Period

Architect/Builder unknown

Primary Material:

Foundation laid, (fieldstone?)

Wall/Trim wood clapboard

Roof asphalt shingle

Outbuildings/Secondary Structures garage

Major Alterations (with dates) 1980's;

large addition at NE rear; entry

vestibule.

Condition fair (altered)

Moved ☒ no ☐ yes Date N/A

Acreage less than one acre

Setting Side to street, with fields

opposite, and new condo. construction

to east. High board fence encloses

back yard.

Sketch Map

Draw a map of the area indicating properties within it. Number each property for which individual inventory forms have been completed. Label streets including route numbers, if any. Attach a separate sheet if space is not sufficient here. Indicate North.

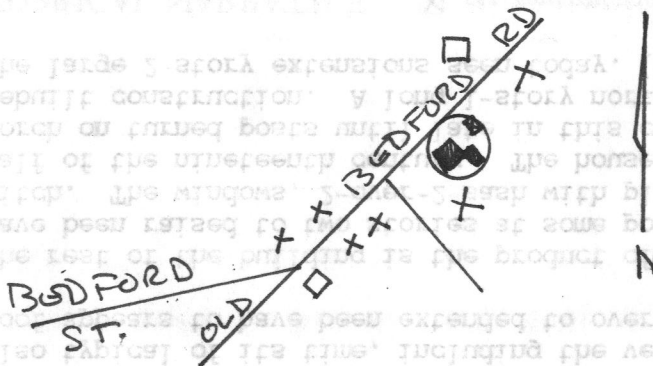

Recorded by A. Forbes
research by Bunny Black

Organization for Concord Hist. Commission

Date (month/day/year) June, 1991

BUILDING FORM

ARCHITECTURAL DESCRIPTION ☒ see continuation sheet

Describe architectural features. Evaluate the characteristics of this building in terms of other buildings within the community.

In spite of the large additions that are part of the recent condominium conversion of this house, the main structure still has the aspect of a typical eighteenth-century five-bay, 2 1/2-story structure. It is one room deep, and has a massive central chimney with prominent rear flue. (The presence of the latter implies that it may have been added to the chimney to accommodate the addition of a fireplace in a rear room, possible a leanto that was added some time in the eighteenth century.) Some surviving detail is also typical of its time, including the very slight roof overhang at the front. (The roof appears to have been extended to overhang the gable ends at a later date.)

The rest of the building is the product of later alterations. The rear room appears to have been raised to two stories at some point, reducing its shed roof to a very shallow pitch. The windows, 2-over-2-sash with plain surrounds, probably date to the second half of the nineteenth century. The house had a late Victorian wraparound, bracketed porch on turned posts until late in this century; the present vestibule is of recent or rebuilt construction. A long 1-story northeast ell was recently replaced or enlarged by the large 2-story extensions seen today. (Cont.)

HISTORICAL NARRATIVE ☒ see continuation sheet

Discuss the history of the building. Explain its associations with local (or state) history. Include uses of the building, and the role(s) the owners/occupants played within the community.

Like its companion across the street at #505, this house changed hands repeatedly over the course of the nineteenth century. The story was different in the eighteenth century, however, when it remained in the possession of the Fox family for several generations. Both houses were standing by 1711 on the large farm of the late Eliphalet Fox, son of seventeenth-century settler Thomas Fox, who had owned an extensive amount of land in the East Quarter where the Old Billerica Road (there was no Bedford then,) turned east. Eliphalet had given the house at #505 to his son Samuel in 1702, and left #472, (his own dwelling of just a few years,) to his youngest son Benoni Fox, in his will of 1711.

Benoni sold this building to his brother, however, and until his death in 1734, Samuel Fox owned both #s 505 and 472. In his will, Samuel left the part of the farm on the west side of the street, including #505, to his son Enos, and #472, with the section of the farm on the east side, to his son Thomas Fox (1706-1759.) Thomas appears to have lived here for the rest of his life, and the house was inherited by his daughter Esther Fox Gibson, wife of Abraham Gibson (later of Stow and Fitchburg.) (Cont.)

BIBLIOGRAPHY and/or REFERENCES ☒ see continuation sheet

Maps and atlases: 1830, 1852, 1856, ca. 1871; 1875, 1889, 1893, 1906.

Shattuck, Lemuel. History of the Town of Concord. 1835.

Town Directories.

Wheeler, Ruth. Concord: Climate for Freedom. 1967. (Cont.)

☐ Recommended for listing in the National Register of Historic Places. *If checked, you must attach a completed National Register Criteria Statement form.*

INVENTORY FORM CONTINUATION SHEET

Community

Property

CONCORD

Benoni/Thomas Fox
House

Massachusetts Historical Commission
80 Boylston Street
Boston, Massachusetts 02116

Area(s) Form No.

180

ARCHITECTURAL SIGNIFICANCE, cont.

A large barn standing to the southeast of the house was taken down and completely rebuilt in the late 1980's. It is now also part of the condominium complex, (#s 468 and 470 Old Bedford Road.)

HISTORICAL SIGNIFICANCE, cont.

This part of the old farm was sold out of the Fox family in 1768, when it was purchased by **Grindall Rawson**. In 1773 it was bought by **Capt. Stephen Jones**, who owned the farm for forty years until his death in 1813. His estate was bankrupt, and #472 appears to have entered a series of holdings by speculators. They appear to have included tavern-owner **Hartwell Bigelow**; **William Watts** (purchased in 1832); **Thomas M. Melvin** (purchased in 1834--he later owned #505, and his brother Isaac may have been involved in this purchase;) and possibly **William Mercer**, as well.

Later in 1834 the property was bought by **Charles Gordon**, who had purchased #505 and the part of the farm on the west side of the road in 1822. He lived here until his death some time after 1856, and according **Keyes** was succeeded by a **Mr. Walmsley**, "a protestant Irishman," who sold it to **Waldo Flint**. According to **Ruth Wheeler**, **Flint** bought the farm after returning to Concord from the California gold rush. **Keyes**, however, says he bought it after returning from the Civil War. (The latter may be more likely, as maps show "J. Wamsley" still here in 1871.)

In 1890 **Waldo Flint** built the house just south at #430 Old Bedford Road had built for his residence, and the next year sold #472 to **Charles Bartlett** of Walden Street. **Bartlett** appears to have owned it only briefly before its sale at auction to **T. Henry Mahan** in 1891. The **Mahan** family owned the property through the middle of this century.

BIBLIOGRAPHY, Cont.

Wheeler, Ruth. "TH Mahan House", newspaper article 4/4/38.

_____. "House File."

Richardson. Concord Chronicle.

Keyes/Tolman. "Houses in Concord". 1885.

Concord Vital Records.

Interview with realtor, 1990.



CON. 180 86
 Town Concord
 Street 472 Old Bedford Rd
 Name Box House
 Original Use _____
 Present Use _____
 Present Owner _____
 Age 18th c Style _____
 Date of Date Newspaper 4/14/38
 Architect Wheeler
porch gone

3. CONDITION: Excellent Good Fair Deteriorated Moved Altered _____
 IMPORTANCE of site to area: Great Little None SITE endangered by _____

4. DESCRIPTION

FOUNDATION/BASEMENT: High Regular Low Material: concrete?
 WALL COVER: Wood clapboard Brick Stone Other _____
 STORIES: 1 2 / 3 4 CHIMNEYS: 1 2 3 4 Center End Cluster Elaborate Irregular
 ATTACHMENTS: Wings Ell Shed Dependency all shed side 2 story ell rear added Simple/Complex
 PORCHES: 1 2 3 4 Portico Balcony 1 story across front Recessed _____
 ROOF: Ridge Gambrel Flat Hip Mansard 2 story ell
 Tower Cupola Dormer windows Balustrade Grillwork _____
 FACADE: Gable End: Front/Side Symmetrical Asymmetrical Simple/Complex Ornament
 Entrance: Front/Side Centered Double Features: _____
 Windows: Spacing: Regular/Irregular Identical/Varied 19th c
 Corners: Plain Pilasters Quoins Obscured corner boards

OUTBUILDINGS _____ LANDSCAPING _____

5. Indicate location of structure on map below 6. Footage of structure from street 30'
 Property has _____ feet frontage on street

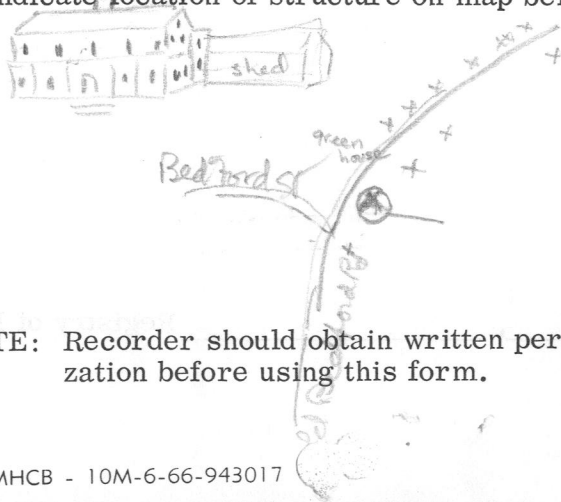

Recorder _____
 For _____
 Photo V-16 48-509 E.09 065.1.0 86
7768-510

NOTE: Recorder should obtain written permission from Commission or sponsoring organization before using this form. (See Reverse Side)

35x25
 H-3/4 A-4
 4-4

FOR USE WITH IMPORTANT STRUCTURES (Indicate any interior features of note)

Fireplace

Stairway

Other

GIVE A BRIEF DESCRIPTION OF HISTORIC IMPORTANCE OF SITE (Refer and elaborate on theme circled on front of form)

Fox family home during 18th C - Concord Farm - sold to Stephen Jones (gentl.)

Thomas Fox's son of Samuel Fox (house across street) daughter Esther inherited - Esther married Abraham Gibson whose estate sold it to Capt. Stephen Jones, gentleman.

REFERENCE (Where was this information obtained? What book, records, etc.)

BIBLIOGRAPHY



Original Owner: _____
Deed Information: Book Number _____ Page _____, _____ Registry of Deeds

Community: CON

MHC OPINION: ELIGIBILITY FOR NATIONAL REGISTER

Date Received: 3/27/01

Date Due: 4/27/01

Date Reviewed: 4/4/01

Type: x Individual x District (s)(Attach map indicating boundaries)

Name: Multiple Areas (see below for list)

Inventory Form: See Below

Address: Old Bedford Rd / Bedford Street / Virginia Road

Requested by: TD

Action: Honor ITC Grant x R & C Other:

Agency: Staff in charge of Review: SW

INDIVIDUAL PROPERTIES

 x Eligible
 Eligible, also in district
 Eligible only in district
 Ineligible
 More information needed

DISTRICTS

 Eligible
 Ineligible
 x More information needed

CRITERIA: x A B x C D

LEVEL: x Local x State National

STATEMENT OF SIGNIFICANCE

AREAS:

Old Bedford Road Area (CON.BM)
Old Bedford Road Area II (CON.BN)
Bedford Street Area II (CON.BO)
Lower Old Bedford – Virginia Roads Area (CON.BL)
William Tibbets – Thoreau Farm (CON.176)

INDIVIDUAL:

Enos Fox House (CON.182)
Samuel Fox House (CON.181)
Benoni & Thomas Fox House (CON.180)
Waldo Flint House (CON.179)

The entire area radiates from the intersection of Old Bedford Road and Bedford Street and part of Virginia Road (see map). The area is illustrative of the area's transition from an early agricultural to small farming area to an early 20th century streetcar suburb residential neighborhood. A majority of the land was once associated with the Fox family. The properties predominately read as historic structures in form though some have replacement windows or a form of synthetic siding.

The Old Bedford Road Area, the northernmost area, consists of three houses at 643, 654 and 667 Old Bedford Road all dating from the 1870's to the 1920's. Modern houses are located adjacent to these historic structures and to the north and south on Old Bedford Road. There is also a modern subdivision to the west (see map).

The Old Bedford Road Area II lies just to the south the Old Bedford Road Area. The area includes five properties 515,527,537,547,595 Old Bedford Road all located on the west side of the street, all constructed between 1870 and 1931. The historic properties are comprised of Greek Revivals and bungalows.

On the east side of Old Bedford Road at number 550 is the Enos Fox House. A Georgian farmhouse constructed in 1770 with a two story rear ell (may be a one story ell with an added second story dating to the early 20th century). The building is a five bay, two and a half story late Georgian structure with a central chimney, with a projecting central bay. The building is wood clapboard sided with 6 over 9 wood windows. The property is one of several in the area built by the Fox family, one of the earliest families in Concord. The house was used by subsequent families who farmed the area fields. Fun fact - during the Revolutionary War, when Harvard College was moved to Concord, a professor was housed here.

Just to the south of the Old Bedford Road Area II are several individually inventoried properties including:

- The Samuel Fox House at 505 Old Bedford Road: It is believed that the house may retain some heavy timber framing dating to 1702 but it predominately dates to the mid 18th century with a vernacular Georgian feel. The building has a salt box addition to the rear, is a five bay symmetrically arranged façade with a projecting one story central bay, and retains 6/6 wood sash and the majority of its architectural details. It has a clapboard façade with shingled sides. There was a former carriage house that was attached to the house, but destroyed in the 1938 hurricane. The site includes a 1930's garage, shed, greenhouse complex, and roadside stand.
- Benoni and Thomas Fox House at 474-472 Old Bedford Road, diagonally opposite the Samuel Fox House: The side of the house faces the street and there is a large condo addition added to the house. This structure began as a typical 18th century five bay 2 and a half story structure with a central chimney. The building is wood clapboard sided with late 19th century 2/2 wood sash with plain trim. The house at one time had a Victorian wrap around porch (as seen in earlier inventory form) that was removed and replaced with a central projecting bay in the 1990's.
- Waldo Flint House at 430 Old Bedford Road: Located at the corner of Bedford Street in a deep lot with mature trees with remnants of an orchard to the south. The c. 1890 2 and a half story dwelling with 2/2 wood windows is a vernacular Queen Anne style house with wood clapboard and shingles. A large clapboarded barn and carriage house sits adjacent to the house and is a very well preserved example in the town of Concord with a small cupola, central dormer with hay door, 6/6 wood sash, and vertical board central door.

Bedford Street II lies southwest of Old Bedford Road Area II after the intersection of Old Bedford Road and Bedford Street. The area consists of 9 properties on the north side of Bedford Street and one on the south side surrounded by modern residential properties. Mid 19th to early 20th century structures of various styles and several of the properties also have outbuildings.

The Lower Bedford – Virginia Road Area lies southeast of the intersection of Old Bedford Road and Bedford Street. The area consists of 7 residential properties dating from the late 19th to early 20th century. The southernmost portion of the area is within the Minuteman National Historic Park which includes the property at 55 Old Bedford Road (which is also in the American Mile LHD) and the agricultural land to the east of Old Bedford Road.

William Tibbets – Thoreau Farm, on the north side of Virginia Road, one of three inventoried sites outside the previous area is just west of the Deacon Wheeler- Thoreau Birthplace, which is individually eligible for listing in the National Register, and the Wheeler-Merriam House, which is individually listed in the National Register. Constructed c. 1878, the Greco-Italianate 2 and a half story three bay with a projecting wing house is sided in asbestos shingle. The associations with Thoreau extend only to the farm land associated with the site, the Thoreau farmhouse was demolished and this property built in the same location. The property was sold to the Wheeler family next door and farmed with the adjoining land.

DETERMINATION:

The Enos Fox House, Samuel Fox House and Waldo Flint House w/ barn and carriage house all retain integrity of setting, location, design, workmanship, feeling, association and materials and are eligible under Criteria A and C.

The Benino and Thomas Fox House is not eligible for listing because it lacks architectural integrity due to alterations over time, including a new side addition and removal of the Victorian porch.

More information is needed to determine eligibility for the areas in order to assess the number if intrusions (if any) between the houses in the areas and the areas themselves.