

# Massachusetts Cultural Resource Information System

## Scanned Record Cover Page

<b>Inventory No:</b>	CON.178
<b>Historic Name:</b>	Wheeler - Merriam House
<b>Common Name:</b>	Elm Brook Farm
<b>Address:</b>	477 Virginia Rd
<b>City/Town:</b>	Concord
<b>Village/Neighborhood:</b>	East Quarter
<b>Local No:</b>	89
<b>Year Constructed:</b>	1692
<b>Architect(s):</b>	Wheeler, Abner
<b>Architectural Style(s):</b>	Colonial
<b>Use(s):</b>	Agricultural; Dairy; Other Recreational; Single Family Dwelling House
<b>Significance:</b>	Agriculture; Archaeology, Historic; Architecture
<b>Area(s):</b>	
<b>Designation(s):</b>	Nat'l Register Individual Property (11/26/1982)
<b>Building Materials(s):</b>	Roof: Asphalt Shingle Wall: Wood; Wood Clapboard Foundation: Stone, Uncut



The Massachusetts Historical Commission (MHC) has converted this paper record to digital format as part of ongoing projects to scan records of the Inventory of Historic Assets of the Commonwealth and National Register of Historic Places nominations for Massachusetts. Efforts are ongoing and not all inventory or National Register records related to this resource may be available in digital format at this time.

The MACRIS database and scanned files are highly dynamic; new information is added daily and both database records and related scanned files may be updated as new information is incorporated into MHC files. Users should note that there may be a considerable lag time between the receipt of new or updated records by MHC and the appearance of related information in MACRIS. Users should also note that not all source materials for the MACRIS database are made available as scanned images. Users may consult the records, files and maps available in MHC's public research area at its offices at the State Archives Building, 220 Morrissey Boulevard, Boston, open M-F, 9-5.

Users of this digital material acknowledge that they have read and understood the MACRIS Information and Disclaimer (<http://mhc-macris.net/macrisdisclaimer.htm>)

Data available via the MACRIS web interface, and associated scanned files are for information purposes only. THE ACT OF CHECKING THIS DATABASE AND ASSOCIATED SCANNED FILES DOES NOT SUBSTITUTE FOR COMPLIANCE WITH APPLICABLE LOCAL, STATE OR FEDERAL LAWS AND REGULATIONS. IF YOU ARE REPRESENTING A DEVELOPER AND/OR A PROPOSED PROJECT THAT WILL REQUIRE A PERMIT, LICENSE OR FUNDING FROM ANY STATE OR FEDERAL AGENCY YOU MUST SUBMIT A PROJECT NOTIFICATION FORM TO MHC FOR MHC'S REVIEW AND COMMENT. You can obtain a copy of a PNF through the MHC web site ([www.sec.state.ma.us/mhc](http://www.sec.state.ma.us/mhc)) under the subject heading "MHC Forms."

Commonwealth of Massachusetts  
Massachusetts Historical Commission  
220 Morrissey Boulevard, Boston, Massachusetts 02125  
[www.sec.state.ma.us/mhc](http://www.sec.state.ma.us/mhc)

This file was accessed on: Friday, October 30, 2020 at 1:41: PM





Looking East down Virginia Rd - House on Left - Barn on right  
Wheeler-Merriam House Concord

4. Map. Draw sketch of building location in relation to nearest cross streets and other buildings. Indicate north.

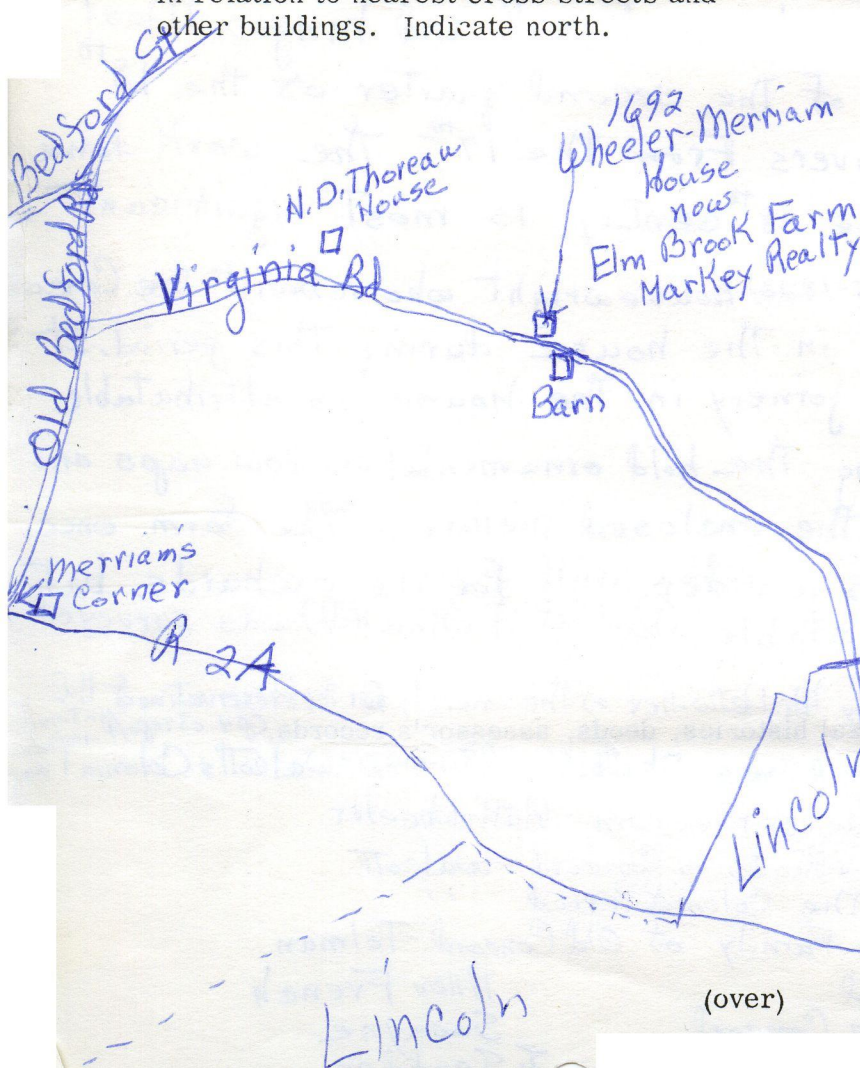

4-7-77

ON  
on5  
otosNRIND  
11/26/82

In Area no.	Form no.
	89 178

1. Town Concord Ma.Address 477 Virginia RdName Elm Brook Farm *Wheeler-Merriam House*Present use Riding StablePresent owner Markey Realty

3. Description:

Date 1692 House 1904 BarnSource Deeds & willsStyle Salt box - center entranceArchitect — partly by Abner WheelerExterior wall fabric wood clapboardsOutbuildings (describe) barnOther features central chimney -Ornamental door and window caps.Altered early eighteenth cent & also in Date 1904Moved no Date \_\_\_\_\_

5. Lot size:

One acre or less \_\_\_\_\_ Over one acre ✓Approximate frontage 125 ft.

Approximate distance of building from street

25 ft6. Recorded by Concord HistoricalOrganization SocietyDate 1980

(over)



Built by Sgt. Thomas Wheeler for his son & bride

7. Original owner (if known) Timothy Wheeler 1692  
 Original use Homestead  
 Subsequent uses (if any) and dates Riding stable in 1967 continuing til now.

8. Themes (check as many as applicable)

Aboriginal	<input type="checkbox"/>	Conservation	<input type="checkbox"/>	Recreation	<input type="checkbox"/>
Agricultural	<input checked="" type="checkbox"/>	Education	<input type="checkbox"/>	Religion	<input type="checkbox"/>
Architectural	<input checked="" type="checkbox"/>	Exploration/ settlement	<input checked="" type="checkbox"/>	Science/ invention	<input type="checkbox"/>
The Arts	<input type="checkbox"/>	Industry	<input type="checkbox"/>	Social/ humanitarian	<input type="checkbox"/>
Commerce	<input type="checkbox"/>	Military	<input type="checkbox"/>	Transportation	<input type="checkbox"/>
Communication	<input type="checkbox"/>	Political	<input type="checkbox"/>		
Community development	<input type="checkbox"/>				

9. Historical significance (include explanation of themes checked above)

The house is one of the few 17<sup>th</sup> century homes still standing and although there have been some changes, there still remains some very early wood work and hinges. Most of the house shows work of the second quarter of the 18<sup>th</sup> century with a few carry-overs from the 17<sup>th</sup>. The work done in the third quarter of the 18<sup>th</sup> century is most significant because Abner Wheeler, (1745-1820) Housewright who rebuilt the Concord Meetinghouse in 1791, was living in the house during this period. It is felt that the Georgian joinery in the house is attributable to him - one nice touch being the bold ornamental window caps and cornices which are shown in the enclosed picture. The farm once had a saw mill and perhaps a cider mill for its orchards, but is now used as a riding stable. Part of it (Pine Hill) was surveyed by Henry D Thoreau in 1851.

10. Bibliography and/or references (such as local histories, deeds, assessor's records, CP 4.05 report, Antiquities early maps, etc.)

Deeds  
 1692 - Vol 16 p 523  
 Will 1718 Vol 15 p 166 & 7  
 1775 Vol 62 p 132  
 Guardian ship Vol 237 + 55  
 Will 1856 Merriam # 37617  
 Deeds  
 1863 Vol 905 p 158  
 1865 Vol 956 p 118 Algeo

Town Records & maps - Shattuck's 1830 map - Walcott's Colonial map  
 Concord Climate for Freedom - Ruth Wheeler  
 Notes on Land & Roads in Concord - Walcott  
 Concord in the Colonial Period  
 The Wheeler Family of Old Concord - Tolman  
 Old Concord Allen French  
 The Story of Concord Swayne  
 Concord American Town T. Scudder  
 1717 assessor's records and polls  
 To Rodway To Markey Thoreau's Survey in Concord Library



## INVENTORY FORM CONTINUATION SHEET

Massachusetts Historical Commission  
80 Boylston Street  
Boston, Massachusetts 02116

Community

Property Address

CONCORD

477 VIRGINIA RD

Area(s)

FormNo.

178



East end of Wheeler-  
Merriam House - Virginia Rd



Window caps - Abner Wheeler  
Wheeler-Merriam House  
Concord Ma



Wheeler-Merriam House 1692  
Concord Ma



1904 Barn - diagonally opposite  
Wheeler Merriam House  
477 Virginia Rd. Concord Ma.



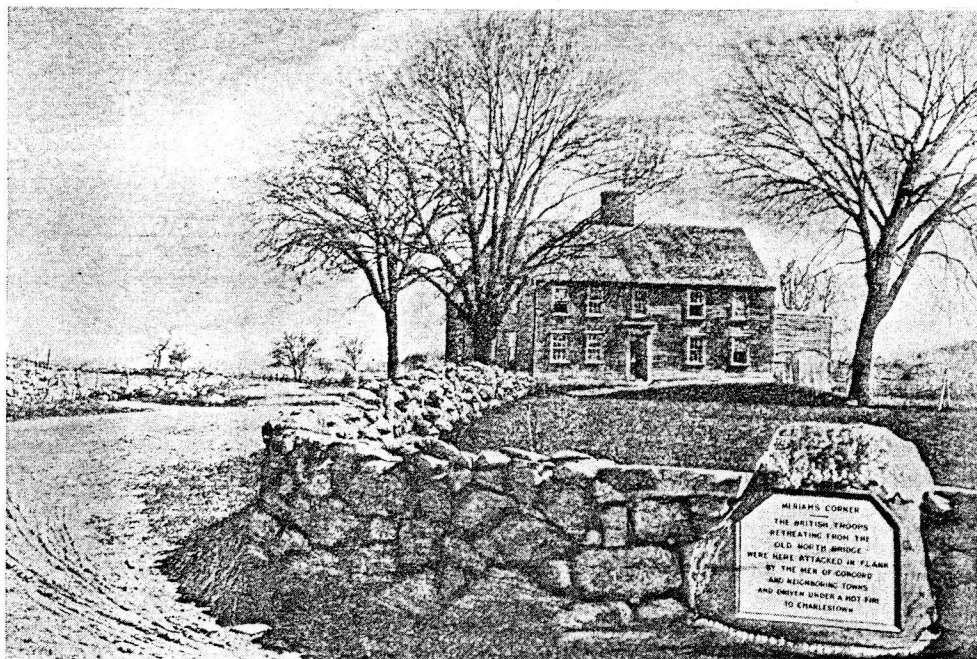

EPHRAIM-RUFUS MERIAM HOUSE  
Meriam's Corner, Concord



*Joseph and* JOSEPH MERIAM HOME  
Virginia Road, Concord

From a photograph by Miss Elizabeth Merriam of Framingham

Pictures from  
The Family Name Merriam It's Origin and a Sample Record  
by John V. Merriam  
Lakeview Press Framingham Ma 1935



Concord (178)  
 Virginia Rd  
 Timothy Wheeler House  
 al Use Farm  
 nt Use \_\_\_\_\_  
 nt Owner Alper  
 1756 Style \_\_\_\_\_  
 e of Date \_\_\_\_\_  
 tect \_\_\_\_\_

5. CONDITION: ~~Excellent~~ ~~Good~~ ~~Fair~~ ~~Deteriorated~~ ~~Moved~~ Altered added altered mid 19th C

IMPORTANCE of site to area: ~~Great~~ ~~Little~~ ~~None~~ SITE endangered by estate problems

#### 4. DESCRIPTION

FOUNDATION/BASEMENT: High Regular Low Material: \_\_\_\_\_

WALL COVER: Wood clapboard Brick Stone Other \_\_\_\_\_

STORIES: 1 2/3 4 CHIMNEYS: 1 2 3 4 Center End Cluster Elaborate Irregular

ATTACHMENTS: Wings Ell Shed Dependency \_\_\_\_\_ Simple/Complex

PORCHES: 1 2 3 4 Portico Balcony East side Recessed \_\_\_\_\_

ROOF: Ridge Gambrel Flat Hip Mansard lean to  
 Tower Cupola Dormer windows Balustrade Grillwork \_\_\_\_\_

FACADE: Gable End: Front/Side Symmetrical/Asymmetrical Simple/Complex Ornament

Entrance: Front/Side Centered Double Features: later door + porch

Windows: Spacing: Regular/Irregular Identical/Varied heavy late 19th lints

Corners: Plain Pilasters Quoins Obscured cornerboard

OUTBUILDINGS \_\_\_\_\_

LANDSCAPING \_\_\_\_\_

5. Indicate location of structure on map below

6. Footage of structure from street 50  
 Property has \_\_\_\_\_ feet frontage on street

Recorder \_\_\_\_\_

For \_\_\_\_\_

Photo I-868-501 2.09.065.1.089  
068-502

NOTE: Recorder should obtain written permission from Commission or sponsoring organization before using this form. (See Reverse Side)

FOR USE WITH IMPORTANT STRUCTURES (Indicate any interior features of note)

Fireplace

Stairway

Other

GIVE A BRIEF DESCRIPTION OF HISTORIC IMPORTANCE OF SITE (Refer and elaborate on theme circled on front of form)

in Capt Brown's Minuteman Co -  
after war moved Maine, then Ohio  
Mrs Wheeler

✓ I think the Timothy Wheeler +  
Wheeler - Algeo house are the same

Wheeler-Algeo - see also Thoreau's Birthplace for full Wheeler account

Algeo back to 1852

Prior to this to Joseph Merriam who married Lucy Wheeler  
daughter of Algeo -

possibly dates back to 1692 - Timothy Wheeler

news article 11/18/87

REFERENCE (Where was this information obtained? What book, records, etc.)

news art

## BIBLIOGRAPHY

Original Owner: \_\_\_\_\_

Deed Information: Book Number \_\_\_\_\_ Page \_\_\_\_\_, \_\_\_\_\_ Registry of Deeds