

Massachusetts Cultural Resource Information System

Scanned Record Cover Page

Inventory No:	CON.428
Historic Name:	Lee, Woodis - Lee, Isaac House
Common Name:	
Address:	509 Garfield Rd
City/Town:	Concord
Village/Neighborhood:	Nine Acre Corner
Local No:	G15-3449-5
Year Constructed:	1764
Architect(s):	
Architectural Style(s):	Federal
Use(s):	Agricultural; Single Family Dwelling House; Workers Housing
Significance:	Agriculture; Architecture; Industry
Area(s):	CON.AU: Woodis - Isaac Lee - Wright Farm
Designation(s):	
Building Materials(s):	Roof: Asphalt Shingle Wall: Wood; Wood Clapboard Foundation: Granite; Stone, Cut; Stone, Uncut



The Massachusetts Historical Commission (MHC) has converted this paper record to digital format as part of ongoing projects to scan records of the Inventory of Historic Assets of the Commonwealth and National Register of Historic Places nominations for Massachusetts. Efforts are ongoing and not all inventory or National Register records related to this resource may be available in digital format at this time.

The MACRIS database and scanned files are highly dynamic; new information is added daily and both database records and related scanned files may be updated as new information is incorporated into MHC files. Users should note that there may be a considerable lag time between the receipt of new or updated records by MHC and the appearance of related information in MACRIS. Users should also note that not all source materials for the MACRIS database are made available as scanned images. Users may consult the records, files and maps available in MHC's public research area at its offices at the State Archives Building, 220 Morrissey Boulevard, Boston, open M-F, 9-5.

Users of this digital material acknowledge that they have read and understood the MACRIS Information and Disclaimer (<http://mhc-macris.net/macrisdisclaimer.htm>)

Data available via the MACRIS web interface, and associated scanned files are for information purposes only. THE ACT OF CHECKING THIS DATABASE AND ASSOCIATED SCANNED FILES DOES NOT SUBSTITUTE FOR COMPLIANCE WITH APPLICABLE LOCAL, STATE OR FEDERAL LAWS AND REGULATIONS. IF YOU ARE REPRESENTING A DEVELOPER AND/OR A PROPOSED PROJECT THAT WILL REQUIRE A PERMIT, LICENSE OR FUNDING FROM ANY STATE OR FEDERAL AGENCY YOU MUST SUBMIT A PROJECT NOTIFICATION FORM TO MHC FOR MHC'S REVIEW AND COMMENT. You can obtain a copy of a PNF through the MHC web site (www.sec.state.ma.us/mhc) under the subject heading "MHC Forms."

Commonwealth of Massachusetts
Massachusetts Historical Commission
220 Morrissey Boulevard, Boston, Massachusetts 02125
www.sec.state.ma.us/mhc

This file was accessed on: Friday, October 23, 2020 at 12:54 PM

CON. 428

FORM B - BUILDING

Assessor's number

USGS Quad

Area(s)

Form Number

Massachusetts Historical Commission
80 Boylston Street
Boston, Massachusetts 02116

G15-3449-5

CONCORD

AU

428



CONCORD

SEA B

Neighborhood or village)

Nine Acre Corner

509 Garfield Road

Name Woodis/Isaac Lee Farmhouse

Present dwelling

Original dwelling

Construction 1764

Wheeler

Form Federal

Architect/Builder unknown

Exterior Material:

Foundation granite and fieldstone

Wall/Trim wood clapboard

Roof asphalt shingle

Outbuildings/Secondary Structures

barn, shed

Major Alterations (with dates) 20th C.:

sunrooms added on rear and east end,

glass doors on west end; new door.

Condition good

Moved ☒ no ☐ yes Date N/A

Acreage 4.2 acres

Setting Set in former farm landscape of rolling meadows, woods and stone walls. Paddock beside barn. Stone and concrete root cellar behind house. Steps lead south toward Fitchburg Tpke.

Sketch Map

Draw a map of the area indicating properties within it. Number each property for which individual inventory forms have been completed. Label streets including route numbers, if any. Attach a separate sheet if space is not sufficient here. Indicate North.

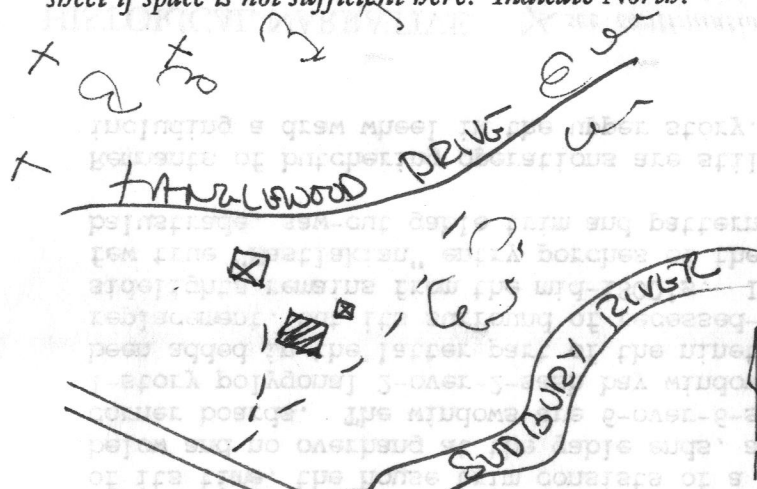

Recorded by A. Forbes
research by Tillie Sweet

Organization for Concord Hist. Commission

Date (month/day/year) June, 1991

CON. 428

BUILDING FORM

ARCHITECTURAL DESCRIPTION ☒ see continuation sheet

Describe architectural features. Evaluate the characteristics of this building in terms of other buildings within the community.

#509 Garfield Road is one of Concord's many classic late-eighteenth-century 2 1/2-story, five-bay farmhouses. It has a pair of ridge chimneys and a long 1 1/2-story ell on the west side. A second, shorter ell extends to the east. Typical of its time, the house trim consists of a boxed front cornice with prominent molding below and no overhang at the gable ends, a sill board or "water table," and narrow corner boards. The windows are 6-over-6-sash with slightly molded crowns. A 1-story polygonal 2-over-2-sash bay window at the west end of the facade would have been added in the latter part of the nineteenth century. The main door is a modern replacement, but its surround of recessed-paneled plasters with 2/3-length sidelights remains from the mid-1800's. In front of the entry is one of Concord's few true "Eastlavian" entry porches of the 1880's. with heavy spindle posts and balustrade, saw-cut gable trim and patterned shingles.

Remnants of butchering operations are still extant in the west ell of the house, including a draw wheel in the upper story. (Cont.)

HISTORICAL NARRATIVE ☒ see continuation sheet

Discuss the history of the building. Explain its associations with local (or state) history. Include uses of the building, and the role(s) the owners/occupants played within the community.

The history of the main ownership of this property goes back to ca. 1660-61, when Henry Woodhouse (Woodis,) purchased Simon Willard's former 350-acre farm "between the two rivers" (including also Nashawtuc Hill.) The house standing today, however, was apparently built by Henry Woodhouse's descendant Woodis Lee, Jr. The house fell to Woodis' son Isaac Lee, who, according to Wheeler, was born here shortly after it was built in 1764. The ownership of the house and surrounding farm passed through several generations of the family. Isaac and Lucy Lee's son Isaac Stearns Lee, (b. 1801) who married Sarah Clark of Boston in 1848, became owner of the farm after his father's death in 1835. Their daughter married her father's apprentice, George H. Wright, who owned it until the end of the century.

The farm was one of Henry Thoreau's favorite spots, who came in all seasons to view the landscape from Conantum and Fairhaven Hill, and to walk "Lee's Cliff", where he had gone as a boy for picnics with his family. (Cont.)

BIBLIOGRAPHY and/or REFERENCES ☐ see continuation sheet

Maps and atlases: 1830, 1852, 1856, 1875, 1889.
Wheeler House File.
Wheeler.
Fenn.
Shattuck.
Walcott, Concord in the Colonial Period.
Hudson, Alfred. History of Middlesex County.
Brooks, Paul. The People of Concord.

☒ Recommended for listing in the National Register of Historic Places. *If checked, you must attach a completed National Register Criteria Statement form.*

INVENTORY FORM CONTINUATION SHEET

Community

Property

CONCORD

Lee Farmhouse

Massachusetts Historical Commission
80 Boylston Street
Boston, Massachusetts 02116

Area(s) Form No.
AU 428

ARCHITECTURAL SIGNIFICANCE, cont.

The house is complemented by a clapboard shed with rolling door to the rear, and to the west, a magnificent example of a long gable-end barn with clerestory monitor roof. (Form # .) Its facade has an off-center diagonal-board door with transom and bracketed hood. The windows are 6-over-6-sash, the foundation is brick.

HISTORICAL SIGNIFICANCE, cont.

In 1899 the farm was acquired by the Misses Elizabeth and Emma Williams, who built the large white house on the bluff at Conantum overlooking Fairhaven Bay. (See #900 Tanglewood Drive.) By 1925 the entire property had been purchased by Richard Fessenden, who, probably following the practice of the Misses Williams, lived in the 1899 house and rented this one to a foreman and farm workers. The Fessenden family owned the property through the middle of this century.



CON. 428

RECEIVED

Massachusetts Historical Commission
80 Boylston Street
Boston, Massachusetts 02116

JUL 15 1993

Community
CONCORD

Property Address
509 Garfield Road

MASS. HIST. COMM.

Area(s)	FormNo.
AU	428

National Register of Historic Places Criteria Statement Form



Check all that apply:

- ☒ Individually eligible ☐ Eligible only in a historic district
☐ Contributing to a potential historic district ☐ Potential historic district

Criteria: ☒ A ☐ B ☒ C ☐ D

Criteria Considerations: ☐ A ☐ B ☐ C ☐ D ☐ E ☐ F ☐ G

Anne McCarthy Forbes

Statement of Significance by _____

The criteria that are checked in the above sections must be justified here.

As one of the most well-preserved farmsteads, as well as one of the most significant farms over the course of 250 years in the southern section of Concord, 509 Garfield Road is eligible for the National Register under Criteria A and C. It possesses integrity of location, design, setting, materials, and workmanship, feeling and association.



2. Town Concord
 Street Rt. 117 almost Lee's Bridge
 Name Lee House
 Original Use 5096a field Rd.
 Present Use _____
 Present Owner private
 Date early 19th C Style _____
 Source of Date aw
 Architect _____

3. CONDITION: Excellent Good Fair Deteriorated Moved Altered _____

IMPORTANCE of site to area: Great Little None SITE endangered by _____

4. DESCRIPTION

FOUNDATION/BASEMENT: High Regular Low Material: _____

WALL COVER: Wood lapboard Brick Stone Other _____

STORIES: 1 2 3 4 CHIMNEYS: 1 2 3 4 Center End Cluster Elaborate Irregular

ATTACHMENTS: Wings Ell Shed Dependency _____ Simple/Complex

PORCHES: 1 2 3 4 Portico Balcony _____ Recessed _____

ROOF: Ridge Gambrel Flat Hip Mansard
 Tower Cupola Dormer windows Balustrade Grillwork _____

FACADE: Gable End: Front/Side Symmetrical/Asymmetrical Simple/Complex Ornament

Entrance: Front/Side Centered Double Features: _____

Windows: Spacing: Regular/Irregular Identical/Varied _____

Corners: Plain Pilasters Quoins Obscured _____

OUTBUILDINGS _____ LANDSCAPING _____

5. Indicate location of structure on map below

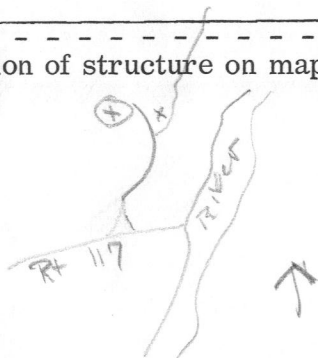

6. Footage of structure from street over 100
 Property has _____ feet frontage on street

Recorder _____

For _____

Photo polaroid

E-09.065 1.116

NOTE: Recorder should obtain written permission from Commission or sponsoring organization before using this form. (See Reverse Side)

FOR USE WITH IMPORTANT STRUCTURES (Indicate any interior features of note)

Fireplace

Stairway

Other

GIVE A BRIEF DESCRIPTION OF HISTORIC IMPORTANCE OF SITE (Refer and elaborate on theme circled on front of form)

Lee Jr, born 1719 son Isaac b. 1764 his son
Isaac Stearns Lee

REFERENCE (Where was this information obtained? What book, records, etc.)

CAS

BIBLIOGRAPHY

Original Owner:

Deed Information: Book Number Page Registry of Deeds