

Massachusetts Cultural Resource Information System

Scanned Record Cover Page

Inventory No:	CON.217
Historic Name:	Wright, Edward - Barrett, Capt. Richard House
Common Name:	
Address:	577 Monument St
City/Town:	Concord
Village/Neighborhood:	Punkatasset Hill
Local No:	H6-1450
Year Constructed:	c 1820
Architect(s):	
Architectural Style(s):	Federal
Use(s):	Agricultural; Other Manufacturing; Single Family Dwelling House
Significance:	Agriculture; Architecture; Industry
Area(s):	
Designation(s):	
Building Materials(s):	Roof: Wood Shingle Wall: Brick; Wood; Wood Clapboard Foundation: Granite; Stone, Cut



The Massachusetts Historical Commission (MHC) has converted this paper record to digital format as part of ongoing projects to scan records of the Inventory of Historic Assets of the Commonwealth and National Register of Historic Places nominations for Massachusetts. Efforts are ongoing and not all inventory or National Register records related to this resource may be available in digital format at this time.

The MACRIS database and scanned files are highly dynamic; new information is added daily and both database records and related scanned files may be updated as new information is incorporated into MHC files. Users should note that there may be a considerable lag time between the receipt of new or updated records by MHC and the appearance of related information in MACRIS. Users should also note that not all source materials for the MACRIS database are made available as scanned images. Users may consult the records, files and maps available in MHC's public research area at its offices at the State Archives Building, 220 Morrissey Boulevard, Boston, open M-F, 9-5.

Users of this digital material acknowledge that they have read and understood the MACRIS Information and Disclaimer (<http://mhc-macris.net/macrisdisclaimer.htm>)

Data available via the MACRIS web interface, and associated scanned files are for information purposes only. THE ACT OF CHECKING THIS DATABASE AND ASSOCIATED SCANNED FILES DOES NOT SUBSTITUTE FOR COMPLIANCE WITH APPLICABLE LOCAL, STATE OR FEDERAL LAWS AND REGULATIONS. IF YOU ARE REPRESENTING A DEVELOPER AND/OR A PROPOSED PROJECT THAT WILL REQUIRE A PERMIT, LICENSE OR FUNDING FROM ANY STATE OR FEDERAL AGENCY YOU MUST SUBMIT A PROJECT NOTIFICATION FORM TO MHC FOR MHC'S REVIEW AND COMMENT. You can obtain a copy of a PNF through the MHC web site (www.sec.state.ma.us/mhc) under the subject heading "MHC Forms."

Commonwealth of Massachusetts
Massachusetts Historical Commission
220 Morrissey Boulevard, Boston, Massachusetts 02125
www.sec.state.ma.us/mhc

This file was accessed on: Friday, October 30, 2020 at 12:39 PM

FORM B - BUILDING

Assessor's number

USGS Quad

Area(s)

Form Number

CON.217

Massachusetts Historical Commission
80 Boylston Street

H6-1450

CONCORD

217

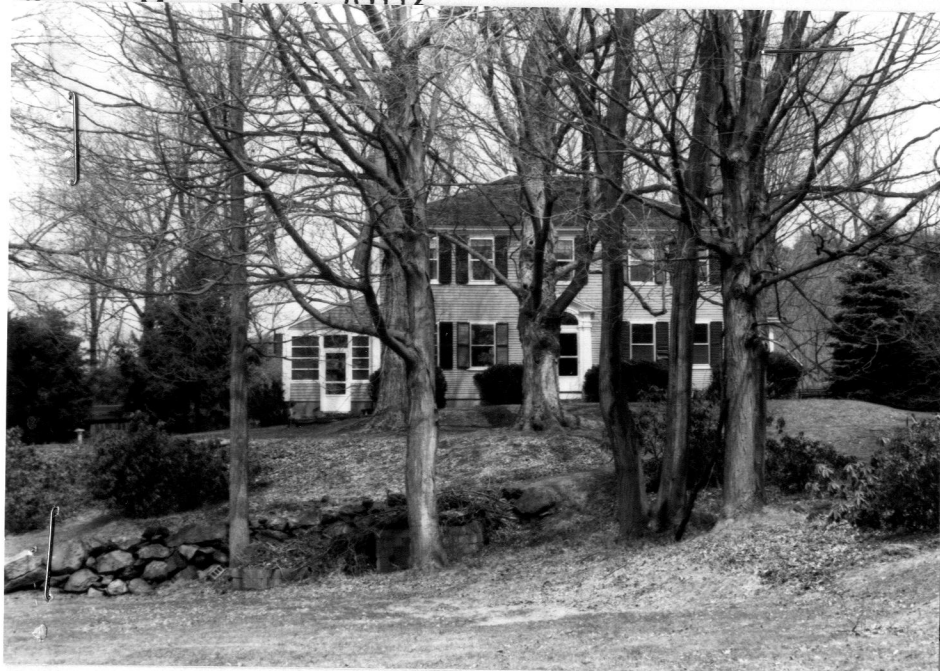

CONCORD

neighborhood or village)

Punkatasset Hill

577 Monument Street

Name Jonathan/Edward Wright House
~~Shattuck/Barrett House~~
dwelling

Present dwelling

Original dwelling
ca. 1810-1817

Construction Wheeler; visual
assessment

Federal period

Form unknown

Architect/Builder

Exterior Material:

Foundation dressed granite

Wall/Trim wood clapboard

Roof and brick
wood shingle

Outbuildings/Secondary Structures
shed

Major Alterations (with dates) 1-story
shed-roofed extension with screened
porch on west side; some window re-
placement.

Condition good

Moved ☒ no ☐ yes Date N/A

Acreage 2.7 acres

Setting Stands side to street, with ever-
greens and stone wall lining roadside.
Faces south over pond and open lawn.

Sketch Map

Draw a map of the area indicating properties within it. Number each property for which individual inventory forms have been completed. Label streets including route numbers, if any. Attach a separate sheet if space is not sufficient here. Indicate North.

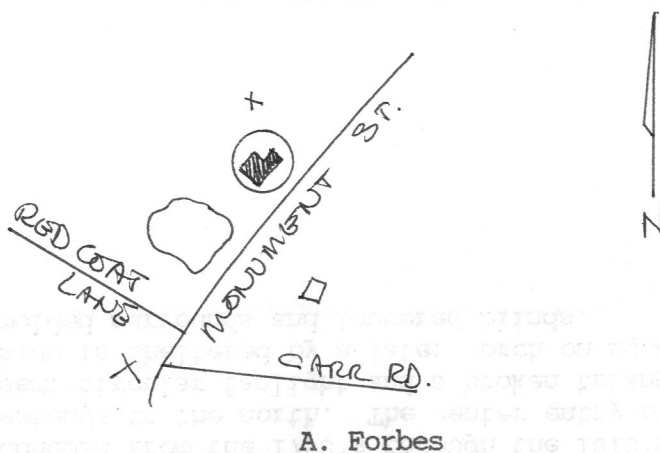

A. Forbes

Recorded by for Concord Hist. Commission

Organization June, 1992

Date (month/day/year)

CON-217

BUILDING FORM

ARCHITECTURAL DESCRIPTION ☐ see continuation sheet

Describe architectural features. Evaluate the characteristics of this building in terms of other buildings within the community.

This house is highly significant as one of Concord's Federal period "brick-enders". Characteristic of its construction date, it is a late period example of the 2-story, five-bay, shallow-hip-roofed Federal house with tall corner chimneys that was popular in Concord from the 1790's through the 1810's. A long two-story clapboarded rear wing extends to the north. The center entry of the main, south-facing facade has a semi-circular fanlight and a broken triangular pediment. A second entry on the east side is sheltered by a later porch on square posts. The windows are 6-over-6-sash, with molded surrounds and louvered blinds.

HISTORICAL NARRATIVE ☒ see continuation sheet

Discuss the history of the building. Explain its associations with local (or state) history. Include uses of the building, and the role(s) the owners/occupants played within the community.

Ruth Wheeler has corrected some mistakes in the order of ownership of this house given by Keyes, although two of her accounts conflict somewhat with each other. Although in her "Concord House File Mo 12" she says the house was built about 1820 by Edward Wright, later research apparently convinced her that the house was built by Edward's father, **Jonathan Wright** (1759-1817.) In 1791 he had bought the old farm here, (part of the original Flint grant,) and by the time of his death in 1817 he had built this "new house," which he willed to Edward along with 69 acres and the old Flint farmhouse to the north.

Edward Wright married Mary Hunt. A farmer who raised broom corn and made brooms on the property, he died in 1825 at the age of 36. Edward and Mary's son, George W. Wright, left Concord to become an early settler of California; he was later the first representative of California to Congress.

After her husband's death Mary Wright sold the old farmhouse to Jonas Monroe (see Form #BX), and this "new" house and the southern part of the farm were acquired by Capt. Nathan Barrett (see also Form #BZ). He owned it only briefly before selling it to (Cont.)

BIBLIOGRAPHY and/or REFERENCES ☒ see continuation sheet

Maps, atlases: 1830, 1852, 1856, 1875, 1889, 1906.
Keyes/Tolman. "Houses in Concord." 1885; rev. 1915 and 1920's.
Town Directories and tax lists.
(Concord Chronicle.
(Wheeler House File #Mo 12. (Cont.)

☒ Recommended for listing in the National Register of Historic Places. *If checked, you must attach a completed National Register Criteria Statement form.*

INVENTORY FORM CONTINUATION SHEET

Community

Property

CONCORD577 Monument Street

Massachusetts Historical Commission
80 Boylston Street
Boston, Massachusetts 02116

Area(s) Form No.

217

HISTORICAL SIGNIFICANCE, cont.

Gen. Joshua Buttrick, who was for many years the highest officer in the Concord Artillery. He is shown here in 1830; his widow still owned the house in 1852. By 1856, however, #577 had been purchased by Henry L. Shattuck. Henry Shattuck (d. 1892), son of Daniel S. and nephew of Lemuel, served for many years as Concord's Superintendent of Public Grounds. He sold the house to Capt. Richard Barrett in 1868.

Richard Barrett was one of the town's most influential citizens of the second half of the nineteenth century. In 1864 he succeeded his father, Capt. Joseph Barrett, as secretary-treasurer of the Middlesex Mutual Fire Insurance Company on Monument Square; he also served as Justice of the Peace. He had attained the rank of Captain in the US Volunteers during the Civil War. Like many proprietors of Concord's large farms in his day, he turned the acreage here into a progressive and successful operation, noted for its vineyard and its heavy crops of hay and vegetables. The story goes that he bought a thousand-dollar piece of land across the street, and paid for it in the first year in a crop of cucumbers.

After Richard Barrett's death in 1887, a sizeable farming operation was apparently run here for a few years by George R. and Nellie Gay as tenant farmers. In 1890-1891 the property was purchased by Judge Henry C. Merwin, associate judge of the District Court, and his wife, formerly of Lowell Road. Judge Merwin, who was also an author, is said to have turned the acreage farm into a breeding farm for both horses and dogs. The Merwins retained ownership of the farm until 1898. The property was subsequently purchased by I. Pierce Sewell, a leader in the Christian Science Church. He owned it until at least 1941; it was later owned by James Howe Volkmann.

BIBLIOGRAPHY, cont.

Wheeler. Climate for Freedom.

_____. "North Bridge Neighbors."

Social Circle Memoirs, III, 167.

Shattuck.

Concord, by Way of Bedford.



CON-217 93

wn Concord ✓
eet 577 Monument ST NW cor
me Red Coat Lane
iginal Use _____
esent Use _____
esent Owner private
te 1810 Style Federal
ource of Date _____
chitect Wright

3. CONDITION: Excellent Good Fair Deteriorated Moved Altered _____
IMPORTANCE of site to area: Great Little None SITE endangered by _____

4. DESCRIPTION

FOUNDATION/BASEMENT: High Regular Low Material: cutstone
WALL COVER: Wood clapboard Brick and Stone Other _____
STORIES: 1 2 3 4 CHIMNEYS: 1 2 3 4 Center End + one well Cluster Elaborate Irregular
ATTACHMENTS: Wings Ell Shed Dependency long 2 story ell Simple/Complex
PORCHES: 1 2 3 4 Portico Balcony brick end side Recessed _____
ROOF: Ridge Gambrel Flat Hip Mansard _____
Tower Cupola Dormer windows Balustrade Grillwork _____
FACADE: Gable End: Front/Side Symmetrical/Asymmetrical Simple/Complex Ornament
Entrance: Front/Side Centered Double Features: door in rounded broken pediment
Windows: Spacing: Regular/Irregular Identical/Varied _____
Corners: Plain Pilasters Quoins Obscured corner boards

OUTBUILDINGS _____ LANDSCAPING _____

5. Indicate location of structure on map below 6. Footage of structure from street 30'
Property has _____ feet frontage on street

Recorder _____

For _____

Photo VI-2
68-516

8-09-06 7. 1. 0 93

NOTE: Recorder should obtain written permission from Commission or sponsoring organization before using this form. (See Reverse Side)

FOR USE WITH IMPORTANT STRUCTURES (Indicate any interior features of note)

Fireplace

Stairway

Other

GIVE A BRIEF DESCRIPTION OF HISTORIC IMPORTANCE OF SITE (Refer and elaborate on theme circled on front of form)

Wrights, Barrett - old families of Concord lived here

REFERENCE (Where was this information obtained? What book, records, etc.)

BIBLIOGRAPHY

Original Owner:

Deed Information: Book Number Page Registry of Deeds

CON-217

Massachusetts Historical Commission
80 Boylston Street
Boston, Massachusetts 02116

Community
CONCORD

Property Address
577 Monument Street

Area(s)	FormNo.
	27

National Register of Historic Places Criteria Statement Form



Check all that apply:

- ☒ Individually eligible ☐ Eligible only in a historic district
☐ Contributing to a potential historic district ☐ Potential historic district

Criteria: ☒ A ☐ B ☒ C ☐ D

Criteria Considerations: ☐ A ☐ B ☐ C ☐ D ☐ E ☐ F ☐ G

Anne McCarthy Forbes

Statement of Significance by _____
The criteria that are checked in the above sections must be justified here.

This house meets the criteria for individual listing on the National Register for its association with the prominent Wright, Buttrick, Shattuck, and Barrett families, all significant farmers, as well as serving their town in other capacities (Criterion A.) As an excellent example of a Federal period "brick-ended" house, it also meets Criterion C. It possesses integrity of design, locatiion, setting, materials, and workmanship, feeling and association.