

# Massachusetts Cultural Resource Information System

## Scanned Record Cover Page

<b>Inventory No:</b>	CON.246
<b>Historic Name:</b>	Farrar, Ephraim House
<b>Common Name:</b>	
<b>Address:</b>	685 Lowell Rd
<b>City/Town:</b>	Concord
<b>Village/Neighborhood:</b>	Hildreth's Corner
<b>Local No:</b>	F6-1644
<b>Year Constructed:</b>	c 1792
<b>Architect(s):</b>	
<b>Architectural Style(s):</b>	Georgian
<b>Use(s):</b>	Single Family Dwelling House
<b>Significance:</b>	Architecture; Industry
<b>Area(s):</b>	
<b>Designation(s):</b>	
<b>Building Materials(s):</b>	Roof: Asphalt Shingle Wall: Wood; Wood Clapboard Foundation: Stone, Uncut



The Massachusetts Historical Commission (MHC) has converted this paper record to digital format as part of ongoing projects to scan records of the Inventory of Historic Assets of the Commonwealth and National Register of Historic Places nominations for Massachusetts. Efforts are ongoing and not all inventory or National Register records related to this resource may be available in digital format at this time.

The MACRIS database and scanned files are highly dynamic; new information is added daily and both database records and related scanned files may be updated as new information is incorporated into MHC files. Users should note that there may be a considerable lag time between the receipt of new or updated records by MHC and the appearance of related information in MACRIS. Users should also note that not all source materials for the MACRIS database are made available as scanned images. Users may consult the records, files and maps available in MHC's public research area at its offices at the State Archives Building, 220 Morrissey Boulevard, Boston, open M-F, 9-5.

Users of this digital material acknowledge that they have read and understood the MACRIS Information and Disclaimer (<http://mhc-macris.net/macrisdisclaimer.htm>)

Data available via the MACRIS web interface, and associated scanned files are for information purposes only. THE ACT OF CHECKING THIS DATABASE AND ASSOCIATED SCANNED FILES DOES NOT SUBSTITUTE FOR COMPLIANCE WITH APPLICABLE LOCAL, STATE OR FEDERAL LAWS AND REGULATIONS. IF YOU ARE REPRESENTING A DEVELOPER AND/OR A PROPOSED PROJECT THAT WILL REQUIRE A PERMIT, LICENSE OR FUNDING FROM ANY STATE OR FEDERAL AGENCY YOU MUST SUBMIT A PROJECT NOTIFICATION FORM TO MHC FOR MHC'S REVIEW AND COMMENT. You can obtain a copy of a PNF through the MHC web site ([www.sec.state.ma.us/mhc](http://www.sec.state.ma.us/mhc)) under the subject heading "MHC Forms."

Commonwealth of Massachusetts  
Massachusetts Historical Commission  
220 Morrissey Boulevard, Boston, Massachusetts 02125  
[www.sec.state.ma.us/mhc](http://www.sec.state.ma.us/mhc)

This file was accessed on: Friday, October 30, 2020 at 10:50 AM

## FORM B - BUILDING

Assessor's number

USGS Quad

Area(s)

Form Number

CON. 246

Massachusetts Historical Commission  
80 Boylston Street  
Boston, Massachusetts 02116

F6-1644

CONCORD

246

CONCORD

Town

SECT A



neighborhood or village)

Hildreth's Corner

685 Lowell Road

Ephraim Farrar House

c Name

dwelling

Present

dwelling

Original

ca. 1792

Construction

wheeler

Georgian vernacular

form

unknown

ct/Builder

## Sketch Map

Draw a map of the area indicating properties within it. Number each property for which individual inventory forms have been completed. Label streets including route numbers, if any. Attach a separate sheet if space is not sufficient here. Indicate North.

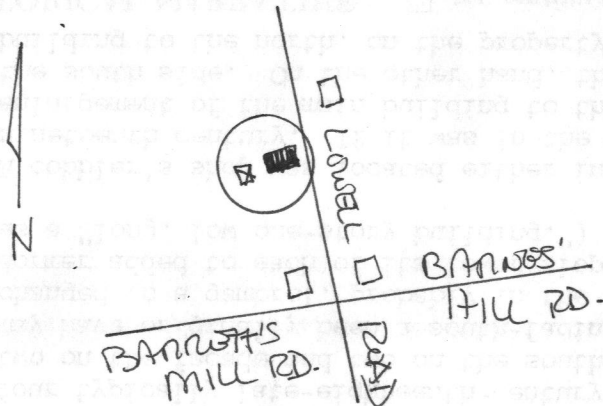

Exterior Material:

rubble

Foundation

wood clapboard

Wall/Trim

asphalt shingle

Roof

Outbuildings/Secondary Structures

one-car garage

Major Alterations (with dates) 20th-century:

roof line changed, shed dormers added;  
foundation rebuilt; house extended to  
rear and 1-story addition built on  
southwest. E. entry replaced.

Condition

fair

Moved ☒ no ☐ yes Date/A

Acreage less than one acre

Recorded by Anne Forbes;  
research by J. Poppel; A. Hoyt  
for Concord Hist. Commission

Organization

June, 1992

Date (month/day/year)

Setting On open yard with picket  
fence at north rear. Fieldstone re-  
taining wall at front. In area of 18th-  
early 20th-C. houses, with modern houses  
interspersed.

ARCHITECTURAL DESCRIPTION ☐ see continuation sheet

*Describe architectural features. Evaluate the characteristics of this building in terms of other buildings within the community.*

The rubble foundation at this house, characteristic of ca. 1900, indicates that the building may have been moved or repositioned on the lot at about that time. Otherwise, in spite of its many additions and alterations, #685 still reveals its likely origin as a tiny cottage of the last decade of the eighteenth century. Although today its facade is in the end wall facing Lowell Road, the position of four typically late-eighteenth-century 6-over-9-sash windows with projecting frames, two on the facade and two on the south side beside a later door, suggest that this may have originally been a south-facing 1 1/2-story "half house." The roof line was changed to a gambrel, probably in the early part of this century, and a long shed dormer added to each of its lower slopes. (Keyes, writing in 1885, refers to this as a "long, low one-story building.")

A cobbler's shop was located either in or near the house for many years in the nineteenth century. If it was in the house, its presence may explain the apparent enlargement of the main building to the rear, and the addition of a second entry on the south side. On the other hand, the cobbler's shop may have been in a separate building to the north, on the property of #699.

HISTORICAL NARRATIVE ☐ see continuation sheet

*Discuss the history of the building. Explain its associations with local (or state) history. Include uses of the building, and the role(s) the owners/occupants played within the community.*

#685 Lowell Road, like #699 to the north, was associated with different Hildreth Corner families, at different periods. It was evidently built by Ephraim Farrar in about 1792. His son, Sumner Farrar (b. 1800), was the next owner; he was a blacksmith, and is shown here on the map of 1830, with a blacksmith shop standing just north of the house. His widow apparently owned the property through the middle of the nineteenth century. His son Willard Farrar (b. 1828) was the next owner. He was an undertaker, and was the predecessor and instructor of Joseph Dee in the funeral business. (See 27-37 Bedford Street.)

By 1871 the property belonged to shoemaker Joseph A. Melvin, who also owned #699 Lowell Road. After his death the house was rented out for a while, and owned for a time by Dr. Theodore Chamberlin. In 1917 it was sold to Jackson Garrett. In 1937 he sold it to Andrew Hepburn, who owned the adjoining property at #8 Barrett's Mill Road (NR).

BIBLIOGRAPHY and/or REFERENCES ☐ see continuation sheet

Maps, atlases: 1830, 1852, 1856, ca. 1871, 1875, 1889, 1906.  
Keyes/Tolman.  
Wheeler House File #Lo8.  
Town directories and tax files.  
Richardson, Concord Chronicle.

☐ Recommended for listing in the National Register of Historic Places. *If checked, you must attach a completed National Register Criteria Statement form.*