

# Massachusetts Cultural Resource Information System

## Scanned Record Cover Page

<b>Inventory No:</b>	CON.1724
<b>Historic Name:</b>	Sheehan, Jeremiah - Carroll, Thomas F. House
<b>Common Name:</b>	Simpson, Martha House
<b>Address:</b>	1045 Main St
<b>City/Town:</b>	Concord
<b>Village/Neighborhood:</b>	West Concord
<b>Local No:</b>	
<b>Year Constructed:</b>	c 1899
<b>Architect(s):</b>	
<b>Architectural Style(s):</b>	Queen Anne
<b>Use(s):</b>	Single Family Dwelling House
<b>Significance:</b>	Architecture
<b>Area(s):</b>	CON.H: Hosmer - Sheehan Farms CON.DM: Main Streetscape VII
<b>Designation(s):</b>	
<b>Building Materials(s):</b>	Roof: Asphalt Shingle Wall: Wood; Wood Clapboard; Wood Shingle Foundation: Concrete Unspecified; Stone, Cut



The Massachusetts Historical Commission (MHC) has converted this paper record to digital format as part of ongoing projects to scan records of the Inventory of Historic Assets of the Commonwealth and National Register of Historic Places nominations for Massachusetts. Efforts are ongoing and not all inventory or National Register records related to this resource may be available in digital format at this time.

The MACRIS database and scanned files are highly dynamic; new information is added daily and both database records and related scanned files may be updated as new information is incorporated into MHC files. Users should note that there may be a considerable lag time between the receipt of new or updated records by MHC and the appearance of related information in MACRIS. Users should also note that not all source materials for the MACRIS database are made available as scanned images. Users may consult the records, files and maps available in MHC's public research area at its offices at the State Archives Building, 220 Morrissey Boulevard, Boston, open M-F, 9-5.

Users of this digital material acknowledge that they have read and understood the MACRIS Information and Disclaimer (<http://mhc-macris.net/macrisdisclaimer.htm>)

Data available via the MACRIS web interface, and associated scanned files are for information purposes only. THE ACT OF CHECKING THIS DATABASE AND ASSOCIATED SCANNED FILES DOES NOT SUBSTITUTE FOR COMPLIANCE WITH APPLICABLE LOCAL, STATE OR FEDERAL LAWS AND REGULATIONS. IF YOU ARE REPRESENTING A DEVELOPER AND/OR A PROPOSED PROJECT THAT WILL REQUIRE A PERMIT, LICENSE OR FUNDING FROM ANY STATE OR FEDERAL AGENCY YOU MUST SUBMIT A PROJECT NOTIFICATION FORM TO MHC FOR MHC'S REVIEW AND COMMENT. You can obtain a copy of a PNF through the MHC web site ([www.sec.state.ma.us/mhc](http://www.sec.state.ma.us/mhc)) under the subject heading "MHC Forms."

Commonwealth of Massachusetts  
Massachusetts Historical Commission  
220 Morrissey Boulevard, Boston, Massachusetts 02125  
[www.sec.state.ma.us/mhc](http://www.sec.state.ma.us/mhc)

This file was accessed on: Friday, October 30, 2020 at 11:39 AM

# FORM B – BUILDING

Assessor's Number USGS Quad Area(s) Form Number

MASSACHUSETTS HISTORICAL COMMISSION  
MASSACHUSETTS ARCHIVES BUILDING  
220 MORRISSEY BOULEVARD  
BOSTON, MASSACHUSETTS 02125

3733	Concord	H,DM	CON.1724
------	---------	------	----------

Town/City: Concord

Place: (neighborhood or village):  
West Concord

## Photograph



Address: 1045 Main St.

Historic Name: Jeremiah Sheehan - Thomas F. Carroll House

Uses: Present: Single-family Residential

Original: Single-family Residential

Date of Construction: ca. 1899

Source: Historic Maps and Deed Research

Style/Form: Queen Anne

Architect/Builder:

Exterior Material:

Foundation: Stone and Concrete

Wall/Trim: Wood Clapboards/Wood Shingles

Roof: Asphalt Shingles

Outbuildings/Secondary Structures:

A one-story, one-car garage is located southwest of the residence - constructed 1974.

Major Alterations (with dates):

## Locus Map

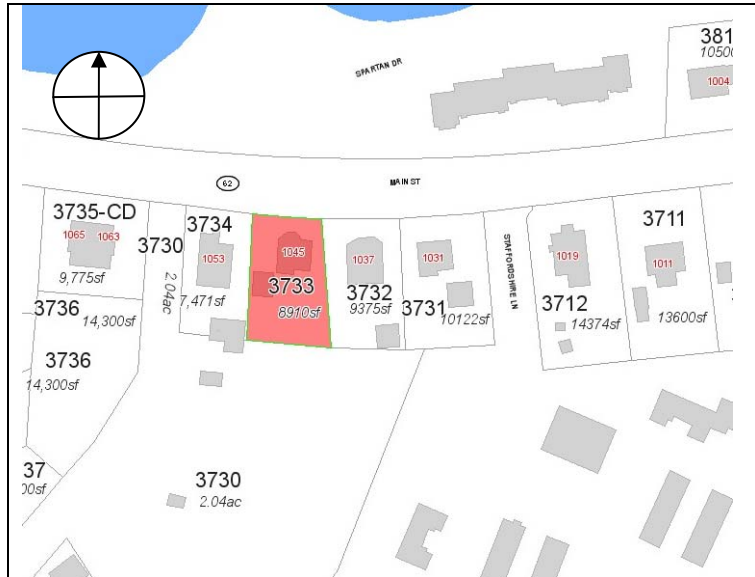

Condition: Good

Moved: no ☒ yes ☐ Date:

Acreage: .20 Acres

Setting: Located on a small narrow lot in a residential area located along Main Street to the east of the village of Concord Junction, the business center of West Concord.

Recorded by: Geoffrey Melhuish

Organization: ttl-architects

Date (month / year): July 2013

RECEIVED

SEP 17 2013

MASS. HIST. COMM.

# INVENTORY FORM B CONTINUATION SHEET

CONCORD

1045 MAIN STREET

## MASSACHUSETTS HISTORICAL COMMISSION

220 MORRISSEY BOULEVARD, BOSTON, MASSACHUSETTS 02125

Area(s) Form No.

H,DM

CON.1724

☐ Recommended for listing in the National Register of Historic Places.

*If checked, you must attach a completed National Register Criteria Statement form.*

*Use as much space as necessary to complete the following entries, allowing text to flow onto additional continuation sheets.*

### ARCHITECTURAL DESCRIPTION:

*Describe architectural features. Evaluate the characteristics of this building in terms of other buildings within the community.*

1031-1065 Main Street consist of five, gable front residences constructed between ca. 1865 and ca. 1900. The earliest property, located at 1053 Main Street (CON.1725) is a modest one-and-one-half story side hall front gable which has undergone alterations including the addition of the late-nineteenth century ell, the mid-twentieth century through cornice dormers on the principal block, a shed roof dormer on the principal block and side ell and the application of sawtooth vertical board trim on the gable roof entry porch. 1031, 1037, and 1045 Main Street (CON.1722-171724) are similar two-and-one-half story, wood frame front gable Queen Anne residences that were constructed ca 1890-ca. 1899. Each of the properties features a wrap-around porch and a two-story side ell. Typical of the Queen Anne style, 1045 Main Street still retains many of its original 2/2 double-hung wood sash windows as well decorative cut shingles, both staggered and scalloped, within its gables and a band between the first and second floors. Both 1031 and 1037 Main Street have undergone siding replacement and the installation of vinyl replacement windows on many of the windows. In addition, 1037 has had a two-story addition to the side ell. 1063/1065 Main Street (CON.1726) constructed ca. 1900 is a two-and-one-half story front gable Queen Anne inspired double-house. The residence features a prominent pedimented front gable resting on two-story bay windows flanking the paired entry.

1045 Main Street (CON.1724) is a two-and-one-half story, wood frame residence constructed in the Queen Anne style. The building adopts an L-shaped plan on a stone and concrete foundation. The three-by-three bay building faces north and is set back approximately twenty feet from the road on a level lot. The building terminates in a front gable roof sheathed with asphalt shingles. One interior brick chimney pierces the ridge of the roof and one interior brick chimney pierces the west roof plane. A two-story, one-by-two bay ell projects out from the west elevation. The ell is capped by a gable roof which intersects the west roof plane of the principal block. Both the front facing gable and gable of the ell are clad with variegated wood shingles. The exterior walls of the residence are clad with wood clapboards on the first floor and wood shingles on the second. A slight flare is visible between the first and second floor which is clad with two-courses of fish scale shingles. A wrap-around porch is featured at the northeast corner of the facade. The porch is capped by a hipped roof sheathed with asphalt shingles; a gable pediment marks the principal entry. The roof of the porch is supported by wood posts resting on a raised wood deck. Access is provided by an entry at the west end of the facade. Two 2/2 double-hung wood sash windows are located to the east of the entry. Each opening is set within a simple wood surround. The second floor features an infilled opening above the entry and a 6/6 double-hung wood sash stacked above the first floor openings. A one-story, one-car garage is located southwest of the residence. The front gable roof is sheathed with asphalt shingles and the walls are clad with painted wood shingles. 1045 Main Street is an example of a modest turn of the century Queen Anne that retains a high degree of integrity.

### HISTORICAL NARRATIVE

*Discuss the history of the building. Explain its associations with local (or state) history. Include uses of the building, and the role(s) the owners/occupants played within the community.*

The area along Main Street, east of Concord Junction, from Old Bride Road to Route 2 is expressive of the late nineteenth century residential development brought on by the growing industries of West Concord and the expanding State Reformatory.<sup>1</sup> Much of this development occurred on nineteenth century farmland including lots subdivided from the Hosmer Sheehan (CON.1721) farm by farmer and building contractor Jeremiah Sheehan and Harvey Wheeler, the owner of the Boston Harness Company. The 1988 MHC Streetscape form: Main Street (CON.DM) indicates that *the first parcels to be sold by Jeremiah Sheehan and his brother, Daniel, who lived at 1053 Main Street, were the properties at 1031-1045 Main Street,*

<sup>1</sup> Anne Forbes. Massachusetts Historical Commission: Main Street (CON.DM). Concord Historical Commission, March 1988. on file at Massachusetts Historical Commission. Boston, MA (also Massachusetts Cultural Resource Information System [MACRIS], via [www.state.ma.us/sec/mhc](http://www.state.ma.us/sec/mhc)).

**INVENTORY FORM B CONTINUATION SHEET**

CONCORD

1045 MAIN STREET

**MASSACHUSETTS HISTORICAL COMMISSION**

220 MORRISSEY BOULEVARD, BOSTON, MASSACHUSETTS 02125

Area(s) Form No.

H,DM

CON.1724

in the 1890s. Later twentieth century development of the farmland took place in 1935 for Fairview Park, overlooking the golf course to the south of Old Marlboro Road. Between 1946 and 1953 most of the remaining farm land between Old Marlboro Road and Main Street was subdivided.

1045 Main Street (CON.1724) was constructed ca. 1899. The property is identified on the 1906 map as the property of Jeremiah Sheehan who was residing across the street at the Hosmer Sheehan Farm at 1024 Main Street (CON.H). For much of the twentieth century, the property was maintained as a rental property. Census records indicate that the property was the rental residence of Thomas F. Carroll (b. 1850), a flagman on the railroad and his wife, Maria T. Carroll in 1910 and 1920. They shared the residence with their daughter, Etta (b. 1880) and their two sons, Charles (b. 1882) and Thomas (b. 1884). In 1940, the property was the rental residence of Martha Simpson. The current residence, Paul E. and Sally Anne Demille purchased the property in 1955 from the Tremont Investment Company.<sup>2</sup>

**BIBLIOGRAPHY and/or REFERENCES**

Ancestry.com. <http://www.ancestry.com>. Accessed May 7- May 17, 2013.

Concord Building Inspection and Zoning Enforcement Division Records. [Town of Concord]

Forbes, Anne. Massachusetts Historical Commission: Main Street (CON.DM). Concord Historical Commission, March 1988. on file at Massachusetts Historical Commission. Boston, MA (also Massachusetts Cultural Resource Information System [MACRIS], via [www.state.ma.us/sec/mhc](http://www.state.ma.us/sec/mhc)).

Forbes, Anne McCarthy. *West Concord: Survey of historical and architectural resources, Concord Massachusetts*. Concord, Mass: Concord Historical Commission, 1989. [Concord Free Public Library]

Middlesex South Registry of Deeds. <http://www.sec.state.ma.us/rod/rodmidsth/midsthidx.htm>. Accessed May 7- May 17, 2013.

Sanborn Fire Insurance Maps. August 1887; September 1892; May 1897 January 1903; December 1909; August 1918; May 1927; May 1927-August 1947. [State Library of Massachusetts]

\_\_\_\_\_. Middlesex County. Boston: Geo. H Walker & Co, 1889. [online at <http://www.historicmapworks.com>]

\_\_\_\_\_. Concord Junction, Massachusetts. George E Norris, 1893. [online at <http://www.historicmapworks.com>]

\_\_\_\_\_. *Middlesex County*. Boston: Geo. H Walker & Co, 1906. [online at <http://www.historicmapworks.com>]

Street Directories: 1886, 1892, 1896, 1901, 1905/06, 1909/10, 1913, 1917, 1921, 1925, 1929, 1934, 1937, 1941, 1947, and 1950. [State Library of Massachusetts and online at <http://www.ancestry.com>.]

\_\_\_\_\_. Survey of historical and architectural resources, Concord Massachusetts. Concord, Mass: Concord Historical Commission, 2002. [Concord Free Public Library]

<sup>2</sup> Middlesex South Registry of Deeds Book 8544 page 221.

INVENTORY FORM B CONTINUATION SHEET

CONCORD 1045 MAIN STREET

MASSACHUSETTS HISTORICAL COMMISSION  
220 MORRISSEY BOULEVARD, BOSTON, MASSACHUSETTS 02125

Area(s) Form No.

H,DM	CON.1724
------	----------

