

Massachusetts Cultural Resource Information System

Scanned Record Cover Page

Inventory No:	CON.470
Historic Name:	Damon, Ralph House
Common Name:	
Address:	1623 Main St
City/Town:	Concord
Village/Neighborhood:	West Concord
Local No:	233
Year Constructed:	1884
Architect(s):	
Architectural Style(s):	Shingle Style
Use(s):	Single Family Dwelling House
Significance:	Architecture
Area(s):	CON.D: Westvale
Designation(s):	
Building Materials(s):	Roof: Asphalt Shingle Wall: Wood; Wood Shingle



The Massachusetts Historical Commission (MHC) has converted this paper record to digital format as part of ongoing projects to scan records of the Inventory of Historic Assets of the Commonwealth and National Register of Historic Places nominations for Massachusetts. Efforts are ongoing and not all inventory or National Register records related to this resource may be available in digital format at this time.

The MACRIS database and scanned files are highly dynamic; new information is added daily and both database records and related scanned files may be updated as new information is incorporated into MHC files. Users should note that there may be a considerable lag time between the receipt of new or updated records by MHC and the appearance of related information in MACRIS. Users should also note that not all source materials for the MACRIS database are made available as scanned images. Users may consult the records, files and maps available in MHC's public research area at its offices at the State Archives Building, 220 Morrissey Boulevard, Boston, open M-F, 9-5.

Users of this digital material acknowledge that they have read and understood the MACRIS Information and Disclaimer (<http://mhc-macris.net/macrisdisclaimer.htm>)

Data available via the MACRIS web interface, and associated scanned files are for information purposes only. THE ACT OF CHECKING THIS DATABASE AND ASSOCIATED SCANNED FILES DOES NOT SUBSTITUTE FOR COMPLIANCE WITH APPLICABLE LOCAL, STATE OR FEDERAL LAWS AND REGULATIONS. IF YOU ARE REPRESENTING A DEVELOPER AND/OR A PROPOSED PROJECT THAT WILL REQUIRE A PERMIT, LICENSE OR FUNDING FROM ANY STATE OR FEDERAL AGENCY YOU MUST SUBMIT A PROJECT NOTIFICATION FORM TO MHC FOR MHC'S REVIEW AND COMMENT. You can obtain a copy of a PNF through the MHC web site (www.sec.state.ma.us/mhc) under the subject heading "MHC Forms."

Commonwealth of Massachusetts
Massachusetts Historical Commission
220 Morrissey Boulevard, Boston, Massachusetts 02125
www.sec.state.ma.us/mhc

This file was accessed on: Friday, October 30, 2020 at 12:10 PM

FORM B - BUILDING

MASSACHUSETTS HISTORICAL COMMISSION
80 BOYLSTON STREET
BOSTON, MA 02116



Sketch Map: Draw map showing property's location in relation to nearest cross streets and/or geographical features. Indicate all buildings between inventoried property and nearest intersection(s). Indicate north

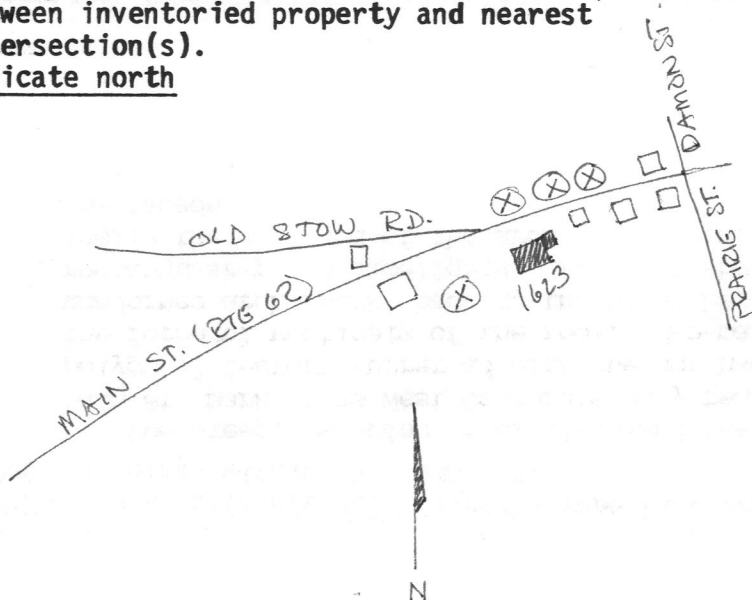

UTM REFERENCE _____

USGS QUADRANGLE _____

SCALE _____

Pl. W CONCORD
USGS - MAY
SECT - A

AREA



FORM NO.

233
470

West Concord

Address 1623 Main St.

Historic Name Ralph Damon House

Present Residential

Original Residential

DESCRIPTION

1884

Notes Owner; diaries & memoirs

Shingle style

Architect _____

Exterior Wall Fabric Wood shingle

Outbuildings _____

Major Alterations (with dates) _____

Attached garage, e. end-1987

Condition good

Moved _____ Date _____

Acreage 38,416 sq. ft.

Setting Mixed residential area on major

street lined with single- and two-

family, wood-frame houses of early 19th

to late 20th-century date.

Recorded by A. Forbes

Organization for Concord Hist. Comm.

Date 2/15/88

NATIONAL REGISTER CRITERIA STATEMENT (if applicable)

ARCHITECTURAL SIGNIFICANCE Describe important architectural features and evaluate in terms of other buildings within the community.

The steep, sweeping, roof lines and the complex massing of ells and gables at #1623 Main St. mark it as West Concord's only real representative of the Shingle Style. A polygonal 2-story turret adjoins the northwest corner, and two high, hefty chimneys crown the forceful verticals of the roof. The main entry, which is recessed under a deep, unadorned arch, harks back to the Greek Revival style, in its 6-paneled door and rectangular-paned sidelights. At right angles to it, a second entry door is inserted inside the east end of the arch. A broken, flared skirt occurs at second story level on the facade.

HISTORICAL SIGNIFICANCE Explain the role owners played in local or state history and how the building relates to the development of the community.

#1623 Main St. was built for Ralph Damon and his wife at the time of their marriage in 1884. Ralph's father, Edward, of the Damon Manufacturing Co., gave the land; his father-in-law, J.W. Kennan, paid for the house. Ralph Damon was involved for most of the 1880's and '90's in the management of his father's company. In 1889, the company was reorganized with Ralph as president; with his father's health failing, Ralph oversaw the business through its final years, until its closing in 1898.

BIBLIOGRAPHY and/or REFERENCES

- Walker, George, and Co. Map of Westvale, Part of Concord, 1889.
 Smith, Henry. Memoirs: Edward Carver Damon. Concord, 1902.
 Interviews with Renee Garrelick, (3/88), and Anne Damon, (4/88).