

**United States Department of the Interior  
Heritage Conservation and Recreation Service**

**National Register of Historic Places  
Inventory—Nomination Form**

See instructions in *How to Complete National Register Forms*  
Type all entries—complete applicable sections

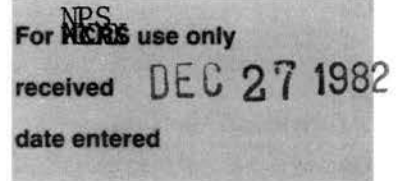

**1. Name**

historic Colonel Roger Brown House (preferred)

and/or common Lot Conant of 1775 House

**2. Location**

street & number 1694 Main Street

N/A not for publication

city, town Concord

N/A vicinity of [redacted]

state MA

code 025

county Middlesex

code 017

**3. Classification**

<b>Category</b>	<b>Ownership</b>	<b>Status</b>	<b>Present Use</b>	
<input type="checkbox"/> district	<input type="checkbox"/> public	<input checked="" type="checkbox"/> occupied	<input type="checkbox"/> agriculture	<input type="checkbox"/> museum
<input checked="" type="checkbox"/> building(s)	<input checked="" type="checkbox"/> private	<input type="checkbox"/> unoccupied	<input type="checkbox"/> commercial	<input type="checkbox"/> park
<input type="checkbox"/> structure	<input type="checkbox"/> both	<input type="checkbox"/> work in progress	<input type="checkbox"/> educational	<input checked="" type="checkbox"/> private residence
<input type="checkbox"/> site	<b>Public Acquisition</b>	<b>Accessible</b>	<input type="checkbox"/> entertainment	<input type="checkbox"/> religious
<input type="checkbox"/> object	<u>N/A</u> in process	<input checked="" type="checkbox"/> yes: restricted	<input type="checkbox"/> government	<input type="checkbox"/> scientific
	<input type="checkbox"/> being considered	<input type="checkbox"/> yes: unrestricted	<input type="checkbox"/> industrial	<input type="checkbox"/> transportation
		<input type="checkbox"/> no	<input type="checkbox"/> military	<input type="checkbox"/> other:

**4. Owner of Property**

name Gail Reitzel

street & number 3931 Tynewick Drive

city, town Silver Spring

N/A vicinity of

state Maryland

**5. Location of Legal Description**

courthouse, registry of deeds, etc. South Middlesex Registry of Deeds

street & number 40 Thorndike Street

city, town Cambridge

state MA

**6. Representation in Existing Surveys**

Inventory of Historic Assets of  
title The Commonwealth of MA #129

has this property been determined eligible? ☐ yes ☒ no

date November, 1977

☐ federal ☒ state ☐ county ☐ local

depository for survey records Massachusetts Historical Commission

city, town Boston

state MA

## 7. Description

Colonel Roger Brown House, Concord, MA

### Condition

☐ excellent  
☒ good  
☐ fair

☐ deteriorated  
☐ ruins  
☐ unexposed

### Check one

☐ unaltered  
☒ altered

### Check one

☒ original site  
☐ moved date N/A

### Describe the present and original (if known) physical appearance

The Colonel Roger Brown House sits on a landscaped  $\frac{1}{4}$  acre site at the corner of Main Street and Pond Lane (part of the original road from Concord to Lancaster) in a business zoned area of Concord near the Assabet River. It is adjacent to the Damon Mill (NR) with which its early history is closely associated.

The house was constructed to its present form in 1775. Although not firmly documented, local tradition holds that an earlier house on the site was rebuilt during that year. This is substantiated by certain architectural features; however, the configuration of the structure prior to 1775 is not known.

The house is  $2\frac{1}{2}$  stories tall with a central chimney, symmetrical five-bay facade and a rectangular (28'8" x 36'8") four room plan. A fieldstone foundation, partially exposed, supports the structure. The exterior is sheathed with painted clapboards, framed by an undecorated cornice and corner boards. The gable roof is of asphalt shingles and the rectangular stuccoed chimney is offset from the ridge pole towards the front. The symmetrical main facade is dominated by an enclosed entry pavillion with side windows, a pedimented gable roof, corner boards, and pilasters at either side of the panelled entry door. All the windows in the building contain 6/6 double hung sash. The lower front and rear, and all end windows, are capped with a heavy, but simple projecting moulding.

The full basement contains an unusual chimney brick vaulted foundation. Off each corner is a brick pier for hearth support on the first floor. The chimney consists of 2 side-by-side flues separated today by small bathrooms that rejoin in the attic and curve to avoid the ridge pole.

The first floor contains larger front rooms with doors off the front entry pavillion and stairwell. Each has a brick fireplace and hearth set in a full panelled wall; the remaining 3 walls are pine feathered panelling to the wainscot chair-rail. The panelling of these two rooms and the front entry and stairwell is in excellent condition. The wall partition which separated the rear two smaller rooms has been removed to form a larger kitchen/dining area.

The second floor also has the typical four corner room layout. The two larger front rooms contain well preserved wainscot panelling. Lath and plaster walls and ceilings with boxed beams and gunstock corner posts are in good condition.

The attic is unfinished, displaying hand hewn and pegged rafter beams, purlins and jacks. To date, no archaeological resources have been identified associated with the house, although the potential for their existence should not be discounted. Included within the present property bounds is a one-story below grade studio building (c. 1960), well screened by siting and landscaping.

## 8. Significance

Colonel Roger Brown House, Concord, MA

Period	Areas of Significance—Check and justify below			
<input type="checkbox"/> prehistoric	<input type="checkbox"/> archeology-prehistoric	<input type="checkbox"/> community planning	<input type="checkbox"/> landscape architecture	<input type="checkbox"/> religion
<input type="checkbox"/> 1400–1499	<input type="checkbox"/> archeology-historic	<input type="checkbox"/> conservation	<input type="checkbox"/> law	<input type="checkbox"/> science
<input type="checkbox"/> 1500–1599	<input type="checkbox"/> agriculture	<input type="checkbox"/> economics	<input type="checkbox"/> literature	<input type="checkbox"/> sculpture
<input type="checkbox"/> 1600–1699	<input checked="" type="checkbox"/> architecture	<input type="checkbox"/> education	<input checked="" type="checkbox"/> military	<input type="checkbox"/> social/
<input checked="" type="checkbox"/> 1700–1799	<input type="checkbox"/> art	<input type="checkbox"/> engineering	<input type="checkbox"/> music	<input type="checkbox"/> humanitarian
<input checked="" type="checkbox"/> 1800–1899	<input type="checkbox"/> commerce	<input type="checkbox"/> exploration/settlement	<input type="checkbox"/> philosophy	<input type="checkbox"/> theater
<input type="checkbox"/> 1900–	<input type="checkbox"/> communications	<input checked="" type="checkbox"/> industry	<input type="checkbox"/> politics/government	<input type="checkbox"/> transportation
		<input type="checkbox"/> invention		<input type="checkbox"/> other (specify)

Specific dates 1775 Builder/Architect Unknown

### Statement of Significance (in one paragraph)

The Colonel Roger Brown House retains integrity of location, setting, materials, workmanship, feeling, association, and design since 1775. The building is distinguished architecturally, combining features both typical and unusual of late 18th century houses in the area which may indicate a pre-1775 original construction date. Its primary significance, however, lies in its association with persons of local industrial and military importance throughout its history. The house therefore meets Criteria A, B, and C of the National Register of Historic Places.

In the late 1600's the property was associated with a small grist mill located most likely to the rear of the present Damon Mill (NR) near the site of a c.1660 bog iron works. The owner/operator of the mill built his house on or near the site of the present house. In 1715 the property, including the mills, passed from The George Hayward estate to the Conant family who owned it for several subsequent generations. The Conant family had migrated westward from Salem, Massachusetts and were grand-and great-grand-sons of Roger Conant, the puritan founder of Salem. They were farmers, running small grist mills and sawmills in the Concord area. Conant remains a prominent name in Concord, although their early recorded history in the town is sparse.

Roger Brown, the son of William Brown of Framingham, a fulling mill operator, and Elizabeth Conant of Concord, was born in Framingham in 1749. By the mid-1770's, Roger Brown owned the Conant house and a portion of the Mill property in Concord (perhaps his mother's inheritance). Local tradition refers to the house as the "1775 House", as carpenters constructing or rebuilding the structure to its present configuration took arms at the Concord Bridge on April 18 of that year. Roger was, at that time, a member of Captain Cleasons' Framingham Minutemen and was recorded by roll on April 19, 1775 as Corporal Roger Brown. He served for ten days. In 1776, Roger Brown joined Captain Joseph Hosmer's Light Infantry Co. and later that year was drafted by Captain Hubbard's Concord Infantry. Apparently, he had then settled in Concord in his completed house. Roger Brown prospered as a farmer and textile miller, increasing his land holdings in Concord over the years. He married a Hartwell from Lincoln in 1779.

In the early 19th century, John Brown, born 1783 to Roger Brown, inherited the property. With his cousin, Ephraim Hartwell of New Hampshire, he purchased the remaining Conant Mill property in 1808. As partners, they erected a five-story wood frame cotton spinning mill on the site of the present Damon Mill (NR). This marked a change in industrial focus from providing a support service for local agriculture to commercial production on an expanded scale, although apparently with limited success. At about the same time, John Brown built his own house nearby and married Sarah Sogswell, grand daughter of William Dawes.

**United States Department of the Interior  
National Park Service**

**National Register of Historic Places  
Inventory—Nomination Form**

For NPS use only

received

date entered

Continuation sheet Colonel Roger Brown House Item number 8

Page 1

Five years later Hartwell sold a third share to his uncle, Ephraim Bellows, who, four years later, bought out four-fifths of John Brown's interest. Bellows took the mill operation into more prosperity for a time, but business fell off in the 1820's. Despite a lawsuit by John Brown against Bellows to regain control of the mill that was later won, the property was sold. Thus ended the Brown Family's relation to the mill which subsequently burned in 1862 and was replaced by the Damon Mill (NR).

As homestead to Roger Brown and birthplace to John Brown, the property was home to two significant citizen soldier carriers. Following his involvement at Concord on April 19, 1775, Roger Brown returned in 1786 as Captain of a company to suppress "Shay's Rebellion". Captain Brown quelled insurrections in Cambridge and communities throughout western Massachusetts which had been generated by general dissatisfaction with the fledgling Federal Government. Following Shay's Rebellion, he was elevated to the rank of Colonel. During the War of 1812, Lt. John Brown participated in holding Dorchester Heights against the British.

Architecture:

Although tradition ascribes a 1775 construction date to the house, evidence for an early to mid 18th century date is fairly strong and includes: projecting window mouldings; the longitudinal, side-by-side chimney flue arrangement; and the design of the entry porch. The porch resembles a form found on early houses in Concord itself, and elsewhere in Middlesex County (Concord, John Bull House c.1753 and Peter Bulkely Esq. House 1667, both NR; Cambridge, Hooper-Lee-Nichols House c.1685) (NR). The two room deep central chimney interior floor plan with fireplaces in the front rooms is fairly uncommon. More typical plans of the late 18th century consist of five rooms around a central chimney or a four room plan with central hallway and twin chimneys. Possibly, the house was originally one room deep and enlarged to its more substantial, high style appearance as a reflection of settlement growth in Concord.



## 9. Major Bibliographical References

Biography of Roger Conant; Middlesex Co. Registry of Deeds; Hurd, History of Middlesex Co.; Brown Family Geneology, Brown; Corinthian Lodge, Biographies of Past Members, Factory Village, paper by Chas. Hammond.

## 10. Geographical Data

Acreage of nominated property  $\frac{1}{4}$

Quadrangle name Maynard, MA

Quadrangle scale 1:25000

UMT References

A 

1	9
---	---

3	0	1	9	0	0
---	---	---	---	---	---

4	7	0	2	6	9	0
---	---	---	---	---	---	---

  
Zone Easting Northing

B 

--	--

--	--	--	--

--	--	--	--	--	--

  
Zone Easting Northing

C 

--	--

--	--	--	--

--	--	--	--	--	--

D 

--	--

--	--	--	--

--	--	--	--	--	--

E 

--	--

--	--	--	--

--	--	--	--	--	--

F 

--	--

--	--	--	--

--	--	--	--	--	--

G 

--	--

--	--	--	--

--	--	--	--	--	--

H 

--	--

--	--	--	--

--	--	--	--	--	--

**Verbal boundary description and justification** From the most easterly point of the property's frontage its side runs north to a point; thence southwesterly to a point 10' off the rear brick warehouse structure, parallel to that westerly to intersection with stone retaining wall along Pond Lane (including the 20 year old 400 s.f. 1-story below grade studio building);

**List all states and counties for properties overlapping state or county boundaries** turning with the stonewall back across the frontage to the easterly point. These boundaries state follow the property's lot code county code

state N/A lines. code county code

## 11. Form Prepared By

name/title Virginia Adams, Program Assistant with William H. Sullivan, General Partner

organization Massachusetts Historical Commission Mill Square Partnership date August, 1982

street & number 294 Washington Street telephone 727-8470

city or town Boston state MA

## 12. State Historic Preservation Officer Certification

The evaluated significance of this property within the state is:

☐ national ☐ state ☒ local

As the designated State Historic Preservation Officer for the National Historic Preservation Act of 1966 (Public Law 89-665), I hereby nominate this property for inclusion in the National Register and certify that it has been evaluated according to the criteria and procedures set forth by the Heritage Conservation and Recreation Service.

State Historic Preservation Officer signature

Valerie Ann Talmage

title Executive Director, Massachusetts Historical Commission date Dec 15, 1982

For HCRS use only

I hereby certify that this property is included in the National Register

Entered in the  
National Register

date 1/27/83

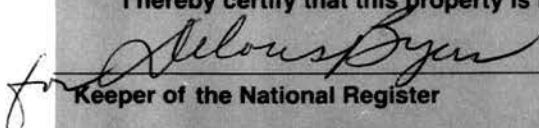
for  Keeper of the National Register

Attest:

date

Chief of Registration

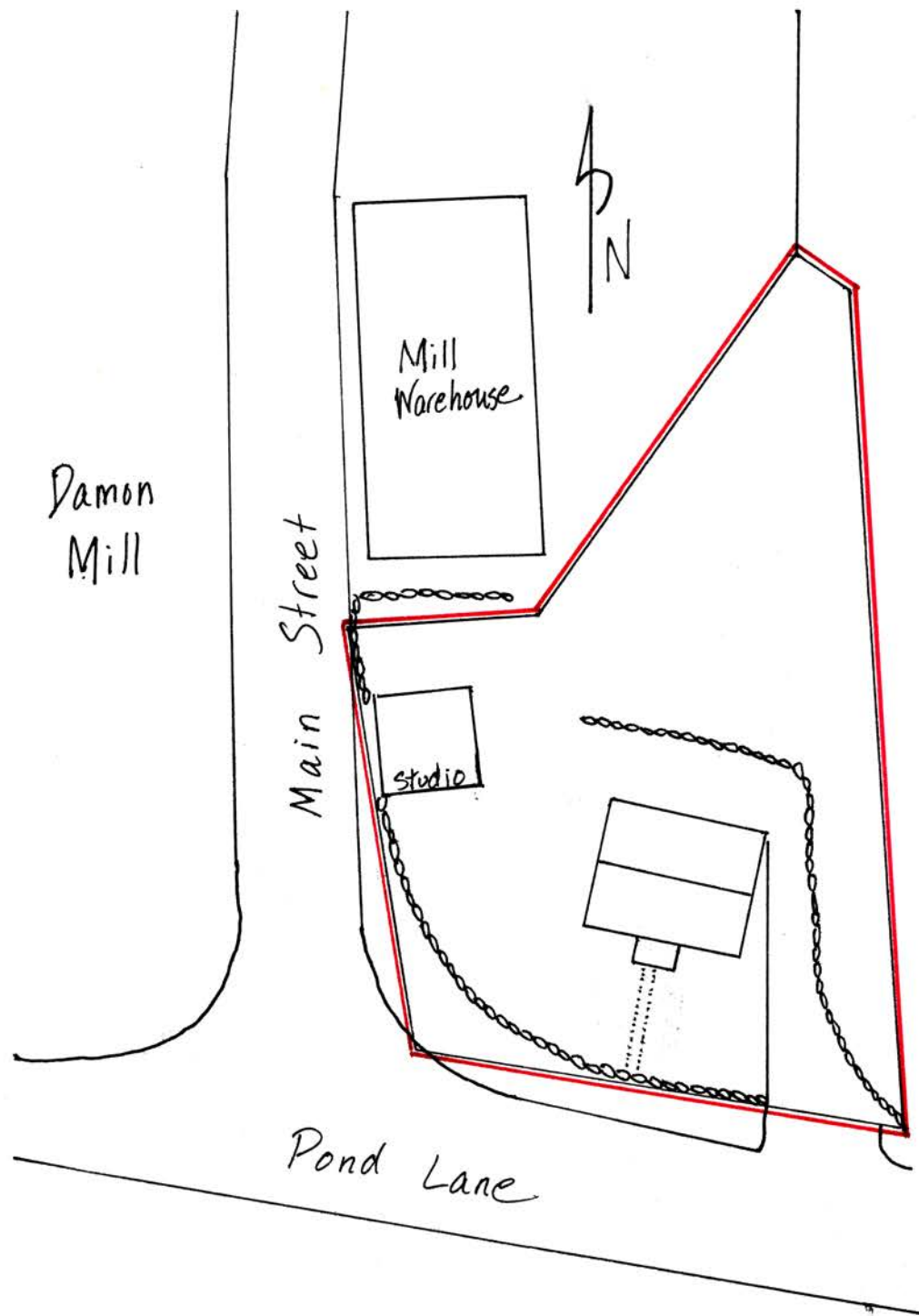

Col. Roger Brown House  
1694 Main Street  
Concord  
Middlesex County, MA

Sketch Map  
scale: 1" = 20' approx.  
date: February 1981  
source: Damonmill Square  
Partnership





COL. ROGER BROWN HOUSE

CONCORD, MASSACHUSETTS

UTM REFERENCE: 19/301900/4702700<sup>690</sup>

CONVERSION  
SCALES

Feet Meters

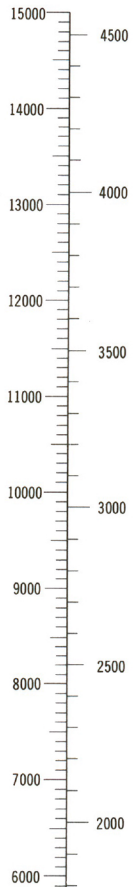

CONCORD 1.3 MI.  
6 MI. TO MASS. 128  
NORTH CAMBRIDGE (U.S. 3) 13 MI.

CONCORD  
MAINE





1. Northeasterly view from south side of Main Street of Col. Roger Brown House, 1694 Main Street. (Photograph: David Rhubi, October 1980)