

Massachusetts Cultural Resource Information System

Scanned Record Cover Page

Inventory No:	CON.AB
Historic Name:	Cottage Lane Streetscape
Common Name:	
Address:	
City/Town:	Concord
Village/Neighborhood:	Concord Center
Local No:	
Year Constructed:	
Architect(s):	
Architectural Style(s):	
Use(s):	Residential District
Significance:	Architecture; Community Planning
Area(s):	
Designation(s):	
Building Materials(s):	



The Massachusetts Historical Commission (MHC) has converted this paper record to digital format as part of ongoing projects to scan records of the Inventory of Historic Assets of the Commonwealth and National Register of Historic Places nominations for Massachusetts. Efforts are ongoing and not all inventory or National Register records related to this resource may be available in digital format at this time.

The MACRIS database and scanned files are highly dynamic; new information is added daily and both database records and related scanned files may be updated as new information is incorporated into MHC files. Users should note that there may be a considerable lag time between the receipt of new or updated records by MHC and the appearance of related information in MACRIS. Users should also note that not all source materials for the MACRIS database are made available as scanned images. Users may consult the records, files and maps available in MHC's public research area at its offices at the State Archives Building, 220 Morrissey Boulevard, Boston, open M-F, 9-5.

Users of this digital material acknowledge that they have read and understood the MACRIS Information and Disclaimer (<http://mhc-macris.net/macrisdisclaimer.htm>)

Data available via the MACRIS web interface, and associated scanned files are for information purposes only. THE ACT OF CHECKING THIS DATABASE AND ASSOCIATED SCANNED FILES DOES NOT SUBSTITUTE FOR COMPLIANCE WITH APPLICABLE LOCAL, STATE OR FEDERAL LAWS AND REGULATIONS. IF YOU ARE REPRESENTING A DEVELOPER AND/OR A PROPOSED PROJECT THAT WILL REQUIRE A PERMIT, LICENSE OR FUNDING FROM ANY STATE OR FEDERAL AGENCY YOU MUST SUBMIT A PROJECT NOTIFICATION FORM TO MHC FOR MHC'S REVIEW AND COMMENT. You can obtain a copy of a PNF through the MHC web site (www.sec.state.ma.us/mhc) under the subject heading "MHC Forms."

Commonwealth of Massachusetts
Massachusetts Historical Commission
220 Morrissey Boulevard, Boston, Massachusetts 02125
www.sec.state.ma.us/mhc

This file was accessed on: Thursday, October 22, 2020 at 12:36 PM

CON. AB

FORM G - STREETSCAPE

RECEIVED

JUL 15 1993

MASSACHUSETTS HISTORICAL COMMISSION
80 BOYLSTON STREET
BOSTON, MA 02116

MASS. HIST. COMM.

AREA

FORM NO.

AB

641-643

CONCORD

Street Name Cottage LaneAddresses (inclusive) 29th 41 51

DESCRIPTION

General Date or Period ca. 1879Predominant Architectural Styles vernacular cottagesMajor Intrusions noneAlterations see p. 2Acreage less than one acre

Photos (3"x3" or 3"x5" black and white)
Indicate street addresses for
buildings shown on back of each
photo. Staple to left side of form.

Sketch Map: Draw map of street, clearly
showing all buildings; indicate street
addresses for all buildings; identify
intrusions.
Indicate north.

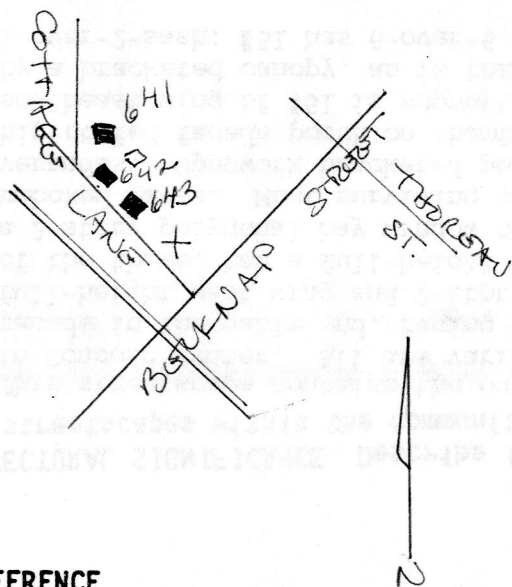

UTM REFERENCE

USGS QUADRANGLE

SCALE

Recorded by A. ForbesOrganization for Concord Hist. Comm.
July, 1990

Date

NATIONAL REGISTER CRITERIA STATEMENT (if applicable)

ARCHITECTURAL SIGNIFICANCE Describe important architectural features and evaluate in terms of other streetscapes within the community.

This streetscape contains the only cluster of nineteenth-century gambrel-roofed cottages in Concord center. All are variations on the same design--a two-story house with its facade in the gable end, facing the street. #29 has a 1-story side ell; #41 a full-height west wing and 2-story polygonal bay on the east side, and #51, the largest of the three, has a full-height gambrel-roofed wing on either side and at the rear, and a 2-story polygonal bay window on the facade. All have simple trim details, including unboxed eaves. Most surviving ornamentation is at the various door hoods, porches and verandas. Openwork bracketed posts appear at the ell veranda on #29; #41 has a hip-roofed facade porch on chamfered, square posts. A porch recessed under the southeast wing of #51 is supported on spindlework posts, and its main entry is sheltered by a bracketed canopy, as is that at #29. Most windows at #s 29 and 41 are 2-over-2-sash; #51 has 6-over-6 sash. (Cont.)

HISTORICAL SIGNIFICANCE Explain historical importance of streetscape and how the streetscape relates to the development of the community.

This section of Cottage Lane, (originally Railroad Lane, also briefly called Munroe Street,) was subdivided from the triangle between Main, Thoreau, and Belknap Streets and the railroad. Most of it once belonged to William Munroe, Jr., who had a large double-house (demolished) built on the north section, facing Main Street, and put up a group of houses on Thoreau Street, (see Form #AA.) William Munroe died in 1877, and these three houses may have been ^{built} shortly afterward. According to Keyes, they were put up by Judge E.R. Hoar in about 1879. He may have rented them out for a while, but by 1885 at least two out of the three were owned by their occupants. In that year #29 was owned and occupied by John Ireland, a track repairer for the Fitchburg Railroad. The occupant, at least, of #41 was Patrick McWalter, a mason, who is shown as the owner from at least 1889 to 1915. #51 was owned by John McSweeney, who had been foreman of George Keyes' Liberty Street farm, and who by the early 1880's was working for Judge Hoar, apparently as his coachman. He is listed in directories as a coachman through 1906.

In the nineteenth century, the car house for the Fitchburg Railroad is said to have been located just across the lane from this group of houses, although it does not appear there on any extant maps. (A car house is shown on the 1875 map just northwest of the depot; a long unlabeled building appears across the lane from these houses in 1889.)

One of the very altered cottages on the west side of the street (no inventory number) is said to be the relocated farmhouse of the Old Heywood Family farm which occupied much of the area west of today's Thoreau St. before the railroad was built.

BIBLIOGRAPHY and/or REFERENCES

- Keyes/Tolman.
- Town directories.
- Maps, plans, and atlases: 1889, 1893, 1906; Sanborns from 1903.

FORM G - STREETSCAPE

AREA

FORM NO.

AB

641-643

CONCORD

t Name Cottage Lanesses (inclusive) 29, 31, 51

RIPTION

al Date or Period ca. 1880inant Architectural Styles vernacular cottagesIntrusions noneAlterations see p. 2Acreage less than one acre

Sketch Map: Draw map of street, clearly showing all buildings; indicate street addresses for all buildings; identify intrusions.
Indicate north.

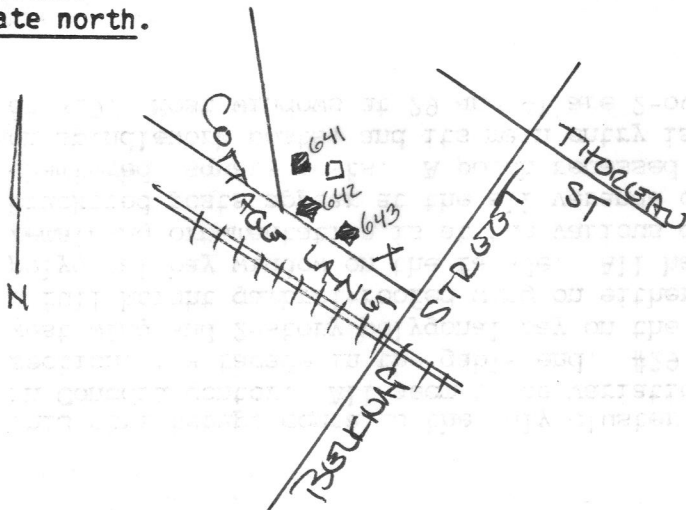

UTM REFERENCE

USGS QUADRANGLE

SCALE

Recorded by A. ForbesOrganization for Concord Hist. Comm.Date July, 1990

NATIONAL REGISTER CRITERIA STATEMENT (if applicable)

ARCHITECTURAL SIGNIFICANCE Describe important architectural features and evaluate in terms of other streetscapes within the community.

This streetscape contains the only cluster of nineteenth-century gambrel-roofed cottages in Concord center. All seem to be variations on the same design, with a two-story main section, its facade in the gable end. #29 has a 1-story side ell; #41 a full-height west wing and 2-story polygonal bay on the east, and #51, the largest of the three, has a full-height gambrel-roofed wing on either side and at the rear, and a 2-story polygonal bay window on the facade. All have simple house trim with unboxed eaves; most remaining ornamentation is at the various door hoods, porches and verandas--openwork, bracketed posts appear at the ell veranda on #29; #41 has a hip-roofed facade porch on chamfered, square posts. A porch recessed under the southeast wing of #51 is supported on spindlework posts, and its main entry is sheltered by a bracketed canopy, as is that at #29. Most windows at 29 and 41 are 2-over-2-sash; #51 has 6-over-6 sash. (Cont.)

HISTORICAL SIGNIFICANCE Explain historical importance of streetscape and how the streetscape relates to the development of the community.

This section of Cottage Lane, (originally Railroad Lane,) was subdivided from the rear of the property belonging to William Munroe, whose large house stood just to the north, facing Main Street. By 1889 the Munroe property belonged to Mrs. Susan Underhill, and all three of these houses had been built. The owner of #41 was apparently Patrick McWalter, a mason, who owned the house until at least 1906. #51 was owned by John McSweeney, who worked at the home of E.R. Hoar in 1886, probably as his coachman; (he is listed as a coachman through 1906.)

In the nineteenth century, the car house for the Fitchburg Railroad is said to have been located just across the lane from this group of houses, although it does not appear there on any extant maps. (A car house is shown on the 1875 map just northwest of the depot; a long unlabeled building appears across the lane from these houses in 1889.)

BIBLIOGRAPHY and/or REFERENCES

Town directories.

Maps, plans, and atlases: 1889, 1893, 1906; Sanborns from 1903.

INVENTORY FORM CONTINUATION SHEET

MASSACHUSETTS HISTORICAL COMMISSION
Office of the Secretary, Boston

Community: CONCORD	Form No: AB; 641-643
Property Name: 29 41 51 Cottage Lane	

Indicate each item on inventory form which is being continued below.

ARCHITECTURAL SIGNIFICANCE, cont.

All foundations are brick. #41 is unique in the group for its attached carriage house, connected to the house by a 1-story ell. #51 is the only one of the three with roof dormers.

MHC# Wall fabric, alterations, and outbuildings
Map/parcel #

641 29 Cottage Lane - synthetic siding. 20th-century door. Garage.
G9-737

642 39-41 Cottage Lane - synthetic siding. Most trim gone; some window replacement.
G9-738

643 51 Cottage Lane - clapboard. 2-story rear extension.
G9-740

MHC INVENTORY FORM CONTINUATION SHEET

MHC Inventory scanning project, 2008-2012

MACRIS No. CON. AB

AREA AB
PL- CONCORD
USGS- CONCORD
SECTION- B

641- 29 COTTAGE LN

642- 41 COTTAGE LN

643- 51 COTTAGE LN



29 Cottage Lane (CON. 641)



51 Cottage Lane (CON. 643)



51 Cottage Lane (CON. 643)