

Massachusetts Cultural Resource Information System

Scanned Record Cover Page

Inventory No:	CON.AD
Historic Name:	Nashawtuc Hill Area
Common Name:	
Address:	
City/Town:	Concord
Village/Neighborhood:	Concord Center
Local No:	
Year Constructed:	
Architect(s):	Owen, Frank Sewall
Architectural Style(s):	
Use(s):	Residential District
Significance:	Architecture; Community Planning
Area(s):	
Designation(s):	
Building Materials(s):	



The Massachusetts Historical Commission (MHC) has converted this paper record to digital format as part of ongoing projects to scan records of the Inventory of Historic Assets of the Commonwealth and National Register of Historic Places nominations for Massachusetts. Efforts are ongoing and not all inventory or National Register records related to this resource may be available in digital format at this time.

The MACRIS database and scanned files are highly dynamic; new information is added daily and both database records and related scanned files may be updated as new information is incorporated into MHC files. Users should note that there may be a considerable lag time between the receipt of new or updated records by MHC and the appearance of related information in MACRIS. Users should also note that not all source materials for the MACRIS database are made available as scanned images. Users may consult the records, files and maps available in MHC's public research area at its offices at the State Archives Building, 220 Morrissey Boulevard, Boston, open M-F, 9-5.

Users of this digital material acknowledge that they have read and understood the MACRIS Information and Disclaimer (<http://mhc-macris.net/macrisdisclaimer.htm>)

Data available via the MACRIS web interface, and associated scanned files are for information purposes only. THE ACT OF CHECKING THIS DATABASE AND ASSOCIATED SCANNED FILES DOES NOT SUBSTITUTE FOR COMPLIANCE WITH APPLICABLE LOCAL, STATE OR FEDERAL LAWS AND REGULATIONS. IF YOU ARE REPRESENTING A DEVELOPER AND/OR A PROPOSED PROJECT THAT WILL REQUIRE A PERMIT, LICENSE OR FUNDING FROM ANY STATE OR FEDERAL AGENCY YOU MUST SUBMIT A PROJECT NOTIFICATION FORM TO MHC FOR MHC'S REVIEW AND COMMENT. You can obtain a copy of a PNF through the MHC web site (www.sec.state.ma.us/mhc) under the subject heading "MHC Forms."

Commonwealth of Massachusetts
Massachusetts Historical Commission
220 Morrissey Boulevard, Boston, Massachusetts 02125
www.sec.state.ma.us/mhc

This file was accessed on: Thursday, October 22, 2020 at 3:16: PM

FORM A - AREA

Assessor's Sheets

USGS Quad

Area Letter

Form Numbers in Area

Massachusetts Historical Commission
80 Boylston Street
Boston, Massachusetts 02116

F8, F9, G8, G9

CONCORD

AD

388-394; 646-675
904; 906-7; 952

CONCORD

(neighborhood or village)

of Area Nashawtuc Hill Area

at Use residential

struction Dates or Period 1880's
through early 20th century

ll Condition
good

Intrusions and Alterations

modern houses interspersed; three at
hilltop.

Acreage ca. 60 acres

Recorded by A. Forbes

Organization resch. by A. Dwelley, K. Silver
for Concord Histor. Comm.

Date (month/day/year) July, 1992

Sketch Map

Draw a map of the area indicating properties within
it. Number each property for which individual
inventory forms have been completed. Label streets
including route numbers, if any. Attach a separate
sheet if space is not sufficient here. Indicate North.

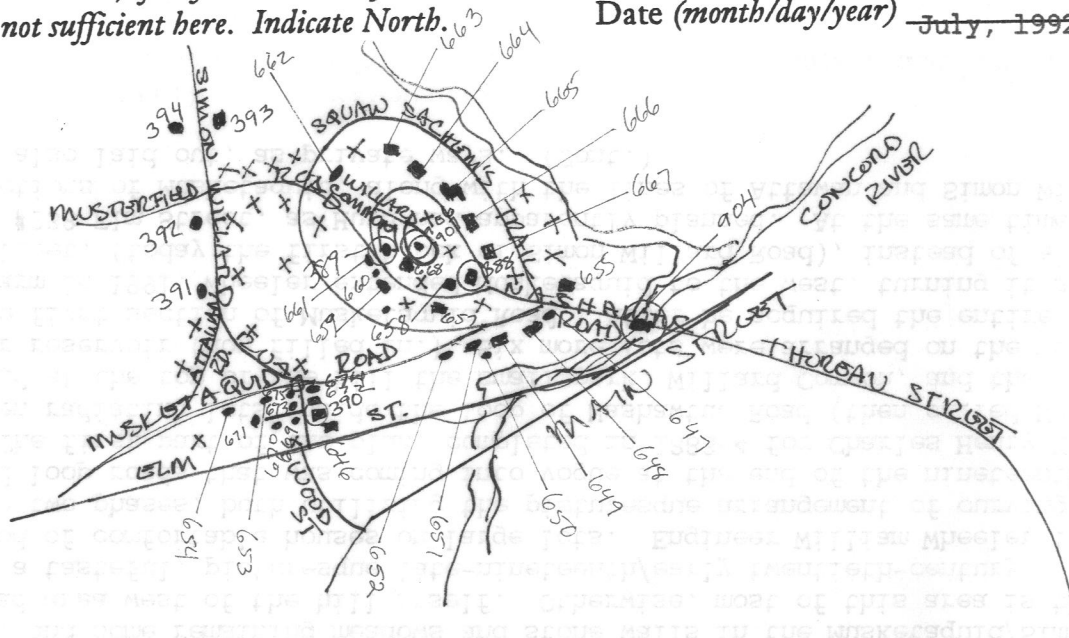

AREA FORM

ARCHITECTURAL DESCRIPTION ☐ *see continuation sheet*

Describe architectural, structural and landscape features and evaluate in terms of other areas within the community.

Nashawtuc Hill, once the heart of the largest of Concord's original farms, retains hints of its agrarian history only in its rolling terrain, wide expanses of riverfront, and some remaining meadows and stone walls in the Musketaquid/Simon Willard Road area west of the hill itself. Otherwise, most of this area is the epitome of a tasteful, picturesque late-nineteenth/early twentieth-century neighborhood of comfortable houses on large lots. Engineer William Wheeler laid out the hill in two phases, both utilizing the picturesque arrangement of curving streets and loop roads that was coming into vogue at the end of the nineteenth century. The first part of the plan, completed in 1883-4 for Charles Henry Hurd, included ten radiating lots inside the loop of Nashawtuc Road (then called Nashawtuc Avenue,) and at the top of the hill the small park, Willard Common, and the rectangular reservoir (now filled in.) Six more lots were arranged on the north side of the first section of Musketaquid Road. After he acquired the entire 400-acre farm in 1891, Wheeler extended Musketaquid to the west, turning it south to join Elm Street, (today the first block of Simon Willard Road), instead of aligning it west of #238 Elm Street, as Hurd had apparently planned. At the same time the western sections of Musketaquid, along with the lines of Attawan and Simon Willard Roads were also laid out, as private ways. (Cont.)

HISTORICAL NARRATIVE ☐ *see continuation sheet*

Explain historical development of the area. Discuss how this area relates to the historical development of the community.

Nashawtuc Hill, with the streets to its west and southwest, is today historically significant as the earliest, and still one of the most sophisticated, of Concord's high-style planned neighborhoods of large country estates. It was the dream of two men, Charles Henry Hurd and William Wheeler.

Situated just west of "Egg Rock," where the Sudbury and Assabet Rivers join to form the Concord, Nashawtuc Hill had been named by the Indians, who had frequented the area for centuries before the white man came. In 1635 it became part of the vast land holdings of Concord's major founder, Simon Willard. By 1660 the farm he established here became the property of the Woodis, and by 1699 the Lee family, who were to own it for 113 years. In the nineteenth century, the farm underwent the swift changes of ownership typical of many of the town's agricultural lands during that era, until ending up in the hands of railroad magnate Charles Henry Hurd, some time after 1860. It was under Hurd's ownership that the 1883 town reservoir was constructed on the hill's highest point. Ostensibly to provide ready access to the reservoir, he donated Nashawtuc Bridge, having been instrumental in having School Street (later Thoreau Street) extended north from Main Street to meet Nashawtuc Road at the river. (Cont.)

BIBLIOGRAPHY and/or REFERENCES ☐ *see continuation sheet*

Maps and atlases: 1889 Walker, 1893 Wood, 1906 Walker. Sanborns from 1927.
 "Sketch Plan of Nashawtuc Farm and Vicinity." 1899-1914.
 Wheeler, William. "Nashawtuc Hill." 1884.
 Hudson, Alfred S. History of Concord, Massachusetts. Concord: Erudite Press, 1904.
 Reynolds, Grindell. A Collection of Historical and Other Papers. Cambridge: University Press, 1895.
 Interviews with owners and former residents.
 Town Assessor's records. (Cont.)

☐ Recommended as a National Register District. *If checked, you must attach a completed National Register Criteria Statement form.*

INVENTORY FORM CONTINUATION SHEET

Community

Property

CONCORDNashawtuc Hill
Area

Massachusetts Historical Commission
80 Boylston Street
Boston, Massachusetts 02116

Area(s) Form No.
AD 388-394; 646 625;
904; 906 907; 952

ARCHITECTURAL/DESIGN SIGNIFICANCE, cont.

Landscaping and picturesque views and vistas formed an integral part of the neighborhood plan, but when Wheeler added the cobblestone walls along Nashawtuc Road at the top of the hill, one concerned citizen bemoaned "the subtle but sure encroachments which are gradually changing the original aspect of the village." Today, pockets of much of the original plant material remain, including a variety of mature deciduous and coniferous trees and a profusion of rhododendrons and other shrubs which still convey a sense of Wheeler's original vision. Many of the plants are ornamental varieties, some imported by the Wheelers from Japan. On most lots, the vistas south and east toward the Sudbury River remain unbroken. The northwest to northeast slopes of the hill, however, which must have once provided breathtaking views over the fields to the Assabet and the confluence of the rivers at Egg Rock, have grown up to woods, and been built up with a few modern houses on Simon Willard and Musterfield Roads, and on Squaw Sachem's Trail.

If the scenic and horticultural environment of the hill was an important part of the quality of life of both its residents and other Concord citizens, so was its recreational potential. From the start, the small tear-drop-shaped park, Willard Common, was planned at the top of the hill next to the reservoir. A steep area on the hill's west side became a favorite site for sledding and the new sport of skiing; it was donated to the town by the Shaw family, and has been kept open for sledding ever since.

Architecturally, the historic core of the area, and the most intact section, is the southern slope of the hill on the lower sections of Nashawtuc and Musketauquid Roads. Here are a variety of large, comfortable houses in the fashions most popular for country estates at the turn of the twentieth century--Shingle Style, Queen Anne, and the budding Colonial Revival. The area's earliest house, William Wheeler's own residence at #190 Nashawtuc Road, is a flamboyant Queen Anne house of ca. 1886, typically complex in design, with a clipped-gable roof, cylindrical bays, high brick and stone foundation, and patterned shingles. Its whimsical little carriage house/gardener's cottage at #204 Nashawtuc is of a compatible design. The Wheeler House is the only true Queen Anne house here, however. Several others are in the Shingle-Style. Carefully sited behind retaining walls and curving drives on the downhill sides of the roads, they present their formal facades to the street, while dormers, terraces, and sloping lawns at the rear take advantage of the hillside location. In these houses, #s 199, 235, 415, and 437 Nashawtuc Road, typical features of the Shingle Style abound, including rubble or uncoursed granite foundations, wide and varied window forms (including a large Palladian at #199), hipped, gabled, and eyebrow dormers, massive chimneys, and hipped or gambrel roofs.

INVENTORY FORM CONTINUATION SHEET

Community

Property

CONCORDNashawtuc Hill
Area

Massachusetts Historical Commission
80 Boylston Street
Boston, Massachusetts 02116

Area(s) Form No.
AD 388-394; 646-675;
904; 906-907; 952

ARCHITECTURAL/DESIGN SIGNIFICANCE, cont.

Three others, #s 275, 357, and 385 **Nashawtuc**, combine the dominant roofs of the Shingle style with the Colonial Revival. #275, the most altered of the houses, has a gambrel roof and bow-windowed entry atrium; #357 is a large square house with high hipped roof, tall chimneys, and brick first story. #385, which uses the most classical elements of the group, is an unusual Z-plan building, with steeply-pitched slate roofs, 9/6 and 12/8 sash windows, (a pair of round windows flank an exterior chimney on the facade of the south wing), and a sidelighted entry.

West of the hill, much of the land remained open for many years. William Wheeler farmed the acreage there, moving the huge **Nashawtuc Farm** barn to the site of #158 Simon Willard Road. (It burned down in 1898). In 1895 he leased the farmland northwest of the hill to the Concord Golf Club. A clubhouse was built in 1897, and the club continued at the site until 1913.

A few lots on the western sections, however, were developed relatively early. The three houses on the east side of lower Simon Willard Road were built in 1893 (#s 26, 38, and 52.) One, the 3-story #26, with its high, balustraded roof and gracious carriage house at 196 Elm Street, (now converted to a dwelling) is one of Concord's most elegant examples of the Federal Revival style. The other two are large Colonial Revival stucco residences. A few years later, two shingled houses, the Shingle Style #39 and early Dutch Colonial Revival #53, were built across the road. After the turn of the century the old farmhouse on the northwest corner of Elm and Simon Willard Road burned down, and Simon Willard Lane was cut through. Today its two stucco French Revival cottages at #s 17 and 27 are more evocative of a lane in Europe than in Concord.

The additional residential construction of the 1910's through 1930's in the area consisted almost entirely of large Colonial Revival houses. Some outstanding examples are the wide-clapboarded G.S. Whitney House at 207 **Musketaquid** and a large brick Georgian Revival house at #325 **Nashawtuc Road**. Simon Willard Road was extended north after the golf course was discontinued, and beginning in 1914 prominent local architect Harry Britton Little designed three houses there. Two, including his own residence at #263, were Colonial Revival; the third, the 1927 **Berkeley Wheeler House** at #256, is in the French Provincial style.

HISTORICAL SIGNIFICANCE, cont.

Hurd also saw the bridge as a way to open up the hill to residential development, however, and in 1884 laid out 16 lots and the road pattern described above. The engineer who drew up the plan, and who also built the first residence on the hill, was William Wheeler, the brilliant civil and hydraulic engineer who ten years earlier, at the age of 23, had designed the Concord Water system. Wheeler was probably familiar with every aspect of **Nashawtuc**, as he had directed the (Cont.)

INVENTORY FORM CONTINUATION SHEET

Community

Property

CONCORDNashawtuc Hill
Area

Massachusetts Historical Commission
80 Boylston Street
Boston, Massachusetts 02116

Area(s) Form No.

HISTORICAL SIGNIFICANCE, cont.

building of the reservoir, and clearly had a close working relationship with Hurd. C.H. Hurd died before he could develop the hill, however, and in 1891 Wheeler purchased the 400-acre farm from his heirs, and began to develop the hill himself. His taste in architecture had been apparent in his own elaborate Queen Anne residence and in his glowing praise of John Chapman's fanciful little reservoir gatehouse, which he lauded for its contrast with more "conventional box-and-pyramid structures." His dream for Nashawtuc Hill was for a well-planned, long-range real estate development of large, gracious homes in a carefully-landscaped setting. He retained Hurd's lay-out of 1884, and over a period of 30 years gradually extended the residential development west onto today's Musketaquid and Simon Willard Roads.

Building on the hill progressed slowly. After William Wheeler's own residence of 1886, which occupied the focal point at the bottom of the Nashawtuc loop road, the next construction did not take place until the mid-1890's. In 1892, in order to make room for more house lots, Wheeler moved the huge 180-foot Nashawtuc Farm barn (said to be the largest in the county) up from its location off Elm Street opposite Wood Street to the site of today's #158 Simon Willard Road. In 1895 the Concord Golf Club leased land between the line of today's Simon Willard Road and the railroad. The preparation of the golf links was helped along by the steam roller from the state road construction project of that year.

By 1906 seven houses had been built on Nashawtuc Road, two on Musketaquid overlooking the river, and three on the first block of today's Simon Willard Road, (then the end of Musketaquid,) at #s 26, 38, and 52. By 1914 there were four more on the hill. All were "various elegant buildings with finely kept lawns" as Alfred Hudson characterized the neighborhood's architecture.

Over the years the inhabitants of this neighborhood have included some of Concord's most illustrious citizens. Among them were artists, writers, and businessmen, and several of the residents were closely involved in shaping the course of events in the town. #138 Nashawtuc Road was built for author and historian Allen French, who wrote 31 books, including novels, books on gardening, and histories, including histories of Concord. By 1896 William H. Bowker, president of Bowker Fertilizer Company in Boston had #437 Nashawtuc built for his family; (this was later the first residence in Concord of Houghton Mifflin publisher, Henry A. Laughlin, Jr.) In 1894-95 artist Robertson James, brother of authors William and Henry James, and his wife Mary built a large house on the site of the modern house at today's #179 in 1894-95. Shortly afterward just to its west #199 Nashawtuc was built, evidently for Boston lumber dealer Herbert W. Blanchard. The first owners of other houses on Nashawtuc Road included Boston cotton broker Walter Keith Shaw at #235 (built in 1897), and lawyer and music publisher Jonas M. Miles, who built #357 Nashawtuc in about 1900. #275 Nashawtuc Road was designed by Shepard & Stearns in 1926 for the marriage of Walter K. Shaw, Jr., who succeeded his father as president of E.A. Shaw & Co. Its 1934 addition was designed by local architect William Kussin. The house at #415 Nashawtuc Road was built for accountant Edward L. Parker and his wife Sarah in 1902.

CON. AD

INVENTORY FORM CONTINUATION SHEET

Community

Property

CONCORD

Nashawtuc Hill
Area

Massachusetts Historical Commission
80 Boylston Street
Boston, Massachusetts 02116

Area(s) Form No.
AD 388-394, 64665;
904, 906-907, 952

HISTORICAL SIGNIFICANCE, cont.

The first house built on Musketaquid Road was #61, put up by New England Telephone and Telegraph executive **Francis A. Houston** in 1898-99. A second house for **Herbert Blanchard** was built at #39 in about 1910; it was later owned by Otis Elevator executive **M. Irving Motte**, and in the middle of this century it was remodeled into the present structure.

Further west, on the extension of Musketaquid Road, #207 was constructed for **George S. Whitney** and his wife in the 1920's. Mr. Whitney, who died in 1924, founded the Whitney Coal and Grain Co. in West Concord late in the nineteenth century. #229 Musketaquid was built in 1927-28 by builder **H. Whitemore Brown** for his own residence. The son of Benjamin Brown of 238 Elm Street, he was responsible for developing a considerable portion of Concord's early-twentieth-century neighborhoods, including much of the area in the vicinity of this house. On the northern extension of Simon Willard Road are at least four significant houses: #175, the little farm cottage of ca. 1880 that was apparently the residence of the foreman of Nashawtuc Farm, and three houses designed by architect **Harry Britton Little**, #s 199, 256, and 263. #59 Willard Common at the top of the hill is also one of the later significant buildings. Built for a Dr. **Ferry**, it was later the home of composer **Randall Thompson**. Mrs. **Arthur Brooks**, founder of the Brooks School, also lived both there and at #38 Simon Willard Road.

William Wheeler's plan did indeed turn into a "long-range" project, as the streets as he conceived of them, including Squaw Sachem's Trail, Simon Willard, and Musterfield Road, (in a slightly altered position,) are still being built up with large, stylish residences and embellished with handsome gardens and ornamental plantings.

Future research on each of the significant houses is sure to provide a wealth of detailed information on their inhabitants.

BIBLIOGRAPHY, cont.

Richardson.

Concord Town Report. 1883.

Strawberries and Streetcars.

Social Circle Memoirs.

Concord Free Library obituary file.

INVENTORY FORM CONTINUATION SHEET

Community

Property

CONCORDNashawtuc Hill
Area

Massachusetts Historical Commission
80 Boylston Street
Boston, Massachusetts 02116

Area(s) Form No.
AD 388-394; 646-675;
904; 906-7; 952

AREA DATA SHEET

(Asterisk indicates property is covered on an individual form)

MHC #/ Parcel #	Address	name	date	description	condition
646 F9-1769-1	196 Elm Street -	Abbott Carriage House	ca. 1900	Federal Revival --converted to dwelling, mid-20th century	fair
647 G9-1733	9 Musketaquid Road -		ca. 1912	Federal Revival	exc.
648 G9-1732	23 Musketaquid Road -		ca. 1935	Colonial Revival	good
649 G9-1731	39 Musketaquid Road -	Blanchard/Motte House	1910	Shingle Style rebuilt ca. 1950	fair
650 G9-1730	49 Musketaquid Road -	Houston garage/cottage	ca. 1900	Shingle Style	exc.
651 G9-1730	61 Musketaquid Road -	FA Houston House	ca. 1898;	Shingle/Col.	good
652 G9-1729	73 Musketaquid Road -		ca. 1900;	Shingle Style	good
653 F8-1774	207 Musketaquid Road -	G.S. Whitney House	mid-1920's	Col. Revival	good
654 F8-1776	229 Musketaquid Road -	H.W. Brown House	1927-8;	stucco Col. Rev. - second floor added ca. 1935 - H.W. Brown, designer and builder	good
*904	Nashawtuc Road -	Nashawtuc Bridge	1883		fair
		- Conrad Juuel, designer			
655 G9-1736	138 Nashawtuc Road -	Allen French House	1904	Colonial Revival - George Wales, architect.	exc.
*388 G8-1741	190 Nashawtuc Road -	William Wheeler House	1886	Queen Anne	exc.
657 G9-1743-1	199 Nashawtuc Road -	Herbert Blanchard House	ca. 1896	Shingle Style	exc.

CON. AD

INVENTORY FORM CONTINUATION SHEET

Community

Property

CONCORDNashawtuc Hill
Area

Massachusetts Historical Commission
80 Boylston Street
Boston, Massachusetts 02116

Area(s) Form No.
AD 388-394; 646-675;
904; 906-907; 952

AREA DATA SHEET

(Asterisk indicates property is covered on an individual form)

MHC #/ Parcel #	Address	name	date	description	condition
658 G8-1741-1	204 Nashawtuc Road -	Wheeler Carriage House/ gardener's cottage	1886	Queen Anne	exc.
659 F8-1744-1	235 Nashawtuc Road -	Walter K. Shaw House	1897	Shingle Style	exc.
660 F8-1744-1	247 Nashawtuc Road -	Shaw garage/cottage Architect: Derby Robinson Shepard.	1912	Queen Anne	good
952 F8-1745	Nashawtuc Road -	sledding hill	1890's		
661 F8-1746-2	275 Nashawtuc Road -	WK Shaw, Jr. House Architect: Shepard & Stearns; William Kussin: 1934 addition.	1926	Shingle/Col. Revival	good
*389 F8-1749	Nashawtuc Road -	Gate House, Nashawtuc Reservoir	1883	Gothic Revival	good
662 F8-1753-1	325 Nashawtuc Road -		ca. 1927	Georgian Revival	exc.
663 G8-1752	349 Nashawtuc Road -	Miles Carr. House - converted to house mid-20th C.	ca. 1897	Shingle/Col. Rev.	fair
664 G8-1752-2	357 Nashawtuc Road -	Jonas Miles House	ca. 1897	Shingle/Col. Rev.	exc.
665 G8-1751	385 Nashawtuc Road -		ca. 1920's	Shingle/Col. Rev.	exc.
666 G8-1740	415 Nashawtuc Road -	E.L. Parker House	ca. 1900	Shingle Style	exc.
667 G8-1737-3	437 Nashawtuc Road -	W.H. Bowker House	ca. 1895	Shingle Style	exc.
669 F9-1767	7 Simon Willard Lane -		ca. 1920's	Dutch Col. Revival	good

CON. AD

INVENTORY FORM CONTINUATION SHEET

Community

Property

CONCORDNashawtuc Hill
AreaMassachusetts Historical Commission
80 Boylston Street
Boston, Massachusetts 02116

Area(s) Form No.

AREA DATA SHEET

(Asterisk indicates property is covered on an individual form)

MHC #/ Parcel #	Address	name	date	description	condition
670 F9-1766	17 Simon Willard Lane -		early 20th C.	French Revival cottage	good
671 F9-1765	27 Simon Willard Lane -		early 20th C.	French Revival cottage	good
* 390 F9-1769-2	26 Simon Willard Road - Newman/Abbott House		1898	Federal Revival	exc.
672 F9-1768-1	38 Simon Willard Road - Buttrick House -		1898	stucco Col. Rev.	exc.
673 F9-1764	39 Simon Willard Road -		ca. 1915	Shingle Style	exc.
674 F9-1763	52 Simon Willard Road - Murphy House		1898	stucco Col. Rev.	good
675 F8-1762	53 Simon Willard Road -		ca. 1920's	Dutch Col. Revival	good
* 391 F8-1787	173 (175) Simon Willard Road - foreman's cottage		ca. 1880	eclectic	good
		Nashawtuc Farm			
* 392 F8-1788	199 Simon Willard Road - Horace Arnold House		1936	Col. Revival	good
		Harry Little, architect			
* 393 F8-1792-3	256 Simon Willard Road - Berkeley Wheeler House		1927	French Provincial	good
		Harry Little, architect			
* 394 F8-1790-2	263 Simon Willard Road - Harry Little House		1914	Col. Revival	exc.
		Harry Little, architect			
* 906	Willard Common - landscaped park				
* 907	Willard Common - monument to Simon Willard				good
668 G8-1747	59 Willard Common - Ferry House		ca. 1926	Col. Revival	good



9 Musketaguid Road (CON. 647)



39 Musketaguid Road (CON. 649)



23 Musketaguid Road (CON. 648)



61 Musketaguid Road (CON. 650)



61 Musketaguid Road (CON.651)



207 Musketaguid Road (CON.653)



73 Musketaguid Road (CON.652)



House on Musketaguid Road



138 Nashawtuc Road (CON.655)



199 Nashawtuc Road (CON.657)



199 Nashawtuc Road (CON.657)



204 Nashawtuc Road (CON.658)



235 Nashawtuc Road (CON. 659)



275 Nashawtuc Road (CON. 661)



235 Nashawtuc Road (CON. 660)



325 Nashawtuc Road (CON. 662)



349 Nashawtuc Road (CON.663)



385 Nashawtuc Road (CON.665)



357 Nashawtuc Road (CON.664)



415 Nashawtuc Road (CON.666)



437 Nashawtuc Road (CON.667)



Nashawtuc Hill



Toboggan Slide
Nashawtuc Hill (CON.952)



39 and 53 Simon Willard Road
(CON.673 and CON.675)



Simon Willard Lane, South side



52 Simon Willard Road (CON.674)



59 Willard Common (CON.668)



Houses on Simon Willard Lane

INVENTORY FORM CONTINUATION SHEET

Massachusetts Historical Commission
Massachusetts Archives Building
220 Morrissey Boulevard
Boston, Massachusetts 02125

Community

Property

Concord

Nashawtuc Hill

Area(s)

AD

Form Nos.

388-394; 646-675; 904, 906,
907, 952

Additional information by Anne Forbes, November, 2000:

HISTORICAL NARRATIVE, cont.

Thanks largely to input from local residents, since 1992 the names of initial owners and the architects of some of the buildings in the area have come to light. The architect of the 1926 Ferry House, 59 Willard Common, was Frank Sewall Owen.

The gatehouse of the Nashawtuc Reservoir was designed by local architect John H. Chapman (see Form #389, **Nashawtuc Road: Gatehouse**).

According to a late-nineteenth-century painting and the Wheeler plan of Nashawtuc Hill of 1883-84, the former farm foreman's cottage of Nashawtuc Farm at 175 Simon Willard Road (see Form #391) probably dates to between 1857 and 1860--the period of rebuilding at Nashawtuc Farm after a fire destroyed much of the farmstead in the 1850s--and was moved to its present site by William Wheeler.

BIBLIOGRAPHY/REFERENCES, cont.

Town of Concord. Annual Report, 1884.

Submissions from longtime residents, 1998-1999.

RECEIVED

OCT 01 2001

MASS. HIST. COMM

Massachusetts Historical Commission
80 Boylston Street
Boston, Massachusetts 02116

Community

CONCORD

Property Address

Nashawtuc Hill

Area(s) FormNo.
A D 388-394; 646-675
904; 906-7; 952

National Register of Historic Places Criteria Statement Form



Check all that apply:

- ☐ Individually eligible ☐ Eligible only in a historic district
☐ Contributing to a potential historic district ☒ Potential historic district

Criteria: ☒ A ☐ B ☒ C ☐ D

Criteria Considerations: ☐ A ☐ B ☐ C ☐ D ☐ E ☐ F ☐ G

Anne McCarthy Forbes

Statement of Significance by _____
The criteria that are checked in the above sections must be justified here.

This area meets Criteria A and C of the National Register as a District composed of a high-style planned residential development of Queen Anne, Shingle Style, Colonial Revival and French Revival/Provincial architecture that spanned the mid-1880's through 1930's. Each resource possesses integrity of design, location, setting, materials, workmanship, feeling and association.

Massachusetts Historical Commission
80 Boylston Street
Boston, Massachusetts 02116

RECEIVED

JUL 15 1993

Community

CONCORD

Property Address

Nashawtuc Hill

MASS. HIST. COMM.

Area(s) FormNo.

AD

National Register of Historic Places Criteria Statement Form



Check all that apply:

- ☐ Individually eligible ☐ Eligible only in a historic district
☐ Contributing to a potential historic district ☒ Potential historic district

Criteria: ☒ A ☐ B ☒ C ☐ D

Criteria Considerations: ☐ A ☐ B ☐ C ☐ D ☐ E ☐ F ☐ G

Anne McCarthy Forbes

Statement of Significance by _____
The criteria that are checked in the above sections must be justified here.

This area meets Criteria A and C of the National Register as a District composed of a high-style planned residential development of Queen Anne, Shingle Style, Colonial Revival and French Revival/Provincial architecture that spanned the mid-1880's through 1930's. Each resource possesses integrity of design, location, setting, materials, workmanship, feeling and association.

Eligible resources:

9 Musketaquid Road, 23 Musketaquid Road, 39 Musketaquid Road - Blanchard/Motte House, 49 Musketaquid Road - Houston garage/cottage, 61 Musketaquid Road - FA Houston House, 73 Musketaquid Road, Nashawtuc Road - Nashawtuc Bridge, 138 Nashawtuc Road - Allen French House, 190 Nashawtuc Road - William Wheeler House, 199 Nashawtuc Road - Herbert Blanchard House, 204 Nashawtuc Road - Wheeler Carriage House, 235 Nashawtuc Road - Walter K. Shaw House, 247 Nashawtuc Road - Shaw garage/cottage, Nashawtuc Road - sledding hill, 275 Nashawtuc Road - WK Shaw, Jr. House, Nashawtuc Road - Gate House for Nashawtuc Reservoir, 325 Nashawtuc Road, 357 Nashawtuc Road - Jonas Miles House, 385 Nashawtuc Road, 415 Nashawtuc Road - E.L. Parker House, 437 Nashawtuc Road - W.H. Bowker House, 26 Simon Willard Road - Newman/Abbott House, 38 Simon Willard Road - Buttrick House, 39 Simon Willard Road, 52 Simon Willard Road - Murphy House, 53 Simon Willard Road, 173 (175) Simon Willard Road - Nashawtuc Farm foreman's cottage, 199 Simon Willard Road - Horace Arnold House, 256 Simon Willard Road - Berkeley Wheeler House, 263 Simon Willard Road - Harry Little House, Willard Common - landscaped park, Willard Common - monument to Simon Willard, 59 Willard Common - Ferry House.