

Massachusetts Cultural Resource Information System

Scanned Record Cover Page

| | |
|--------------------------------|----------------------------------|
| Inventory No: | CON.AJ |
| Historic Name: | Main Street Area II |
| Common Name: | |
| Address: | |
| City/Town: | Concord |
| Village/Neighborhood: | Concord Center |
| Local No: | |
| Year Constructed: | |
| Architect(s): | |
| Architectural Style(s): | |
| Use(s): | Residential District |
| Significance: | Architecture; Community Planning |
| Area(s): | |
| Designation(s): | |
| Building Materials(s): | |



The Massachusetts Historical Commission (MHC) has converted this paper record to digital format as part of ongoing projects to scan records of the Inventory of Historic Assets of the Commonwealth and National Register of Historic Places nominations for Massachusetts. Efforts are ongoing and not all inventory or National Register records related to this resource may be available in digital format at this time.

The MACRIS database and scanned files are highly dynamic; new information is added daily and both database records and related scanned files may be updated as new information is incorporated into MHC files. Users should note that there may be a considerable lag time between the receipt of new or updated records by MHC and the appearance of related information in MACRIS. Users should also note that not all source materials for the MACRIS database are made available as scanned images. Users may consult the records, files and maps available in MHC's public research area at its offices at the State Archives Building, 220 Morrissey Boulevard, Boston, open M-F, 9-5.

Users of this digital material acknowledge that they have read and understood the MACRIS Information and Disclaimer (<http://mhc-macris.net/macrisdisclaimer.htm>)

Data available via the MACRIS web interface, and associated scanned files are for information purposes only. THE ACT OF CHECKING THIS DATABASE AND ASSOCIATED SCANNED FILES DOES NOT SUBSTITUTE FOR COMPLIANCE WITH APPLICABLE LOCAL, STATE OR FEDERAL LAWS AND REGULATIONS. IF YOU ARE REPRESENTING A DEVELOPER AND/OR A PROPOSED PROJECT THAT WILL REQUIRE A PERMIT, LICENSE OR FUNDING FROM ANY STATE OR FEDERAL AGENCY YOU MUST SUBMIT A PROJECT NOTIFICATION FORM TO MHC FOR MHC'S REVIEW AND COMMENT. You can obtain a copy of a PNF through the MHC web site (www.sec.state.ma.us/mhc) under the subject heading "MHC Forms."

Commonwealth of Massachusetts
Massachusetts Historical Commission
220 Morrissey Boulevard, Boston, Massachusetts 02125
www.sec.state.ma.us/mhc

This file was accessed on: Friday, October 23, 2020 at 11:06 AM

Massachusetts Historical Commission
80 Boylston Street
Boston, Massachusetts 02116

F-9

CONCORD

A5

720-724



CONCORD

Neighborhood or village) _____

Concord center

Area _____ Main Street: 591-661

Use _____ residential

Construction Dates or Period _____ ca. 1906-1930's

Condition _____

good

Intrusions and Alterations _____ modern

houses interspersed

Acreage _____ ca. 8 acres

Recorded by _____ A. Forbes

Organization _____ for Concord Histor. Comm.

Date (month/day/year) _____ June, 1992

591 Main Street (CON. 720)

Sketch Map

Draw a map of the area indicating properties within it. Number each property for which individual inventory forms have been completed. Label streets including route numbers, if any. Attach a separate sheet if space is not sufficient here. Indicate North.

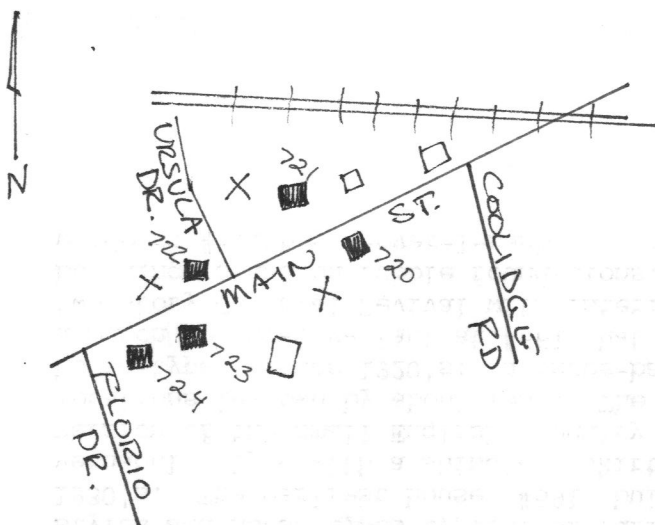

AREA FORM

ARCHITECTURAL DESCRIPTION ☐ *see continuation sheet*

Describe architectural, structural and landscape features and evaluate in terms of other areas within the community.

In spite of some modern residential construction in the area, this section of Main Street is largely a neighborhood that represents the slow progression of modest styles and house-types typical of various parts of Concord from ca. 1906 through 1930's. The earliest house, #591, built ca. 1906, is a late 2-story Queen Anne vernacular type with a shingled, skirted second story. The latest, #632, is one version of the small English "country cottage" that was appearing at scattered locations in town by about 1930. The other three buildings here are Colonial house-types of the 1920's: a three-bay Dutch Colonial Revival of 1929-30 at #602, a Dutch Colonial variant at #661 that lacks the characteristic shed dormers, and a two-story Colonial Revival with interior end chimneys at #653. Several of the buildings stand on rubble foundations. All the later houses have 6-over-6-sash windows; #591 has 6-over-1-sash.

HISTORICAL NARRATIVE ☐ *see continuation sheet*

Explain historical development of the area. Discuss how this area relates to the historical development of the community.

By the first decade of the twentieth century, scattered houses were beginning to appear on properties divided out of the old Wood and Hosmer farms along Main Street west of the railroad.

Further research should reveal the early owners of most of these houses. The earliest building, #591, was apparently built about 1906 by Robertson James. Living at that time off Lexington Road, he owned several rental properties at the center, including the "Dovecote" across the street at #586, and he may have built this house for investment purposes and rented out both buildings.

As is the case throughout Concord, these early modern buildings co-exist not only with earlier historic buildings, but with other historical evidence, as well. A family gravesite behind #602 remains from a 1792 Hosmer family burial, marked by a table tablet. (See #586 Main Street, "The Dovecote.")

BIBLIOGRAPHY and/or REFERENCES ☐ *see continuation sheet*

Maps and atlases: 1906.
Town directories.

☐ Recommended as a National Register District. *If checked, you must attach a completed National Register Criteria Statement form.*

CON. A5

INVENTORY FORM CONTINUATION SHEET

Community

Property

CONCORD

Main St: 591-661

Massachusetts Historical Commission
80 Boylston Street
Boston, Massachusetts 02116

Area(s) Form No.
A5 720-724

AREA DATA SHEET
description

| MHC #/ Parcel # | Address | description | date | condition |
|--------------------|-----------------|--|----------|-----------|
| 720 F9-3970 | 591 Main Street | - late 2 1/2-story Queen Anne vernac. Wood shingle and synthetic siding, with skirted second story. 6/1 windows. | ca. 1906 | fair |
| 721 F9-3860 | 602 Main Street | - Dutch Colonial Revival Wood shakes. 3-bay hip-roofed shingle/ clapboard garage/cottage to rear. | 1930 | good |
| 722 F9-3858 | 632 Main Street | - English Revival cottage Synthetic siding. Prominent steep facade gable and exterior chimney. | ca. 1930 | fair |
| 723 F9-3974 | 653 Main Street | - 2-story Colonial Revival Wood clapboard, rubble foundation. 6/6 windows, interior end chimneys. | 1920's | good |
| 724 F9-3975 | 661 Main Street | - Dutch Colonial Revival Wood clapboard; rubble foundation. | 1920's | fair |

MHC INVENTORY FORM CONTINUATION SHEET

MHC Inventory scanning project, 2008-2012

MACRIS No.

CON. AJ

AREA AJ
PL-CONCORD
USGS-CONCORD
SECTION-B

720 - 591 MAIN ST

721 - 602 MAIN ST (ALSO AREA DU-LHD 3/12/62)

722 - 632 MAIN ST

723 - 653 MAIN ST

724 - 661 MAIN ST

1



602 Main Street (CON. 721)



838, 844 Main Street (CON. 739 and CON. 741)



622 Main Street



653 and 661 Main Street
(CON. 723)