

Massachusetts Cultural Resource Information System

Scanned Record Cover Page

Inventory No:	CON.AN
Historic Name:	Potter Streetscape
Common Name:	
Address:	
City/Town:	Concord
Village/Neighborhood:	Hubbardville
Local No:	
Year Constructed:	
Architect(s):	
Architectural Style(s):	
Use(s):	Residential District
Significance:	Architecture; Community Planning
Area(s):	
Designation(s):	
Building Materials(s):	



The Massachusetts Historical Commission (MHC) has converted this paper record to digital format as part of ongoing projects to scan records of the Inventory of Historic Assets of the Commonwealth and National Register of Historic Places nominations for Massachusetts. Efforts are ongoing and not all inventory or National Register records related to this resource may be available in digital format at this time.

The MACRIS database and scanned files are highly dynamic; new information is added daily and both database records and related scanned files may be updated as new information is incorporated into MHC files. Users should note that there may be a considerable lag time between the receipt of new or updated records by MHC and the appearance of related information in MACRIS. Users should also note that not all source materials for the MACRIS database are made available as scanned images. Users may consult the records, files and maps available in MHC's public research area at its offices at the State Archives Building, 220 Morrissey Boulevard, Boston, open M-F, 9-5.

Users of this digital material acknowledge that they have read and understood the MACRIS Information and Disclaimer (<http://mhc-macris.net/macrisdisclaimer.htm>)

Data available via the MACRIS web interface, and associated scanned files are for information purposes only. THE ACT OF CHECKING THIS DATABASE AND ASSOCIATED SCANNED FILES DOES NOT SUBSTITUTE FOR COMPLIANCE WITH APPLICABLE LOCAL, STATE OR FEDERAL LAWS AND REGULATIONS. IF YOU ARE REPRESENTING A DEVELOPER AND/OR A PROPOSED PROJECT THAT WILL REQUIRE A PERMIT, LICENSE OR FUNDING FROM ANY STATE OR FEDERAL AGENCY YOU MUST SUBMIT A PROJECT NOTIFICATION FORM TO MHC FOR MHC'S REVIEW AND COMMENT. You can obtain a copy of a PNF through the MHC web site (www.sec.state.ma.us/mhc) under the subject heading "MHC Forms."

Commonwealth of Massachusetts
Massachusetts Historical Commission
220 Morrissey Boulevard, Boston, Massachusetts 02125
www.sec.state.ma.us/mhc

This file was accessed on: Friday, October 23, 2020 at 11:08 AM

CON. AN

FORM G - STREETSCAPE

AREA

FORM NO.

AN	747, 750, 752, 753
----	-----------------------

MASSACHUSETTS HISTORICAL COMMISSION
80 BOYLSTON STREET
BOSTON, MA 02116

Town

CONCORD

RECEIVED

Name Potter StreetAddresses (inclusive) 15, 35, 55, 61

Description

Date or Period ca. 1900Dominant Architectural Styles vernacular Italianate

Intrusions

modern house, #27Notes see p. 2

61, 55 Potter Street (CON. 753, CON. 752) Acreage

less than one acre

Sketch Map: Draw map of street, clearly
showing all buildings; indicate street
addresses for all buildings; identify
intrusions.
Indicate north.

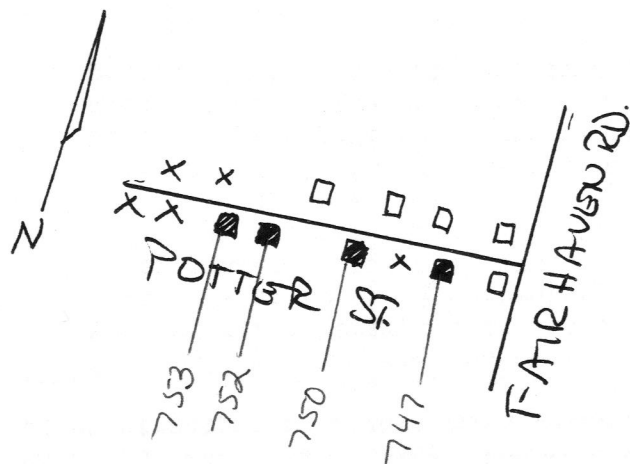

UTM REFERENCE

USGS QUADRANGLE

SCALE

Recorded by

A. Forbes

Organization

research by Ann Chapman
for Concord Hist. Comm.

Date

July, 1990

NATIONAL REGISTER CRITERIA STATEMENT (if applicable)

ARCHITECTURAL SIGNIFICANCE Describe important architectural features and evaluate in terms of other streetscapes within the community.

Four buildings on the southwest side of Potter Street at #s 15, 35, 55, and 61 are well-preserved examples of the side-hall-entry, gable-end form that, even in the face of a variety of turn-of-the-century forms, still prevailed in Concord at that time. (Two other houses of the same type, now more altered, were built across the street at #s 20 and 40.) All are tall 2 1/2-story buildings, three bays wide, and have the brick foundations and simple, narrow trim boards typical of the vernacular Italianate influence. All but #15 have short cross-gabled wings. #35 has a typically Italianate door canopy supported by ornate brackets. #s 55 and 61 appear to have been built as mirror images of each other, and have hip-roofed entry porches on bracketed square posts. Both have 1-story rear ells.

HISTORICAL SIGNIFICANCE Explain historical importance of streetscape and how the streetscape relates to the development of the community.

Potter Street is significant as an illustration of one way short side streets were created late in the nineteenth century. It was officially laid out in 1889, but followed the line of a cart path that had existed for at least several years. Houses were not built immediately, however. No buildings are shown here on the 1893 map; three appear to have been built by 1896, and three more by 1906. Further research will be necessary to determine the owners of each of these houses. Significantly, however, nearly all listed in directories from 1896 through 1906 were of Irish descent.

According to local tradition, at least some of the houses here, including #s 55 and 61, contain boards reused from the dance hall that had stood on the banks of Walden Pond in the latter part of the nineteenth century, and was torn down ca. 1903.

BIBLIOGRAPHY and/or REFERENCES

Interviews with owners, 1990.
Town directories.
Maps, plans, and atlases: 1906.

INVENTORY FORM CONTINUATION SHEET

MASSACHUSETTS HISTORICAL COMMISSION
Office of the Secretary, Boston

Community:

CONCORD

Form No:

AN: 747,
750, 752, 753

Property Name: POTTER STREET

Indicate each item on inventory form which is being continued below.

ARCHITECTURAL SIGNIFICANCE, cont.

MHC#

Wall fabric, alterations, and outbuildings

Map/parcel #

- 747 15 Potter Street - clapboard. Screened porch, NW side; some windows
G11-420 replaced. Colonial Revival entry porch on Tuscan columns.
- 750 35 Potter Street - clapboard. Windows replaced; exterior chimney added.
G11-421-1
- 752 55 Potter Street - clapboard. Some windows replaced. 2-car garage.
G11-423
- 753 61 Potter Street - asbestos. Some porch replacement.
G11-424



15 Potter Street
(CON. 747)

State to Inventory form at bottom