

# Massachusetts Cultural Resource Information System

## Scanned Record Cover Page

<b>Inventory No:</b>	CON.AZ
<b>Historic Name:</b>	Thoreau Street Area II
<b>Common Name:</b>	
<b>Address:</b>	
<b>City/Town:</b>	Concord
<b>Village/Neighborhood:</b>	
<b>Local No:</b>	
<b>Year Constructed:</b>	
<b>Architect(s):</b>	
<b>Architectural Style(s):</b>	
<b>Use(s):</b>	Residential District
<b>Significance:</b>	Architecture; Community Planning
<b>Area(s):</b>	
<b>Designation(s):</b>	
<b>Building Materials(s):</b>	



The Massachusetts Historical Commission (MHC) has converted this paper record to digital format as part of ongoing projects to scan records of the Inventory of Historic Assets of the Commonwealth and National Register of Historic Places nominations for Massachusetts. Efforts are ongoing and not all inventory or National Register records related to this resource may be available in digital format at this time.

The MACRIS database and scanned files are highly dynamic; new information is added daily and both database records and related scanned files may be updated as new information is incorporated into MHC files. Users should note that there may be a considerable lag time between the receipt of new or updated records by MHC and the appearance of related information in MACRIS. Users should also note that not all source materials for the MACRIS database are made available as scanned images. Users may consult the records, files and maps available in MHC's public research area at its offices at the State Archives Building, 220 Morrissey Boulevard, Boston, open M-F, 9-5.

Users of this digital material acknowledge that they have read and understood the MACRIS Information and Disclaimer (<http://mhc-macris.net/macrisdisclaimer.htm>)

Data available via the MACRIS web interface, and associated scanned files are for information purposes only. THE ACT OF CHECKING THIS DATABASE AND ASSOCIATED SCANNED FILES DOES NOT SUBSTITUTE FOR COMPLIANCE WITH APPLICABLE LOCAL, STATE OR FEDERAL LAWS AND REGULATIONS. IF YOU ARE REPRESENTING A DEVELOPER AND/OR A PROPOSED PROJECT THAT WILL REQUIRE A PERMIT, LICENSE OR FUNDING FROM ANY STATE OR FEDERAL AGENCY YOU MUST SUBMIT A PROJECT NOTIFICATION FORM TO MHC FOR MHC'S REVIEW AND COMMENT. You can obtain a copy of a PNF through the MHC web site ([www.sec.state.ma.us/mhc](http://www.sec.state.ma.us/mhc)) under the subject heading "MHC Forms."

Commonwealth of Massachusetts  
Massachusetts Historical Commission  
220 Morrissey Boulevard, Boston, Massachusetts 02125  
[www.sec.state.ma.us/mhc](http://www.sec.state.ma.us/mhc)

This file was accessed on: Friday, October 23, 2020 at 11:35 AM

## FORM A - AREA

Assessor's Sheets

USGS Quad

Area Letter

Form Numbers in Area

CON. AZ

Massachusetts Historical Commission  
80 Boylston Street  
Boston, Massachusetts 02116

H-10, H-11

CONCORD

AZ

1025-1026



CONCORD

(neighborhood or village)

of Area Thoreau Street:  
537, 540

at Use residential

struction Dates or Period 1894-early  
20th Century

ll Condition good/excellent

Intrusions and Alterations none

537 Thoreau Street (con. 1025)

## Sketch Map

Draw a map of the area indicating properties within it. Number each property for which individual inventory forms have been completed. Label streets including route numbers, if any. Attach a separate sheet if space is not sufficient here. Indicate North.

Acreage ca. 2.5 acres

Recorded by A. Forbes

Organization for Concord Histor. Comm.

Date (month/day/year) June, 1992

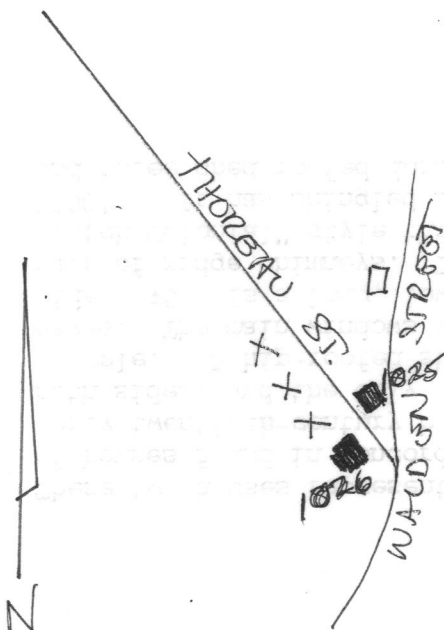

Follow Massachusetts Historical Commission Survey Manual instructions for completing this form.

## AREA FORM

ARCHITECTURAL DESCRIPTION ☐ *see continuation sheet*

*Describe architectural, structural and landscape features and evaluate in terms of other areas within the community.*

These two houses represent well-preserved versions of two of the more unusual types of houses found in Concord. #537 is one of only a few examples of the hip-roofed early-twentieth-century bungalow with veranda under the main roof on the facade and both sides, and the only one in brick. (See #247 Nashoba Road for a shingled example.) A hip-roofed shingled dormer over the facade also has deeply-overhanging eaves. The main windows are casements; an exterior chimney rises from the south side. #540 is a long, low gambrel-roofed three-bay Colonial Revival cottage with a pair of ridge chimneys. The distinctive flare at the eaves is indicative of the "Dutch Colonial" style that was just beginning to appear in its early phase in the 1890's. It has shingled siding, 6-over-6-sash windows with vertical-board shutters, and three shed-roofed dormers over the facade.

HISTORICAL NARRATIVE ☐ *see continuation sheet*

*Explain historical development of the area. Discuss how this area relates to the historical development of the community.*

Partly as a result of the ongoing house construction in the vicinity of the new Hubbard Street, Thoreau Street was extended south to Walden Street from its former terminus at Sudbury Road in 1873. No houses were built on the new section, however, for many years. Residential construction began in the 1880's on both sides of the street near the Emerson Playground to the northwest, but the southeast end, more remote from the depot and town center, remained open until these two houses were built, the first in 1894, the second early in this century. As such, the area is typical of the way some of Concord's former farmland evolved at the transition to the early modern period.

#540, which originally had a Walden Street address, was built for William Chisholm. He was a carpenter, and may have constructed the house himself. #537 was built for a member of the Buckley family, probably in about 1915 on part of the farm that William Buckley had owned at 440 Walden Street since ca. 1894. Early in this century the Buckleys acquired #540 Thoreau as well, and owned all three houses for many years.

BIBLIOGRAPHY and/or REFERENCES ☐ *see continuation sheet*

Town assessor's records.

Interview with Richard O'Connor, Thoreau Lyceum. 1992.

☐ Recommended as a National Register District. *If checked, you must attach a completed National Register Criteria Statement form.*

MHC INVENTORY FORM CONTINUATION SHEET

MHC Inventory scanning project, 2008-2012

MACRIS No.

CON. AZ

AREA AZ

PL - ~~CANADA~~ ☒

USGS - CONCORD

SECTION - B

1025 - 537 THOREAU ST

1026 - 540 THOREAU ST

INVENTORY FORM CONTINUATION SHEET

Community

Property

CONCORD

537, 540 Thoreau St.

Massachusetts Historical Commission  
80 Boylston Street  
Boston, Massachusetts 02116

Area(s) Form No.  
AZ 1025+026

MHC #/ Parcel #	Address	AREA DATA SHEET	date	condition
		description		
1025 H10-218	537 Thoreau Street	- Brick Bungalow with overhanging roof supported on heavy brick posts; veranda on three sides.	ca. 1915	excellent
1026 H11-292	540 Thoreau Street	- Colonial Revival cottage Wood shingle.	1894	good



540 Thoreau Street (CON. 1026)