

# Massachusetts Cultural Resource Information System

## Scanned Record Cover Page

<b>Inventory No:</b>	CON.CD
<b>Historic Name:</b>	Monument Street Area IV
<b>Common Name:</b>	
<b>Address:</b>	
<b>City/Town:</b>	Concord
<b>Village/Neighborhood:</b>	North Quarter
<b>Local No:</b>	
<b>Year Constructed:</b>	
<b>Architect(s):</b>	
<b>Architectural Style(s):</b>	
<b>Use(s):</b>	Residential District
<b>Significance:</b>	Agriculture; Architecture
<b>Area(s):</b>	
<b>Designation(s):</b>	
<b>Building Materials(s):</b>	



The Massachusetts Historical Commission (MHC) has converted this paper record to digital format as part of ongoing projects to scan records of the Inventory of Historic Assets of the Commonwealth and National Register of Historic Places nominations for Massachusetts. Efforts are ongoing and not all inventory or National Register records related to this resource may be available in digital format at this time.

The MACRIS database and scanned files are highly dynamic; new information is added daily and both database records and related scanned files may be updated as new information is incorporated into MHC files. Users should note that there may be a considerable lag time between the receipt of new or updated records by MHC and the appearance of related information in MACRIS. Users should also note that not all source materials for the MACRIS database are made available as scanned images. Users may consult the records, files and maps available in MHC's public research area at its offices at the State Archives Building, 220 Morrissey Boulevard, Boston, open M-F, 9-5.

Users of this digital material acknowledge that they have read and understood the MACRIS Information and Disclaimer (<http://mhc-macris.net/macrisdisclaimer.htm>)

Data available via the MACRIS web interface, and associated scanned files are for information purposes only. THE ACT OF CHECKING THIS DATABASE AND ASSOCIATED SCANNED FILES DOES NOT SUBSTITUTE FOR COMPLIANCE WITH APPLICABLE LOCAL, STATE OR FEDERAL LAWS AND REGULATIONS. IF YOU ARE REPRESENTING A DEVELOPER AND/OR A PROPOSED PROJECT THAT WILL REQUIRE A PERMIT, LICENSE OR FUNDING FROM ANY STATE OR FEDERAL AGENCY YOU MUST SUBMIT A PROJECT NOTIFICATION FORM TO MHC FOR MHC'S REVIEW AND COMMENT. You can obtain a copy of a PNF through the MHC web site ([www.sec.state.ma.us/mhc](http://www.sec.state.ma.us/mhc)) under the subject heading "MHC Forms."

Commonwealth of Massachusetts  
Massachusetts Historical Commission  
220 Morrissey Boulevard, Boston, Massachusetts 02125  
[www.sec.state.ma.us/mhc](http://www.sec.state.ma.us/mhc)

This file was accessed on: Friday, October 23, 2020 at 11:47 AM

Massachusetts Historical Commission  
80 Boylston Street  
Boston, Massachusetts 02116

12, 13

BILLERICA

CD

431-432, 949;  
1149-1158

CONCORD

Neighborhood or village)

North Quarter

Area 1549-1743 Monument St.

Use residential

Construction Dates or Period ca. 1800 to  
20th century

Condition good

Intrusions and Alterations

modern houses interspersed



## Sketch Map

Draw a map of the area indicating properties within it. Number each property for which individual inventory forms have been completed. Label streets including route numbers, if any. Attach a separate sheet if space is not sufficient here. Indicate North.

1743 Monument Street (CON. 1153)

Acreage

ca. 35 acres

Recorded by

A. Forbes

Organization

for Concord Histor. Comm.

Date (month/day/year)

July, 1992

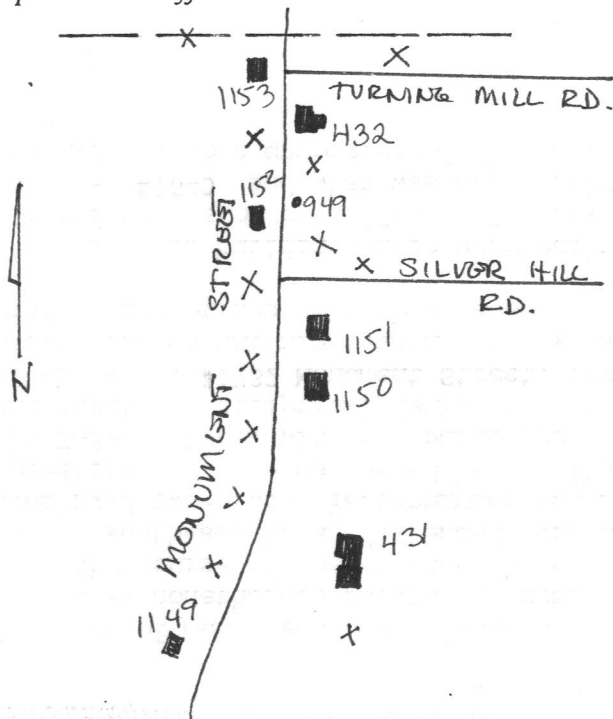

# ARCHITECTURAL DESCRIPTION ☐ *see continuation sheet*

*Describe architectural, structural and landscape features and evaluate in terms of other areas within the community.*

In spite of much recent development in the vicinity, the seven historic resources in this area nonetheless retain the character of a cluster of farmsteads that developed over the course of the nineteenth century into the twentieth. The area is anchored on the southeast by an "extended farmhouse," #1586 Monument Street, a well-preserved two-story, rear-chimney Federal house of ca.1800-1810, attached via a one-story ell to a gable-end barn. Its main entry is an excellent local example of the Federal type, with a 6-panel door, divided 2/3-length sidelights, and a louvered and keystoneed elliptical fanlight. At least part of the house at the northeast edge of the area, #1732 Monument Street, (most likely the east ell) also dates to the early part of the nineteenth century, about 1820. The main house is 2 1/2-stories with an asymmetrical four-bay facade.

All the other buildings here were built after the Civil War. They include two very altered houses of ca. 1870: a 2-story, three-bay gable-end with fully sidelighted entry at #1640, and what was apparently a four-bay, 1 1/2-story cottage enlarged and updated to a gambrel-roofed Colonial Revival early in this century, at #1689. (Cont.)

## HISTORICAL NARRATIVE ☐ *see continuation sheet*

*Explain historical development of the area. Discuss how this area relates to the historical development of the community.*

The northernmost section of Monument Street had a long association with the Blood family. Just to the north is the large tract of land owned as early as 1642 by Robert and John Blood. Called Blood's Farms, (Monument Street was laid out in 1686 as "the way to Blood's Farm") for many years it was not part of any town. From 1682 through the end of the eighteenth century, when it finally became a large part of the town of Carlisle, Blood's Farms and some of the farms here below the border were the subject of much disagreement in regard to paying taxes, the difficulty of traveling to church at the center, etc. As late as the end of the nineteenth century, in fact, the Carlisle border in this area was highly irregular. The entire Hodgman farm, for instance (#1640 Monument Street) was at that time in Carlisle, and the more northerly Conant Farm (at #1732) was still part of Concord. The town border was finally simplified to the current east-west line, with the river at the eastern boundary, in 1903-04.

One house here, #1586 Monument Street, belonged to descendants of the Bloods. This was the home of John F. Blood in the first half of the nineteenth century, and may date to ca. 1800-1810. Another, #1743, was built by a Portuguese farmer named Biggi (?) in 1884 as a replacement for another pre-1830 Blood house, the home of Perez Blood and his sisters, Sally and Polly. (Cont.)

## BIBLIOGRAPHY and/or REFERENCES ☐ *see continuation sheet*

Maps, atlases: 1830, 1852, 1856, 1875, 1889, 1906.  
Keyes/Tolman. "Houses in Concord." 1885; rev. 1915 and 1920's.  
Town Directories and tax lists.  
Concord Chronicle.  
Wheeler. Concord, Climate for Freedom.  
Shattuck.  
Interviews with owners.

☐ Recommended as a National Register District. *If checked, you must attach a completed National Register Criteria Statement form.*

INVENTORY FORM CONTINUATION SHEET

Community

Property

CONCORD

1549-1743 Monument St.

Massachusetts Historical Commission  
80 Boylston Street  
Boston, Massachusetts 02116

Area(s)    Form No.  
CD        431-2, 949;  
          1149-1153

DESCRIPTION, cont.

The house at #1743 is another vernacular gable-end "extended farmhouse". It dates to 1884; thus its scalloped verge boarding is one of Concord's later examples of this type of Gothic Revival decoration. Two early-twentieth-century houses represent very different house-types of the period--the continuation of the tall 2 1/2-story vernacular gable-end at #1549, and the long, simple Craftsman Bungalow at #1630. This area also includes one of the many commemorative markers scattered throughout Concord. This one, marking the home site of Jonas Brown, is a heavy two-part rough-faced granite structure, with a curved ashlar base and a heavy rectangular tablet with inscriptions in cartouches on all four sides. It dates to 1887.

HISTORICAL NARRATIVE, cont.

Many of the early houses here are gone, however. One was the home of Jonas Brown, a Revolutionary soldier who is commemorated by the 1887 granite marker erected opposite #1689.

The oldest section of the **Silas Conant House** (#1732 Monument Street), is said to date to as early as 1820. Silas was the great-grandson of Lot Conant, who had come to Concord early in the eighteenth century. He was a farmer, as was his son, **Andrew Conant**, who inherited the property after Silas' widow died. Andres Conant lived here until 1906, when the property was bought by **Alvin D. Puffer**, a soda-fountain manufacturer (A.D. Puffer & Sons). There is evidence that one outbuilding on the property was used as a machine shop in the soda fountain business; the Puffer family still run a repair shop for old soda fountains in Boston. Several Puffer family members apparently lived here, with **Willis R. Puffer** operating the farm as a "gentleman's farm" until the depression, after which it was operated for profit. At one period part of the house was used for boarders or wayfarers enroute from Ayer to Concord; there is even evidence of a billiard room in the east wing. In recent years the old Conant farm, which stretched east to the river, has been subdivided for the Turning Mill/Silver Hill Road development.

The other historic resources in this area date to the end of the nineteenth century and the beginning of the twentieth. #s 1640 and 1689, both highly altered houses, are ca. 1870 replacements of older residences. #1640 was built by **J. Hodgman**, and was later owned by farmer **George W. Hodgman**. #1689 was built by **John Cameron**, son-in-law of **Everett Mason**, owner of the house formerly on the property. Cameron was from Nova Scotia, and made his living both by farming and teaming. He died in 1882, and the farm returned to Mason family ownership.

The two early-twentieth-century houses here, #s 1549 and 1630, in spite of their altered state, illustrate the type of infill housing that was occurring even in Concord's most rural areas at that time. Even though the old farms had been greatly subdivided and reduced over the generations, this neighborhood was still a farming area as late as 1939, when every head-of-household was listed as a farmer.



CON.CD

INVENTORY FORM CONTINUATION SHEET

Community

Property

CONCORD

1549-1743 Monument St.

Massachusetts Historical Commission

Area(s)

~~Form No.~~

CD 431-432,

80 Boylston Street

949, 1149-1153

Boston, Massachusetts 02116

AREA DATA SHEET

[Asterisk (\*) indicates a property that is covered on an individual form.]

MHC #/ Parcel #	Address	description	date	condition
1149 I3-1400	1549 Monument Street	- astylistic, vernacular house Clapboard; rubble foundation. 2 1/2-stories, with many additions.	early 20th C.	fair
* 431 I3-1380	1586 Monument Street	- Federal Clapboard and shingle; fieldstone and granite foundation. 2 1/2-story "extended farmhouse".	ca. 1800	good
1150 I2-1381	1630 Monument Street	- Craftsman bungalow Synthetic siding; rubble foundation. Large addition at rear.	early 20th C.	fair
1151 I2-1382	1640 Monument Street	- formerly Greek Rev. vernacular Clapboard; granite foundation. 2-story gable-end house, with additions.	ca. 1870	fair
1152 I2-1391	1689 Monument Street	- L-plan 1 1/2-story gambrel- roofed house. Clapboard; rubble and granite foundation. Former cottage altered to Col. Revival in early 20th century.	ca. 1870	fair
949 I2-1384-3	Monument Street	- Granite marker on curved, rough- faced ashlar base.	1887	good
* 432 I2-1384-4	1732 Monument Street	- Vernac. early-20th C. update of older house. Shingle; granite foundation.	early 19th C.	fair
1153 I2-1388	1743 Monument Street	- vernacular gable-end "extended farmhouse" with scalloped verge-boardings, several 20th-C. additions.	1884	fair

AREA CD  
AL - NORTH QUARTER  
USGS - BILLERICA  
SECTION - C

1149 - 1549 MONUMENT ST (USGS-CONCORD)

1150 - 1630 MONUMENT ST (USGS-CONCORD)

1151 - 1640 MONUMENT ST (USGS-CONCORD)

1152 - 1689 MONUMENT ST

949 - MONUMENT ST

1153 - 1743 MONUMENT ST



1549 Monument Street (CON. 1149)



1689 Monument Street (CON. 1152)



1640 + 1630 Monument Street (CON. 1151  
and CON. 1150)

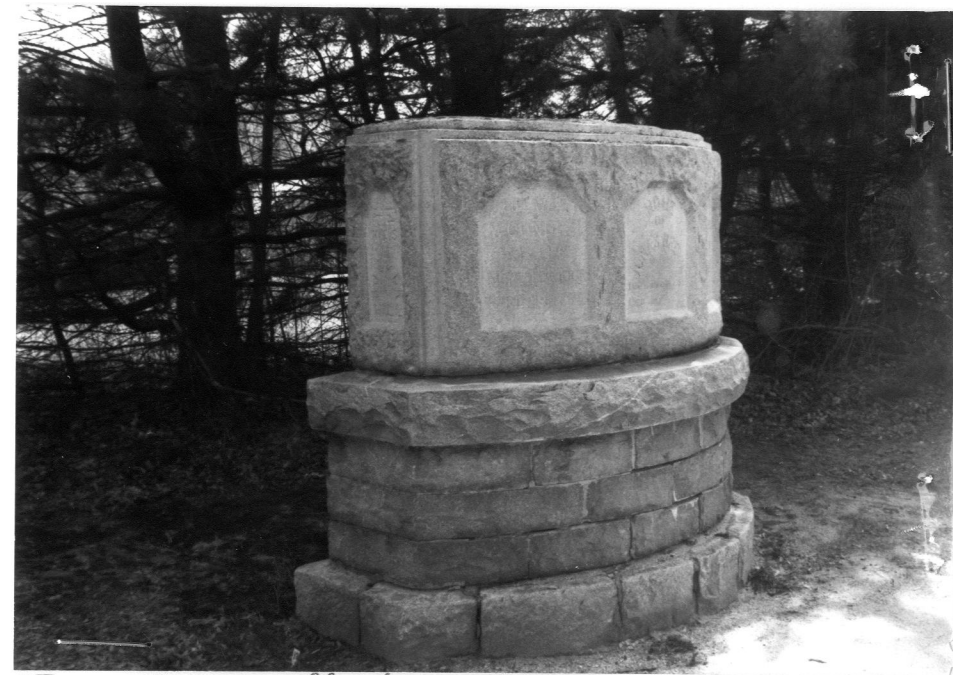

Jones Brown Marker (CON. 949)