

Massachusetts Cultural Resource Information System

Scanned Record Cover Page

Inventory No:	CON.CE
Historic Name:	Lowell Road Area
Common Name:	
Address:	
City/Town:	Concord
Village/Neighborhood:	Concord Center
Local No:	
Year Constructed:	
Architect(s):	
Architectural Style(s):	
Use(s):	Residential District
Significance:	Architecture; Conservation
Area(s):	
Designation(s):	
Building Materials(s):	



The Massachusetts Historical Commission (MHC) has converted this paper record to digital format as part of ongoing projects to scan records of the Inventory of Historic Assets of the Commonwealth and National Register of Historic Places nominations for Massachusetts. Efforts are ongoing and not all inventory or National Register records related to this resource may be available in digital format at this time.

The MACRIS database and scanned files are highly dynamic; new information is added daily and both database records and related scanned files may be updated as new information is incorporated into MHC files. Users should note that there may be a considerable lag time between the receipt of new or updated records by MHC and the appearance of related information in MACRIS. Users should also note that not all source materials for the MACRIS database are made available as scanned images. Users may consult the records, files and maps available in MHC's public research area at its offices at the State Archives Building, 220 Morrissey Boulevard, Boston, open M-F, 9-5.

Users of this digital material acknowledge that they have read and understood the MACRIS Information and Disclaimer (<http://mhc-macris.net/macrisdisclaimer.htm>)

Data available via the MACRIS web interface, and associated scanned files are for information purposes only. THE ACT OF CHECKING THIS DATABASE AND ASSOCIATED SCANNED FILES DOES NOT SUBSTITUTE FOR COMPLIANCE WITH APPLICABLE LOCAL, STATE OR FEDERAL LAWS AND REGULATIONS. IF YOU ARE REPRESENTING A DEVELOPER AND/OR A PROPOSED PROJECT THAT WILL REQUIRE A PERMIT, LICENSE OR FUNDING FROM ANY STATE OR FEDERAL AGENCY YOU MUST SUBMIT A PROJECT NOTIFICATION FORM TO MHC FOR MHC'S REVIEW AND COMMENT. You can obtain a copy of a PNF through the MHC web site (www.sec.state.ma.us/mhc) under the subject heading "MHC Forms."

Commonwealth of Massachusetts
Massachusetts Historical Commission
220 Morrissey Boulevard, Boston, Massachusetts 02125
www.sec.state.ma.us/mhc

This file was accessed on: Friday, October 23, 2020 at 11:48 AM

Massachusetts Historical Commission

G8

CONCORD

CE

1154, 1155



CONCORD

Neighborhood or village)

Concord Center

Area 169 and 181 Lowell Road

Use residential

Construction Dates or Period 1910's-1930's

Condition good

169 and 181 Lowell Road
(CON. 1154 and CON. 1155)

Major Intrusions and Alterations
two industrial buildings just south

ca. one acre

Acreage A. Forbes

Recorded by for Concord Histor. Comm.

Organization June, 1992

Date (month/day/year)

Sketch Map

Draw a map of the area indicating properties within it. Number each property for which individual inventory forms have been completed. Label streets including route numbers, if any. Attach a separate sheet if space is not sufficient here. Indicate North.

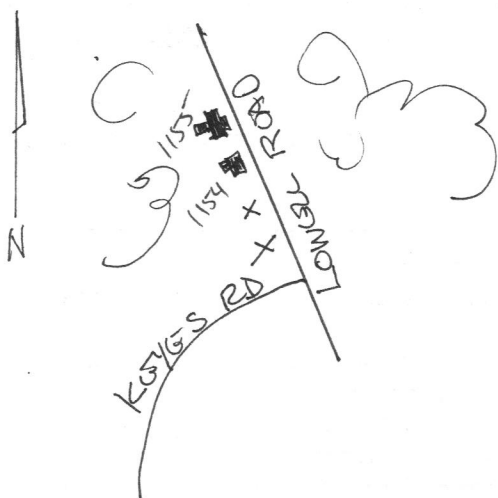

AREA FORM

ARCHITECTURAL DESCRIPTION ☐ *see continuation sheet*

Describe architectural, structural and landscape features and evaluate in terms of other areas within the community.

These houses abut the northern edge of the small commercial/industrial area that began to grow up around the Middlesex Central Railroad depot in the 1870's.

#181, apparently the earlier house, is a five-bay Colonial Revival "Cape Cod cottage," with a pair of dormers over the facade, and an exterior chimney on the south end. A one-story gable-roofed den also extends from the south end. The details of the house are vigorously Colonial Revival: the windows are 9-over-6-sash with molded surrounds, the entry has a 6-panel door with a shallow pediment and fluted pilasters, and the architectural trim includes a molded, boxed cornice with wide frieze, a sill board, and corner pilasters.

#169, although set on a somewhat anachronistic brick foundation, is a 2 1/2-story, five-bay, center-chimney Colonial (Federal) Revival house characteristic of the late 1920's-'30's. It has a two-story wing on the south, and another on the north. Like #181 it also has 9-over-6-sash windows and a full component of architectural trim, which here includes wide cornerboards and a molded, boxed cornice. The pedimented and fanlighted doorway may be a later alteration.

HISTORICAL NARRATIVE ☐ *see continuation sheet*

Explain historical development of the area. Discuss how this area relates to the historical development of the community.

These two are the only houses built on what was formerly town-owned land on the west side of Lowell Road between the Middlesex Central Railroad and the river. They stand on the southeast edge of the old calf pasture, most of which is still preserved as town conservation land. Further research will be necessary to determine for whom they were originally built.

AREA DATA SHEET

MHC #/ Parcel #	Address	description	approx. date	condition
1154 G8-1679-1	169 Lowell Road -	Col. Revival Cape Cod cottage	early 20th century	good
1155 G8-1678	181 Lowell Road -	Col. Revival 2 1/2-story house	early 20th century	good

BIBLIOGRAPHY and/or REFERENCES ☐ *see continuation sheet*

Tax assessor's records.

☐ Recommended as a National Register District. *If checked, you must attach a completed National Register Criteria Statement form.*

MHC INVENTORY FORM CONTINUATION SHEET

MHC Inventory scanning project, 2008-2012

MACRIS No. CON-CE

AREA CE
PL- CONCORD
USGS- CONCORD
SECTION - B

1154- 169 LOWELL RD (ALSO DV- LHD- 3/5/73)

1155- 181 LOWELL RD (ALSO DV- LHD 3/5/73)