

# Massachusetts Cultural Resource Information System

## Scanned Record Cover Page

<b>Inventory No:</b>	CON.CN
<b>Historic Name:</b>	Triangle Farm
<b>Common Name:</b>	
<b>Address:</b>	
<b>City/Town:</b>	Concord
<b>Village/Neighborhood:</b>	Bateman's Pond; North Quarter
<b>Local No:</b>	
<b>Year Constructed:</b>	
<b>Architect(s):</b>	
<b>Architectural Style(s):</b>	
<b>Use(s):</b>	Agricultural; Other Residential
<b>Significance:</b>	Agriculture; Architecture
<b>Area(s):</b>	
<b>Designation(s):</b>	
<b>Building Materials(s):</b>	



The Massachusetts Historical Commission (MHC) has converted this paper record to digital format as part of ongoing projects to scan records of the Inventory of Historic Assets of the Commonwealth and National Register of Historic Places nominations for Massachusetts. Efforts are ongoing and not all inventory or National Register records related to this resource may be available in digital format at this time.

The MACRIS database and scanned files are highly dynamic; new information is added daily and both database records and related scanned files may be updated as new information is incorporated into MHC files. Users should note that there may be a considerable lag time between the receipt of new or updated records by MHC and the appearance of related information in MACRIS. Users should also note that not all source materials for the MACRIS database are made available as scanned images. Users may consult the records, files and maps available in MHC's public research area at its offices at the State Archives Building, 220 Morrissey Boulevard, Boston, open M-F, 9-5.

Users of this digital material acknowledge that they have read and understood the MACRIS Information and Disclaimer (<http://mhc-macris.net/macrisdisclaimer.htm>)

Data available via the MACRIS web interface, and associated scanned files are for information purposes only. THE ACT OF CHECKING THIS DATABASE AND ASSOCIATED SCANNED FILES DOES NOT SUBSTITUTE FOR COMPLIANCE WITH APPLICABLE LOCAL, STATE OR FEDERAL LAWS AND REGULATIONS. IF YOU ARE REPRESENTING A DEVELOPER AND/OR A PROPOSED PROJECT THAT WILL REQUIRE A PERMIT, LICENSE OR FUNDING FROM ANY STATE OR FEDERAL AGENCY YOU MUST SUBMIT A PROJECT NOTIFICATION FORM TO MHC FOR MHC'S REVIEW AND COMMENT. You can obtain a copy of a PNF through the MHC web site ([www.sec.state.ma.us/mhc](http://www.sec.state.ma.us/mhc)) under the subject heading "MHC Forms."

Commonwealth of Massachusetts  
Massachusetts Historical Commission  
220 Morrissey Boulevard, Boston, Massachusetts 02125  
[www.sec.state.ma.us/mhc](http://www.sec.state.ma.us/mhc)

This file was accessed on: Friday, October 23, 2020 at 12:01 PM

Massachusetts Historical Commission  
80 Boylston Street  
Boston, Massachusetts 02116

E2-1565-2

WESTFORD

CN

1185, 1186, 950

RECEIVED

Town

CONCORD

Neighborhood or village)

North Quarter

Area Triangle Farm

Use agricultural

Construction Dates or Period early  
20th Century

Condition excellent

Additions and Alterations none

Acreage 15.75 acres

Recorded by A. Forbes

Organization for Concord Histor. Comm.

Date (month/day/year) July, 1992

## Sketch Map

Draw a map of the area indicating properties within it. Number each property for which individual inventory forms have been completed. Label streets including route numbers, if any. Attach a separate sheet if space is not sufficient here. Indicate North.

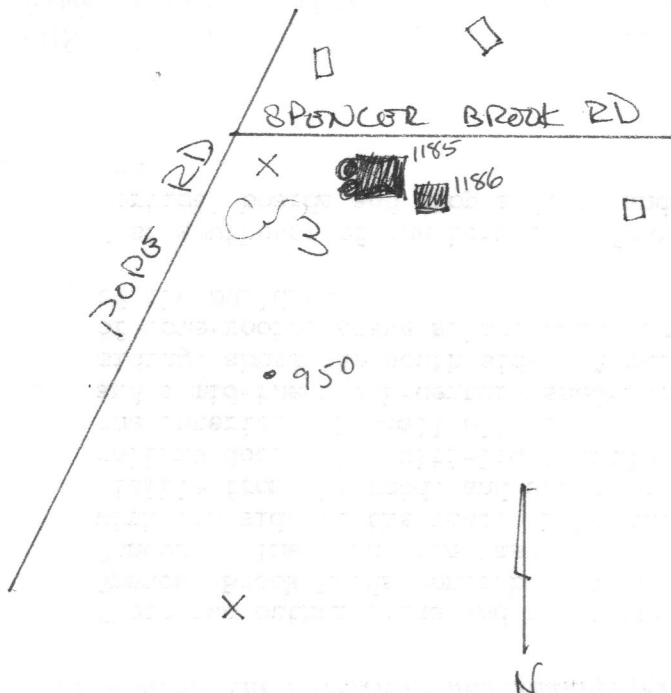

AREA FORM

ARCHITECTURAL DESCRIPTION ☐ *see continuation sheet*

*Describe architectural, structural and landscape features and evaluate in terms of other areas within the community.*

These two outbuildings and thirteen-acre pasture at the intersection of Pope and Spencer Brook Roads contribute greatly to the pastoral atmosphere of this part of Concord. The barn, the last of its type on the road, is a long gable-end structure with its side to the road. Like many of its time, it is clapboarded on the sides visible from the road, and shingled on the rear. The main wagon door is a two-part rolling door with multi-light windows; a transom above the door lets more light into the interior. A small ell projects forward from the southeast corner of the facade, and a mid-twentieth-century shed-roofed stable wing, clad in beveled or "drop" siding, abuts the south side. A pair of metal vents pierces the ridge, and a pair of dome-roofed stave silos, once common, but now rare in Concord, abuts the west end of the building.

Just southeast of the barn is a four-bay wagon shed of ca. 1950. It is clad in vertical boards and drop siding, and has a long shed roof. An ell abuts the west end.

HISTORICAL NARRATIVE ☐ *see continuation sheet*

*Explain historical development of the area. Discuss how this area relates to the historical development of the community.*

The cluster of outbuildings and rolling pasture land here at the corner of Spencer Brook and Pope Roads remain from the last working farm in the vicinity, "Triangle Farm".

From 1901 to the mid-1930's much of the Concord section of the farm, (80+ additional acres of it were eventually added across Pope Road in Acton), was owned by Mons Olsen, who lived first at #110 Spencer Brook Road, and after 1934 in a cottage at #158. He moved the barn up from the Judge Keyes property in about 1914. The pasture on Pope Road was apparently part of the farm which had belonged in the mid-nineteenth century to J. E. Wadley, and after his death to his son Frank. In the early part of this century it belonged to Martinus Helscher, owner of the farmstead just east at #107 Spencer Brook Road. Mons Olsen kept cows in the barn, and grew asparagus and other crops on fields in the northern part of the ca. 20-acre triangle bounded by Westford, Spencer Brook, and Pope Roads. In 1934 Mr. and Mrs. John McMillan purchased most of Mons Olsen's property, including the farmhouse at #110. In 1938 Mr. and Mrs. Fisher Nesmith bought the farmhouse, along with the fields in the triangle and a strip of orchard with the Olsen barn here on the south side of the road. (Cont.)

BIBLIOGRAPHY and/or REFERENCES ☐ *see continuation sheet*

Keyes/Tolman. "Houses in Concord." 1885; rev. 1915 and 1920's.  
Interview with owners, 7/92.

☐ Recommended as a National Register District. *If checked, you must attach a completed National Register Criteria Statement form.*

## INVENTORY FORM CONTINUATION SHEET

Community

Property

CONCORDTriangle Farm

Massachusetts Historical Commission  
80 Boylston Street  
Boston, Massachusetts 02116

Area(s) Form No.  
CN 1185-86;  
950

## HISTORICAL SIGNIFICANCE, cont.

Mrs. Nesmith was later Mrs. George Clayton Greene, and the Greenes purchased the field on Pope Road in about 1946, added the property in Acton, and carried on the dairy operations into the late 1960's. They added the leanto on the south side of the barn to house a flock of sheep; it was later converted to an area for cows in stanchions. The barn and wagon house are now used for storage, and the field is leased as a pasture.

-----  
AREA DATA SHEET

MHC #/ Parcel #	Address	name/description	date	condition
1185 <sup>149</sup> E2-1565-2	Spencer Brook Road	utilitarian gable-end barn Clapboard, shingle, drop-siding; fieldstone and granite foundation. Pair of stave silos abutting west end.	mid-19th century	
1186 <sup>149</sup> E2-1565-2	Spencer Brook Road	shed-roofed utilitarian wagon shed Vertical-board and drop-siding; Concrete foundation.	mid-20th century	
950 E2-1567	Spencer Brook Road	pasture land	13.5 acres	N/A

Barn, Spencer Brook Road

