

Massachusetts Cultural Resource Information System

Scanned Record Cover Page

Inventory No:	CON.CP
Historic Name:	Elm Street Area II
Common Name:	
Address:	
City/Town:	Concord
Village/Neighborhood:	West Concord
Local No:	
Year Constructed:	
Architect(s):	
Architectural Style(s):	
Use(s):	Residential District
Significance:	Architecture; Community Planning
Area(s):	
Designation(s):	
Building Materials(s):	



The Massachusetts Historical Commission (MHC) has converted this paper record to digital format as part of ongoing projects to scan records of the Inventory of Historic Assets of the Commonwealth and National Register of Historic Places nominations for Massachusetts. Efforts are ongoing and not all inventory or National Register records related to this resource may be available in digital format at this time.

The MACRIS database and scanned files are highly dynamic; new information is added daily and both database records and related scanned files may be updated as new information is incorporated into MHC files. Users should note that there may be a considerable lag time between the receipt of new or updated records by MHC and the appearance of related information in MACRIS. Users should also note that not all source materials for the MACRIS database are made available as scanned images. Users may consult the records, files and maps available in MHC's public research area at its offices at the State Archives Building, 220 Morrissey Boulevard, Boston, open M-F, 9-5.

Users of this digital material acknowledge that they have read and understood the MACRIS Information and Disclaimer (<http://mhc-macris.net/macrisdisclaimer.htm>)

Data available via the MACRIS web interface, and associated scanned files are for information purposes only. THE ACT OF CHECKING THIS DATABASE AND ASSOCIATED SCANNED FILES DOES NOT SUBSTITUTE FOR COMPLIANCE WITH APPLICABLE LOCAL, STATE OR FEDERAL LAWS AND REGULATIONS. IF YOU ARE REPRESENTING A DEVELOPER AND/OR A PROPOSED PROJECT THAT WILL REQUIRE A PERMIT, LICENSE OR FUNDING FROM ANY STATE OR FEDERAL AGENCY YOU MUST SUBMIT A PROJECT NOTIFICATION FORM TO MHC FOR MHC'S REVIEW AND COMMENT. You can obtain a copy of a PNF through the MHC web site (www.sec.state.ma.us/mhc) under the subject heading "MHC Forms."

Commonwealth of Massachusetts
Massachusetts Historical Commission
220 Morrissey Boulevard, Boston, Massachusetts 02125
www.sec.state.ma.us/mhc

This file was accessed on: Friday, October 23, 2020 at 12:01 PM

CON.C.P.

Massachusetts Historical Commission
80 Boylston Street
Boston, Massachusetts 02116

C-7

MAYNARD

CP

1196-1199

CONCORD

Neighborhood or village) _____

West Concord

Area 1245-1287 Elm Street

Use residential

Construction Dates or Period 1880's-1930's

Condition good

Intrusions and Alterations
none

approx. 4.25 acres

Acreage _____
A. ForbesRecorded by _____
for Concord Hist. Comm.Organization _____
June, 1992

Date (month/day/year) _____

1245 and 1257 Elm (CON. 1196 and
CON. 1197)
Sketch Map
Draw a map of the area indicating properties within
it. Number each property for which individual
inventory forms have been completed. Label streets
including route numbers, if any. Attach a separate
sheet if space is not sufficient here. Indicate North.

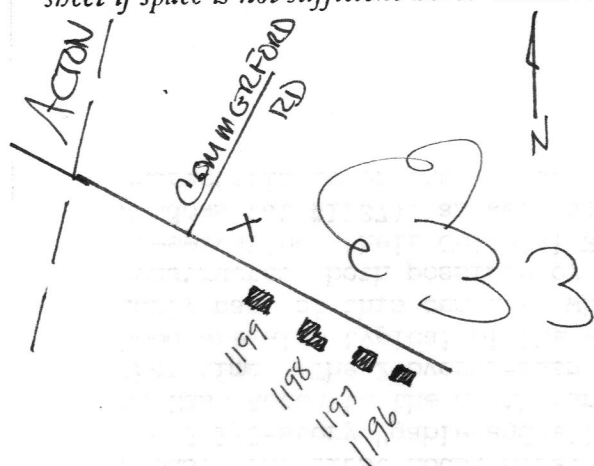

AREA FORM

CON. CP

ARCHITECTURAL DESCRIPTION ☒ *see continuation sheet*

Describe architectural, structural and landscape features and evaluate in terms of other areas within the community.

A cluster of four houses on the west side of Elm Street between Reformatory Circle and the Acton town line is an eloquent illustration of the way one small neighborhood developed in response to changes in the surrounding area. Through the middle of the nineteenth century, in spite of its proximity to the growing mill village of East Acton, land along this part of Elm Street was all farmland and woods. The first house here, #1273, was evidently built in the 1880's. It is in the 2 1/2-story "gable-and-ell" configuration that was typical of houses put up both in East Acton to the north, and in the Concord Reformatory area to the south, at that time. The 2-over-2-sash windows and the elaborate Italianate-bracketed door hood are also typical of the era. No other houses were built in here until the early part of this century, when two bungalows, #s 1245 and 1287 were constructed, both possibly by the same builder. Still in a good state of preservation, their Colonial Revival details, 6-over-6-sash (at #1245) and casement windows (at #1287), as well as the large fieldstone facade chimney at #1287, are characteristic of the vernacular houses of the 1910's-1920's. (Cont.)

HISTORICAL NARRATIVE ☐ *see continuation sheet*

Explain historical development of the area. Discuss how this area relates to the historical development of the community.

These houses occupy a former farm area that by the end of the nineteenth century was a logical location for small-scale residential development, as it stood on the main road between the Concord Reformatory to the south, and the village of East Acton, where there was a small village center and railroad depot, just to the north. #1273, which may have been standing by 1880, was evidently built for a member of the Reformatory staff. Officer **Frank Garland** is listed here by 1896.

BIBLIOGRAPHY and/or REFERENCES ☐ *see continuation sheet*

Maps and atlases: 1906.
Town assessor's records.
Town directories.

☐ Recommended as a National Register District. *If checked, you must attach a completed National Register Criteria Statement form.*

CON.CP

INVENTORY FORM CONTINUATION SHEET

Community

Property

CONCORD

1245-1287 Elm Street

Massachusetts Historical Commission
80 Boylston Street
Boston, Massachusetts 02116

Area(s) Form No.
CP 1196-1199

DESCRIPTION, cont.

#1257 presents another early-twentieth-century house-type that was appearing throughout Concord by 1930, the little "Cape Cod" cottage. It, too, has an exterior chimney; the paneled shutters with cut-out designs both here and at #1254 are typical features of the 1920's and early '30's.

AREA DATA SHEET

MHC #/ Parcel #	Address	description	date	condition
1196 C7-2005	1245 Elm Street	- Craftsman Bungalow Wood shakes; concrete foundation.	early 20th C.	excellent
1197 C7-2004	1257 Elm Street	- Cape Cod cottage Wood shakes; rubble foundation.	early 20th C.	good
1198 C7-2003	¹²⁷¹ 1273 Elm Street	- Vernacular Italianate 2 1/2-story gable-end house Wood clapboard. Some window and door replacement; porches added.	ca. 1880's	good
1199 C7-2002	1287 Elm Street	- Craftsman Bungalow Wood shakes, rubble foundation. Sun porch added on south end.	early 20th C.	good



1245 Elm Street (CON. 1196)



1287 Elm Street (CON. 1199)



1273 Elm Street (CON. 1198)