

Massachusetts Cultural Resource Information System

Scanned Record Cover Page

Inventory No:	CON.DE
Historic Name:	Main Streetscape VI
Common Name:	
Address:	
City/Town:	Concord
Village/Neighborhood:	West Concord
Local No:	
Year Constructed:	
Architect(s):	
Architectural Style(s):	
Use(s):	Residential District
Significance:	Architecture; Community Planning
Area(s):	
Designation(s):	
Building Materials(s):	



The Massachusetts Historical Commission (MHC) has converted this paper record to digital format as part of ongoing projects to scan records of the Inventory of Historic Assets of the Commonwealth and National Register of Historic Places nominations for Massachusetts. Efforts are ongoing and not all inventory or National Register records related to this resource may be available in digital format at this time.

The MACRIS database and scanned files are highly dynamic; new information is added daily and both database records and related scanned files may be updated as new information is incorporated into MHC files. Users should note that there may be a considerable lag time between the receipt of new or updated records by MHC and the appearance of related information in MACRIS. Users should also note that not all source materials for the MACRIS database are made available as scanned images. Users may consult the records, files and maps available in MHC's public research area at its offices at the State Archives Building, 220 Morrissey Boulevard, Boston, open M-F, 9-5.

Users of this digital material acknowledge that they have read and understood the MACRIS Information and Disclaimer (<http://mhc-macris.net/macrisdisclaimer.htm>)

Data available via the MACRIS web interface, and associated scanned files are for information purposes only. THE ACT OF CHECKING THIS DATABASE AND ASSOCIATED SCANNED FILES DOES NOT SUBSTITUTE FOR COMPLIANCE WITH APPLICABLE LOCAL, STATE OR FEDERAL LAWS AND REGULATIONS. IF YOU ARE REPRESENTING A DEVELOPER AND/OR A PROPOSED PROJECT THAT WILL REQUIRE A PERMIT, LICENSE OR FUNDING FROM ANY STATE OR FEDERAL AGENCY YOU MUST SUBMIT A PROJECT NOTIFICATION FORM TO MHC FOR MHC'S REVIEW AND COMMENT. You can obtain a copy of a PNF through the MHC web site (www.sec.state.ma.us/mhc) under the subject heading "MHC Forms."

Commonwealth of Massachusetts
Massachusetts Historical Commission
220 Morrissey Boulevard, Boston, Massachusetts 02125
www.sec.state.ma.us/mhc

This file was accessed on: Friday, October 23, 2020 at 12:11 PM

CON. DE

FORM G - STREETSCAPE

MASSACHUSETTS HISTORICAL COMMISSION
80 BOYLSTON STREET
BOSTON, MA 02116

AREA	FORM NO.
FIDE	258
West Concord	

Town West Concord



Street Name Main St., (S. side)

Addresses (inclusive) 1415-1515

Description

Original Date or Period 1890's-1916

Dominant Architectural Styles Colonial Revival

Other Intrusions Two mid 20th-century Cape Cod houses at #s 1443 and 1453.

Alterations Rebuilding at 1461; synthetic siding on five houses

1461, 1471, 1479 Main Street (CON. 1521, CON. 1522, CON. 1523)

Sketch Map: Draw map of street, clearly showing all buildings; indicate street addresses for all buildings; identify intrusions. Indicate north.

Acreage Approximately 3 1/2 acres

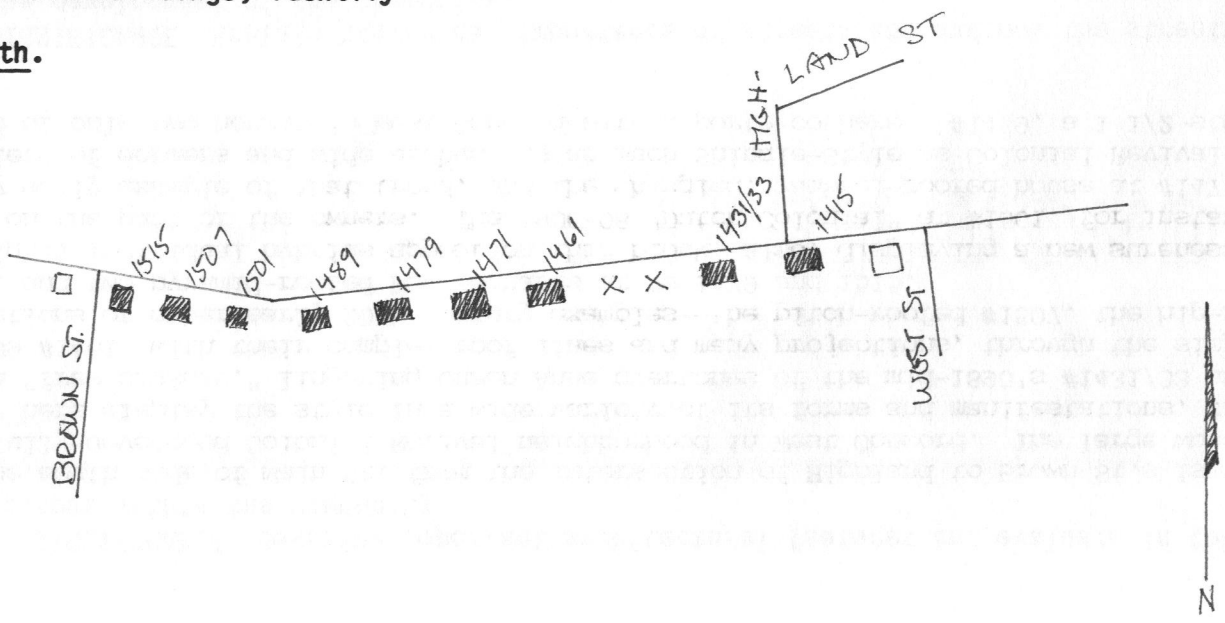

UTM REFERENCE _____

USGS QUADRANGLE _____

SCALE _____

Recorded by A. Forbes

Organization for Concord Hist. Comm.

Date 3/5/88

NATIONAL REGISTER CRITERIA STATEMENT (if applicable)

ARCHITECTURAL SIGNIFICANCE Describe important architectural features and evaluate in terms of other streetscapes within the community.

The south side of Main St. from the intersection of Highland to Brown St.s is the most fully-developed Colonial Revival neighborhood in West Concord. The large wood-frame houses here display the style in a wide variety of its forms and manifestations, from the hybrid "free classic," lingering Queen Anne overtones of the mid-1890's #1431/33 and the 1906-09 #1461, with their complex roof lines and many projections, through the simpler proportions of other early 20th-century examples--the pitch-roofed #1507, the hip-roofed #1415, and two pyramid-roofed Four-Squares at #s 1479 and 1515.

Highly individual hybrids appear on this block, also, displaying a new sureness of style on the part of the owners. The 1906-08 "Dutch Colonial" at #1501, for instance, is a very early example of that trend, and the shingled, gambrel-roofed house at #1471, with its tiers of dormers and wide arches, is as much Shingle-Style as Colonial Revival, and is one of only two houses in West Concord with a porte-cochere. #1489, a 1 1/2-story

HISTORICAL SIGNIFICANCE Explain historical importance of streetscape and how the streetscape relates to the development of the community.

Located just west of the original 1874 "Derby Addition," this section of Main St. was largely filled in by 1910, forming the final link between West Concord's two mid-19th century villages, Westvale and Concord Junction. With the building of this group of houses, fifty years after Ralph Warner established his tub and pail factory on Nashoba Brook and began to build the tiny settlement of "Warnerville" for his workers, and nearly forty years after the creation of the junction, West Concord was now a community of continuous residential neighborhoods.

BIBLIOGRAPHY and/or REFERENCES

- Richardson, Laurence. Concord Chronicle, 1865-1899. Concord: 1967.
 Beers, F.W. Map of Concord, from Beers' Atlas of Middlesex County, 1875.
 Walker, George. Map of Concord Junction, part of Concord. 1889.
 Town Directories and Tax Records.

INVENTORY FORM CONTINUATION SHEET

MASSACHUSETTS HISTORICAL COMMISSION
Office of the Secretary, Boston

Community:

West Concord

Form No:

FIDE

Property Name:

1415-1515 Main St.

Indicate each item on inventory form which is being continued below.

ARCHITECTURAL SIGNIFICANCE, cont.

house with a flared-pitched, slate roof, combines Colonial Revival detail with Queen Anne eccentricity. Both Tuscan and Ionic columns appear on the porch, in front of a wide inner, flat archway with slanted sides.

The houses here are also marked by a great variety of window designs, including a multiplicity of rectangular sash combinations, and many other shapes as well--lunettes and an oriel at #1461, a vertical oval at #1489, and a Palladian at #1461.



1489 Main Street (CON. 1524)