

Massachusetts Cultural Resource Information System

Scanned Record Cover Page

Inventory No:	CON.X
Historic Name:	Herringville
Common Name:	
Address:	
City/Town:	Concord
Village/Neighborhood:	Concord Center
Local No:	
Year Constructed:	
Architect(s):	
Architectural Style(s):	
Use(s):	Residential District
Significance:	Architecture; Community Planning; Ethnic Heritage
Area(s):	
Designation(s):	
Building Materials(s):	



The Massachusetts Historical Commission (MHC) has converted this paper record to digital format as part of ongoing projects to scan records of the Inventory of Historic Assets of the Commonwealth and National Register of Historic Places nominations for Massachusetts. Efforts are ongoing and not all inventory or National Register records related to this resource may be available in digital format at this time.

The MACRIS database and scanned files are highly dynamic; new information is added daily and both database records and related scanned files may be updated as new information is incorporated into MHC files. Users should note that there may be a considerable lag time between the receipt of new or updated records by MHC and the appearance of related information in MACRIS. Users should also note that not all source materials for the MACRIS database are made available as scanned images. Users may consult the records, files and maps available in MHC's public research area at its offices at the State Archives Building, 220 Morrissey Boulevard, Boston, open M-F, 9-5.

Users of this digital material acknowledge that they have read and understood the MACRIS Information and Disclaimer (<http://mhc-macris.net/macrisdisclaimer.htm>)

Data available via the MACRIS web interface, and associated scanned files are for information purposes only. THE ACT OF CHECKING THIS DATABASE AND ASSOCIATED SCANNED FILES DOES NOT SUBSTITUTE FOR COMPLIANCE WITH APPLICABLE LOCAL, STATE OR FEDERAL LAWS AND REGULATIONS. IF YOU ARE REPRESENTING A DEVELOPER AND/OR A PROPOSED PROJECT THAT WILL REQUIRE A PERMIT, LICENSE OR FUNDING FROM ANY STATE OR FEDERAL AGENCY YOU MUST SUBMIT A PROJECT NOTIFICATION FORM TO MHC FOR MHC'S REVIEW AND COMMENT. You can obtain a copy of a PNF through the MHC web site (www.sec.state.ma.us/mhc) under the subject heading "MHC Forms."

Commonwealth of Massachusetts
Massachusetts Historical Commission
220 Morrissey Boulevard, Boston, Massachusetts 02125
www.sec.state.ma.us/mhc

This file was accessed on: Friday, October 23, 2020 at 11:00 AM

CON.X

FORM A - AREA

MASSACHUSETTS HISTORICAL COMMISSION
80 BOYLSTON STREET, BOSTON, MA 02116

RECEIVED

NOV 17 1992

Area Letter Form numbers in this Area

X	Yi 371-374, 552-586
---	------------------------

CONCORD

Town _____

Name of Area (if any) _____
Herringville



Use	residential
Date or Period	late 1870's-1920
Condition	excellent to altered
Size	approx. nine acres
Recorded by	A. Forbes research by Ted Shidler for Concord Hist. Comm.
Date	July, 1990

NOTE: CIRCLED PROPERTIES
ARE COVERED ON INDIVIDUAL
FORMS.

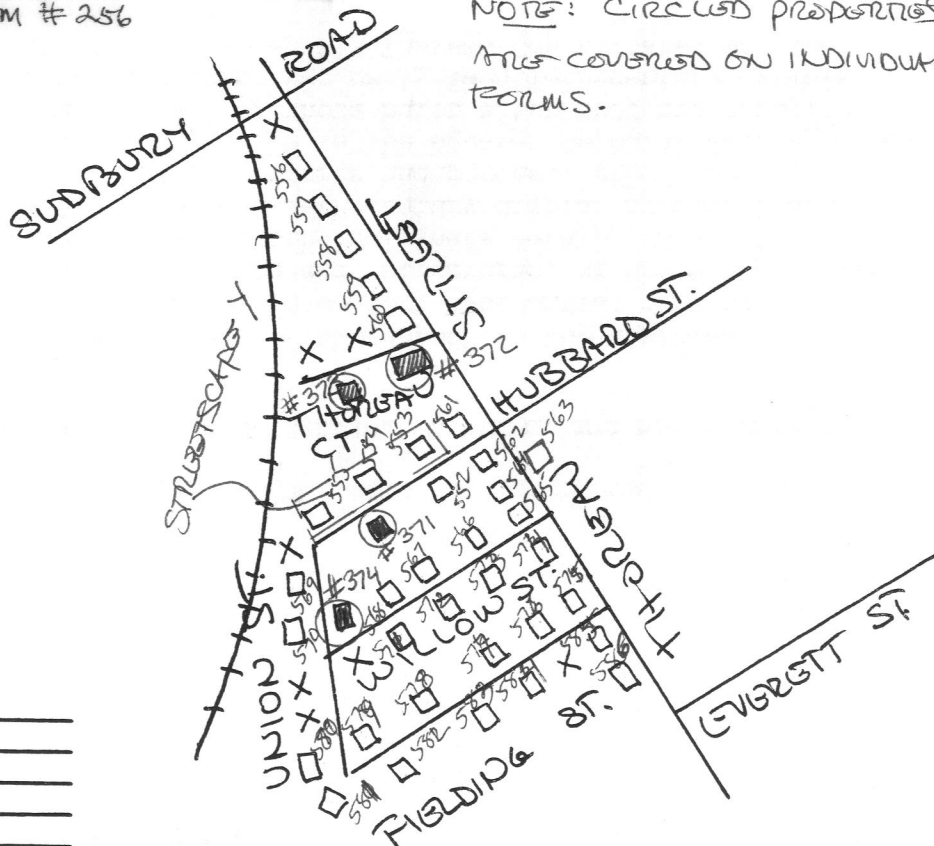

8 UNION ST.

UTM REFERENCE

USGS QUADRANGLE
SCALE

"NATIONAL REGISTER CRITERIA STATEMENT (if applicable)

ARCHITECTURAL SIGNIFICANCE Describe important architectural features and evaluate in terms of other areas within the community.

Herringtonville, like the large neighborhood "back of the depot" to the northwest, is a largely intact late-nineteenth and early-twentieth-century residential area of vernacular houses on small lots. Many are "gable-end" structures, of which the earlier examples, built in the 1880's, are embellished with Italianate detail. Most of those built in the 1890's and first decade of the twentieth century display subdued Queen Anne ornament, often combined with Colonial Revival entries and porches, etc. The later houses, built in the 1910's, are more likely to be in the squarer Colonial Revival mode, with hipped roofs and classical detail. Many of those built after 1900 are shingled. Several double houses were built here, including two early-twentieth-century examples of the "double-decker" form. One relocated house, at #19 Thoreau Court, dates to the mid-18th century.

HISTORICAL SIGNIFICANCE Explain historical importance of area and how the area relates to the development of other areas of the community.

This little neighborhood, situated south of Sudbury Road between today's Thoreau Street and the railroad tracks, began in 1872, with the laying out of the town's first real subdivision of land for house lots from Ebenezer Hubbard's farm at Concord center. In anticipation of the coming building boom, a new street, later called Thoreau Street, was extended that same year from Brister's Hill north to the depot. Four lots are shown here flanking the end of Hubbard Street on the original subdivision plan; within a few years those on Thoreau Court had themselves been subdivided, and eight houses were standing in the area by 1889, eleven by 1893. By that time the former Wheeler and Stow farmland east and west of the core area had all been acquired by lumber dealer James B. Wood, who had recently been responsible for much of the development in the Grant Street area "back of the depot", and it appears that it was he who was responsible for subdividing Willow Street and Thoreau between Thoreau Ct. and Sudbury Road.

James Wood died just after the turn of the century, and much of the land he owned was acquired by the team of Lowden and Wilson, carpenters and builders, (later R.L. Wilson, Inc.,) who over the first two decades of the twentieth century built several houses in the area. Andrew Lowden had been building houses on Hubbard Street from the 1880's, (cf. his own house of 1887, 211 Hubbard Street.) Richard Wilson appears to have immigrated from Canada about ten years later. Some houses attributed to either Andrew Lowden or Lowden & Wilson include 8 Union Street, 212 Thoreau Street, 12/14 Willow Street, and Andrew Lowden's own house at 211 Hubbard Street. (Cont.)

BIBLIOGRAPHY and/or REFERENCES

Maps and atlases: 1875, 1889, 1906; Sanborns from 1903.
 Garrelick and Bailey, Concord in the Days of Strawberries and Streetcars.
 Richardson, Concord Chronicle.
 Town directors
 Wayne.

INVENTORY FORM CONTINUATION SHEET

MASSACHUSETTS HISTORICAL COMMISSION
Office of the Secretary, Boston

CON.X
Community:

CONCORD

Form No:

Property Name: Herringville

Indicate each item on inventory form which is being continued below.

HISTORICAL SIGNIFICANCE, cont.

By 1906 Willow and the northwest end of Union Street were being built up. Fielding Street was laid out several years later, and at least three houses there, #s 28, 31, and 34, are ascribed to Richard Wilson, who by that time had founded Wilson Lumber Co. behind the depot in the old lumber, coal, and grain yard of James Wood and Benjamin Brown.

In the early twentieth century, this neighborhood acquired the name of "Herringville," supposedly for the many immigrants from Nova Scotia who bought or rented houses there. The area reflected the presence of another ethnic concentration in this general part of town, however, when the Norwegian and Danish Methodist Church was built on the corner of Thoreau and Thoreau Ct. in 1893.

Staple to Inventory form at bottom

INVENTORY FORM CONTINUATION SHEET

CONCORD

Herringville

AREA : HERRINGVILLE AREA DATA SHEET

Degree of Integrity: Excellent=intact, unaltered; Good=minor alterations only; fair=alterations such as synthetic siding, replacement windows/doors, or minor changes in form; Alt.=many alterations, integrity greatly diminished.

An asterisk [*] indicates that a property is also covered on an individual or small group form.

<u>MHC/Map #</u>	<u>Street address</u>	<u>Description</u>	<u>Approx. date</u>	<u>Degree of integrity</u>
<u>Fielding Street</u>				
576	18 Fielding St.	vernac. Q. Anne	ca. 1910-15	fair
584	23 Fielding St.	" " "	" " "	"
577	24 Fielding St.	" " "	" " "	"
578	28 Fielding St.	" " "	" " "	good
583	31 Fielding St.	" Col. Revival	" " "	"
579	34 Fielding St.	" Queen Anne	" " "	"
582	37 Fielding St.	" Col. Revival	" " "	alt.
581	43 Fielding St.	" " " gambrel	" " "	alt.

Hubbard Street

553	*204 Hubbard St.	vernac. Italianate	1880's	exc.
552	205 Hubbard St.	vernac. Q. Anne	ca. 1880's	good
371	*211 Hubbard St.	" " " A.S. Lowden	1887	exc.
554	*212 Hubbard St.	" Italianate	1880's	good
555	*220 Hubbard St.	" "	1880's	good

CON.X

INVENTORY FORM CONTINUATION SHEET

CONCORD

Herringtonville

<u>MHC/Map #</u>	<u>Street address</u>	<u>Description</u>	<u>Approx. date</u>	<u>Degree of integrity</u>
<u>Thoreau Court</u>				
372	*5/7/9 Thoreau Ct.	vernacular Norwegian & Danish Meth. Church	1893	alt.
373	*19 Thoreau Ct.	vernac. 2nd Period	mid-18th C.	good
<u>Thoreau Street</u>				
556	148 Thoreau St.	vernac. Q. Anne/Col. Revival	late 1890's	good
557	156 Thoreau St.	" " " " "	" "	fair
558	164 Thoreau St.	" " " " "	" "	good
559	172/174 Thoreau St.	vernac. double house	ca. 1907	fair
560	180 Thoreau St.	" Queen Anne	late 1890's	good
561	196 Thoreau St.	" Italianate	1880's	good
562	²⁰⁸ 206/8 Thoreau St.	" Q. Anne double-house	1880's	fair
564	212 Thoreau St.	" " "	1880's	"
565	218 Thoreau St.	" " "	1880's	alt.
563-225	Thoreau St.	" double house	1880's	fair
574	226 Thoreau St.	" " "	ca. 1900	alt.
575	234 Thoreau St.	" Colonial Revival	ca. 1900	fair
585	248 Thoreau St.	" " "	ca. 1910-15	exc.
586	256 Thoreau St.	" " "	ca. 1910-15	good

INVENTORY FORM CONTINUATION SHEET

CONCORD

Herringtonville

<u>MHC/Map #</u>	<u>Street address</u>	<u>Description</u>	<u>Approx. date</u>	<u>Degree of integrity</u>
<u>Union Street</u>				
569	8 Union St.	vernac. cottage	ca. 1900	good
570	14 Union St.	vernac. cottage	ca. 1895-1900	fair
374	*15 Union St.	vernac. Q. Anne cottage	ca. 1895	exc.
580	4042 Union St.	vernacular gambrel	ca. 1920's	good
<u>Willow Street</u>				
573	11/13 Willow St.	"double-decker"	ca. 1900-05	fair
566	12/14 Willow St.	vernac. Queen Anne	ca. 1900-05	alt.
572	17/19 Willow St.	cross-gambrel double decker	ca. 1910-15	fair
567	18 Willow St.	vernac. Queen Anne	ca. 1900-05	"
568	24 Willow St.	" " "	ca. 1900-05	"
571	25 Willow St.	" " "	ca. 1910-15	alt.

AREA ☒

PL- CONCORD

JS63- CONCORD

SECTION - B

576 - 18 FIELDING ST

584 - 23 FIELDING ST

577 - 24 FIELDING ST

578 - 28 FIELDING ST

583 - 31 FIELDING ST

579 - 34 FIELDING ST

582 - 37 FIELDING ST

581 - 43 FIELDING ST

553 - 204 HUBBARD ST (ALSO AREA Y)

552 - 205 HUBBARD ST

554 - 212 HUBBARD ST (ALSO AREA Y)

555 - 220 HUBBARD ST (ALSO AREA Y)

556 - 148 THOREAU ST

557 - 156 THOREAU ST

558 - 164 THOREAU ST

559 - 172-174 THOREAU ST

560 - 180 THOREAU ST

561 - 196 THOREAU ST

562 - 206-208 THOREAU ST

564 - 212 THOREAU ST

565 - 218 THOREAU ST

563 - 225 THOREAU ST

574 - 226 THOREAU ST

575 - 234 THOREAU ST

585 - 248 THOREAU ST

586 - 256 THOREAU ST

569 - 8 UNION ST

570 - 14 UNION ST

580 - 42 UNION ST

573 - 11-13 WILLOW ST

566 - 12-14 WILLOW ST

572 - 17-19 WILLOW ST

567 - 18 WILLOW ST

568 - 24 WILLOW ST

571 - 25 WILLOW ST



31 Fielding Street (CON. 583)



211-205 Hubbard Street (CON. 371 and
CON. 552)



Fielding Street - West side



8 Union Street (CON. 569)